

**NOTES**

1. INSTALL COOLER / FREEZER PANELS BEFORE LOCATING FURNISH OR GRID WALLS ADJACENT.
2. EQUIPMENT SHOWN ON THIS PLAN FOR REFERENCE ONLY.
3. INSTALL BLOCKING AT ALL WALLS TO RECEIVE HANDRAILS, MARKETING SIGNS, BOARDS, AND SINKS FROM FACE OF WALL.
4. GAS FED EQUIPMENT TO BE LOCATED 10" MIN. FROM FACE OF WALL.
5. ALL FIRE EXTINGUISHERS AT SALES AND PUBLIC AREAS TO BE RECESSED MOUNTED - STAINLESS STEEL HOUSING AREAS ONLY.

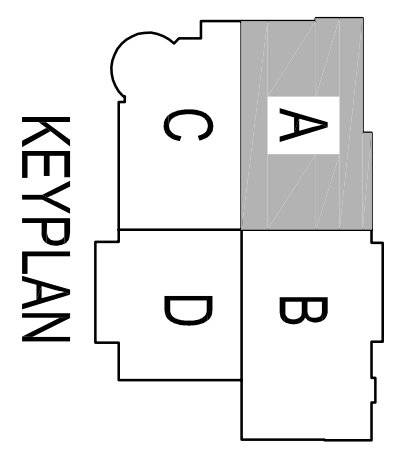

**1 ENLARGED FLOOR PLAN - NORTHWEST CORNER**

**PROPOSED GROCERY STORE**  
 2 SOMERSET STREET  
 PORTLAND, CUMBERLAND COUNTY, MAINE

**ISSUED FOR CONSTRUCTION**

**WHOLE FOODS**

300 Riverport Parkway  
 Portland, ME 04106  
 (207) 875-1400

**COMPANIES**  
 ARCHITECTURE  
 LANDSCAPE ARCHITECTURE  
 PLANNING  
 ENVIRONMENTAL SCIENCES  
 LAND SURVEYING  
 CIVIL ENGINEERING

No.	Date	Desc.

Designed: [Blank]  
 Drawn: [Blank]  
 Checked: [Blank]  
 Project No.: AS NOTED  
 Date: 03/20/24  
 CDD File: 24-04-000

**PAVING PLAN**  
**FLOOR PLAN**  
**NORTHWEST CORNER**

Sheet No. **A4.01**