

- GENERAL NOTES:**
1. ALL SUBCONTRACTORS ARE REQUIRED TO VISIT THE SITE BEFORE SUBMITTING BIDS.
 2. PROVIDE FIRE RESISTANT BOARDING AT ALL WALL MOUNTED HAND SINKS, SHELVEING, SINKS, AND FIXTURES.
 3. PROVIDE 5/8" FILTER PANELS TO MATCH BETWEEN EQUIPMENT BASES AT SERVICE AREAS AS DIRECTED BY OWNERS REP.
 4. ALL GAS RFD EQUIPMENT TO BE LOCATED HALL W/ FOOT MALL. SEE PLUMBING FOR DETAIL.
 5. SECURE CASE COVERS AFTER FROV

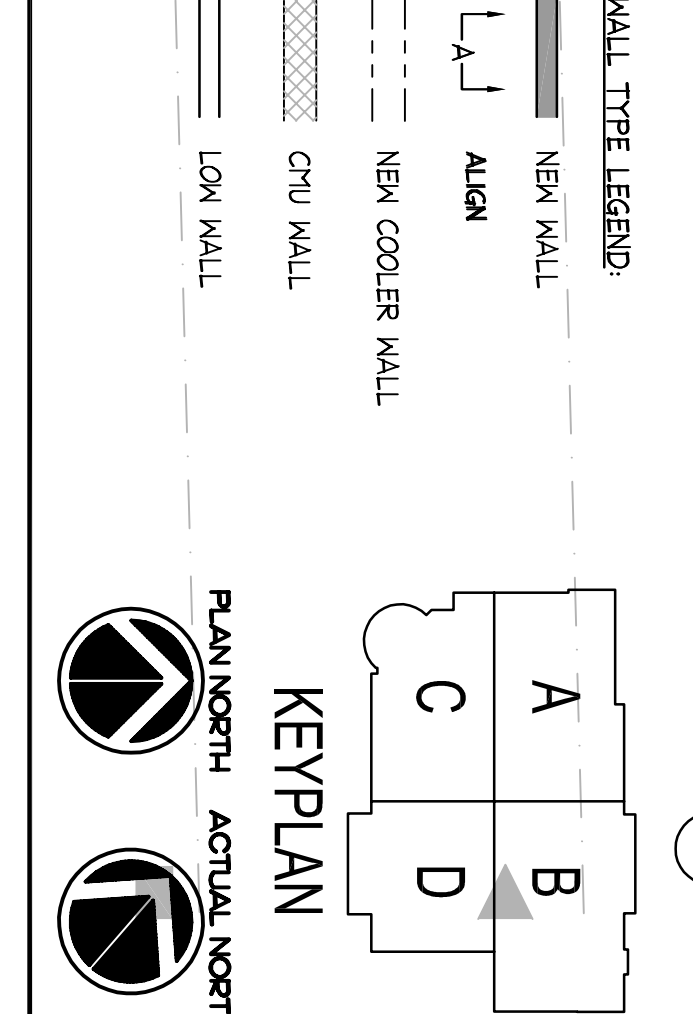

PROPOSED GROCERY STORE
 2 SOMERSET STREET
 PORTLAND, CUMBERLAND COUNTY, MAINE

ISSUED FOR CONSTRUCTION

WHOLE FOODS

Companies

ARCHITECTURE
 PLANNING
 LANDSCAPE ARCHITECTURE
 ENVIRONMENTAL SCIENCES
 CIVIL ENGINEERING

300 Fore Street
 Portland, ME 04101
 (207) 876-1100

Revised	Date	By	Checked	Desc.

Drawn: J.P.
 Checked: J.P.
 Scale: AS NOTED
 Project No.: 1566-01
 CDD File: ARCH23101

Prepared: J.P.
 Approved: J.P.
 Date: 04/26/24
 Project No.: 1566-01
 CDD File: ARCH23101

ARCHITECT/OWNER: WHOLE FOODS MARKET
 ARCHITECT: PLANNING + DESIGN PARTNERS

SHEET NO. **A1.11**