

LEGEND

- PROPERTY LINE
- EXISTING FENCE
- PROPOSED FENCE
- EXISTING CONCRETE/BITUMINOUS SIDEWALK
- PROPOSED CONCRETE/BITUMINOUS SIDEWALK
- EXISTING SIGN
- PROPOSED SIGN
- PROPOSED LIGHT POLE BASE
- PROPOSED LANDSCAPING
- PROPOSED GROUNDCOVER
- EXISTING LIGHT
- APPROXIMATE LIMIT OF WORK

LANDSCAPE NOTES:

1. THE CONTRACTOR SHALL FURNISH AND PLANT ALL PLANTS IN QUANTITIES AS SHOWN ON THIS PLAN. NO SUBSTITUTIONS WILL BE PERMITTED UNLESS APPROVED BY OWNER. ALL PLANTS SHALL BE NURSERY GROWN.
2. ALL PLANTS SHALL BE NURSERY GROWN AND PLANTS AND WORKMANSHIP SHALL CONFORM TO THE AMERICAN ASSOCIATION OF NURSERYMEN STANDARDS, INCLUDING BUT NOT LIMITED TO SIZE, HEALTH, SHAPE, ETC., AND SHALL BE SUBJECT TO THE APPROVAL OF THE LANDSCAPE ARCHITECT PRIOR TO ARRIVAL ON-SITE AND AFTER PLANTING.
3. PLANT STOCK SHALL BE GROWN WITHIN THE HARDINESS ZONES 4 THRU 7 ESTABLISHED BY THE PLANT HARDINESS ZONE MAP, MISCELLANEOUS PUBLICATIONS NO. 814, AGRICULTURAL RESEARCH SERVICE, UNITED STATES DEPARTMENT AGRICULTURE, LATEST REVISION.
4. PLANT MATERIAL SHALL BEAR THE SAME RELATIONSHIP TO FINISHED GRADE AS TO THE ORIGINAL PLANTING GRADE PRIOR TO DIGGING.
5. THE NUMBER OF EACH INDIVIDUAL PLANT TYPE AND SIZE PROVIDED IN THE PLANT LIST OR ON THE PLAN IS FOR THE CONTRACTOR'S CONVENIENCE ONLY. IF A DISCREPANCY EXISTS BETWEEN THE NUMBER OF PLANTS ON THE LABEL AND THE NUMBER OF SYMBOLS SHOWN ON THE DRAWINGS, THE GREATER NUMBER SHALL APPLY.
6. NO SUBSTITUTION OF PLANT MATERIALS WILL BE ALLOWED WITHOUT THE PRIOR WRITTEN APPROVAL OF THE OWNER'S REPRESENTATIVE.
7. THE CONTRACTOR SHALL LOCATE, VERIFY AND MARK ALL EXISTING AND NEWLY INSTALLED UNDERGROUND UTILITIES PRIOR TO ANY LAWN WORK OR PLANTING. ANY CONFLICTS WHICH MIGHT OCCUR BETWEEN PLANTING AND UTILITIES SHALL IMMEDIATELY BE REPORTED TO THE OWNER SO THAT ALTERNATE PLANTING LOCATIONS CAN BE DETERMINED.
8. ALL DISTURBED AREAS NOT TO BE PAVED OR OTHERWISE TREATED, SHALL RECEIVE SIX (6) INCHES OF LOAM AND SEED. NO FILL SHALL BE PLACED IN ANY WETLAND AREA.
9. THREE (3) INCH BARK MULCH IS TO BE USED AROUND THE TREE AND SHRUB PLANTING AS SPECIFIED IN THE DETAILS. WHERE BARK MULCH IS TO BE USED IN A CURBED ISLAND THE BARK MULCH SHALL MEET THE TOP INSIDE EDGE OF THE CURB. ALL OTHER AREAS SHALL RECEIVE SIX (6) INCHES OF LOAM AND SEED.
10. PRE-PURCHASE PLANT MATERIAL AND ARRANGE FOR DELIVERY TO MEET PROJECT SCHEDULE AS REQUIRED. IT MAY BE NECESSARY TO PRE-DIG CERTAIN SPECIES WELL IN ADVANCE OF ACTUAL PLANTING DATES.
11. SEE PLANTING DETAILS AND SPECIFICATIONS FOR ADDITIONAL REQUIREMENTS.
12. TREE STAKES SHALL REMAIN IN PLACE FOR NO LESS THAN 6 MONTHS AND NO MORE THAN 1 YEAR.
13. PLANTING SHALL BE COMPLETED FROM APRIL 15TH THROUGH OCTOBER 1ST. NO PLANTING DURING JULY AND AUGUST UNLESS SPECIAL PROVISIONS ARE MADE FOR DROUGHT.
14. PARKING AREA PLANTED ISLANDS TO HAVE MINIMUM OF 1"-0" TOPSOIL PLACED TO WITHIN 3 INCHES OF THE TOP OF CURB ELEVATION. REMOVE ALL CONSTRUCTION DEBRIS BEFORE PLACING TOPSOIL.
15. TREES SHALL BE PRUNED IN ACCORDANCE WITH THE LATEST EDITION OF ANSI A300 'TREES, SHRUBS AND OTHER WOOD PLANT MAINTENANCE STANDARD PRACTICES.
16. ALL PLANTS SHALL BE WATERED THOROUGHLY TWICE DURING THE FIRST 24 HOUR PERIOD AFTER PLANTING. ALL PLANTS SHALL BE WATERED WEEKLY, OR MORE OFTEN, IF NECESSARY DURING THE FIRST GROWING SEASON.
17. EXISTING TREES AND SHRUBS ARE TO REMAIN UNDISTURBED, UNLESS OTHERWISE SPECIFIED. ALL EXISTING TREES AND SHRUBS SHOWN TO REMAIN ARE TO BE PROTECTED WITH A 4'-FOOT SNOW FENCE PLACED AT THE DRIP LINE OF THE BRANCHES OR AT 8 FEET MINIMUM FROM THE TREE TRUNK. ANY EXISTING TREE OR SHRUB SHOWN TO REMAIN, WHICH IS REMOVED DURING CONSTRUCTION, SHALL BE REPLACED BY A TREE OF COMPARABLE SIZE AND SPECIES TREE OR SHRUB.
18. THE CONTRACTOR SHALL GUARANTEE ALL PLANTINGS TO BE IN GOOD HEALTHY, FLOURISHING AND ACCEPTABLE CONDITION FOR A PERIOD OF (1) YEAR BEGINNING AT THE DATE OF ACCEPTANCE OF SUBSTANTIAL COMPLETION. ALL GRASSES, TREES AND SHRUBS THAT, IN THE OPINION OF THE LANDSCAPE ARCHITECT, SHOW LESS THAN 80% HEALTHY GROWTH AT THE END OF ONE YEAR PERIOD SHALL BE REPLACED BY THE CONTRACTOR.
19. UPON EXPIRATION OF THE CONTRACTOR'S ONE YEAR GUARANTEE PERIOD, THE OWNER SHALL BE RESPONSIBLE FOR LANDSCAPE MAINTENANCE INCLUDING WATERING DURING PERIODS OF DROUGHT.
20. THE CONTRACTOR SHALL BE RESPONSIBLE FOR PROTECTING ALL PLANTING AND LAWNS AGAINST DAMAGE FROM ONGOING CONSTRUCTION. THIS PROTECTION SHALL BEGIN AT THE TIME THE PLANT IS INSTALLED AND CONTINUE UNTIL THE FORMAL ACCEPTANCE OF ALL THE PLANTINGS.

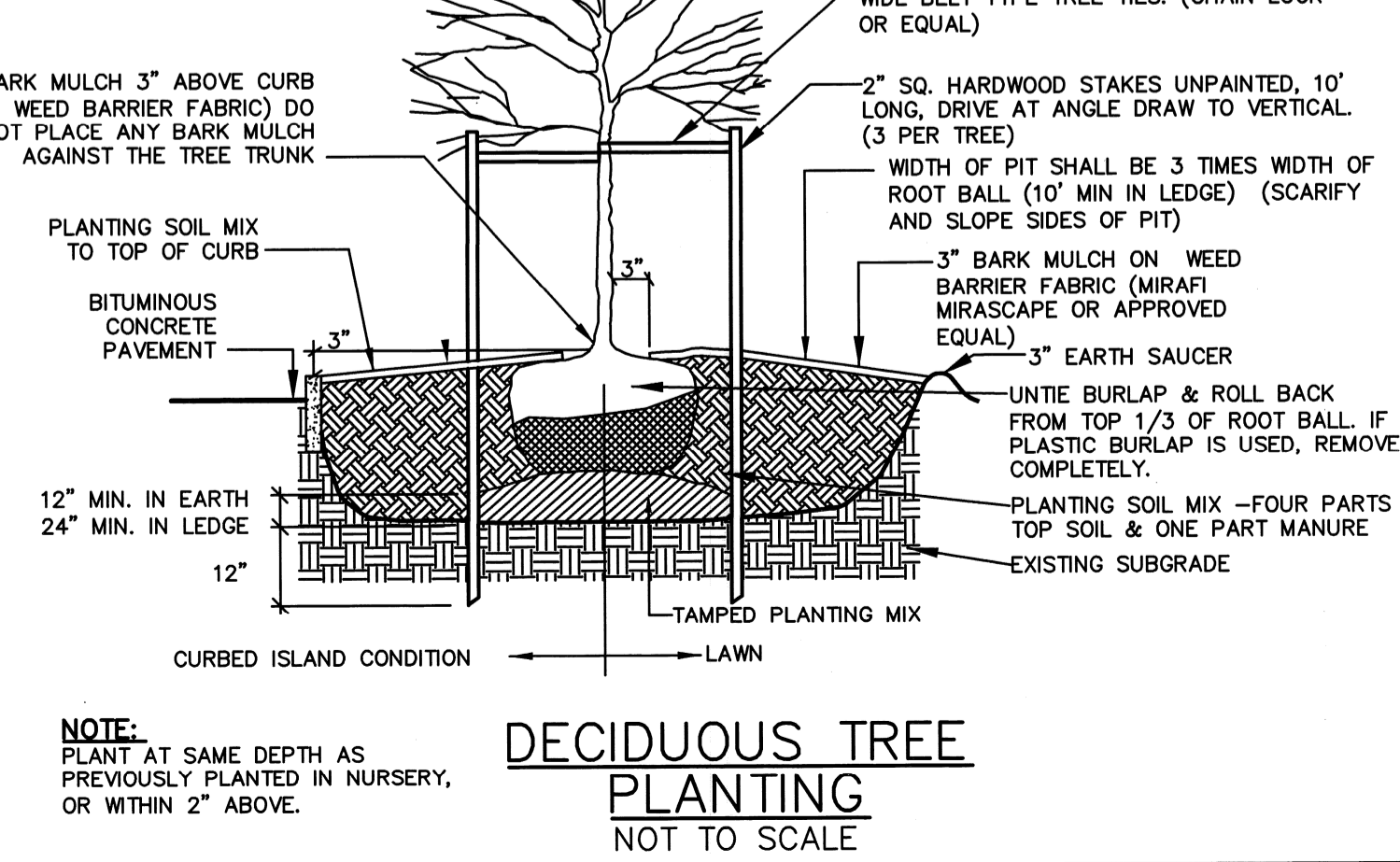
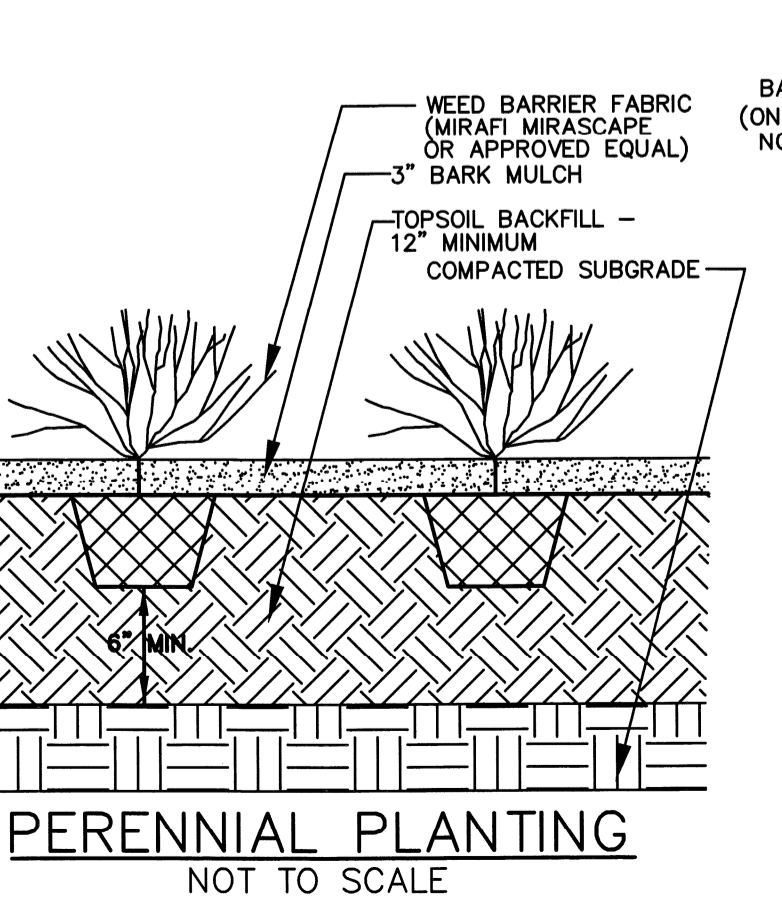
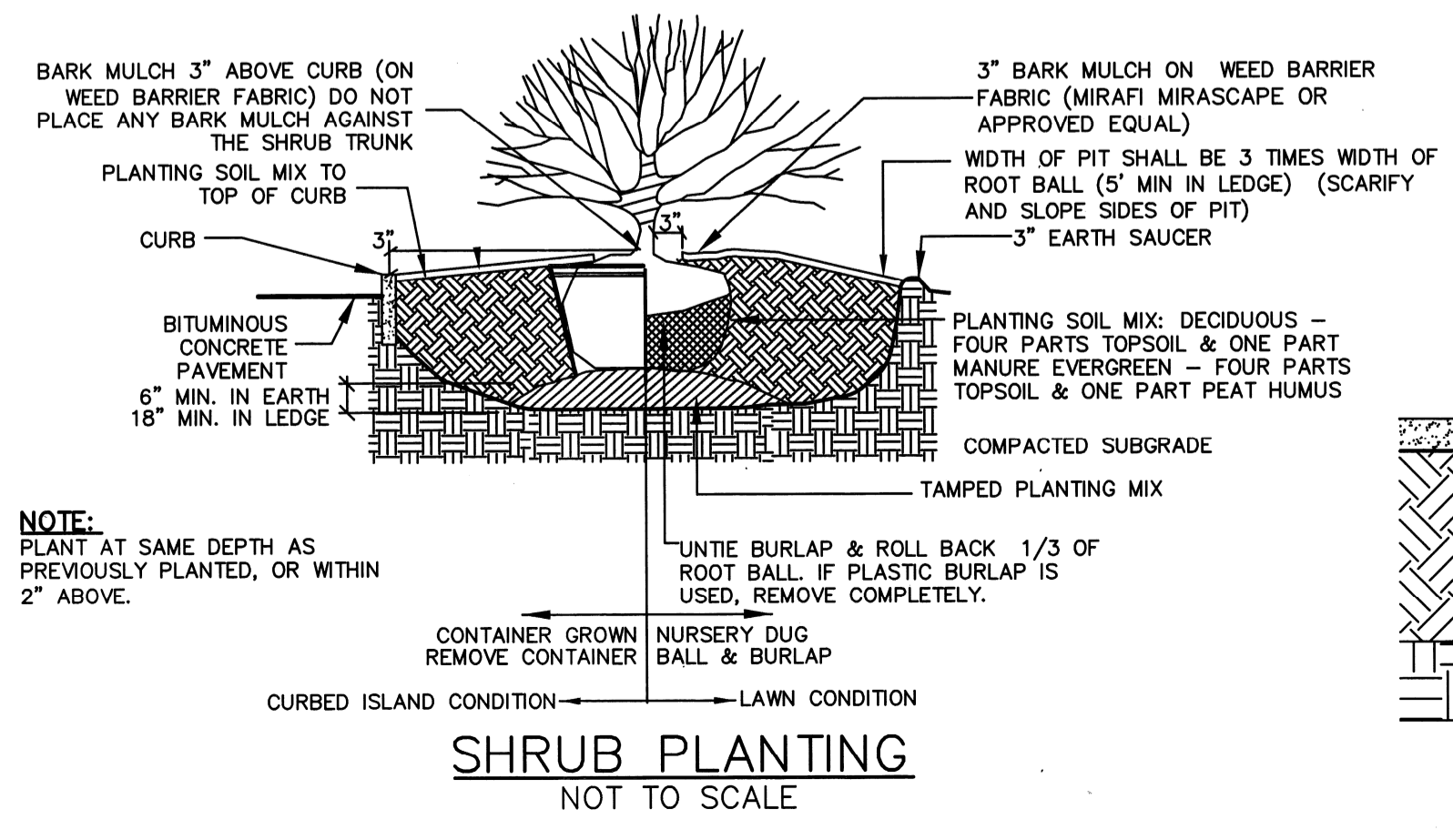
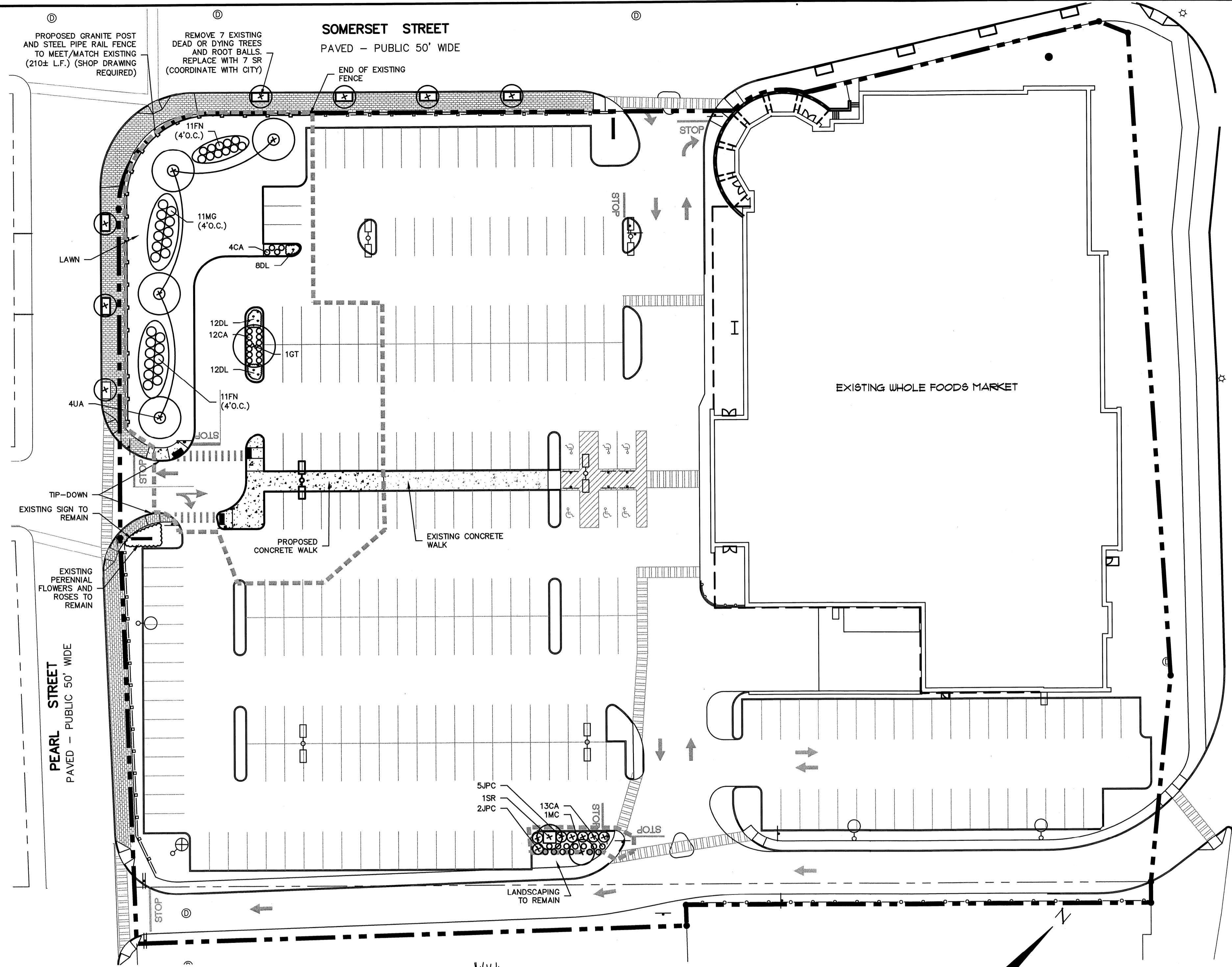

| PLANT SCHEDULE | | | | |
|----------------------------------|----------------------------------|-------------------------|--------------------|--------------------|
| TREES: | BOTANICAL NAME | COMMON NAME | SIZE | REMARKS |
| GT | GLEDITSIA TRIACANTHOS 'SKYLINE' | SKYLINE HONEYLOCUST | 3 - 3 1/2" CALIPER | B & B |
| UA | ULMUS AMERICANA 'PRINCETON' | PRINCETON AMERICAN ELM | 3 - 3 1/2" CALIPER | B & B |
| SR | SYRINGA RETICULATA 'IVORY SILK' | IVORY SILK TREE LILAC | 2 1/2 - 3" CALIPER | B & B, SINGLE STEM |
| MC | MALUS CORAL BURST | CORAL BURST CRAB APPLE | 2 - 2 1/2" CALIPER | B & B |
| SHRUBS: | BOTANICAL NAME | COMMON NAME | SIZE | REMARKS |
| FN | FORSYTHIA 'NORTHERN GOLD' | NORTHERN GOLD FORSYTHIA | 5 GALLON | CONTAINER |
| MG | MYRTICA 'GALE' | SWEETGALE | 5 GALLON | CONTAINER |
| JPC | JUNIPERUS PFITZERIANA 'COMPACTA' | COMPACT PFITZER JUNIPER | 3 GALLON | CONTAINER |
| ORNAMENTAL GRASSES & PERENNIALS: | BOTANICAL NAME | COMMON NAME | SIZE | REMARKS |
| CA | CALAMAGROSTIS 'KARL FOERSTER' | FEATHER REED GRASS | 3 GALLON | CONTAINER |
| DL | HEMEROCALLIS 'STELLA DORO' | STELLA DORO DAYLILLY | 2 GALLON | CONTAINER |

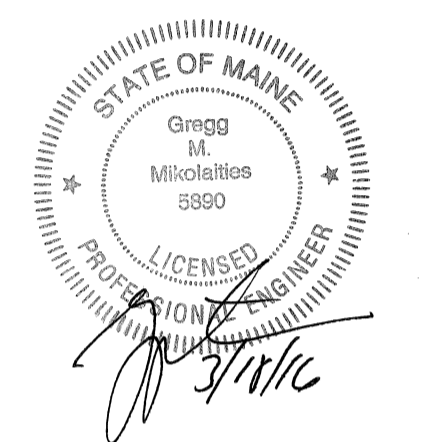
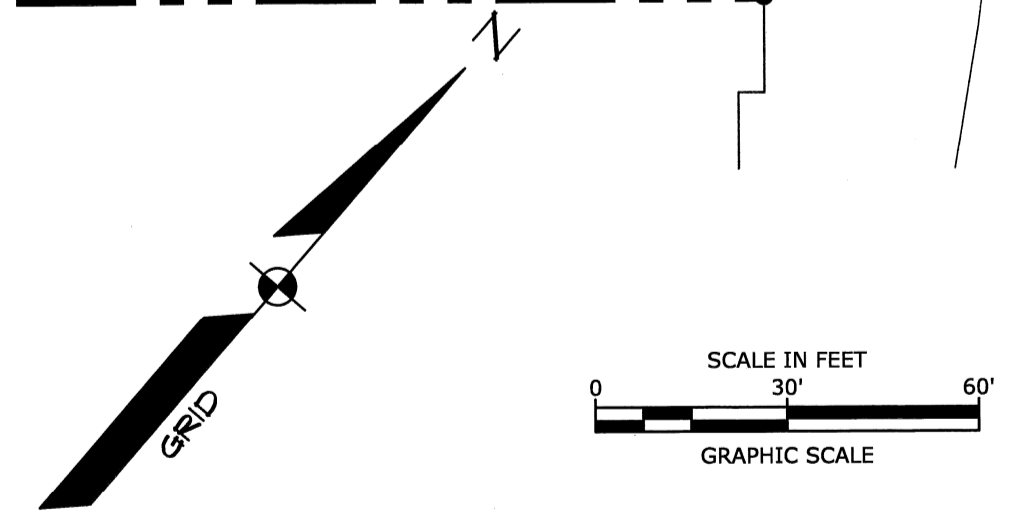

Proposed Parking Lot Improvements

Whole Foods Market

Portland, Maine

| 2. | 3/18/16 | Revised per City Comment |
|------|---------|----------------------------|
| 1. | 2/25/16 | Revised per City Comment |
| MARK | DATE | DESCRIPTION |
| | | PROJECT NO: W2011-39 |
| | | DATE: 2016/01/15 |
| | | FILE: W2011_SITE_REV 2.dwg |
| | | DRAWN BY: REP |
| | | CHECKED: KAM |
| | | APPROVED: GMM |

LANDSCAPE PLAN

SCALE: AS SHOWN

Last Saved: 3/18/2016 1:43pm By: kam
 Printed On: Mar 21, 2016 1:43pm
 Tighe & Bond: \\srv-proj\projects\W2011 Whole Foods\DWG-CAD\DESIGN\W2011 SITE_REV 2.dwg