



Auburn, ME
207.784.5100

Portland, ME
207.775.0053

Manchester, NH
603.626.1242

HARRIMAN

WHOLE FOODS MARKET CANDY ISLAND RENOVATIONS

PORTLAND, ME

HA Project No. 13113

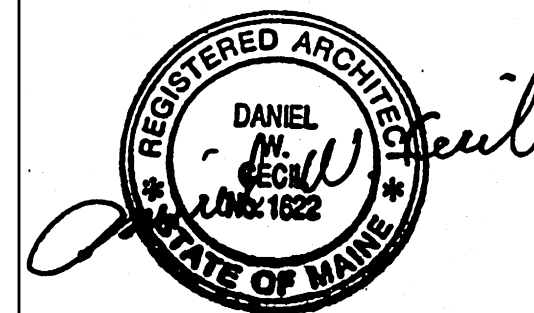

ISSUED FOR PERMITTING
AND CONSTRUCTION

Date 06-09-14

Scale 1/4" = 1'-0"

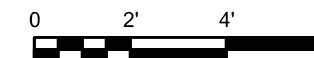

© 2014 Harriman Associates

STORE LAYOUT PROPOSED FLOOR PLAN

A10.1

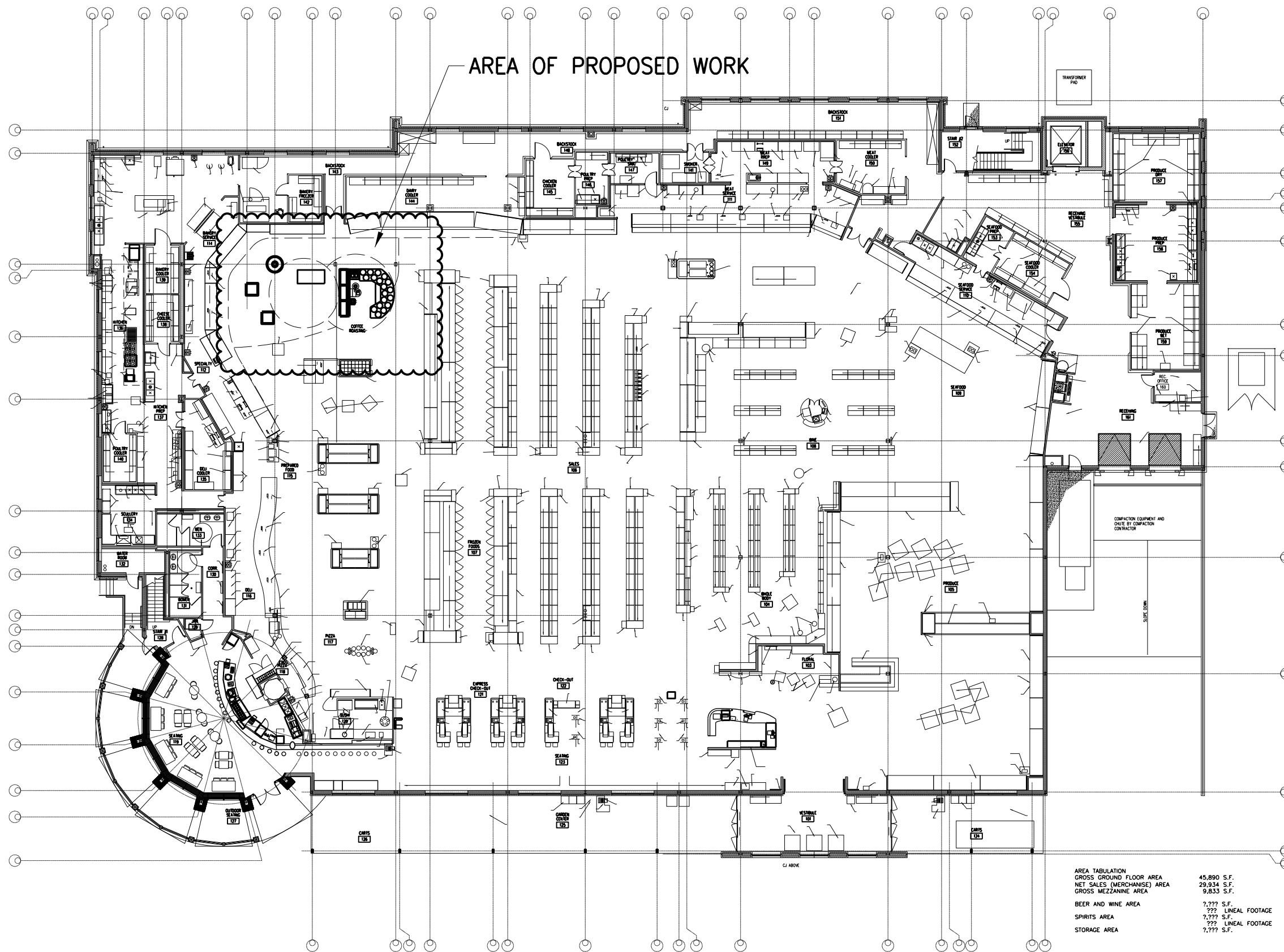

GROSS GROUND FLOOR AREA	45,890 S.F.
NET SALES (MERCHANDISE) AREA	29,934 S.F.
GROSS MEZZANINE AREA	9,833 S.F.
BEER AND WINE AREA	???? S.F.
SPIRITS AREA	???? S.F.
STORAGE AREA	???? S.F.