

MIN 1 HR RATED DEMISING WALL TO BE INSTALLED BY LANDLORD. SIMILAR TO UL DESIGN U419: 2 LAYERS 5/8" TYPE X GWB ON 1/2" HORIZONTAL RESILIENT CHANNELS @ 24" O.C. ON CMD SIDE OF WALL, SINGLE LAYER TYPE X 5/8" GWB ON OTHER SIDE OF 6" STEEL STUDS AT 16" O.C. TIGHT TO STRUCTURE ABOVE. FIRE SAFING BETWEEN DECK FLUTES & TOP OF WALL. THERMAFIBER INSULATION, FULL CAVITY DEPTH. GWB TAPED & PAINTED 3 COATS. 5/8" GWB LAYER ON CONVENIENTMD SIDE OF WALL TO BE CO-ORDINATED BETWEEN LANDLORD & CONVENIENTMD TENANT

ADJACENT TENANT BUILDING SPACE ON WEST OF CONVENIENTMD (BY OTHERS)

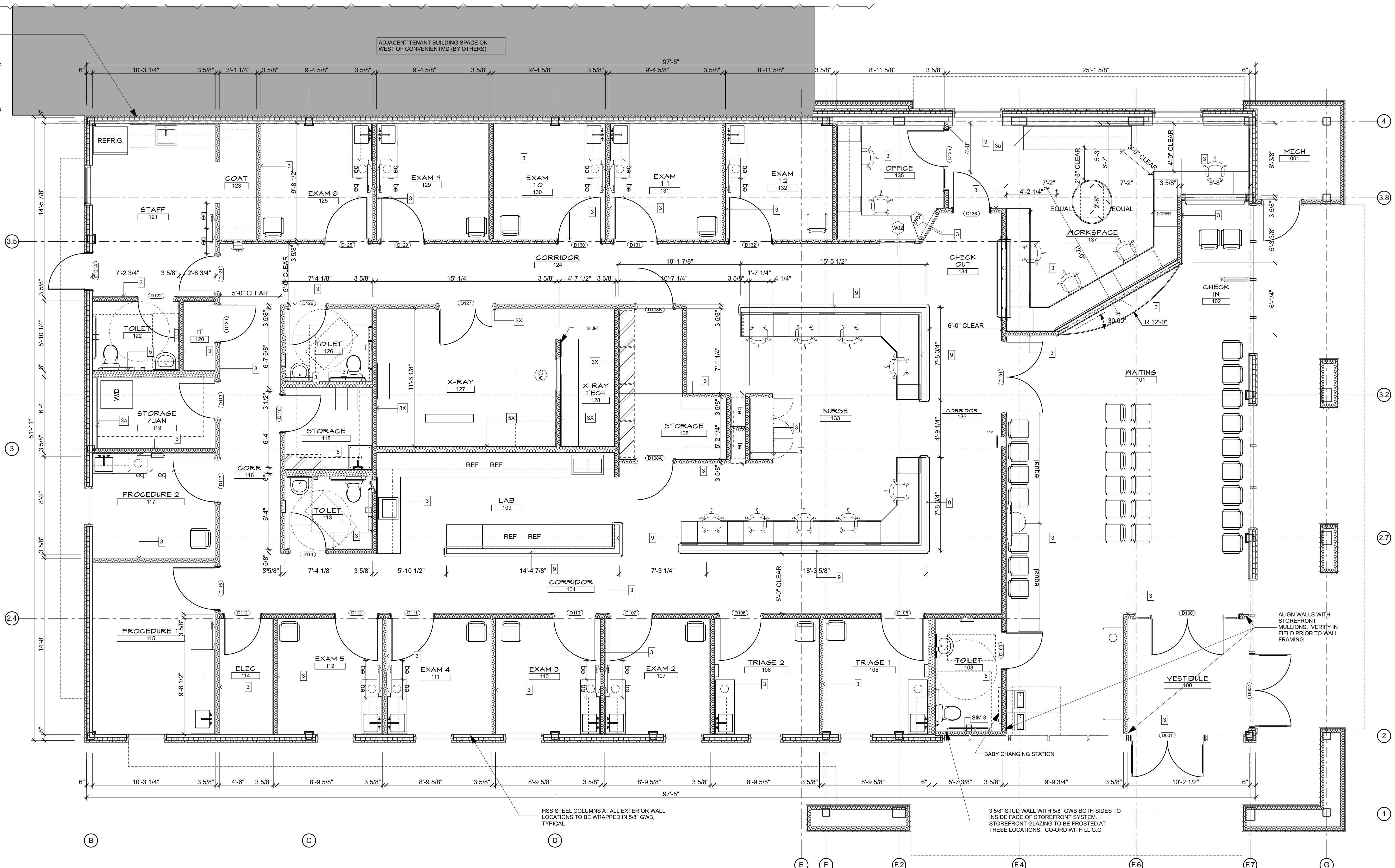

/Volumes/ActiveProjects/CMD/Portland - 2014055/Architect/20170208 - Convenient MD - PORTLAND - Interior_V19.rvt Friday, April 7, 2017

Proposed Floor Plan
SCALE: 1/4" = 1'-0"

WALL TYPE NOTE:
SEE DRAWING A001 FOR WALL TYPE NOTES

GWB NOTE:
-CONVENIENTMD G.C IS TO PROVIDE AND INSTALL 5/8" TYPE X GWB CEILING ON RESILIENT CHANNELS TO THE UNDERSIDE OF ROOF STRUCTURE ABOVE. GWB IS TO BE TAPED, & PRIMED. ALL INTERIOR WALLS WILL BE BUILT TIGHT TO UNDERSIDE OF THE GWB CEILING UNLESS OTHERWISE NOTE.
-EXTERIOR WALLS WILL BE INSULATED BY LANDLORD. CONVENIENTMD G.C IS RESPONSIBLE TO PROVIDE & INSTALL 5/8" TYPE X GWB TO INSIDE FACE OF ALL EXTERIOR WALLS, TO BE TAPED, PRIMED AND PAINTED 2 COATS.
-ALL WINDOWS ARE TO HAVE GWB RETURNS AT JAMBS & HEADS CONDITIONS. WINDOW SILLS SHALL HAVE A 3/4" PAINTED POPLAR SILL TRIM WITH 3/8" PAINTED SHADOW TRIM UNDERNEATH. FRONT EDGE OF SILL TRIM SHALL ALIGN WITH THE FINISH FACE OF GWB AND SHALL DIE INTO JAMBS AT BOTH ENDS OF SILL. GWB RETURNS & WOOD SILLS TO BE INSTALLED BY CONVENIENTMD G.C

ALL PROPOSED TENANT FIT UP WORK SHALL BE CO-ORDINATED WITH BUILDING OWNER CONTRACTOR & ASSOCIATE BUILDING SHELL DOCUMENTS. BUILDING SHELL DOCUMENTS ARE AVAILABLE FOR CO-ORDINATION PURPOSES CWS ARCHITECTS

Convenient MD
191 Marginal Way
Portland, Maine



DENNIS MIRES, P.A.
THE ARCHITECTS
697 Union Street, Manchester, NH
603-625-4548 FAX 603-625-1067

The material contained in these drawings and the design they represent is the property of Dennis Mires, P.A. It is to be used only for the project and location specifically identified in the title block. No part of these drawings may be reproduced, stored in a retrieval system, or transmitted in any form or by any means, electronic, mechanical, photocopying, recording, or by any information storage and retrieval system, without the prior written permission of Dennis Mires, P.A.

Floored Floor Plan

revisions:

date: 03/24/2017

proj. no.:

A101