

**DOOR SCHEDULE**

| NO. | SIZE (WxH)                | DOOR |       |            | FRAME |      | HWDR | COMMENTS                     |   |
|-----|---------------------------|------|-------|------------|-------|------|------|------------------------------|---|
|     |                           | TYPE | LABEL | MAT.       | FIN.  | MAT. |      |                              | FIN.  |
| 1   | EXISTING PR 3'-0" X 7'-0" | -    | -     | ALUM.      | -     | ALUM | -    | PROVIDE NEW LOCKSET/CYLINDER |   |
| 2   | EXISTING 3'-0" X 7'-0"    | -    | -     | S.C. WD    | P-3   | H.M. | P-4  | 2                            | REUSE HARDWARE, REPAIR & REPLACE                                |
| 3   | 3'-0" X 7'-0"             | A    | -     | S.C. WD    | P-3   | H.M. | P-4  | 2                            |   |
| 4   | EXISTING 3'-0" X 7'-0"    | -    | -     | S.C. WD    | P-3   | H.M. | P-4  | 1                            |   |
| 5   | EXISTING 3'-0" X 7'-0"    | -    | -     | INSUL. ST. | P-3   | H.M. | P-4  | 5                            | ADJUST DOOR/FRAME TO NEW FLOOR ELEVATION, PROVIDE WEATHERSTRIPS |
| 6   | 3'-0" X 7'-0"             | -    | -     | S.C. WD    | P-3   | H.M. | P-4  | 6                            |   |
| 7   | EXISTING 3'-0" X 7'-0"    | -    | -     | -          | P-3   | -    | P-4  | 1                            | REUSE EXISTING DOOR & HARDWARE REPLACE AS REQUIRED.             |
| 8   | EXISTING 3'-0" X 7'-0"    | -    | -     | S.C. WD    | P-3   | H.M. | P-4  | 1                            | REUSE EXISTING DOOR & HARDWARE REPLACE AS REQUIRED.             |
| 9   | EXISTING 3'-0" X 7'-0"    | -    | -     | S.C. WD    | P-3   | H.M. | P-4  | 1                            | REUSE EXISTING DOOR & HARDWARE REPLACE AS REQUIRED.             |
| 10  | EXISTING 3'-0" X 7'-0"    | -    | -     | S.C. WD    | P-3   | -    | P-4  | 1                            | REUSE EXISTING DOOR & HARDWARE REPLACE AS REQUIRED.             |
| 11  | 3'-0" X 7'-0"             | B    | -     | S.C. WD    | P-3   | -    | P-4  | 1                            | REUSE EXISTING DOOR & HARDWARE REPLACE AS REQUIRED.             |
| 12  | 3'-0" X 7'-0"             | B    | -     | S.C. WD    | P-3   | H.M. | P-4  | 2                            |   |

**HARDWARE GROUPS** SEE SHEET A-4 FOR PAINT FINISHES

- (ALL LOCKSETS TO HAVE ADA APPROVED LEVER HANDLES)
- HARDWARE GROUP 1**  
 -OFFICE LOCKSET  
 -1 1/2" PR BUTTS  
 -FLOOR STOP/WALL STOP  
 -SILENCERS
- HARDWARE GROUP 2**  
 -PRIVACY SET  
 -CLOSER  
 -1 PR BUTTS  
 -FLOOR STOP/WALL STOP  
 -SILENCERS  
 -SPRING LOADED HINGE  
 -ADA SIGNAGE MEN & WOMEN
- HARDWARE GROUP 3**  
 -PANIC BAR ON EGRESS SIDE  
 -PULL BARS  
 -PUSH BARS  
 -THRESHOLD  
 -FLUSH BOLTS @ INACTIVE LEAF (TOP AND BOTTOM)  
 -CONTINUOUS HINGE (ROTTEN HINGES)  
 -CLOSER  
 -CYLINDRICAL LOCKSET  
 -WEATHER STRIP
- HARDWARE GROUP 4**  
 -PANIC BAR ON EGRESS SIDE  
 -KEYED REENTRY  
 -CLOSER  
 -WEATHER STRIP  
 -KICK PLATE - EACH SIDE  
 -1 1/2" PAIR BUTTS THRESHOLD
- HARDWARE GROUP 5**  
 -PANIC BAR ON EGRESS SIDE  
 -KEYED REENTRY  
 -ALARM  
 -CLOSER  
 -WEATHER STRIP  
 -1 1/2" PAIR BUTTS THRESHOLD
- HARDWARE GROUP 6**  
 -PUSH PLATE ON EGRESS SIDE  
 -PULL LATCH ON ROOM SIDE  
 -SILENCERS  
 -CLOSER  
 -1 1/2" PAIR BUTTS

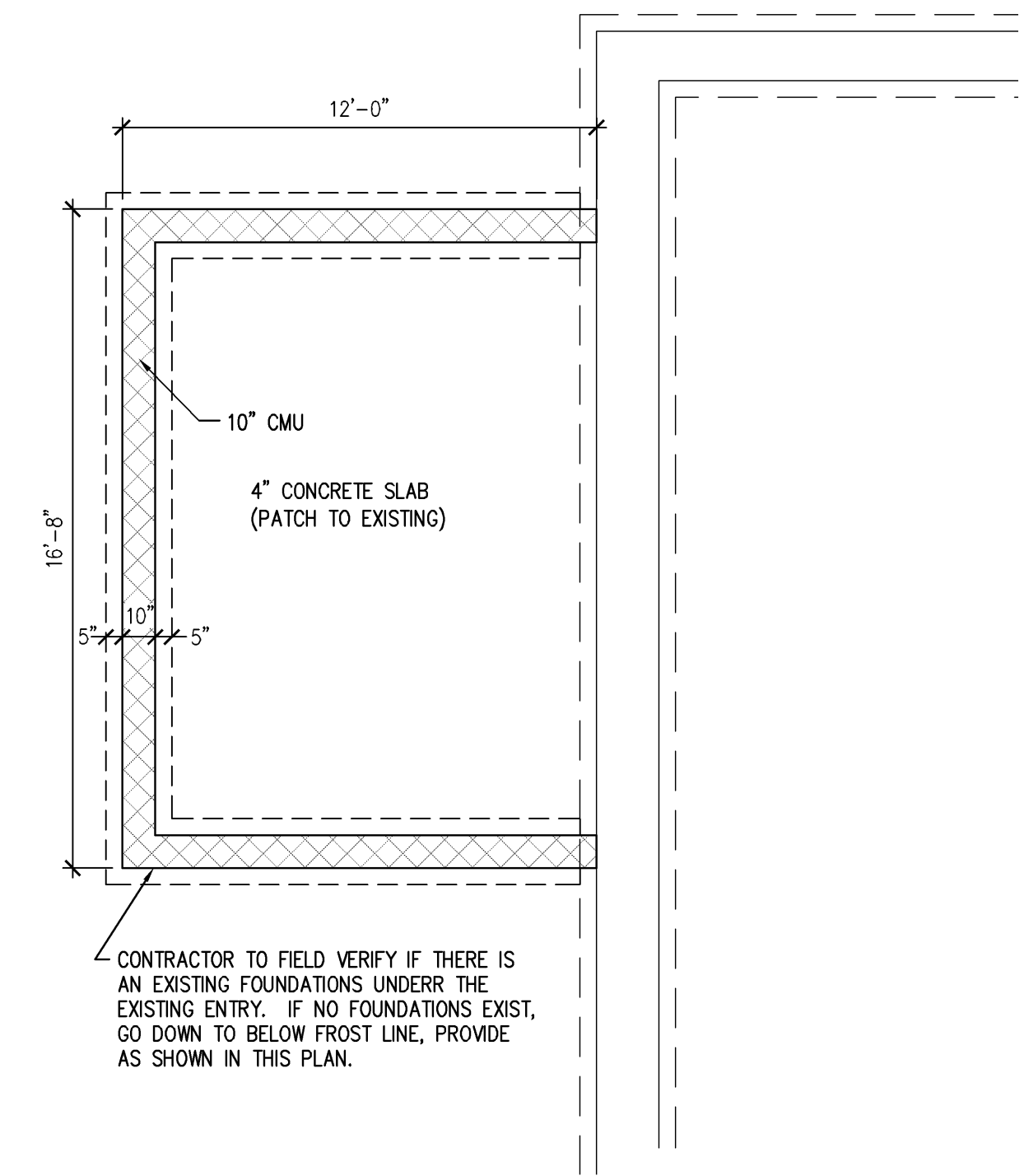
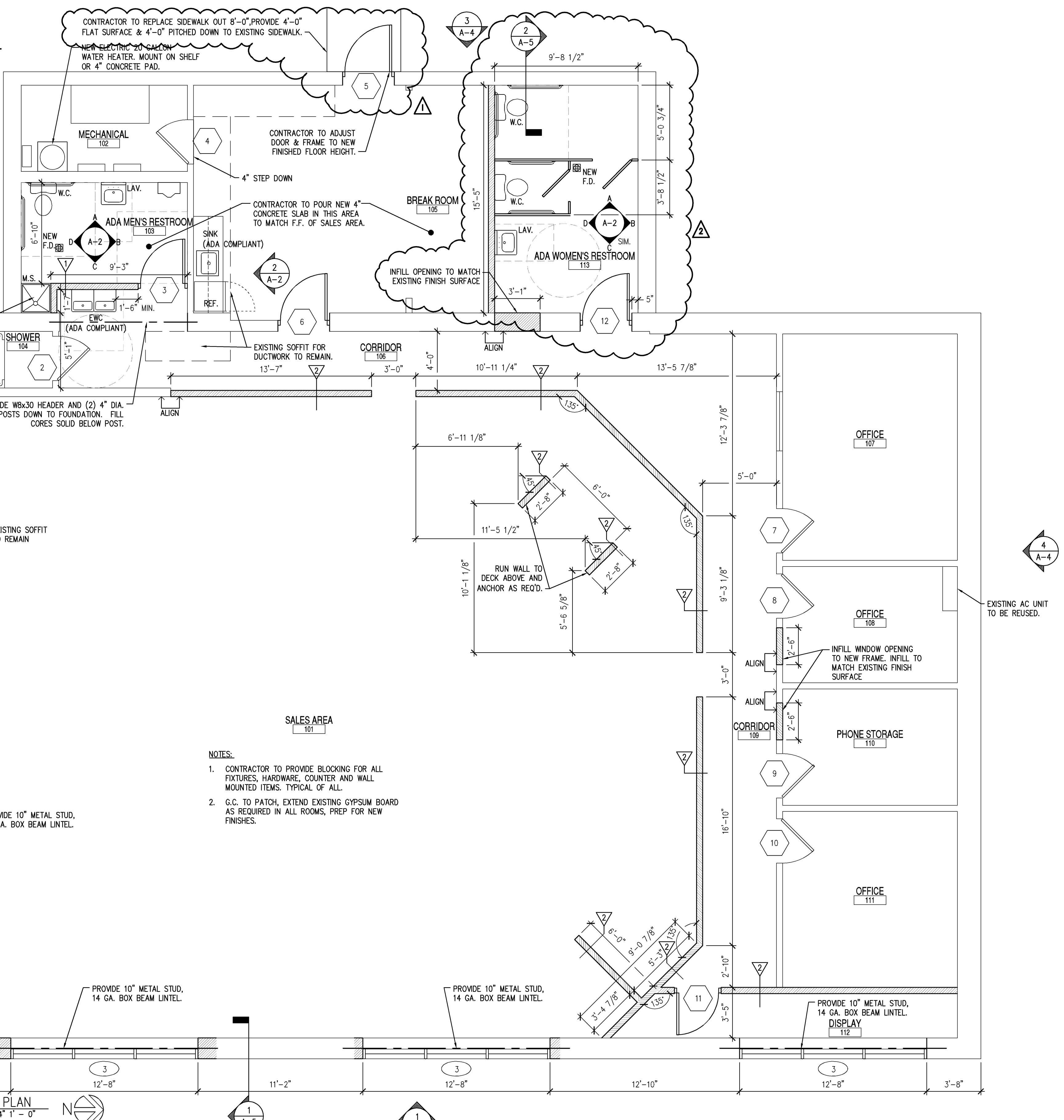

2 PARTIAL FOUNDATION PLAN  
SCALE: 1/4" 1' = 0"

- WALL TYPES**
- 3-5/8" METAL STUD 16" O.C. W/ 5/8" GYP. BD. EACH SIDE UP TO ROOF DECK. R-11 SOUND INSULATION. USE WATER RESISTANT IN LAVS. AND MOPSINK.
  - 3-5/8" METAL STUD 16" O.C. W/ 1/2" GYPSUM BOARD EACH SIDE, 8" ABOVE FINISHED CEILING. USE WATER RESISTANT IN LAVS. AND MOPSINK.
- LEGEND**
- EXISTING WALLS TO BE DEMOLISHED (SEE DEMO PLAN)
  - EXISTING WALLS TO REMAIN
  - NEW WALLS
- DOOR TYPES**
- TYPE A: SOLID CORE WOOD VENEER, 3'-0" x 7'-0"
  - TYPE B: SOLID CORE WOOD VENEER, 3'-0" x 7'-0", H.M. LOUVER

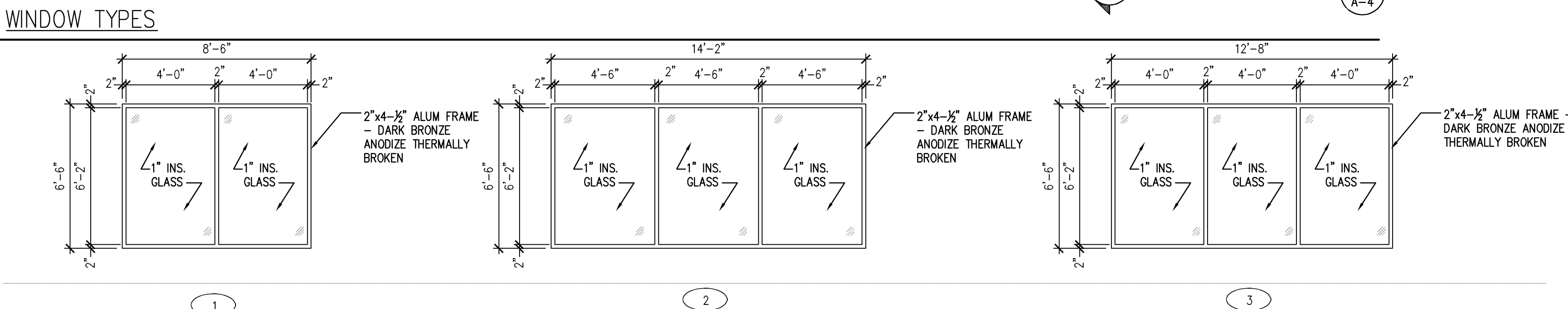

- NOTES:**
- CONTRACTOR TO PROVIDE BLOCKING FOR ALL FIXTURES, HARDWARE, COUNTER AND WALL MOUNTED ITEMS. TYPICAL OF ALL.
  - G.C. TO PATCH, EXTEND EXISTING GYPSUM BOARD AS REQUIRED IN ALL ROOMS, PREP FOR NEW FINISHES.

MAINE

PROJECT: **CELLULAR SALES**  
 3 SOMERSET STREET  
 PORTLAND, MAINE 04101

OWNER: **CELLULAR SALES**  
 109 CIRCLE LANE, KNOXVILLE TN 37919

THE CRISSEY ARCHITECTURAL GROUP  
 995 North Ave.  
 Syracuse NY 13206  
 Phone: 315-437-0844  
 Fax: 315-463-7619  
 Email: info@crisseygroup.com  
 Web: www.crisseygroup.com

JOB NUM: 10173  
 DRAWN BY: B.J.G.  
 CHECKED: TAP  
 ISSUED: 12/16/2010  
 REVISIONS: 12/28/2010  
 01/28/2011

DRAWING TITLE  
 FLOOR PLAN  
 SHEET NUMBER  
**A-1**  
 10173 A-1.DWG