

DISPLAY THIS CARD ON PRINCIPAL FRONTAGE OF WORK CITY OF PORTLAND

Please Read Application And Notes, If Any, Attached

BUILDING PERMIT

Permit Number: 090070

This is to certify that MARGINAL WAY PROPERTIES INC /

has permission to Signs / Two Building Signs, and One Free Standing Sign

AT 211 MARGINAL WAY City - 024 C001001

provided that the person or persons, firm or corporation accepting this permit shall comply with all of the provisions of the Statutes of Maine and of the Ordinances of the City of Portland regulating the construction, maintenance and use of buildings and structures, and of the application on file in this department.

Apply to Public Works for street line and grade if nature of work requires such information.

Notification of inspection must be given and written permission procured before this building or part thereof is altered or otherwise occupied-in. 24 HOUR NOTICE IS REQUIRED.

A certificate of occupancy must be procured by owner before this building or part thereof is occupied.

OTHER REQUIRED APPROVALS

Fire Dept.	FEB 2000
Health Dept.	
Appeal Board	
Other	CITY CERTIFIED
Department Name	



Director - Building & Inspection Services

PENALTY FOR REMOVING THIS CARD

City of Portland, Maine - Building or Use Permit Application

389 Congress Street, 04101 Tel: (207) 874-8703, Fax: (207) 874-8716

Permit No: 09-0070	Issue Date: 2/2/09	CBL: 024 C001001
-----------------------	-----------------------	---------------------

Location of Construction: 211 MARGINAL WAY	Owner Name: MARGINAL WAY PROPERTIES I	Owner Address: 555 WASHINGTON ST	Phone: 781-237-3677
Business Name:	Contractor Name: Burr Signs	Contractor Address: 50 DownEast Drive Yarmouth	Phone: 2077991183
Lessee/Buyer's Name	Phone:	Permit Type: Signs - Permanent	Zone: B-7

Past Use: Commercial - AT & T	Proposed Use: Commercial AT&T Signs / Two Building Signs, and One Freestanding Signs	Permit Fee: \$258.00	Cost of Work: \$0.00	CEO District: 1
		FIRE DEPT: <input type="checkbox"/> Approved <input type="checkbox"/> Denied	INSPECTION: Use Group: <i>Signage</i> <i>IBC-2003</i>	

Proposed Project Description: Signs / Two Building Signs, and One Freestanding Signs	Signature:	Signature: <i>AL 2/2/09</i>
PEDESTRIAN ACTIVITIES DISTRICT (P.A.D.)		
Action: <input type="checkbox"/> Approved <input type="checkbox"/> Approved w/Conditions <input type="checkbox"/> Denied		
Signature:		Date:

Permit Taken By: lmd	Date Applied For: 01/28/2009	Zoning Approval
-------------------------	---------------------------------	------------------------

- This permit application does not preclude the Applicant(s) from meeting applicable State and Federal Rules.
- Building permits do not include plumbing, septic or electrical work.
- Building permits are void if work is not started within six (6) months of the date of issuance. False information may invalidate a building permit and stop all work..

Special Zone or Reviews	Zoning Appeal	Historic Preservation
<input type="checkbox"/> Shoreland	<input type="checkbox"/> Variance	<input checked="" type="checkbox"/> Not in District or Landmark
<input type="checkbox"/> Wetland	<input type="checkbox"/> Miscellaneous	<input type="checkbox"/> Does Not Require Review
<input type="checkbox"/> Flood Zone	<input type="checkbox"/> Conditional Use	<input type="checkbox"/> Requires Review
<input type="checkbox"/> Subdivision	<input type="checkbox"/> Interpretation	<input type="checkbox"/> Approved
<input type="checkbox"/> Site Plan	<input type="checkbox"/> Approved	<input type="checkbox"/> Approved w/Conditions
Maj <input type="checkbox"/> Minor <input type="checkbox"/> MM <input type="checkbox"/>	<input type="checkbox"/> Denied	<input type="checkbox"/> Denied
OK Date: 1/29/09 <i>ABU</i>	Date:	Date: <i>ABU</i>

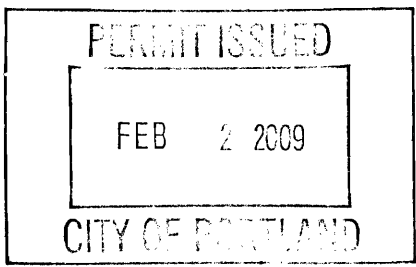

CERTIFICATION

I hereby certify that I am the owner of record of the named property, or that the proposed work is authorized by the owner of record and that I have been authorized by the owner to make this application as his authorized agent and I agree to conform to all applicable laws of this jurisdiction. In addition, if a permit for work described in the application is issued, I certify that the code official's authorized representative shall have the authority to enter all areas covered by such permit at any reasonable hour to enforce the provision of the code(s) applicable to such permit.

SIGNATURE OF APPLICANT	ADDRESS	DATE	PHONE
RESPONSIBLE PERSON IN CHARGE OF WORK, TITLE		DATE	PHONE

City of Portland, Maine - Building or Use Permit

389 Congress Street, 04101 Tel: (207) 874-8703, Fax: (207) 874-8716

Permit No: 09-0070	Date Applied For: 01/28/2009	CBL: 024 C001001
------------------------------	--	----------------------------

Location of Construction: 211 MARGINAL WAY	Owner Name: MARGINAL WAY PROPERTIES I	Owner Address: 555 WASHINGTON ST	Phone: 781-237-3677
Business Name:	Contractor Name: Burr Signs	Contractor Address: 50 DownEast Drive Yarmouth	Phone: (207) 799-1183
Lessee/Buyer's Name	Phone:	Permit Type: Signs - Permanent	

Proposed Use: Commercial AT&T Signs / Two Building Signs, and One Freestanding Signs	Proposed Project Description: Signs / Two Building Signs, and One Freestanding Signs
--	--

Dept: Zoning	Status: Approved	Reviewer: Ann Machado	Approval Date: 01/29/2009
Note: Permit #03-1362 allowed UPS Store to have two signs as long as they were under the max sf allowed. Permit #06-0948 allowed each of the three tenants to have a 32" x 32" panel in the freestanding sign. Ok to Issue: <input checked="" type="checkbox"/>			
Dept: Building	Status: Approved with Conditions	Reviewer: Chris Hanson	Approval Date: 02/02/2009
Note: Ok to Issue: <input checked="" type="checkbox"/>			
1) Separate permits are required for any electrical, plumbing, HVAC or exhaust systems. Separate plans may need to be submitted for approval as a part of this process.			
2) Signage Installation to comply with Chapter 31 of the IBC 2003 building code.			

Comments:
1/29/2009-amachado: Spoke to Randy Burr. The proposed panel in the freestanding sign is too big. Permit #06-0948 limited each tenant panel to 32" x 32". Since AT &T is occupying two tenant spaces their sign can be 32" x 64" but the proposed sign is 34" x 73". Randy will submit a revised sign.
1/29/2009-amachado: Received revised plan for panel in freestanding sign.

BUILDING PERMIT INSPECTION PROCEDURES

Please call 874-8703 or 874-8693 (ONLY)

to schedule your inspections as agreed upon

Permits expire in 6 months, if the project is not started or ceases for 6 months.

The Owner or their designee is required to notify the inspections office for the following inspections and provide adequate notice. Notice must be called in 48-72 hours in advance in order to schedule an inspection:

By initializing at each inspection time, you are agreeing that you understand the inspection procedure and additional fees from a "Stop Work Order" and "Stop Work Order Release" will be incurred if the procedure is not followed as stated below.

A Pre-construction Meeting will take place upon receipt of your building permit.

 X **Final inspection required at completion of work.**

Certificate of Occupancy is not required for certain projects. Your inspector can advise you if your project requires a Certificate of Occupancy. All projects DO require a final inspection.

If any of the inspections do not occur, the project cannot go on to the next phase, REGARDLESS OF THE NOTICE OR CIRCUMSTANCES.

CERIFICATE OF OCCUPANICES MUST BE ISSUED AND PAID FOR, BEFORE THE SPACE MAY BE OCCUPIED.

Signature of Applicant/Designee

Date

Signature of Inspections Official

Date



Signage/Awning Permit Application

If you or the property owner owes real estate or personal property taxes or user charges on any property within the City, payment arrangements must be made before permits of any kind are accepted.

Location/Address of Construction: <u>211 MARGINAL WAY</u>		
Tax Assessor's Chart, Block & Lot Chart# Block# Lot#	Owner: <u>MURPHY/JOEL TRAUUM</u> <u>781-237-3677</u>	Telephone: <u>781-237-3677</u>
Lessee/Buyer's Name (If Applicable) <u>AT&T</u>	Contractor name, address & telephone: <u>ZWAR SIGNS</u> <u>50 DOWNEAST DR.</u> <u>YARMOUTH, ME 04096</u> <u>207-846-7622</u>	Total s.f. of signage x \$2.00 <u>114</u> Per s.f. plus \$30.00/\$65.00 For H.D. signage= Total Fee: \$ <u>258.00</u> Awning Fee= cost of work _____ Total Fee: \$ _____
Who should we contact when the permit is ready: <u>PAUDY BURE</u> phone: <u>846-7622</u>		
Tenant/allocated building space frontage (feet): Length: <u>170'</u> Height: <u>20'-6"</u> Lot Frontage (feet) <u>2300</u> Single Tenant or Multi Tenant Lot <u>M</u>		
Current Specific use: <u>retail - VPS signs; Budget Blinds</u> If vacant, what was prior use: <u>RETAIL</u> Proposed Use: <u>RETAIL - AT&T</u>		
Information on proposed sign(s): Freestanding (e.g., pole) sign? Yes <u>X1</u> No _____ Dimensions proposed: <u>6'-1.25" x 2'-7"</u> Height from grade: <u>(13)</u> Bldg. wall sign? (attached to bldg) Yes <u>X2</u> No _____ Dimensions proposed: <u>4'-6" x 14'-3"</u> sign height is 27.5'		
Proposed awning? Yes _____ No <u>X</u> Is awning backlit? Yes _____ No _____ Height of awning: _____ Length of awning: _____ Depth: _____ Is there any communication, message, trademark or symbol on it? Yes _____ No _____ If yes, total s.f. of panels w/communications, message, trademark or symbol: _____ s.f.		
Information on existing and previously permitted sign(s): Freestanding (e.g., pole) sign? Yes _____ No _____ Dimensions: _____ Bldg. wall sign? (attached to bldg) Yes _____ No _____ Dimensions: _____ Awning? Yes _____ No _____ Sq. ft. area of awning w/communication: _____ JAN 20 2009		
A site sketch and building sketch showing exactly where existing and new signage is located must be provided. Sketches and/or pictures of proposed signage and existing building are also required.		

Please submit all of the information outlined in the Sign/Awning Application Checklist. Failure to do so may result in the automatic denial of your permit.

In order to be sure the City fully understands the full scope of the project, the Planning and Development Department may request additional information prior to the issuance of a permit. For further information visit us on-line at www.portlandmaine.gov, stop by the Building Inspections office, room 315 City Hall or call 874-8703.

I hereby certify that I am the Owner of record of the named property, or that the owner of record authorizes the proposed work and that I have been authorized by the owner to make this application as his/her authorized agent. I agree to conform to all applicable laws of this jurisdiction. In addition, if a permit for work described in this application is issued, I certify that the Code Official's authorized representative shall have the authority to enter all areas covered by this permit at any reasonable hour to enforce the provisions of the codes applicable to this permit.

Signature of applicant: [Signature]

Date: 01-26-08

B-7 multi-tenant

This is not a permit; you may not commence ANY work until the permit is issued.

SIGNAGE/AWNING PRE-APPLICATION QUESTIONNAIRE

PLEASE ANSWER ALL QUESTIONS

ADDRESS: 211 MARGINAL WAY ZONE: _____

CBL: _____

SINGLE TENANT LOT? YES _____ NO X MULTI TENANT LOT? YES X NO _____
MORE THAN ONE SIGN TOTAL WITH PROPOSED SIGN? YES X NO 3

INFORMATION ON PROPOSED SIGN(S):

FREESTANDING (e.g., pole) SIGN? YES X NO _____ DIMENSIONS PROPOSED: 6'-1" x 2'-1"
BLDG. WALL SIGN? (attached to bldg) YES X NO _____ DIMENSIONS PROPOSED: 4'-8" x 14'-3"

INFORMATION ON ALREADY EXISTING AND PERMITTED SIGN(S):

FREESTANDING (e.g., pole) SIGN? YES _____ NO _____ DIMENSIONS: _____
BLDG. WALL SIGN(attached to bldg) ? YES _____ NO _____ DIMENSIONS: _____
AWNING? YES _____ NO _____ DIMENSIONS: _____

LOT FRONTAGE (FEET): 7300'
TENANT/ALLOCATED BUILDING SPACE FRONTAGE (FEET): 170' - 90' on Marginal Way

AWNING YES _____ NO _____ IS AWNING BACKLIT? YES _____ NO _____

HEIGHT OF AWNING: _____ LENGTH OF AWNING: _____ DEPTH: _____

IS THERE ANY COMMUNICATION, MESSAGE, TRADEMARK OR SYMBOL ON IT? YES _____ NO _____

IF YES, TOTAL S.F. OF PANELS WITH COMMUNICATIONS/MESSAGE/TRADEMARK/SYMBOL? _____ s.f.

A SITE SKETCH AND BUILDING SKETCH SHOWING EXACTLY WHERE EXISTING AND NEW SIGNAGE IS LOCATED MUST BE PROVIDED. SKETCHES AND/OR PICTURES OF PROPOSED SIGNAGE ARE ALSO REQUIRED.

SIGNATURE OF APPLICANT: [Signature] DATE: 01-26-08

***** FOR OFFICE USE ONLY *****
B-7- mult-tenant.
90x2 = 180 sq ft
* UPS sign allowed frontage sign to be split - see letter from Maze 3/29/05.
- total sf. of each building sign = 66.35' x 2 = 132.7 sq ft
ok
freestanding sign - each tenant allowed 32"x32" panel - AT&T occupies 2 tenant spaces
permit 06 0448 Can have 32"x64"
revised proposal - rec'd 1/25/09 meets dimensions ok



Strengthening a Remarkable City, Building a Community for Life • www.portlandmaine.gov

*Lee Urban- Director of Planning and Development
Marge Schmuckal, Zoning Administrator*

March 29, 2005

Shane Moffett
Neokraft Signs, Inc.
686 Main Street
Lewiston, ME 04024

RE: 211 Marginal Way – 024-C-001 – B-5 Zone – Application #05-0305

Dear Shane,

I am in receipt of your sign application to add a third building sign for the UPS Store business located at the above location. Your permit is being denied because it is not meeting the B-5 Zone sign requirements. Table 2.8 of the sign ordinance allows only one sign per tenant unless that individual tenant fronts on more than one street. The UPS Store tenancy fronts on only one street, Marginal Way. This office has allowed their frontage signage to be split in order to have signage over the main side entry. The rear of their tenancy does not abut a street and is therefore not entitled to have signage on the rear of their building. ✖ #03-1362

Presently there is also a panel sign for the UPS Store on the common free standing sign located on the corner of Marginal Way and Franklin Arterial.

If you have any questions regarding this matter, please do not hesitate to call. It is possible to get a refund of your fee. The City usually holds back 10%. It will be necessary to bring in your original receipt to the front inspections desk to request a refund.

Very truly yours,

Marge Schmuckal
Zoning Administrator

Cc: Deb Andrews, Planning
File

#06-0948

TFH ARCHITECTS 100 COMMERCIAL STREET PORTLAND MAINE 04101 TELEPHONE 207-775-6141 ARCHITECTURE AND PLANNING

June 14, 2006

Deb Andrews
Historic Preservation Manager
City of Portland
389 Congress Street
Portland, ME 04101

Re: Signage / 211 Marginal Way

Dear Deb,

Please find enclosed a revised elevation showing the proposed sign for 211 Marginal Way, which has been reduced in height by 12" in relationship to the building at Plant Dog's entrance. You will note that the top of the sign is now approximately 6" lower than the top of the gravel stock. I have also indicated on the drawing that the tenant signs will "fit within a 32 inch x 32 inch" zone. Also enclosed is a completed the Signage /Awning Permit Application with accompanying check for permit fees.

Hopefully this will provide you with all information that is necessary to process the request. Please do not hesitate to give me a call if you have any questions.

Sincerely,



T. Scott Teas, NCARB, AIA
Principal

32" x 64"

32" x 5'4"

2'8" x 5'4"

#06-0948

© 2006 TFH ARCHITECT'S

BAYSIDE EAST TENANT SIGN
PORTLAND, MAINE

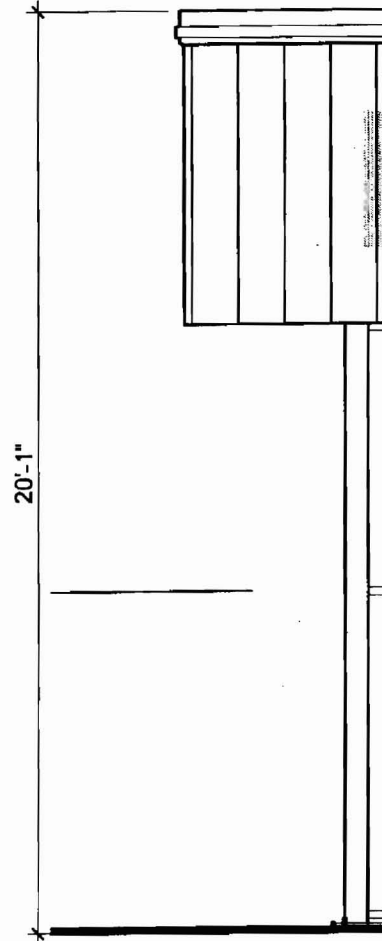
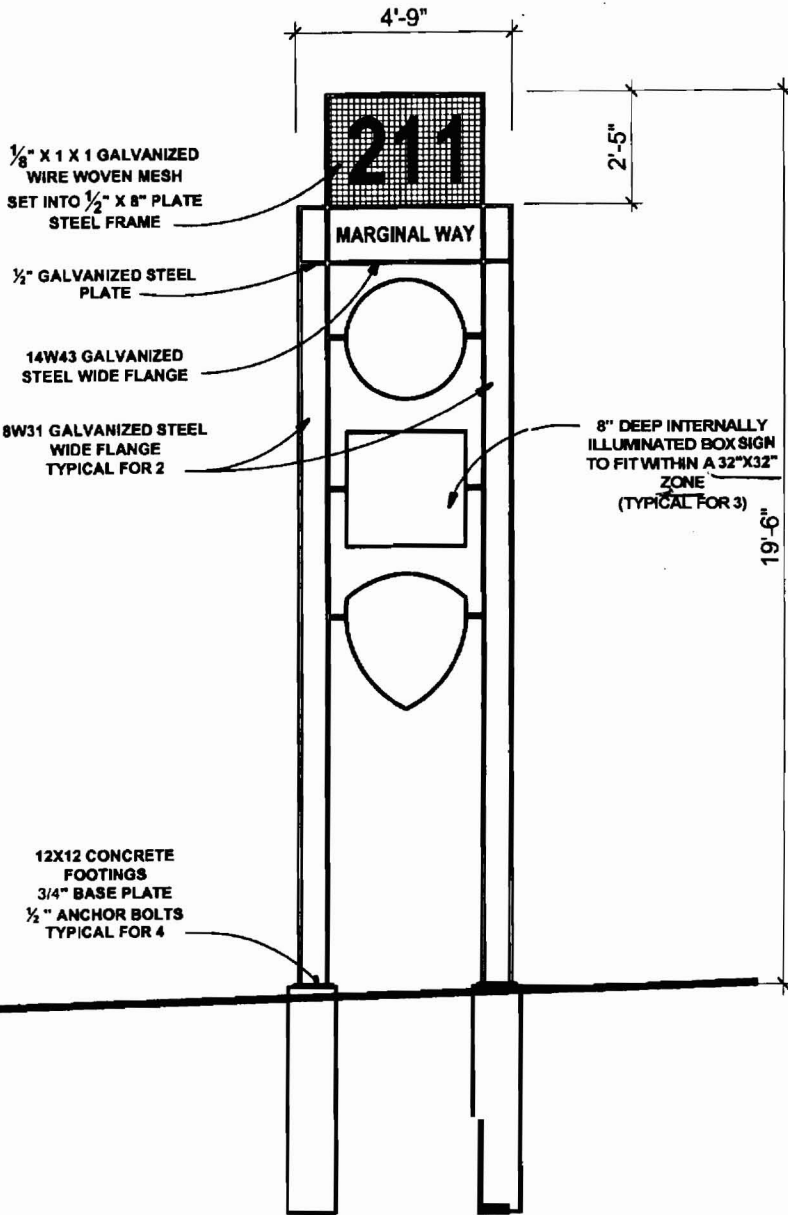

TFH ARCHITECT: 3
100 COMMERCIAL STREET
PORTLAND MAINE 04101
TELEPHONE 207 775 6141
ARCHITECTURE PLANNING

CONSULTANTS:

DATE: 04/28/06
PROJECT NO: 0219
DRAWN BY: TST
CHECKED BY:
SCALE: AS NOTED

SHEET TITLE:
SIGN ELEVATION

REVISED 6/11/06



ASK
I

AUTHORIZATION AND CONSENT FORM



Owner's Name: MARGINAL WAY PROPERTIES

Owner's Address: 555 WASHINGTON ST (#5)
WELLESLEY MA 02482

Telephone Number: 781.237.3677

Leased Premises: SS#: 24591
At&t Market Direct
211 Marginal Way
Portland, ME

Re: AT&T's Signage

To Whom It May Concern:

I am a duly authorized representative of MARGINAL WAY PROPERTIES, INC, the Landlord/Owner at the referenced lease premises.

In my capacity as Landlord's official representative, I do hereby authorize Service Select Signs and its contractors to perform all work associated with at&t's new signage program. I further authorize Service Select Signs and its representatives to obtain all permits associated with this signage program, as hereby consented to by Landlord.

Landlord/Owner:

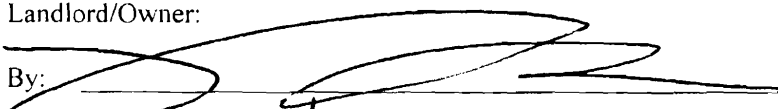
By:  RUSIAW

Date: 7/31/00

Please Fax directly to: 215-788-7588, Attn: Justin Lavinsky

Or mail to: Attn: Justin Lavinsky
Landlord Coordination Department
Service Select, Inc
400 Mack Drive
Croydon, PA 19021

Thank you



EXISTING ELEVATION

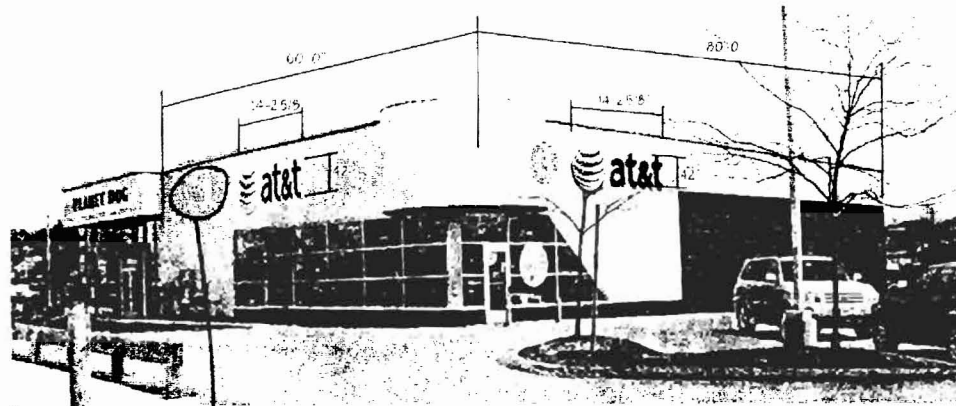

PROPOSED ELEVATION

PRELIMINARY DRAWING
NOT FOR FABRICATION
(field verify dimensions & conditions)

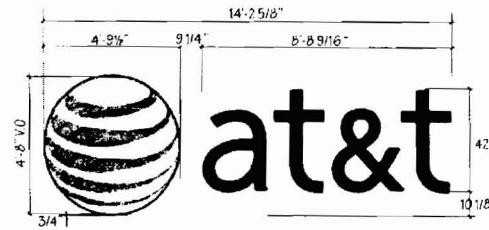

LIF-BLK-42-H
scale 1/4" = 1'

DATE	BY
06/10/06	MJD

- 1. FABRICATE & INSTALL STANDARD SET OF DAY NIGHT AT&T CHANNEL LETTERS AND FACE LIT GLOBE LOGO TO STORE WHERE INDICATED
- 2. INSTALL NEW V-1 WINDOW VINYL
- 3. FABRICATE & INSTALL STANDARD SET OF DAY NIGHT AT&T CHANNEL LETTERS AND FACE LIT GLOBE LOGO TO STORE WHERE INDICATED



**SERVICE
SELECT
SIGNS**

440 MAACK DRIVE
DUNDON, PA 19621
PH: 717-486-0808
FAX: 717-753-0844

CLIENT:



LOCATION:
AT&T MARKET DIRECT COR
211 Marginal Way
Portland ME 04101

SS# 24591R2

SITE I.D. #:

DESCRIPTION:
ELEVATION

SCALE: AS INDICATED

DRAWN BY: MJD

DATE: 7/24/08

REVISION:

1	7/25/08 MJD
2	7/30/08 MJD
3	
4	
5	
6	
7	
8	

CHANGE MADE ON REV:

VOLTAG:

ALLOWABLE SQ. FT.:

PROPOSED SQ. FT.:

THIS DRAWING IS SUBMITTED FOR YOUR REVIEW AND USE IN CONNECTION WITH A PROJECT BEING HANDLED BY SERVICE SELECT SIGNS. IT IS NOT TO BE REPRODUCED OR COPIED OR TRANSMITTED IN ANY FORM OR BY ANY MEANS, WITHOUT THE EXPRESS WRITTEN PERMISSION OF SERVICE SELECT SIGNS, INC.

Page 1 of 5

REVISION APPROVED BUT NOT IN ALL STORES

[Handwritten Signature] 7/31/08



PROPOSED REAR ELEVATION

PRELIMINARY DRAWING
NOT FOR FABRICATION
(field verify dimensions & conditions)

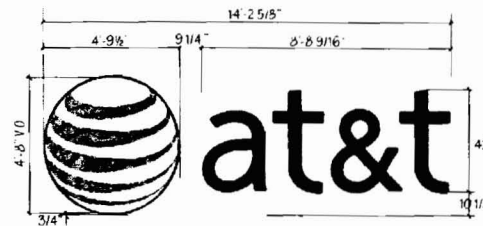

LIF-BLK-42-H
scale 1/4" = 1'

DATE	BY
7/25/08	MJD

FABRICATE & INSTALL STANDARD SET OF DAY NIGHT
AT&T CHANNEL LETTERS AND FACE LIT GLOBE LOGO
TO STORE WHERE INDICATED

NO PRIME

[Signature] 7/31/08

SERVICE SELECT SIGNS

4000 MAJOR DRIVE
CROFTON, PA 19027
PH: 215-484-9599
FAX: 215-763-3840

CLIENT
at&t

LOCATION
AT&T MARKET DIRECT COR
211 Marginal Way
Portland, ME 04101

SS# 24591R2

SITE I.D. #:

DESCRIPTION
ELEVATION

SCALE: AS INDICATED

DRAWN BY: MJD

DATE: 7/24/08

REVISION:

1	7/25/08 MJD
2	7/28/08 MJD
3	
4	
5	
6	
7	
8	

CHANGE MADE ON REV:

VOLTAGE:

ALLOWABLE SQ. FT.:

PROPOSED SQ. FT.:

THIS DRAWING IS SUBMITTED FOR YOUR EXCLUSIVE USE IN CONNECTION WITH A PROJECT BEING PLANNED BY SERVICE SELECT, INC. IT IS NOT TO BE REPRODUCED OR COPIED IN ANY MANNER WITHOUT YOUR WRITTEN CONSENT. IT IS TO BE USED ONLY FOR THE PROJECT AND NOT FOR ANY OTHER PROJECT. IT IS TO BE DESTROYED IMMEDIATELY UPON COMPLETION OF THE PROJECT.

WE TRUST THE QUALITY OF OUR WORK.

Page 2 of 5

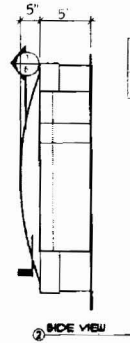
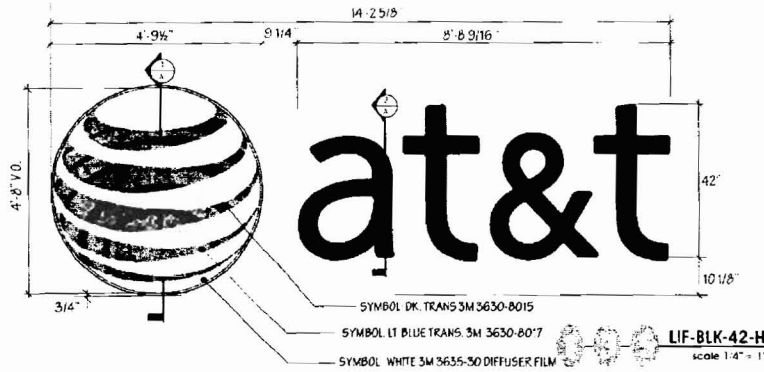

ROLED SQUARE FOOTAGE	EACH WARD SQUARE FOOTAGE
66 8 5F	48 15 5F

GENERAL NOTES

ALL PAINTS TO BE 2-PART POLY-URETHANE BY MATTHEWS GLOSS FINISH
 ALL FILM TO BE 3M UNLESS OTHERWISE STATED
 ALL STEEL COMPONENTS TO BE PRIMED WITH ZINC PHOSPHATE (DILCON-2) OR APPROVED EQUIVALENT
 ALL STRUCTURAL COMPONENTS TO BE ZINC BY LICENSED STRUCTURAL ENGINEER TO MEET OR EXCEED ALL LOCAL, STATE & NATIONAL CODES
 ALL ELECTRICAL WORK TO MEET OR EXCEED I.L.L. REQUIREMENTS
 ALL EXPOSED FASTENERS TO BE PAINTED TO MATCH CABINET
 ELECTRICAL LEADS FROM THE BACK OF ILLUMINATED LETTERS TO BE MINIMUM OF 6" LONG AS MEASURED FROM THE BACK OF LETTER

MATERIAL SPECIFICATIONS

AT&T BLUE - MATTHEWS MP0090
 SILVER - MATTHEWS 41 342 BRUSHED ALUM.
 BLACK - MATTHEWS N925
 WHITE - MATTHEWS 64255P
 DARK GRAY - MATTHEWS MP0534
 VINYL
 SYMBOL DK. TRANS 3M 3630-8015
 SYMBOL LT. BLUE TRANS 3M 3630-807
 SYMBOL WHITE 3M 3635-50 DIFFUSER FILM
 PERFORATED BLACK - 3M 3635-222
 DAY/NIGHT - 3M 3635-91
 SECONDARY LETTERING - BLACK REFLECTIVE VINYL 3M #660-85
 ACRYLIC - ARISTECH 7328 MATTED WHITE FINISH OR APPROVED EQ.
 MOLDED DOME - ARISTECH ACRYLIC STEEL CLEAR SG OR APPROVED EQ.

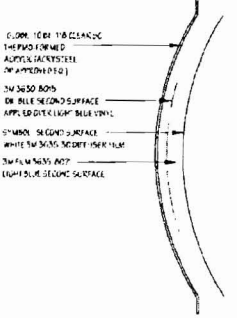
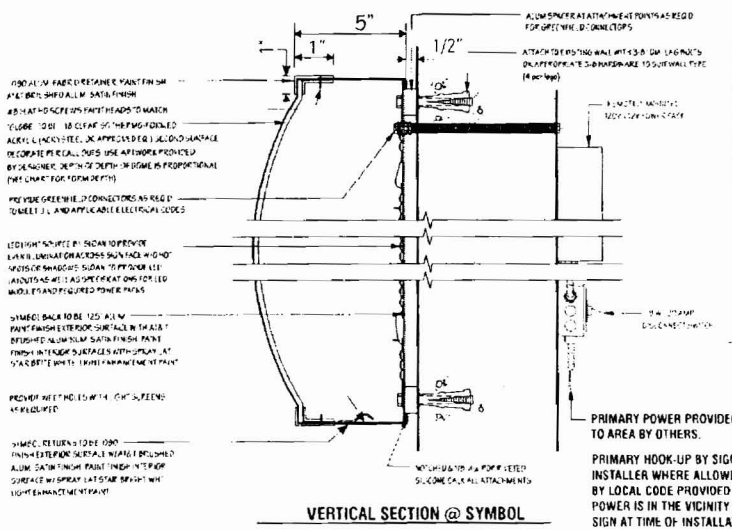

SYMBOL VINYL APPLICATION

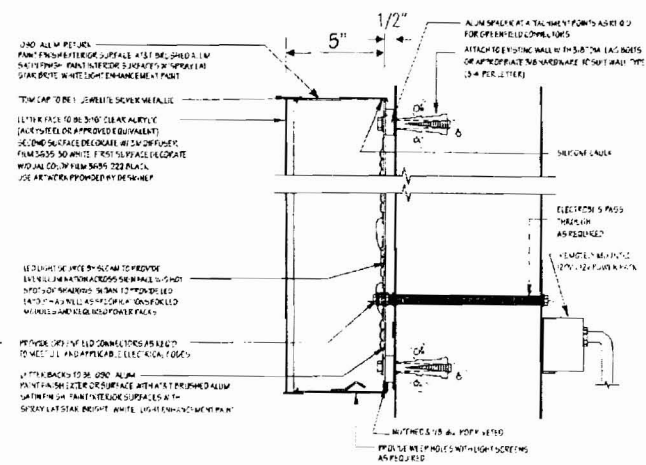

VERTICAL SECTION BLACK LETTERS

[Handwritten signature]
 7/31/02

SERVICE SELECT SIGNS

200 MARK DRIVE
 CHAS. RICH. BLDG.
 141 215 2RD 30599
 FAY. 215 285 3074

CLIENT

LOCATION
 AT&T MARKET DIRECT COR.
 211 Marginal Way
 Portland, ME 04101

SS# 24591R2

SITE I.D. #:

DESCRIPTION
 SIGN DETAILS

SCALE AS INDICATED

DRAWN BY MJD

DATE 7/24/02

REVISION:

1/25/02 MJD
 7/28/02 MJD

CHANGE MADE ON REV:

VOLTAGE:

ALLOWABLE SQ. FT.:

PROPOSED SQ. FT.:

THIS DRAWING IS SUBMITTED FOR YOUR REVIEW. THE CONNECTION WITH A PROJECT BEING HANDLED BY SERVICE SELECT, INC. IT IS NOT TO BE USED TO ANY OTHER PROJECT WITHOUT THE WRITTEN CONSENT OF SERVICE SELECT, INC. TO BE USED, REPRODUCED, COPIED OR EXEMPTED IN ANY MANNER WITHOUT THE EXPRESS WRITTEN PERMISSION OF SERVICE SELECT, INC.

Page 3 of 5



EXISTING D/F PYLON



PROPOSED D/F PYLON

- REMOVE EXISTING (2) D/F ILLUMINATED SIGN CABINETS
- FABRICATE & INSTALL D/F ILLUMINATED SIGN CABINET PAINTED BLACK
- WHITE LEXAN FACE
- BACKGROUND TO BE 3M FILMS ORANGE 3632-84 "TANGERINE"
- GLOBE GRAPHIC TO BE FIRST SURFACE APPLIED 600 DPI DIGITALLY
- PRINTED VINYL. (VINYL GRAPHIC SHALL PROVIDED BY AT&T APPROVED VENDER ONLY)
- "AT&T" COPY WHITE

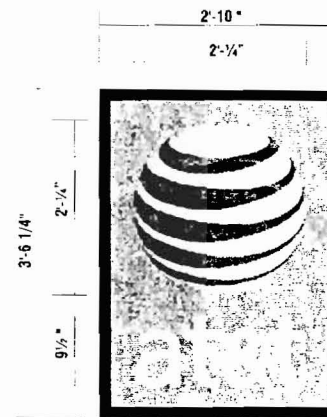

SIGN FACE ELEVATION
scale 3/4" = 1'

PRELIMINARY DRAWING
NOT FOR FABRICATION
(field verify dimensions & conditions)

Approved
[Signature]
7/31/00

**SERVICE
SELECT
SIGNS**

400 MARK DRIV
ORONO ME 04471
144 715-6888
FAX 215-749-3870

CLIENT

LOCATION:
AT&T MARKET DIRECT COR
211 Marginal Way
Portland, ME 04101

SS# 24591R2

SITE I.D. #

DESCRIPTION:
SIGN DETAILS

SCALE: AS INDICATED

DRAWN BY: MJD

DATE: 7/24/00

REVISION:

1	7/25/00 MJD
2	7/28/00 MJD
3	
4	
5	
6	
7	
8	

CHANGE MADE ON REV:

VOLTAGE:

ALLOWABLE SQ. FT.:

PROPOSED SQ. FT.:

THIS DRAWING IS SUBMITTED FOR YOUR EXCLUSIVE USE IN CONNECTION WITH A PROJECT BEING HANDLED BY SERVICE SELECT, INC. IT IS NOT TO BE REPRODUCED OR COPIED BY ANY OTHER ORGANIZATION NOR IS IT TO BE USED IN ANY MANNER WITHOUT THE EXPRESS WRITTEN PERMISSION OF SERVICE SELECT, INC.

Page 4 of 5



SERVICE SELECT SIGNS

400 SOUTH BRISTOL
CHOWDEN, PA 19021
PH: 215 789-0899
FAX: 215 789-0870

CLIENT
at&t

LOCATION
AT&T MARKET DIRECT COR
211 Marginal Way
Portland, ME 04101

SS# 24591R2

SITE I.D. #:

DESCRIPTION
SIGN DETAILS

SCALE: AS INDICATED

DRAWN BY: MJD

DATE: 7/24/08

REVISION:

1	7/26/08 MJD
2	7/28/08 MJD
3	
4	
5	
6	
7	
8	

CHANGE MADE ON REV:

VOLTAJE:

ALLOWABLE SQ. FT.:

PROPOSED SQ. FT.:

THIS DRAWING IS SUBMITTED TO YOU EXCLUSIVE USE IN CONNECTION WITH A PROJECT BEING PLANNED BY SERVICE SELECT, INC. IT IS NOT TO BE REPRODUCED OR USED OUTSIDE YOUR ORGANIZATION WITHOUT THE WRITTEN PERMISSION OF SERVICE SELECT, INC. WITHOUT THE EXPRESS PERMISSION OF SERVICE SELECT, INC.

Page 5 of 5

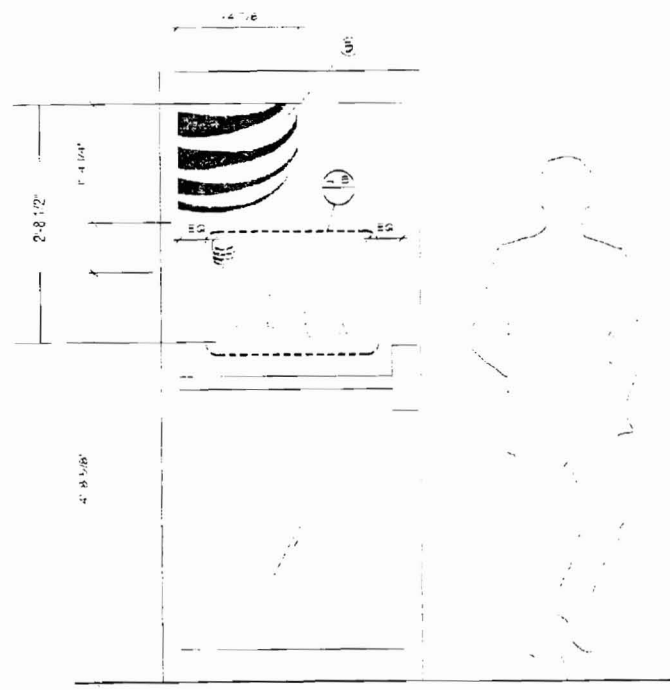

TYPICAL INSTALL SCALE: 3/4" = 1'-0"

TO MAINTAIN CONSISTENCY THROUGH OUT SIGN PROGRAM 3-4 GLOBE GRAPHIC SHALL BE FABRICATED SOLELY BY:

Corporate Identification Solutions (CIS)
Contact: Ben DeHayes
773-763-9600
5308 N. Northwest Highway
Chicago, IL 60630

APPLY VINYL ON OUTSIDE OF GLASS. (1st SURFACE)

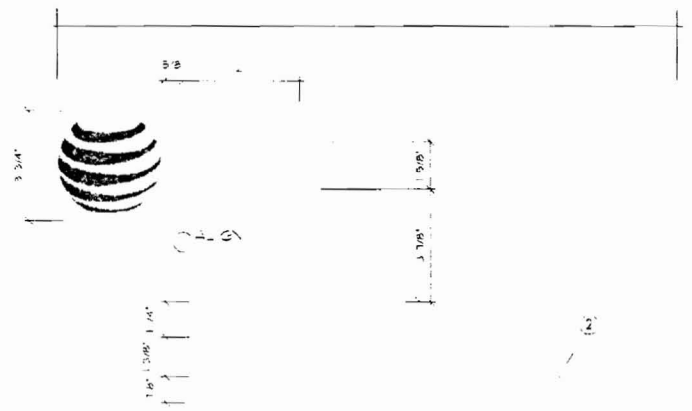

V-1 WINDOW VINYL WHITE COPY SCALE: 3/4" = 1'-0"

Window vinyl: Standard White Letter (2" High) (2.1x)
WHITE CHROME POLYURETHANE V-1 WINDOW VINYL (2" HIGH) (2.1x)

INSTALL NEW V-1 WINDOW VINYL

Holidays
Closed



7/31/08

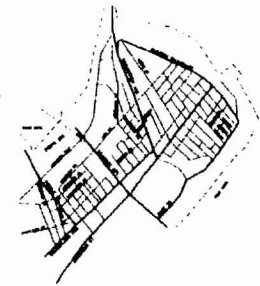
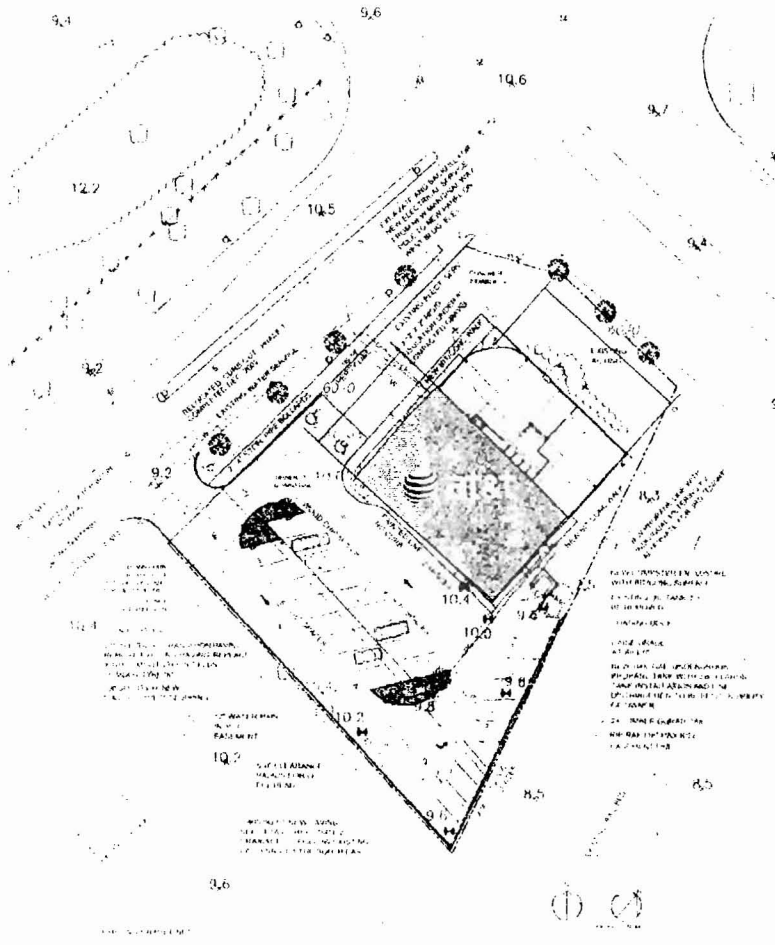

LOCATION MAP
1" = 1000'

SITE PLAN

- LEGEND
- 1. EXISTING DRIVE
 - 2. NEW DRIVE
 - 3. EXISTING SIDEWALK
 - 4. NEW SIDEWALK
 - 5. EXISTING SIDEWALK
 - 6. NEW SIDEWALK
 - 7. EXISTING DRIVE
 - 8. NEW DRIVE
 - 9. EXISTING SIDEWALK
 - 10. NEW SIDEWALK
 - 11. EXISTING SIDEWALK
 - 12. NEW SIDEWALK
 - 13. EXISTING DRIVE
 - 14. NEW DRIVE
 - 15. EXISTING SIDEWALK
 - 16. NEW SIDEWALK
 - 17. EXISTING DRIVE
 - 18. NEW DRIVE
 - 19. EXISTING SIDEWALK
 - 20. NEW SIDEWALK
 - 21. EXISTING DRIVE
 - 22. NEW DRIVE
 - 23. EXISTING SIDEWALK
 - 24. NEW SIDEWALK
 - 25. EXISTING DRIVE
 - 26. NEW DRIVE
 - 27. EXISTING SIDEWALK
 - 28. NEW SIDEWALK
 - 29. EXISTING DRIVE
 - 30. NEW DRIVE
 - 31. EXISTING SIDEWALK
 - 32. NEW SIDEWALK
 - 33. EXISTING DRIVE
 - 34. NEW DRIVE
 - 35. EXISTING SIDEWALK
 - 36. NEW SIDEWALK
 - 37. EXISTING DRIVE
 - 38. NEW DRIVE
 - 39. EXISTING SIDEWALK
 - 40. NEW SIDEWALK
 - 41. EXISTING DRIVE
 - 42. NEW DRIVE
 - 43. EXISTING SIDEWALK
 - 44. NEW SIDEWALK

[Handwritten Signature]
7/31/08



**SERVICE
SELECT
SIGNS**

430 MAIN DRIVE
ORFORD, NH 03824
PH: 603.999.1999
FAX: 603.999.3677

CLIENT



LOCATION:
AT&T MARKET DIRECT COR
211 Marginal Way
Portland, ME 04101

SS# 2459182

SITE I.D. #:

DESCRIPTION:
SIGN DETAILS

SCALE: AS INDICATED

DRAWN BY: MJD

DATE: 7.24.08

REVISION:

1	7/25/08 MJD
2	7/30/08 MJD
3	
4	
5	
6	

CHANGE MADE ON REV:

VOLTAGE:

ALLOWABLE SQ. FT.:

PROPOSED SQ. FT.:

THIS DRAWING IS SUBMITTED FOR YOUR EXCLUSIVE USE IN CONNECTION WITH A PROJECT BEING PLANNED BY SERVICE SELECT SIGNS. IT IS NOT TO BE REPRODUCED, COPIED, OR OTHERWISE USED IN ANY MANNER WITHOUT THE WRITTEN PERMISSION OF SERVICE SELECT SIGNS.

SITE PLAN



SIGNAGE LEASE EXHIBIT

LOCATION:

Construction I.D. _____
Brand Name: AT&T MARKET DIRECT
Address: _____
Street 211 MARGINAL WAY
City PORTLAND
State ME 04101

LANDLORD CONTACTS:

Developer MWP INC.
Contact JOEL TRANUM
Phone 781-237-3677

LANDLORD CRITERIA:

Front Elev.: FOLLOW LOCAL CODE

Rear Elev.: N/A
Side Elev.: FOLLOW LOCAL CODE

Under Canopy/Blade Sign: N/A
Pylon/Monument: YES AVAILABLE

TOWNSHIP CONTACT INFO:

Township Name CITY OF PORTLAND

Contact Person: ANN MACHADO
Address: _____
Street: CITY HALL ROOM 315
City: PORTLAND
State: ME
Phone: 781-874-8703

BROKER INFO:

JOEL REICHMAN
978-681-8997

ARCHITECT INFO:

Callison
206-623-4646

SIGN CODE ALLOWANCE:

ZONED B7 MULTI TENANT
BOX ENTIRE COPY 2 SQ/FT PER LINEAR FOOT OF FASCIA SIGN IS MOUNTED TO
FRONT 60' X 2 ALLOWS FOR 120 SQ/FT OF SIGN
SIDE 80' X 2 ALLOWS FOR 160 SQ/FT OF SIGN
REAR 60' X 2 ALLOWS FOR 120 SQ/FT OF SIGN

NOTICE:

THIS EXHIBIT IS FOR LEASE AGREEMENT PURPOSES ONLY. THE ATTACHED DRAWINGS ARE NOT FOR FABRICATION AND ARE SUBJECT TO ALL LOCAL, CITY AND STATE APPROVALS

ALL BUILDING FACADE COLORS MUST BE FIELD VERIFIED AND CHANNEL LETTER FACE COLORS APPROVED BY AT&T BEFORE FABRICATION

CUSTOMER APPROVAL:

DRAWING # SS24591R2 DATE: 7/30/08
REF. DWG # _____ DATE: _____

PREPARED FOR:

Chad Lovett

MARSH

CERTIFICATE OF INSURANCE

CERTIFICATE NUMBER
CHI-002168373-01

PRODUCER

Marsh USA Inc.
701 Market Street
Suite 1100
St. Louis, MO 63101
Attn: ATT.CertRequest@marsh.com

THIS CERTIFICATE IS ISSUED AS A MATTER OF INFORMATION ONLY AND CONFERS NO RIGHTS UPON THE CERTIFICATE HOLDER OTHER THAN THOSE PROVIDED IN THE POLICY. THIS CERTIFICATE DOES NOT AMEND, EXTEND OR ALTER THE COVERAGE AFFORDED BY THE POLICIES DESCRIBED HEREIN.

COMPANIES AFFORDING COVERAGE

- COMPANY
A National Union Fire Ins Co Pittsburgh PA
- COMPANY
B New Hampshire Insurance Company
- COMPANY
C Illinois National Ins Co
- COMPANY
D

018566-GAW-CRT-08-09

N

INSURED

AT&T Inc. and Subsidiaries
AT&T Mobility LLC
One AT&T Plaza
208 South Akard
Dallas, TX 75202

COVERAGES

This certificate supersedes and replaces any previously issued certificate for the policy period noted below. 2

THIS IS TO CERTIFY THAT POLICIES OF INSURANCE DESCRIBED HEREIN HAVE BEEN ISSUED TO THE INSURED NAMED HEREIN FOR THE POLICY PERIOD INDICATED. NOTWITHSTANDING ANY REQUIREMENT, TERM OR CONDITION OF ANY CONTRACT OR OTHER DOCUMENT WITH RESPECT TO WHICH THE CERTIFICATE MAY BE ISSUED OR MAY PERTAIN, THE INSURANCE AFFORDED BY THE POLICIES DESCRIBED HEREIN IS SUBJECT TO ALL THE TERMS, CONDITIONS AND EXCLUSIONS OF SUCH POLICIES. AGGREGATE LIMITS SHOWN MAY HAVE BEEN REDUCED BY PAID CLAIMS.

CO LTR	TYPE OF INSURANCE	POLICY NUMBER		POLICY EFFECTIVE DATE (MM/DD/YY)	POLICY EXPIRATION DATE (MM/DD/YY)	LIMITS	
A	GENERAL LIABILITY	GL9723024	(AOS)	06/01/08	06/01/09	GENERAL AGGREGATE	\$ 10,000,000
	<input checked="" type="checkbox"/> COMMERCIAL GENERAL LIABILITY					PRODUCTS - COMP/OP AGG	\$ 1,000,000
	<input type="checkbox"/> CLAIMS MADE <input checked="" type="checkbox"/> OCCUR					PERSONAL & ADV INJURY	\$ 1,000,000
	<input type="checkbox"/> OWNER'S & CONTRACTOR'S PROT					EACH OCCURRENCE	\$ 1,000,000
						FIRE DAMAGE (Any one fire)	\$ 1,000,000
						MED EXP (Any one person)	\$ 10,000
A A A	AUTOMOBILE LIABILITY	CA1607582	(AOS)	06/01/08	06/01/09	COMBINED SINGLE LIMIT	\$ 1,000,000
	<input checked="" type="checkbox"/> ANY AUTO	CA1607583	(VA)	06/01/08	06/01/09		
	<input type="checkbox"/> ALL OWNED AUTOS <input type="checkbox"/> SCHEDULED AUTOS <input type="checkbox"/> HIRED AUTOS <input type="checkbox"/> NON-OWNED AUTOS	CA1607584	(MA)	06/01/08	06/01/09	BODILY INJURY (Per person)	\$
						BODILY INJURY (Per accident)	\$
						PROPERTY DAMAGE	\$
	GARAGE LIABILITY					AUTO ONLY - EA ACCIDENT	\$
	<input type="checkbox"/> ANY AUTO					OTHER THAN AUTO ONLY:	
						EACH ACCIDENT	\$
						AGGREGATE	\$
	EXCESS LIABILITY					EACH OCCURRENCE	\$
	<input type="checkbox"/> UMBRELLA FORM					AGGREGATE	\$
	<input type="checkbox"/> OTHER THAN UMBRELLA FORM						\$
B B C C	WORKERS COMPENSATION AND EMPLOYERS' LIABILITY	WC3621165	(AOS)	06/01/08	06/01/09	<input checked="" type="checkbox"/> WC STATUTORY LIMITS	OTHER
		WC3621166	(CA)	06/01/08	06/01/09	EL EACH ACCIDENT	\$ 1,000,000
	<input checked="" type="checkbox"/> THE PROPRIETOR/ PARTNERS/EXECUTIVE OFFICERS ARE:	WC3621167	(FL)	06/01/08	06/01/09	EL DISEASE-POLICY LIMIT	\$ 1,000,000
	<input type="checkbox"/> INCL <input type="checkbox"/> EXCL	WC3621168	(IL,MI)	06/01/08	06/01/09	EL DISEASE-EACH EMPLOYEE	\$ 1,000,000
C B B B	OTHER WORKERS' COMPENSATION	WC3621169	(MA,NY)	06/01/08	06/01/09	W/C Statutory Limits	
		WC3621170	(VI)	06/01/08	06/01/09	EL Each Accident	1,000,000
		WC3621171	(OR)	06/01/08	06/01/09	EL Disease-Policy Limit	1,000,000
		WC3621172	(TX)	06/01/08	06/01/09	EL Disease- Each Employee	1,000,000

DESCRIPTION OF OPERATIONS/LOCATIONS/VEHICLES/SPECIAL ITEMS

Re: Planet Dog Center, ID # 136293, Project # 2056000200.
Portland, ME and the City of Portland are included as Additional Insured under the General Liability policy but only with respect to the requirements of the contract between the Certificate Holder and AT&T Mobility LLC.

CERTIFICATE HOLDER

City of Portland, Maine
389 Congress St.
Portland, ME 04101

CANCELLATION

SHOULD ANY OF THE POLICIES DESCRIBED HEREIN BE CANCELLED BEFORE THE EXPIRATION DATE THEREOF, THE INSURER AFFORDING COVERAGE WILL ENDEAVOR TO MAIL 30 DAYS WRITTEN NOTICE TO THE CERTIFICATE HOLDER NAMED HEREIN, BUT FAILURE TO MAIL SUCH NOTICE SHALL IMPOSE NO OBLIGATION OR LIABILITY OF ANY KIND UPON THE INSURER AFFORDING COVERAGE, ITS AGENTS OR REPRESENTATIVES, OR THE ISSUER OF THIS CERTIFICATE

AUTHORIZED REPRESENTATIVE
of Marsh USA Inc.
BY: Alfred A. Peterfeso



MM1(3/02)

VALID AS OF:01/22/09

JAN 29 2009



EXISTING D/F PYLON



PROPOSED D/F PYLON

- 6** - REMOVE EXISTING (2) S/F ILLUMINATED SIGN CABINETS
 - FABRICATE & INSTALL D/F ILLUMINATED SIGN CABINET PAINTED BLACK
 - WHITE LEXAN FACE
 BACKGROUND TO BE 3M FILMS ORANGE 3632-84 "TANGERINE"
 GLOBE GRAPHIC TO BE FIRST SURFACE APPLIED 600 DPI DIGITALLY
 PRINTED VINYL. (VINYL GRAPHIC SHALL PROVIDED BY AT&T APPROVED VENDER ONLY)
 "AT&T" COPY WHITE

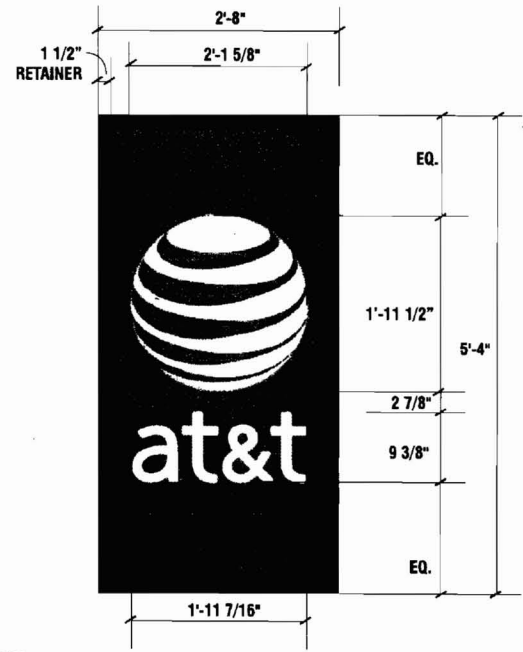

5 SIGN FACE ELEVATION
 scale 3/4" = 1'

PRELIMINARY DRAWING
 NOT FOR FABRICATION
 (field verify dimensions & conditions)

D/F PYLON

SERVICE SELECT SIGNS

400 MACK DRIVE
 CROYDON, PA 19021
 PH: 215.788.3898
 FAX: 215.788.3876

CLIENT:

LOCATION:
 AT&T MARKET DIRECT COR
 211 Marginal Way
 Portland, ME 04101

SS# 24591-R7

SITE L.S. #:

DESCRIPTION:
 SIGN DETAILS

SCALE: AS INDICATED

DRAWN BY: MJD

DATE: 7.24.08

REVISIONS:

▲	7/25/08	MJD
▲	7/30/08	MJD
▲	8/1/08	MJD
▲	11/26/08	RJMJ
▲	12/12/08	RJMJ
▲	12/17/08	TF
▲	1/29/09	RJMJ
▲		

CHANGE MADE ON REV:

VDWG:

ALLOWABLE SQ. FT.:

PROPOSED SQ. FT.:

THIS DRAWING IS SUBMITTED FOR YOUR EXCLUSIVE USE, IN CONNECTION WITH A PROJECT BEING PLANNED BY SERVICE SELECT, INC. IT IS NOT TO BE SHOWN TO ANYONE OUTSIDE YOUR ORGANIZATION, NOR IS IT TO BE USED, REPRODUCED, COPIED OR EXHIBITED IN ANY FORM.

WITHOUT THE EXPRESSED PERMISSION OF SERVICE SELECT, INC.

Page 3 of 4



SIGNAGE LEASE EXHIBIT

LOCATION:

Construction I.D. _____
Brand Name: AT&T MARKET DIRECT
Address: _____
Street 211 MARGINAL WAY
City PORTLAND
State ME 04101

LANDLORD CONTACTS:

Developer MWP INC.
Contact JOEL TRANUM
Phone 781-237-3677

LANDLORD CRITERIA:

Front Elev.: FOLLOW LOCAL CODE
Rear Elev.: N/A
Side Elev.: FOLLOW LOCAL CODE
Under Canopy/Blade Sign: N/A
Pylon/Monument: YES AVAILABLE

TOWNSHIP CONTACT INFO:

Township Name CITY OF PORTLAND
Contact Person: ANN MACHADO
Address: _____
Street: CITY HALL ROOM 315
City: PORTLAND
State: ME
Phone: 781-874-8703

BROKER INFO:

JOEL REICHMAN
978-681-8997

ARCHITECT INFO:

Callison
206-623-4646

SIGN CODE ALLOWANCE:

ZONED B7 MULTI TENANT
BOX ENTIRE COPY 2 SQ/FT PER LINEAR FOOT OF
FASCIA SIGN IS MOUNTED TO
FRONT 60' X 2 ALLOWS FOR 120 SQ/FT OF SIGN
SIDE 80' X 2 ALLOWS FOR 160 SQ/FT OF SIGN
~~REAR 60' X 2 ALLOWS FOR 120 SQ/FT OF SIGN~~

NOTICE:

THIS EXHIBIT IS FOR LEASE AGREEMENT PURPOSES ONLY. THE ATTACHED DRAWINGS ARE NOT FOR FABRICATION AND ARE SUBJECT TO ALL LOCAL, CITY AND STATE APPROVALS

ALL BUILDING FACADE COLORS MUST BE FIELD VERIFIED AND CHANNEL LETTER FACE COLORS APPROVED BY AT&T BEFORE FABRICATION

CUSTOMER APPROVAL:

DRAWING # SS24591-R6 DATE: 12/17/08
REF. DWG # SS24591-R1 DATE:

PREPARED FOR:

Chad Lovett

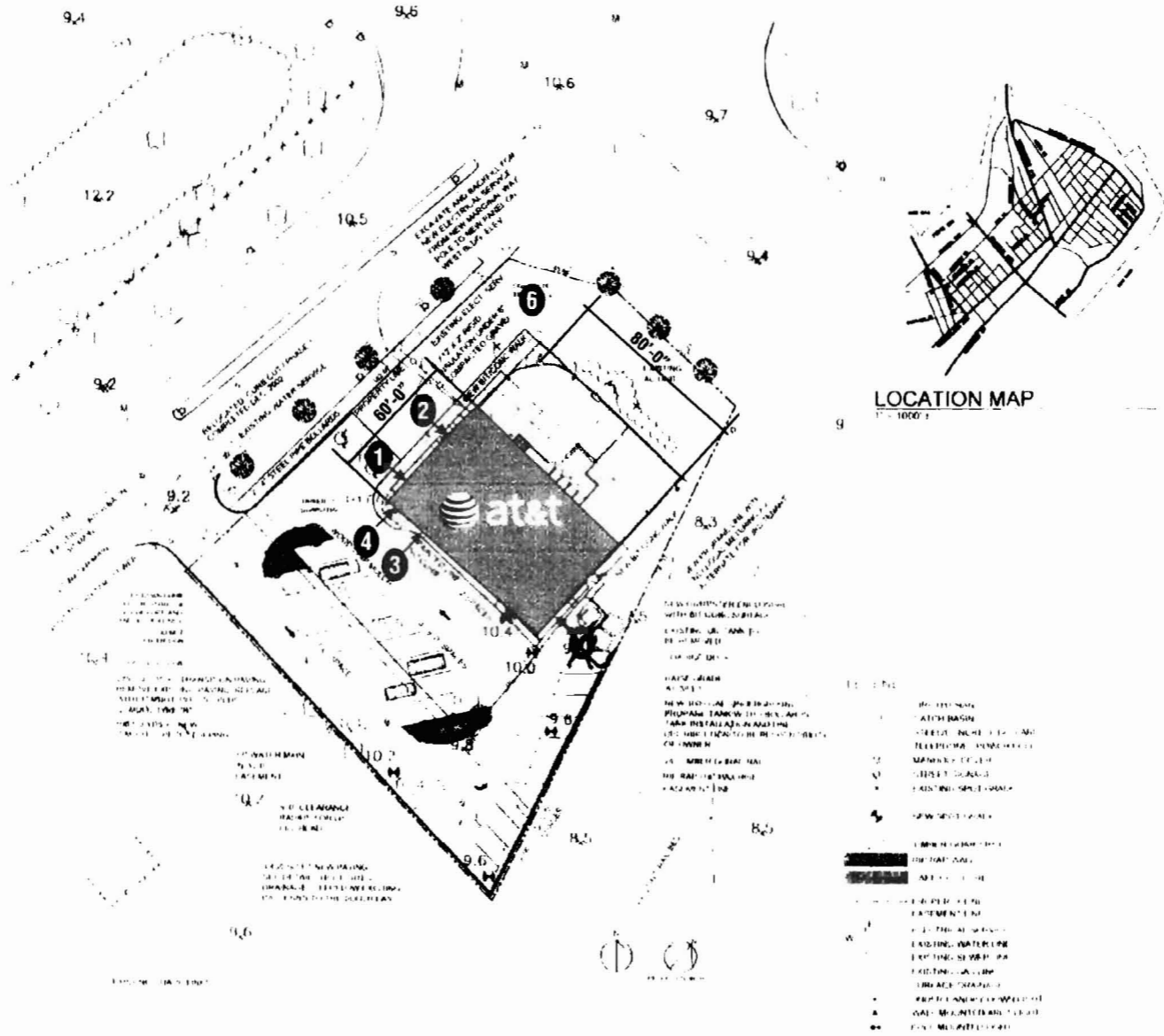

SITE PLAN

SITE PLAN



400 MACK DRIVE
 CROYDON, PA 19021
 PH: 215.788.3898
 FAX: 215.788.3876

CLIENT:

LOCATION:
 AT&T MARKET DIRECT COR
 211 Marginal Way
 Portland, ME 04101

SS# 24591-R6

SITE I.D. #:

DESCRIPTION:
 SIGN DETAILS

SCALE: AS INDICATED

DRAWN BY: MJD

DATE: 7.24.08

REVISION:

- ▲ 7/25/08 MJD
- ▲ 7/30/08 MJD
- ▲ 8/1/08 MJD
- ▲ 11/26/08 RJM
- ▲ 12/12/08 RJM
- ▲ 12/17/08 TF

CHANGE MADE ON REV:

VOLUME:

ALLOWABLE SQ. FT.:

PROPOSED SQ. FT.:

THIS DRAWING IS SUBMITTED FOR YOUR EXCLUSIVE USE, IN CONNECTION WITH A PROJECT BEING PLANNED BY SERVICE SELECT, INC. IT IS NOT TO BE SHOWN TO ANYONE OUTSIDE YOUR ORGANIZATION, NOR IS IT TO BE USED, REPRODUCED, COPIED OR EXHIBITED IN ANY MANNER, WITHOUT THE EXPRESSED PERMISSION OF SERVICE SELECT, INC.

SITE PLAN