



HEMESPHERE DESIGN
Architecture

58 Fore Street
Portland, ME 04101
207.232.6079
joe@hemisphere.design.com
www.hemisphere.design.com

PROSPECT



DESIGN
58 FORE ST. PORTLAND, ME
www.prospectdesign.me
T: 207-749-7400

DIAMOND ST. WAREHOUSE RENOVATION
1-11 DIAMOND ST, PORTLAND, ME
A.D. BEANER, LLC

LIFE SAFETY AND EGRESS PLAN
PERMIT SET

DESIGNED BY: [blank]
DATE: January 28, 2016

LS-101

Young's Furniture Warehouse
East Warehouse (Storage)
NFA 20,844 SF @ 300 SF/occupant = 41.7 occupants
IBC 20,844 SF @ 300 SF/occupant = 41.7 occupants
Storage - Total occupants 42 occupants

East Warehouse (Merchandise)
NFA 832 SF @ 30 SF/occupant = 27.7 occupants
IBC 832 SF @ 30 SF/occupant = 27.7 occupants
Merchandise - Total occupants 28 occupants

TOTAL OCCUPANTS 70 occupants

2 separate means of egress provided; 35 occupants to each means of egress.
Each egress: 35 occupants x 2 inches = 7 inches door width required
36 inch door width provided

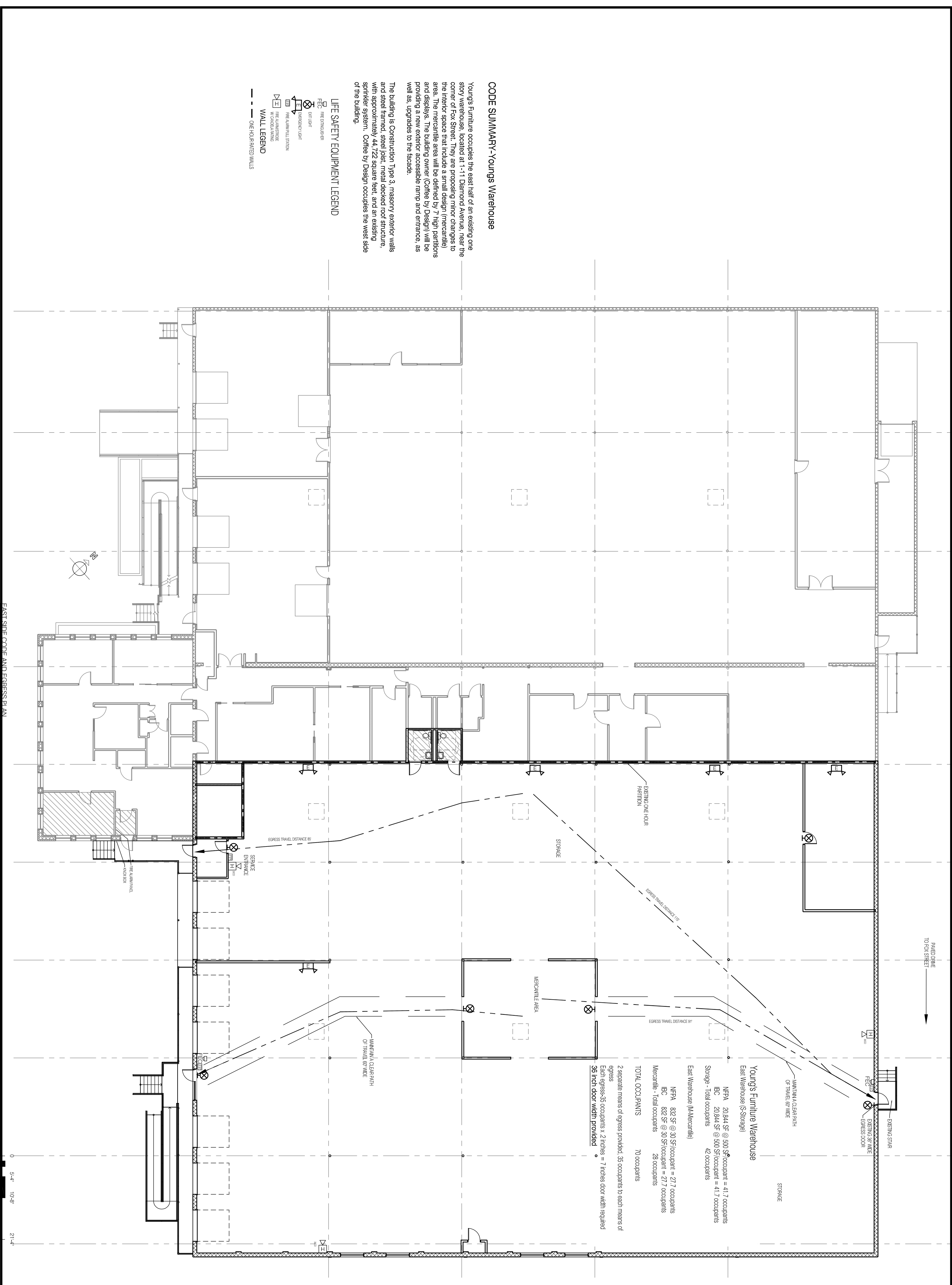

CODE SUMMARY-Youngs Warehouse

Youngs Furniture occupies the east half of an existing one story warehouse, located at 1-11 Diamond Avenue, near the corner of Fox Street. They are proposing minor changes to the interior space that include a small design (merchandise) area. The mercantile area will be defined by 7 high partitions and displays. The building owner (Coffee by Design) will be providing a new exterior accessible ramp and entrance, as well as, upgrades to the facade.

The building is Construction Type 3, masonry exterior walls and steel framed, steel joist, metal decked roof structure, with approximately 44,722 square feet, and an existing sprinkler system. Coffee by Design occupies the west side of the building.

- LIFE SAFETY EQUIPMENT LEGEND**
- ☒ FIRE ENCLOSURES
 - ⊗ FIRE DOOR
 - ⊗ EMERGENCY LIGHT
 - ⊗ FIRE ALARM PULL STATION
 - ⊗ FIRE ALARM SOUNDER
 - ⊗ FIRE ALARM SOUND
 - ⊗ WALL LEGEND
 - ONE-HOUR PARTITIONED WALLS

EAST SIDE CORNER AND EGRESS PLAN
3/28/16

SCALE: 3/32" = 1'-0"