

**NEW RAMP - FRAMING PLAN**  
Scale: 1/4" = 1'-0"

All Framing to be Pressure Treated  
All Dimensions must be Verified with Architectural Drawings

**STRUCTURAL DESIGN CRITERIA:**

1. BUILDING CODE: INTERNATIONAL BUILDING CODE - 2009 EDITION
2. DECK DESIGN LIVE LOAD = 100 PSF
3. DECK DESIGN DEAD LOAD = 10 PSF

**GENERAL NOTES:**

1. ALL DIMENSIONS AND CONDITIONS MUST BE VERIFIED IN THE FIELD. ANY DISCREPANCIES SHALL BE BROUGHT TO THE ATTENTION OF THE ENGINEER BEFORE PROCEEDING WITH THE AFFECTED PART OF THE WORK.
2. ALL APPLICABLE FEDERAL, STATE, AND MUNICIPAL REGULATIONS SHALL BE FOLLOWED, INCLUDING THE FEDERAL DEPARTMENT OF LABOR OCCUPATIONAL SAFETY AND HEALTH ACT.
3. REFER TO ARCHITECTURAL DRAWINGS FOR ALL DIMENSIONS, ELEVATIONS, RAISINGS, AND ADDITIONAL INFORMATION.

**FOUNDATION NOTES:**

1. FOUNDATION DESIGN BASED ON AN ASSUMED MAXIMUM ALLOWABLE BEARING PRESSURE OF 2000 PSF.
2. DESIGN OF EXTERIOR FOUNDATIONS IS BASED ON A FROST DEPTH OF 4'-0" BELOW FINISHED GRADE.

**CONCRETE NOTES:**

1. ALL CONCRETE WORK SHALL CONFORM TO ACI-318-LATEST EDITION.
2. CONCRETE COMPRESSIVE STRENGTH AT 28 DAYS SHALL BE 3000 PSI, MAXIMUM SIZE AGGREGATE SHALL BE 0".

**WOOD FRAMING NOTES:**

1. STRUCTURAL LUMBER: SOUTHERN YELLOW PINE, PRESSURE TREATED  
F<sub>b</sub> = 1000 PSI F<sub>v</sub> = 70 PSI  
F<sub>c</sub> = 975 PSI E = 1100000 PSI
2. DESIGN CODE: NATIONAL DESIGN SPECIFICATIONS FOR WOOD CONSTRUCTION BY THE NATIONAL FOREST PRODUCTS ASSOCIATION.
3. CONNECTORS: ALL CONNECTORS, BOLTS, JOISTS HANGERS TO BE GALVANIZED.  
JOIST TO HEADER / RIM JOIST = JOIST HANGER  
RIM JOIST / HEADER TO POST = (2) 3/4" THRU-BOLTS
4. FRAMING ARRANGEMENT SHOWN IS A PROVIDED AS A GUIDE.

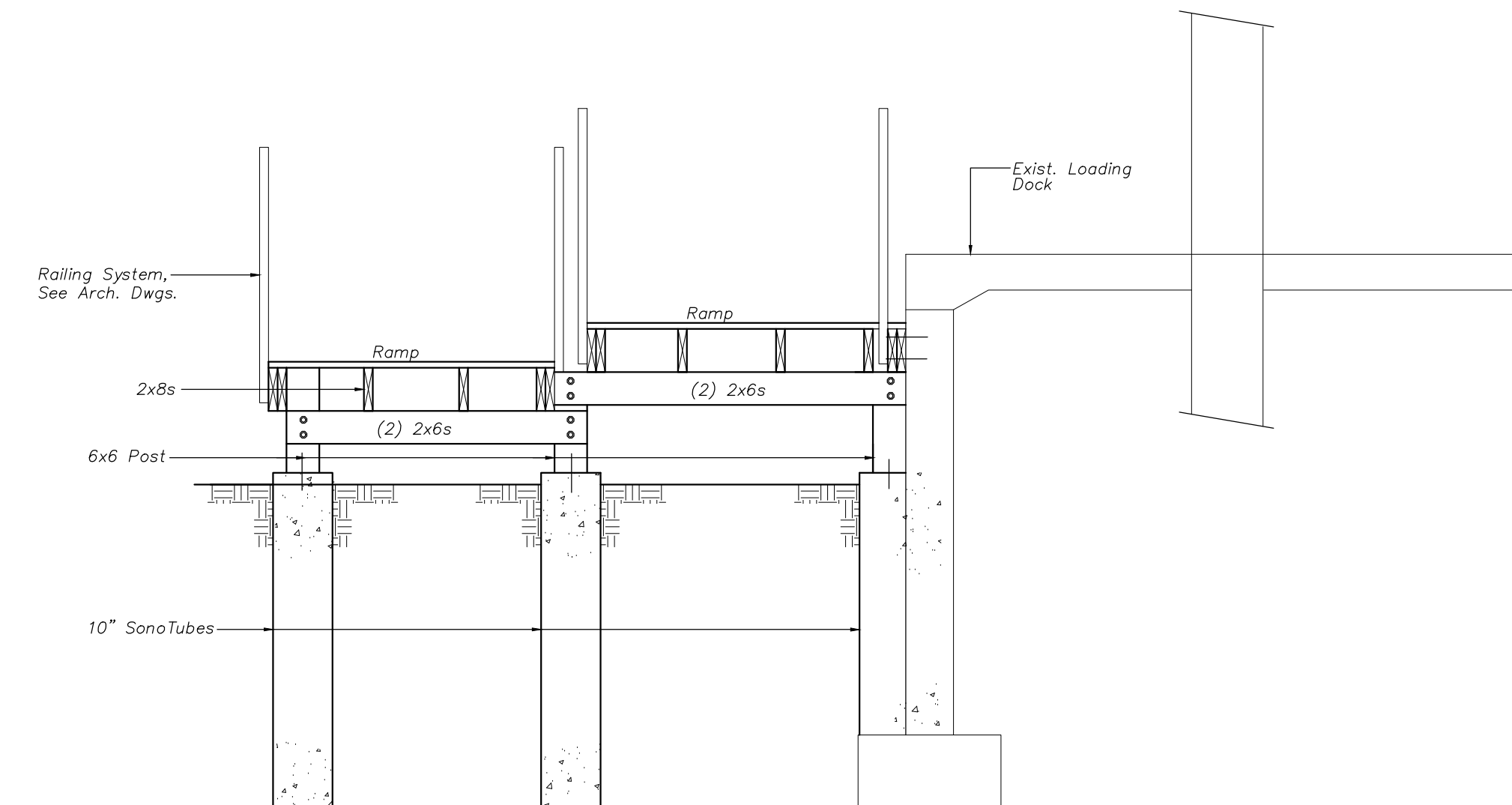

**SECTION 1 S1**  
Scale: 1/2" = 1'-0"

SEI  
Shelley Engineering, Inc.  
Structural Consultants  
P.O. Box 1030  
Gray, Maine 04039  
Phone (207) 667-8031  
www.ShelleyEngineering.com

DIAMOND ST. WAREHOUSE RENOVATION  
Portland ME

Issue	Date
Review	1/13/16

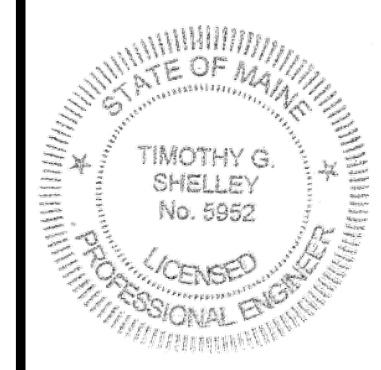

**SHEET TITLE:**  
Structural  
New Ramp &  
Windows

S1 of 1  
SEI Job # 2015-234