

**PROSPECT DESIGN**  
 ARCHITECTURE | EXHIBITIONS  
 207.749.7400 | prospectdesign.me

**HEMESphere**  
**DESIGN LLC**  
**CONSTRUCTION**

DIAMOND ST. WAREHOUSE RENOVATION  
 1-11 DIAMOND ST, PORTLAND, ME  
 A.D. BEANER, LLC  
 43 WASHINGTON AVENUE, PORTLAND

SECTION  
 PERMIT SET

SHEET TITLE
REVISION

FORMER BY:  
 DATE: March 12, 2013

A-301

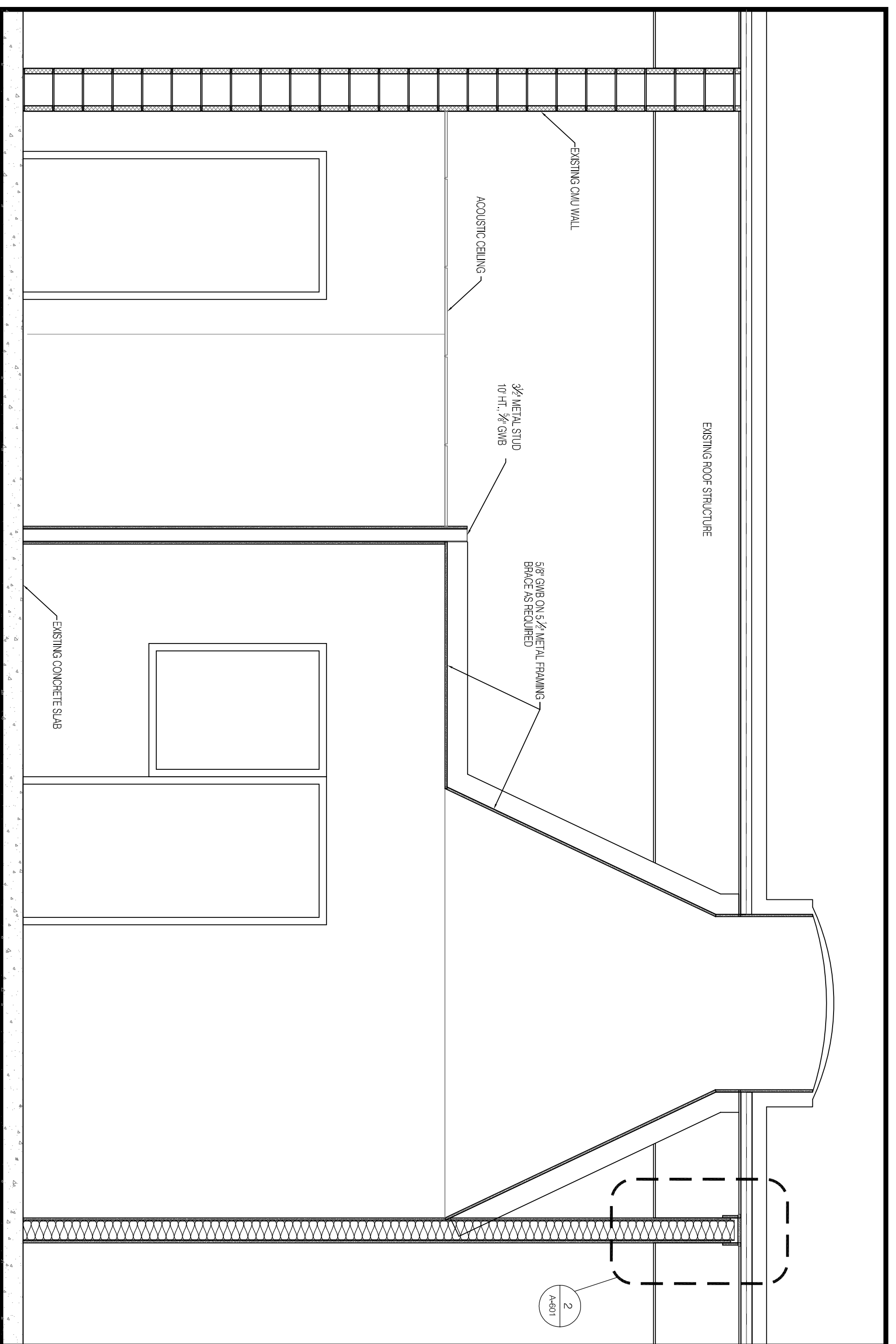
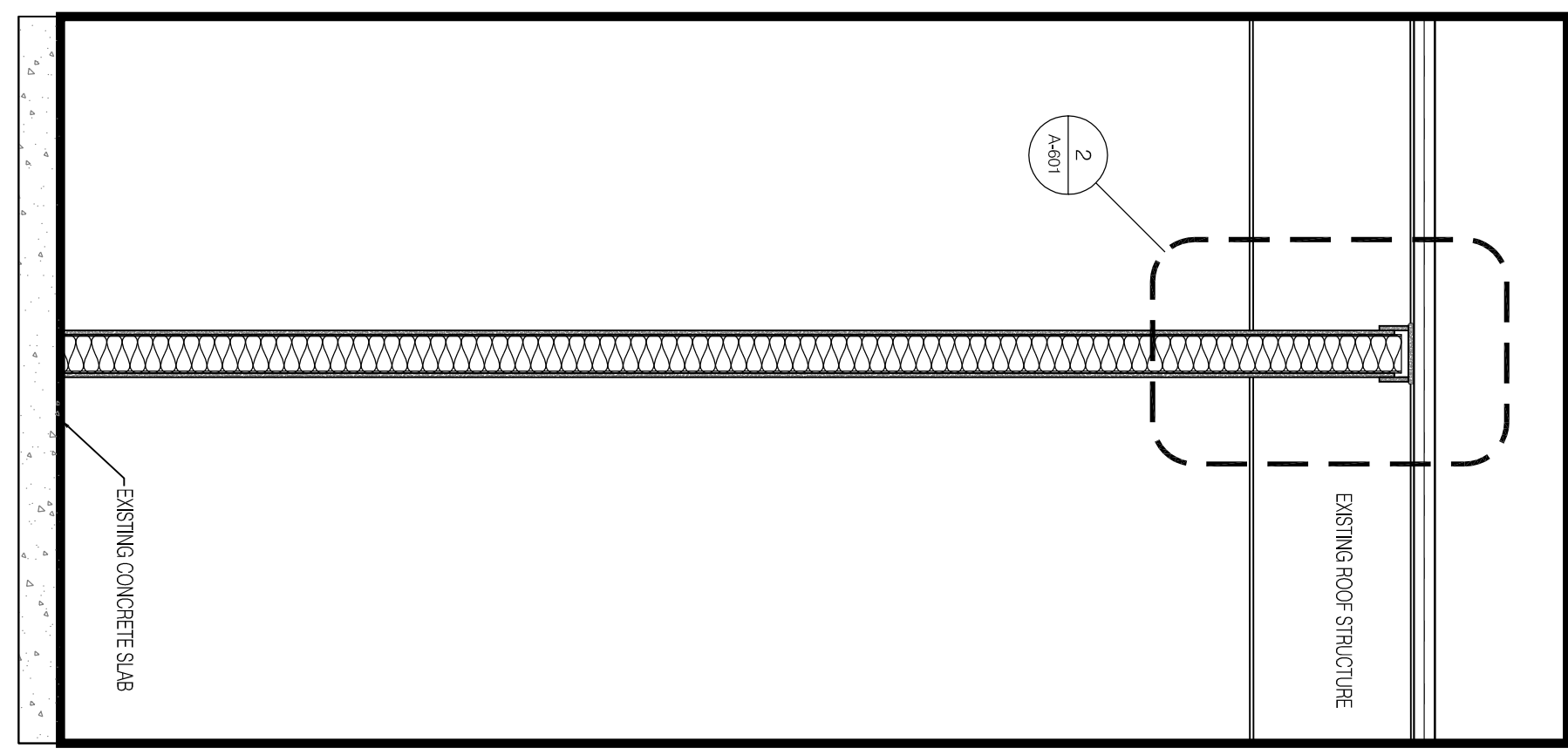

1 ONE HOUR WALL - SLIP JOINT AT DECK  
1/2" = 1'-0"

2 DETAIL  
1/2" = 1'-0"

