

City of Portland, Maine – Building or Use Permit Application, 389 Congress Street, 04101, Tel: (207) 874-8703, FAX: 874-8716

Location of Construction: 323 Marginal Way		Owner: Southern Maine Properties	Phone: 879-1671	Permit # 990476
Owner Address: P.O. Box 7525	Lessee/Buyer's Name: Bayside Employee Health Ctr.	Phone:	BusinessName:	<div style="border: 2px solid black; padding: 5px; text-align: center;"> PERMIT ISSUED Permit Issued: APR 14 1999 CITY OF PORTLAND </div>
Contractor Name: Sign-A-Rama	Address: 778 Roosevelt Trail Windham, ME 04062	Phone: 893-2011		
Past Use: Commercial	Proposed Use: Same	COST OF WORK: \$ 5,800	PERMIT FEE: \$ 34.60	
		FIRE DEPT. <input type="checkbox"/> Approved <input type="checkbox"/> Denied	INSPECTION: Use Group: Type:	
Proposed Project Description: 6 x 8 double face sign box mounted on a 20' pole.		PEDESTRIAN ACTIVITIES DISTRICT (P.A.D.) Action: <input type="checkbox"/> Approved <input type="checkbox"/> Approved with Conditions <input type="checkbox"/> Denied Signature: _____ Date: _____		Zoning Approval: <i>Neck Area</i> Special Zone or Reviews: <input type="checkbox"/> Shoreland <input type="checkbox"/> Wetland <input type="checkbox"/> Flood Zone <input type="checkbox"/> Subdivision <input type="checkbox"/> Site Plan maj <input type="checkbox"/> minor <input type="checkbox"/> mm <input type="checkbox"/> <i>5/14/99</i>
Permit Taken By: SP	Date Applied For: 4-16-99			Zoning Appeal <input type="checkbox"/> Variance <input type="checkbox"/> Miscellaneous <input type="checkbox"/> Conditional Use <input type="checkbox"/> Interpretation <input type="checkbox"/> Approved <input type="checkbox"/> Denied

- This permit application does not preclude the Applicant(s) from meeting applicable State and Federal rules.
- Building permits do not include plumbing, septic or electrical work.
- Building permits are void if work is not started within six (6) months of the date of issuance. False information may invalidate a building permit and stop all work..

****Call for Pick Up 893-2011

PERMIT ISSUED WITH REQUIREMENTS

CERTIFICATION

I hereby certify that I am the owner of record of the named property, or that the proposed work is authorized by the owner of record and that I have been authorized by the owner to make this application as his authorized agent and I agree to conform to all applicable laws of this jurisdiction. In addition, if a permit for work described in the application is issued, I certify that the code official's authorized representative shall have the authority to enter all areas covered by such permit at any reasonable hour to enforce the provisions of the code(s) applicable to such permit

4-16-99

SIGNATURE OF APPLICANT _____ ADDRESS: _____ DATE: _____ PHONE: _____

RESPONSIBLE PERSON IN CHARGE OF WORK, TITLE _____ PHONE: _____

White-Permit Desk Green-Assessor's Canary-D.P.W. Pink-Public File Ivory Card-Inspector

CEO DISTRICT

1

COMMENTS

11/2/99 Completed OK

99-0476

023-E-002

Inspection Record

Type

Date

Foundation: _____

Framing: _____

Plumbing: _____

Final: _____

Other: _____

THIS IS NOT A PERMIT/CONSTRUCTION CANNOT COMMENCE UNTIL THE PERMIT IS ISSUED

**Building or Use Permit Pre-Application
Attached Single Family Dwellings/Two-Family Dwelling
Multi-Family or Commercial Structures and Additions Thereto**

In the interest of processing your application in the quickest possible manner, please complete the Information below for a Building or Use Permit.

NOTEIf you or the property owner owes real estate or personal property taxes or user charges on ANY PROPERTY within the City, payment arrangements must be made before permits of any kind are accepted.**

Location/Address of Construction (include Portion of Building): <u>323 MARGINAL WAY, PORTLAND</u>			
Total Square Footage of Proposed Structure <u>SIGN 48 SQ FT.</u>		Square Footage of Lot <u>68000 SQ FT.</u>	
Tax Assessor's Chart, Block & Lot Number Chart# <u>023</u> Block# <u>E</u> Lot# <u>002</u>		Owner: <u>Southern Maine Properties.</u>	Telephone#: <u>207-829-1671</u>
Owner's Address: <u>PO Box 7525 PORTLAND ME. 04112</u>		Lessee/Buyer's Name (If Applicable) <u>BAYSIDE Employee Health Center.</u>	Cost Of Work: <u>\$ 48⁰⁰</u> Fee <u>\$ 39.60</u> <u>5800</u>
Proposed Project Description: (Please be as specific as possible) <u>(THIS SIGN WILL NOT BE LIGHTED)</u> <u>6'x8' DOUBLE FACE SIGN BOX MOUNTED ON A 20' POLE.</u>			
Contractor's Name, Address & Telephone <u>SIGN-A-RAMA 778 ROOSEVELT TRAIL WINDHAM ME 04062 (207) 893-2011</u>			Rec'd By <u>[Signature]</u>
Current Use:		Proposed Use: <u>SIGN.</u>	

Separate permits are required for Internal & External Plumbing, HVAC and Electrical installation.

- All construction must be conducted in compliance with the 1996 B.O.C.A. Building Code as amended by Section 6-Art II.
- All plumbing must be conducted in compliance with the State of Maine Plumbing Code.
- All Electrical Installation must comply with the 1996 National Electrical Code as amended by Section 6-Art III.
- HVAC (Heating, Ventilation and Air Conditioning) installation must comply with the 1995 B.O.C.A. Mechanical Code.

You must include the following with your application:

- 1) A Copy of Your Deed or Purchase and Sale Agreement
- 2) A Copy of your Construction Contract, if available
- 3) A Plot Plan/Site Plan

Minor or Major site plan review will be required for the above proposed projects. The attached checklist outlines the minimum standards for a site plan.

4) Building Plans

Unless exempted by State Law, construction documents must be designed by a registered design professional.

A complete set of construction drawings showing all of the following elements of construction:

- Cross Sections w/Framing details (including porches, decks w/ railings, and accessory structures)
- Floor Plans & Elevations
- Window and door schedules
- Foundation plans with required drainage and dampproofing
- Electrical and plumbing layout. Mechanical drawings for any specialized equipment such as furnaces, chimneys, gas equipment, HVAC equipment (air handling) or other types of work that may require special review must be included.

Certification

I hereby certify that I am the Owner of record of the named property, or that the proposed work is authorized by the owner of record and that I have been authorized by the owner to make this application as his/her authorized agent. I agree to conform to all applicable laws of this jurisdiction. In addition, if a permit for work described in this application is issued, I certify that the Code Official's authorized representative shall have the authority to enter all areas covered by this permit at any reasonable hour to enforce the provisions of the codes applicable to this permit.

Signature of Applicant: <u>[Signature]</u>	Date: <u>4-1-99</u>
--	---------------------

Building Permit Fee: \$25.00 for the 1st \$1000. cost plus \$5.00 per \$1,000.00 construction cost thereafter.
Additional Site review and related fees are attached on a separate addendum

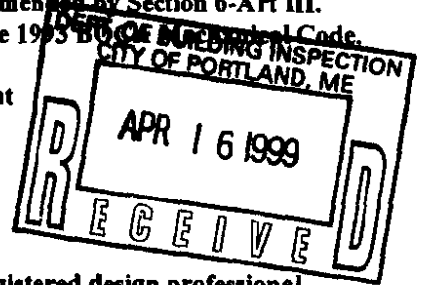

**** → Call for P/U 893-2011**

SIGNAGE PRE-APPLICATION

PLEASE ANSWER ALL QUESTIONS

ADDRESS: 323 MARGINAL way ZONE: B-5
OWNER: Southern Maine Properties
APPLICANT: Bayside Employee Health Center
ASSESSOR NO. _____

using Table 2.12
SPECIAL permission for
zones within 600'
of I-295

PLEASE CIRCLE APPROPRIATE ANSWER

SINGLE TENANT LOT? YES NO
MULTI-TENANT LOT? YES NO
FREESTANDING SIGN? (ex. Pole Sign) YES NO --- DIMENSIONS 73" HEIGHT 96"
MORE THAN ONE SIGN? YES NO DIMENSIONS 6.083' HEIGHT 8'
SIGN ATTACHED TO BLDG.? YES NO DIMENSIONS _____
MORE THAN ONE SIGN? YES NO DIMENSIONS _____
AWNING: YES NO IS AWNING BACKLIT? YES NO HEIGHT OFF SIDEWALK _____
IS THERE ANY MESSAGE, TRADEMARK OR SYMBOL ON IT? _____

LIST ALL EXISTING SIGNAGE AND THEIR DIMENSIONS: Pierre's 4x20', PLAY IT
AGAIN 4x6', SPORTS 4x14', REPER PERFORMANCE 26x40" + 14x40"
MAINE PUBLIC BROADCASTING 26x40"

*** TENANT BLDG. FRONTAGE (IN FEET): 50'
*** REQUIRED INFORMATION

AREA FOR COMPUTATION

Allows 160#
height 25'
5' from line
48# Show
20' high
over 5' finished

YOU SHALL PROVIDE:

A SITE SKETCH AND BUILDING SKETCH SHOWING EXACTLY WHERE EXISTING AND NEW SIGNAGE IS LOCATED MUST BE PROVIDED. SKETCHES AND/OR PICTURES OF PROPOSED ARE ALSO REQUIRED.

SIGNATURE OF APPLICANT: Arthur C. [Signature] DATE: 4-15-99.

ACORD CERTIFICATE OF LIABILITY INSURANCE OP ID KB DATE (MM/DD/YY)
BATSI-1 04/07/99

PRODUCER
Morse, Payson & Noyes Insurance
 P.O. Box 406
 Portland ME 04112-0406

THIS CERTIFICATE IS ISSUED AS A MATTER OF INFORMATION ONLY AND CONFERS NO RIGHTS UPON THE CERTIFICATE HOLDER. THIS CERTIFICATE DOES NOT AMEND, EXTEND OR ALTER THE COVERAGE AFFORDED BY THE POLICIES BELOW.

Kim M. Bruce
 Phone No 207-775-6000 Fax No 207-775-0339

COMPANIES AFFORDING COVERAGE

- COMPANY A **TRAVELERS INSURANCE COMPANY**
- COMPANY B
- COMPANY C
- COMPANY D

INSURED
Bayside Employee Health Center, LLC
 323 Marginal Way
 Portland ME 04101

COVERAGES
 THIS IS TO CERTIFY THAT THE POLICIES OF INSURANCE LISTED BELOW HAVE BEEN ISSUED TO THE INSURED NAMED ABOVE FOR THE POLICY PERIOD INDICATED, NOTWITHSTANDING ANY REQUIREMENT, TERM OR CONDITION OF ANY CONTRACT OR OTHER DOCUMENT WITH RESPECT TO WHICH THIS CERTIFICATE MAY BE ISSUED OR MAY PERTAIN, THE INSURANCE AFFORDED BY THE POLICIES DESCRIBED HEREIN IS SUBJECT TO ALL THE TERMS, EXCLUSIONS AND CONDITIONS OF SUCH POLICIES. LIMITS SHOWN MAY HAVE BEEN REDUCED BY PAID CLAIMS.

CO-TP	TYPE OF INSURANCE	POLICY NUMBER	POLICY EFFECTIVE DATE (MM/DD/YY)	POLICY EXPIRATION DATE (MM/DD/YY)	LIMITS
I	GENERAL LIABILITY <input checked="" type="checkbox"/> COMMERCIAL GENERAL LIABILITY <input type="checkbox"/> CLAIMS MADE <input checked="" type="checkbox"/> OCC JR OWNER'S & CONTRACTORS PRCT	1680914D6988	02/08/99	02/08/00	GENERAL AGGREGATE \$ 2,000,000
					PRODUCTS - COM/OP AGG \$ 2,000,000
					PERSONAL & ADV INJURY \$ 1,000,000
					EACH OCCURRENCE \$ 1,000,000
					FIRE DAMAGE (Any one fire) \$ 300,000
					MED EXP (Any one person) \$ 10,000
	AUTOMOBILE LIABILITY <input type="checkbox"/> ANY AUTO <input type="checkbox"/> OWNED AUTOS <input type="checkbox"/> SCHEDULED AUTOS <input type="checkbox"/> HIRED AUTOS <input type="checkbox"/> NON-OWNED AUTOS				COMBINED SINGLE LIMIT \$
					BODILY INJURY (Per person) \$
					BODILY INJURY (Per accident) \$
					PROPERTY DAMAGE \$
	CARAGE LIABILITY <input type="checkbox"/> ANY AUTO				AUTO ONLY - EA ACCIDENT \$
					OTHER THAN AUTO ONLY \$
					EACH ACCIDENT \$
					AGGREGATE \$
	EXCESS LIABILITY <input type="checkbox"/> UMBRELLA FORM <input type="checkbox"/> OTHER THAN UMBRELLA FORM				EACH OCCURRENCE \$
					AGGREGATE \$
					\$
	WORKERS COMPENSATION AND EMPLOYERS LIABILITY THE PROPRIETORS, PARTNERS/EXECUTIVE OFFICERS ARE <input type="checkbox"/> INCL <input type="checkbox"/> EXCL				WC STATUTORY LIMITS OTHER
					EL EACH ACCIDENT \$
					EL D SEASE - POLICY LIMIT \$
					EL D SEASE - EA EMPLOYEE \$
	OTHER				

DESCRIPTION OF OPERATIONS/LOCATIONS/VEHICLES/SPECIAL ITEMS

CERTIFICATE HOLDER
CITYPTL
 City of Portland
 389 Congress Street
 Portland ME 04101

CANCELLATION
 SHOULD ANY OF THE ABOVE DESCRIBED POLICIES BE CANCELLED BEFORE THE EXPIRATION DATE THEREOF, THE ISSUING COMPANY WILL ENDEAVOR TO MAIL 10 DAYS WRITTEN NOTICE TO THE CERTIFICATE HOLDER NAMED TO THE LEFT. BUT FAILURE TO MAIL SUCH NOTICE SHALL IMPOSE NO OBLIGATION OR LIABILITY OF ANY KIND UPON THE COMPANY, ITS AGENTS OR REPRESENTATIVES.
 AUTHORIZED REPRESENTATIVE
Kim M. Bruce

OWNERS CONSENT AND AGREEMENT

I, Southern Maine Properties Company being the owner of the premises located at 309 - 323

Marionna Way in Portland, Maine, hereby give consent to the erection of a certain Sign on Upham, M.D., Jane Gust, D.D., and Betty Buchner, D.D. dba Barnes Employee Health Center, P.A. LLC signwriting banner owned by A over the sidewalk on building line

from said premises as described in application to the Division of Inspection Services.

And in consideration of the issuance of said permit, owner of said premises, in event said sign shall cease to serve the purpose for which it was erected or shall become dangerous and in event the owner of said sign shall fail to remove said sign or make it permanently safe in case the sign still serves the purpose for which it was erected, hereby agrees for himself or itself, for his heirs, its successors, and his or its assigns, to complete remove said sign.

[Signature]
Signature of Property Owner

[Signature]
Signature of Lessee

4/14/99
Date

4/14/99
Date

BUILDING PERMIT REPORT

DATE: 23 APRIL 99 ADDRESS: 323 Marginal Way CBL: 023-E-002

REASON FOR PERMIT: Signage

BUILDING OWNER: Southern Maine Properties

PERMIT APPLICANT: Sign - A - Ramo Contractor 5,800 - 34.60

USE GROUP Signage BOCA 1996 CONSTRUCTION TYPE _____

CONDITION(S) OF APPROVAL

This permit is being issued with the understanding that the following conditions are met:

Approved with the following conditions: X/

- X1. This permit does not excuse the applicant from meeting applicable State and Federal rules and laws.
2. Before concrete for foundation is placed, approvals from the Development Review Coordinator and Inspection Services must be obtained. (A 24 hour notice is required prior to inspection)
3. Foundation drain shall be placed around the perimeter of a foundation that consists of gravel or crushed stone containing not more than 10 percent material that passes through a No. 4 sieve. The drain shall extend a minimum of 12 inches beyond the outside edge of the footing. The thickness shall be such that the bottom of the drain is not higher than the bottom of the base under the floor, and that the top of the drain is not less than 6 inches above the top of the footing. The top of the drain shall be covered with an approved filter membrane material. Where a drain tile or perforated pipe is used, the invert of the pipe or tile shall not be higher than the floor elevation. The top of joints or top of perforations shall be protected with an approved filter membrane material. The pipe or tile shall be placed on not less than 2" of gravel or crushed stone, and shall be covered with not less than 6" of the same material. Section 1813.5.2
4. Foundations anchors shall be a minimum of 1/2" in diameter, 7" into the foundation wall, minimum of 12" from corners of foundation and a maximum 6' o.c. between bolts. (Section 2305.17)
5. Waterproofing and damp proofing shall be done in accordance with Section 1813.0 of the building code.
6. Precaution must be taken to protect concrete from freezing. Section 1908.0
7. It is strongly recommended that a registered land surveyor check all foundation forms before concrete is placed. This is done to verify that the proper setbacks are maintained.
8. Private garages located beneath habitable rooms in occupancies in Use Group R-1, R-2, R-3 or I-1 shall be separated from adjacent interior spaces by fire partitions and floor/ceiling assembly which are constructed with not less than 1-hour fire resisting rating. Private garages attached side-by-side to rooms in the above occupancies shall be completely separated from the interior spaces and the attic area by means of 1/2 inch gypsum board or the equivalent applied to the garage means of 1/2 inch gypsum board or the equivalent applied to the garage side. (Chapter 4, Section 407.0 of the BOCA/1996)
9. All chimneys and vents shall be installed and maintained as per Chapter 12 of the City's Mechanical Code. (The BOCA National Mechanical Code/1993). Chapter 12 & NFPA 211
10. Sound transmission control in residential building shall be done in accordance with Chapter 12, Section 1214.0 of the City's Building Code.
11. Guardrails & Handrails: A guardrail system is a system of building components located near the open sides of elevated walking surfaces for the purpose of minimizing the possibility of an accidental fall from the walking surface to the lower level. Minimum height all Use Groups 42", except Use Group R which is 36". In occupancies in Use Group A, B, H-4, I-1, I-2, M and R and public garages and open parking structures, open guards shall have balusters or be of solid material such that a sphere with a diameter of 4" cannot pass through any opening. Guards shall not have an ornamental pattern that would provide a ladder effect. (Handrails shall be a minimum of 3e4" but not more than 38". Use Group R-3 shall not be less than 30", but not more than 38".) Handrail grip size shall have a circular cross section with an outside diameter of at least 1 1/4" and not greater than 2". (Sections 1021 & 1022.0) - Handrails shall be on both sides of stairway. (Section 1014.7)
12. Headroom in habitable space is a minimum of 7'6". (Section 1204.0)
13. Stair construction in Use Group R-3 & R-4s a minimum of 10" tread and 7 1/2" maximum rise. All other Use Group minimum 11" tread, 7" maximum rise. (Section 1014.0)
14. The minimum headroom in all parts of a stairway shall not be less than 80 inches. (6'8") 1014.4
15. Every sleeping room below the fourth story in buildings of Use Groups R and I-1 shall have at least one operable window or exterior door approved for emergency egress or rescue. The units must be operable from the inside without the use of special knowledge or separate tools. Where windows are provided as means of egress or rescue they shall have a sill height not more than 44 inches (1118mm) above the floor. All egress or rescue windows from sleeping rooms shall have a minimum net clear opening height dimension of 24 inches (610mm). The minimum net clear opening width dimension shall be 20 inches (508mm), and a minimum net clear opening of 5.7 sq. ft. (Section 1018.6)
16. Each apartment shall have access to two (2) separate, remote and approved means of egress. A single exit is acceptable when it exits directly from the apartment to the building exterior with no communications to other apartment units. (Section 1010.1)
17. All vertical openings shall be enclosed with construction having a fire rating of at least one (1) hour, including fire doors with self closer's. (Over 3 stories in height requirements for fire rating is two (2) hours.) (Section 710.0)

18. The boiler shall be protected by enclosing with (1)hour fire rated construction including fire doors and ceiling, or by providing automatic extinguishment. (Table 302.1.1)
19. All single and multiple station smoke detectors shall be of an approved type and shall be installed in accordance with the provisions of the City's Building Code Chapter 9, Section 920.3.2 (BOCA National Building Code/1996), and NFPA 101 Chapter 18 &19. (Smoke detectors shall be installed and maintained at the following locations):
 - In the immediate vicinity of bedrooms
 - In all bedrooms
 - In each story within a dwelling unit, including basements
 In addition to the required AC primary power source, required smoke detectors in occupancies in Use Groups R-2, R-3 and I-1 shall receive power from a battery when the AC primary power source is interrupted. (Interconnection is required) Section 920.3.2.
20. A portable fire extinguisher shall be located as per NFPA #10. They shall bear the label of an approved agency and be of an approved type. (Section 921.0)
21. The Fire Alarm System shall maintained to NFPA #72 Standard.
22. The Sprinkler System shall maintained to NFPA #13 Standard.
23. All exit signs, lights and means of egress lighting shall be done in accordance with Chapter 10 Section & Subsections 1023.0 & 1024.0 of the City's Building Code. (The BOCA National Building Code/1996)
24. Section 25-135 of the Municipal Code for the City of Portland states, "No person or utility shall be granted a permit to excavate or open any street or sidewalk from the time of November 15 of each year to April 15 of the following year".
25. The builder of a facility to which Section 4594-C of the Maine State Human Rights Act Title 5 MRSA refers, shall obtain a certification from a design professional that the plans commencing construction of the facility, the builder shall submit the certification the Division of Inspection Services.
26. Ventilation shall meet the requirements of Chapter 12 Sections 1210.0 of the City's Building Code. (Crawl spaces & attics).
27. All electrical, plumbing and HVAC permits must be obtained by a Master Licensed holders of their trade. No closing in of walls until all electrical (min. 72 hours notice) and plumbing inspections have been done.
28. All requirements must be met before a final Certificate of Occupancy is issued.
29. All building elements shall meet the fastening schedule as per Table 2305.2 of the City's Building Code (the BOCA National Building Code/1996).
30. Ventilation of spaces within a building shall be done in accordance with the City's Mechanical Code (The BOCA National Mechanical Code/1993). (Chapter M-16)
31. Please read and implement the attached Land Use Zoning report requirements.
32. Boring, cutting and notching shall be done in accordance with Sections 2305.4.4, 2305.5.1 and 2305.5.3 of the City's Building Code.
33. Glass and glazing shall meet the requirements of Chapter 24 of the building code.
34. ~~All signage shall be done in accordance with Section 3102.0 of The City's building Code (The BOCA National Building Code/1996)~~
35. _____
36. _____

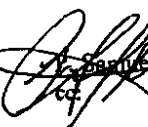
 E. Samuel Hoffes, Building Inspector
 cc. Lt. McDougall, PFD
 Marge Schmuckal, Zoning Administrator

****On the basis of plans submitted and conditions placed on these plans any deviations shall require a separate approval.**

PROPOSED SIGN

1. Height to top of the sign will be 20 ft.
2. The sign footing will be 36 in. by 36 in. by 48 in. deep and flush with the existing grade.

















68000

EXTRUDED ALUMINUM SIGN BOY WITH POLYCARBONATE SIGN PANELS. THIS IS NOT AN ILLUMINATED SIGN.

6x6x1/4" SQUARE STRUCTURAL STEEL TUBING.

(4) 1" ANCHOR BOLTS

3/4" RE BAR

3900 PSI CONCRETE

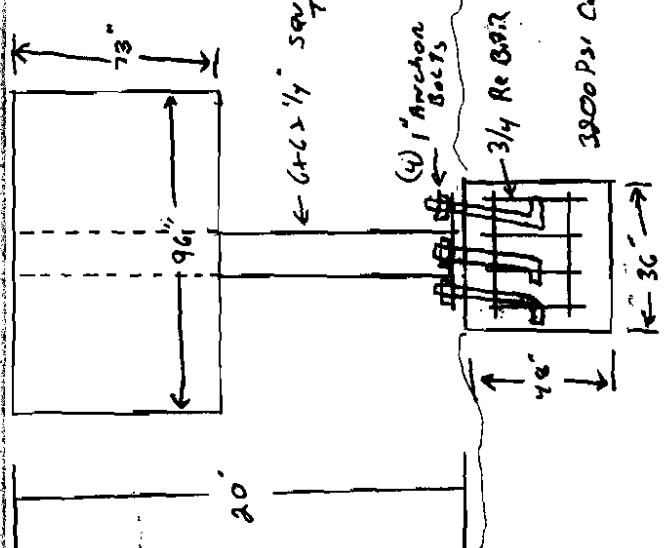

GRADE LINE

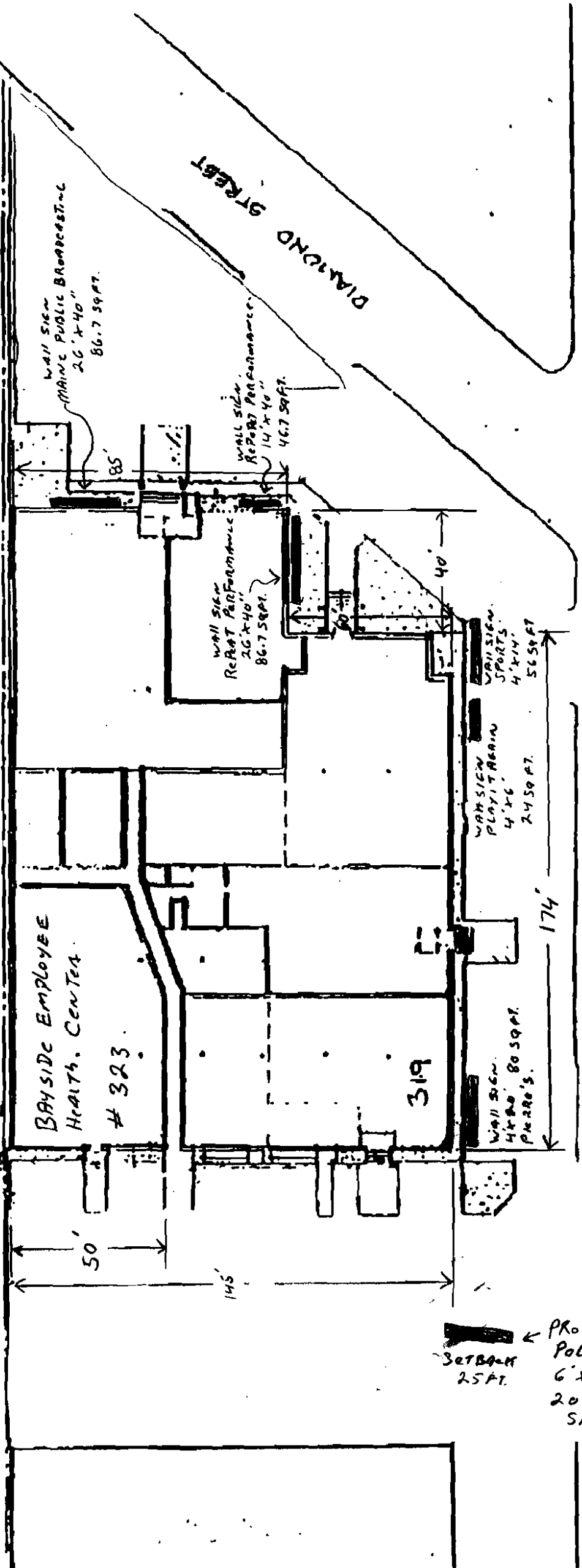

WALL SIGN MAINE PUBLIC BROADCASTING 26'x40" 86.7 SQFT.

WALL SIGN REPEAT PERFORMANCE 14'x40" 46.7 SQFT.

WALL SIGN REPEAT PERFORMANCE 26'x40" 86.7 SQFT.

WALL SIGN VARIATION SPORTS 4'x14' 56.5 SQFT.

WALL SIGN PLAYTERRAIN 4'x6' 24.5 SQFT.

WALL SIGN HERE 80 SQFT. PHARRIS.

BAYSIDE EMPLOYEE HEALTH CENTER #323

319

MARGINAL WAY

MARGINAL WAY

← PROPOSED NEW POLE SIGN 6'x8' 48 SQFT. 20' TO TOP OF SIGN.

← SETBACK 25 FT.