

GENERAL NOTES:

1. REFER TO STRUCTURAL ENGINEER'S PLANS FOR FOUNDATION WALL DESIGN. DESIGN OF TEMPORARY SOIL RESTRAINT MEASURES SHALL BE THE RESPONSIBILITY OF THE CONTRACTOR IF NECESSARY FOR CONSTRUCTION.
2. CONTRACTOR SHALL PLACE CATCH BASIN INLET PROTECTION ON CATCH BASINS AND FIELD INLETS DOWN-GRADE OF ALL NON-STABILIZED SURFACES, PER DETAIL.
3. CONTRACTOR SHALL ENSURE THAT FOUNDATION DRAINS AND UNDERDRAINS ARE CONSTRUCTED WITH POSITIVE OUTLET TO PROPOSED CONNECTIONS.
4. REFER TO THE STORMWATER REPORT FOR STORMWATER ANALYSIS AND BMP SIZING CALCULATIONS.

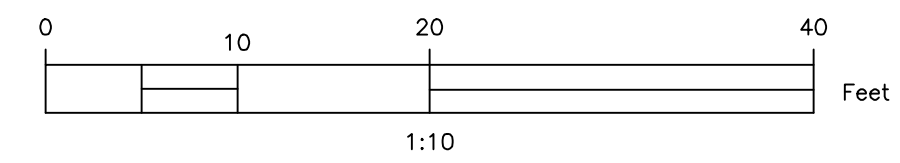
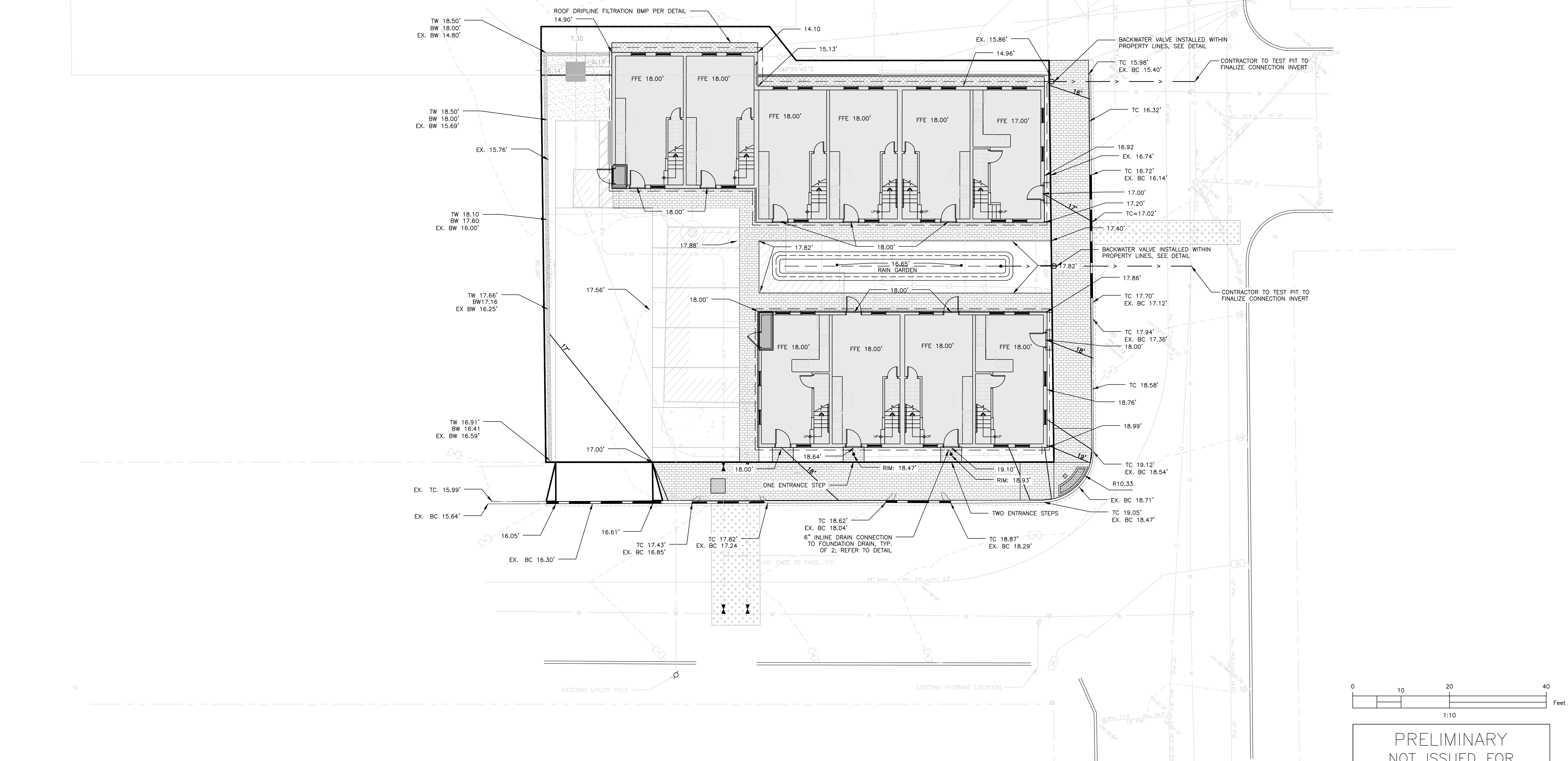
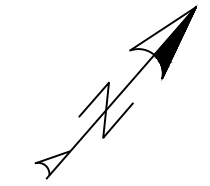

PRELIMINARY
NOT ISSUED FOR
CONSTRUCTION

ISSUED FOR	BY
PRELIMINARY APP	WHS
	DATE
	4/26/16

DRAWING NAME: **GRADING & DRAINAGE PLAN**
 PROJECT NAME: **70 ANDERSON ST REDEVELOPMENT**
 CLIENT: **REDFERN PROPERTIES, LLC**
P.O. BOX 8816 PORTLAND, ME 04104

A C O R N

ENGINEERING, INC.

AS A PROFESSIONAL ENGINEER, I HEREBY CERTIFY THAT I AM A LICENSED PROFESSIONAL ENGINEER IN THE STATE OF MAINE. I AM NOT PROVIDING ANY PROFESSIONAL ENGINEERING SERVICES TO ANY OTHER PROJECTS AT THE SAME TIME AND WITHOUT LIABILITY TO ACOORN ENGINEERING, INC.

158 DANFORTH ST. PORTLAND, MAINE 04102
(207) 775-2655

FILE: 1067_CIVIL
 JN: 1067
 SCALE: 1"=10'
 DESIGNED BY: WHS
 DRAWN BY: QJD
 CHECKED BY: WHS

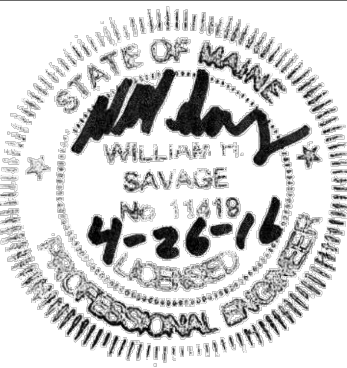

DRAWING NO.
C-30