

TASTING ROOM - RISING TIDE RENOVATION
 103 FOX STREET | PORTLAND, MAINE
 HEATHER & NATHAN SANBORN



DEXTROUS CREATIVE

PORTLAND, ME 04102
 TRACIE REED, ARCHITECT
 NCARB, AIA, LEED AP BD+C
 traciereed@dextrouscreative.com
 207.409.0459 (cell)

STRUCTURAL ENGINEER
 AL HODSON
 RESURGENCE ENGINEERING
 61 INDIA STREET, SUITE 7
 PORTLAND, ME 04101
 AL@RESURGENCEENGINEERING.COM
 207.615.9985 (CELL)

No.	Description	Date

ENLARGED PLAN

Project number 15-24
 Date 08.14.15
 Drawn by TJR
 Checked by TJR

A-1.3

Scale 1/2" = 1'-0"

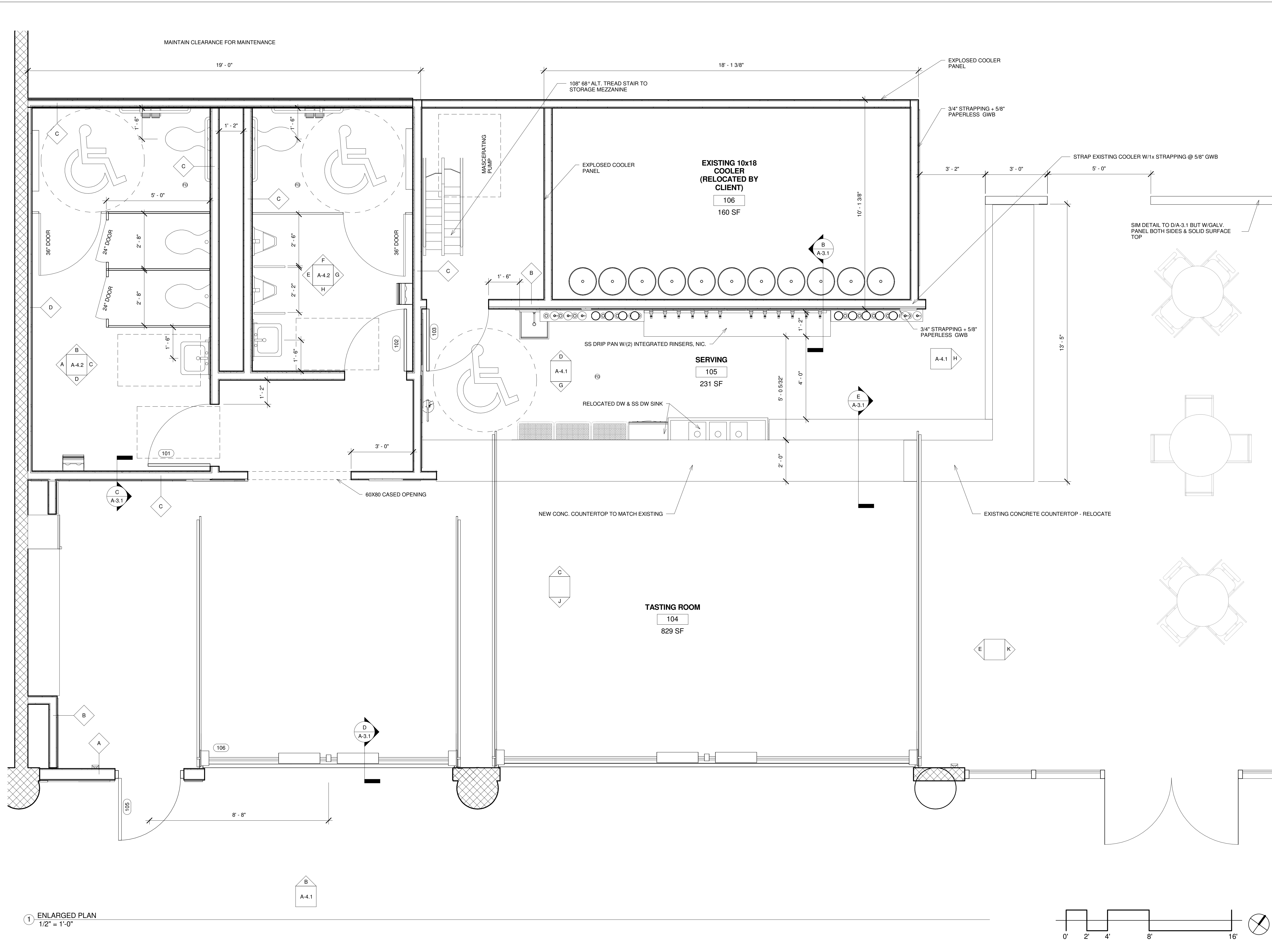

1 ENLARGED PLAN
 1/2" = 1'-0"

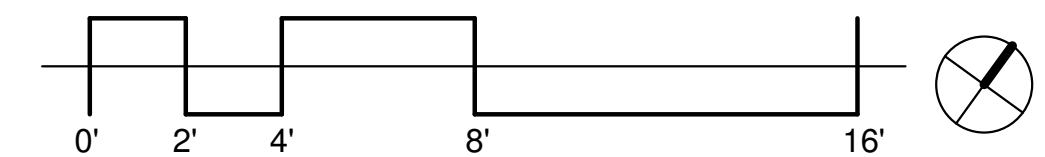

8/14/2015 12:52:28 PM