

© 2017 RYAN SENATORE ARCHITECTURE

# RIISING TIDE BREWING - EXPANSION

103 FOX STREET  
PORTLAND, MAINE 04101



RYAN SENATORE  
**ARCHITECTURE**  
565 CONGRESS ST. SUITE 304  
PORTLAND, MAINE 04101  
207-650-6414  
senatorearchitecture.com

CONSULTANTS:  
**STRUCTURAL:**  
Structural Integrity  
77 Oak Street  
Portland, ME 04101  
207-774-4614

REVISIONS:

DATE: 12 April, 2017  
PROJECT No. 1718  
DRAWN BY: BDH  
CHECKED BY: ACJ  
SCALE: AS NOTED  
SHEET TITLE:

MEZZANINE FRAMING PLAN

S1.1

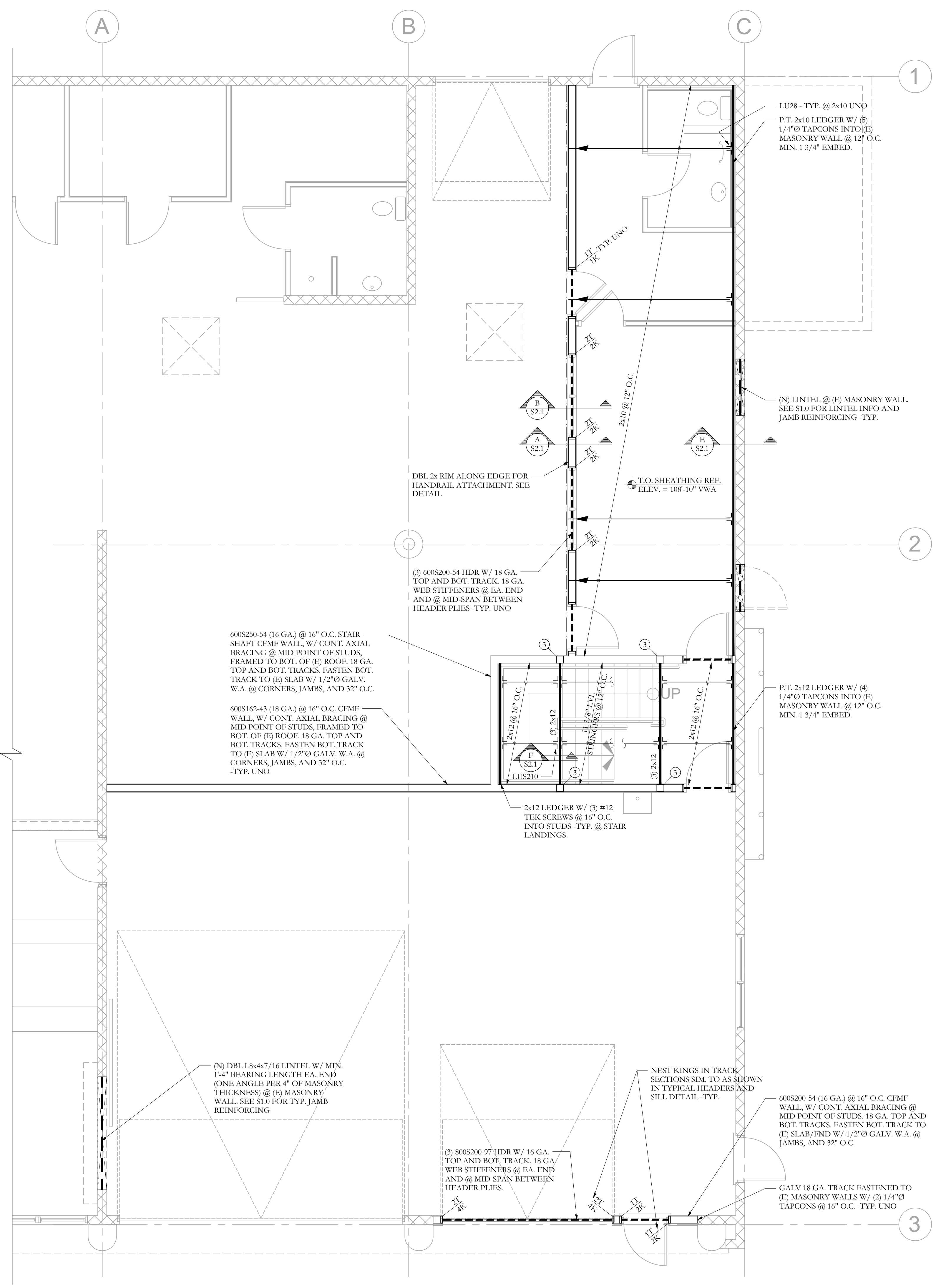

FRAMING PLAN SYMBOLS KEY	
□	CFMF POST
○	STEEL COLUMN
(X)	NUMBER OF CFMF STUDS IN POST BELOW
A	COLUMN ABOVE THIS LEVEL
C	COLUMN CONTINUOUS THROUGH THIS LEVEL
—	JOIST BEARING
—	CONTINUOUS JOIST WITH INTERMEDIATE BEARING
—	FLUSH FRAMED JOIST BEARING WITH HANGER
—	BEARING WALL BELOW
—	SHEAR WALL
X-T	NUMBER OF TRIM STUDS UNDER HEADER
X-K	NUMBER OF KING STUDS ADJACENT TO HEADER

LEGEND	
---	DROPPED BEAM
---	FLUSH BEAM

LAYOUT FLOOR FRAMING TO AVOID CONFLICTS WITH PLUMBING.

### MEZZANINE FRAMING PLAN

SCALE 1/4"=1'-0"

- NOTES:
- SEE SHEET S1.0 FOR GENERAL STRUCTURAL NOTES
  - FLOOR SHEATHING SHALL BE 3/4" -TYP. SEE GENERAL NOTES FOR MORE INFO.
  - USE MIN. #10 SCREWS AT ALL CFMF CONNECTIONS -TYP. UNO
  - TEMPORARY SHORING OF ALL WORK BY CONTRACTOR -TYP.

FOR PERMIT

**Structural Integrity**  
Consulting Engineers, Inc. BUILD WITH CONFIDENCE

77 Oak Street  
Portland, ME, 04101  
p. 207-774-4614  
f. 866-793-7835  
www.structuralintec.com

SI # 17-0113