

TASTING ROOM - RISING TIDE RENOVATION
 103 FOX STREET | PORTLAND, MAINE
 HEATHER & NATHAN SANBORN



DEXTRIOUS CREATIVE
 PORTLAND, ME 04102
 TRACIE REED, ARCHITECT
 NCARB, AIA, LEED AP BD+C
 traciereed@dextrouscreative.com
 207.409.0459 (cell)

STRUCTURAL ENGINEER
 AL HODSON
 RESURGENCE ENGINEERING
 61 INDIA STREET, SUITE 7
 PORTLAND, ME 04101
 AL@RESURGENCEENGINEERING.COM
 207.615.9985 (CELL)

No.	Description	Date
1	Revision 1	Date 1

MEZZANINE/FRAMING PLAN

Project number 15-24
 Date 08.27.15
 Drawn by TJR
 Checked by TJR

A-1.2

Scale 1/4" = 1'-0"

9/25/2015 2:13:34 PM

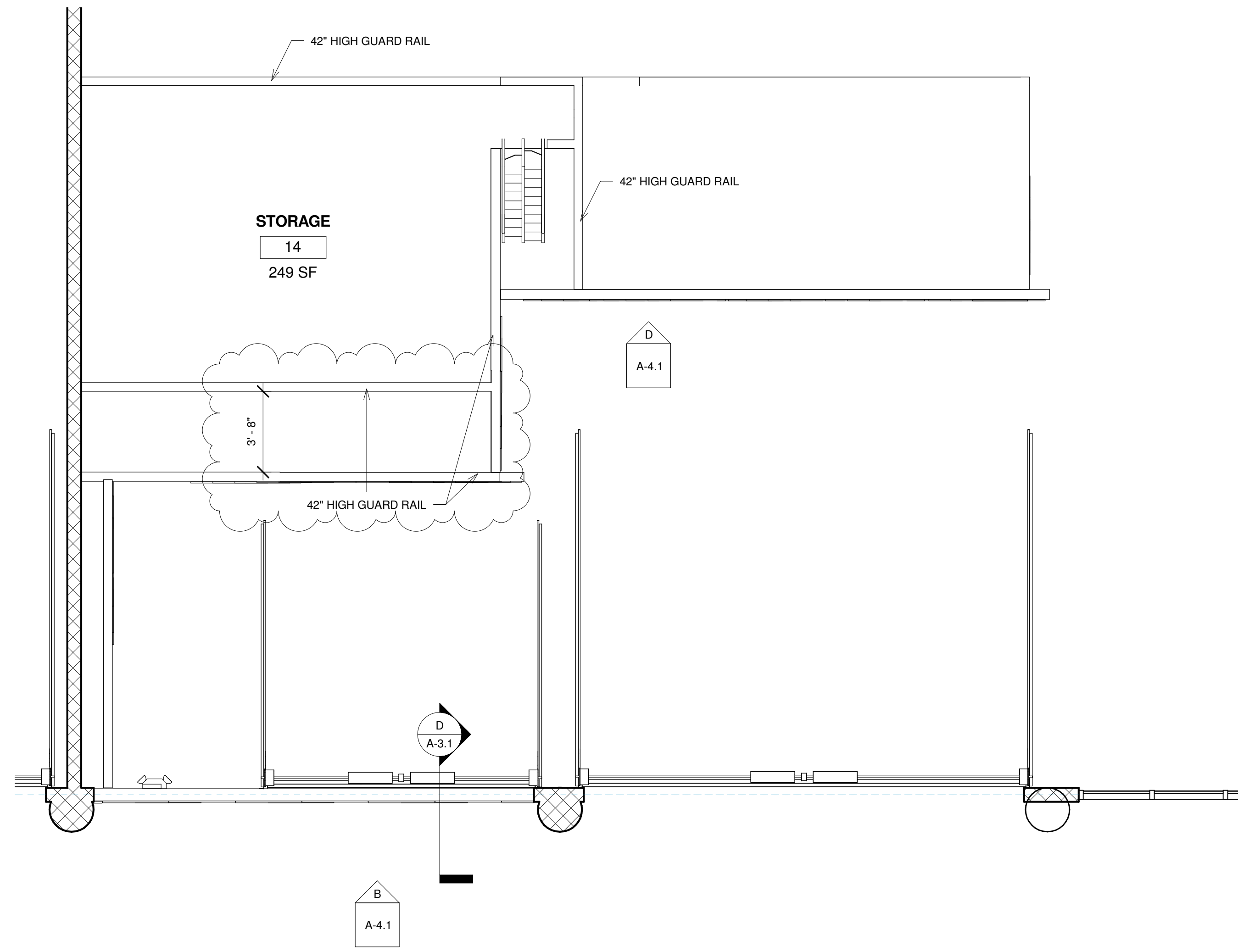

A MEZZANINE
 1/4" = 1'-0"

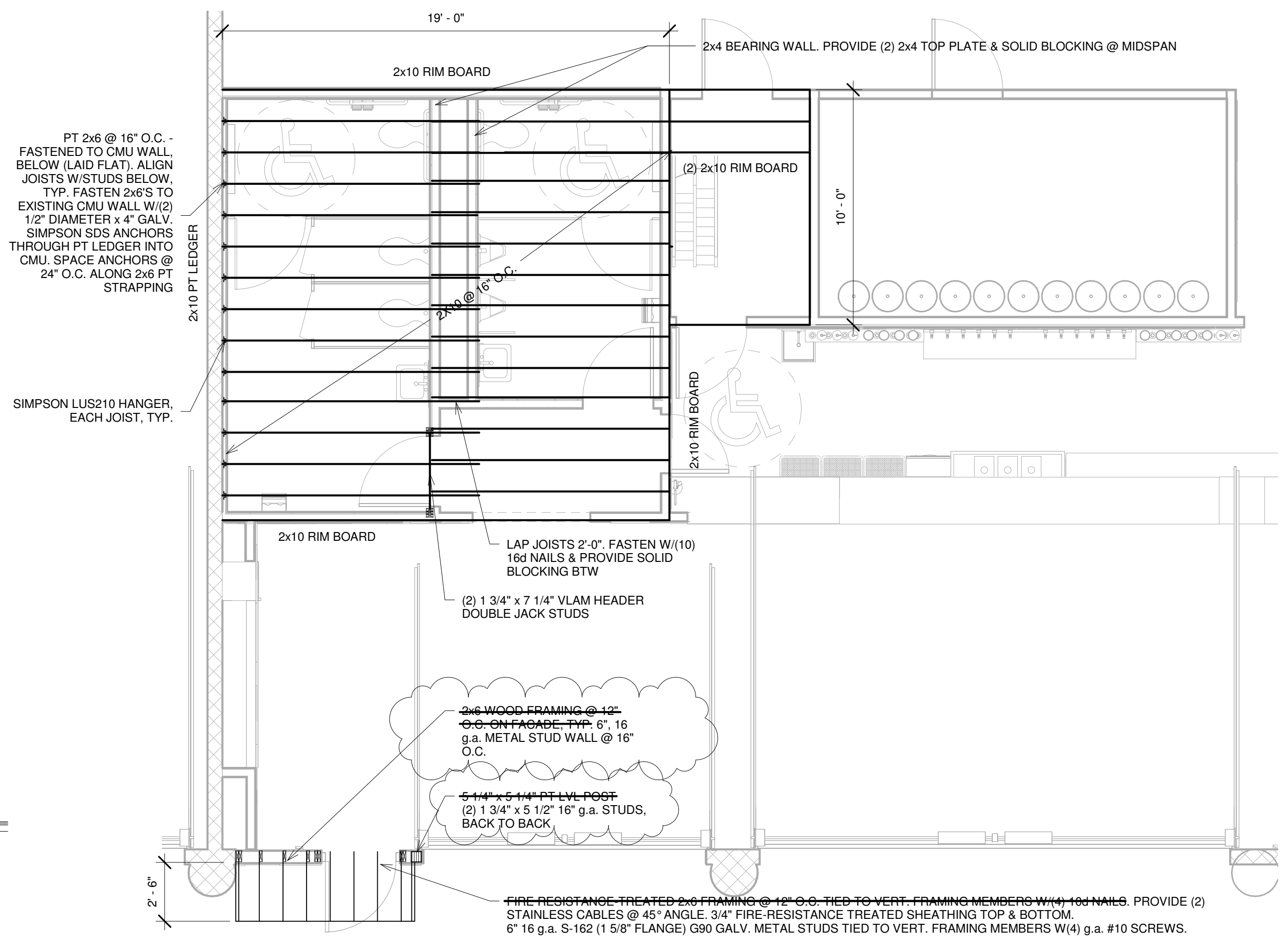

B MEZZANINE FRAMING PLAN
 1/4" = 1'-0"

FRAMING NOTES
 -PROVIDE SOLID WOOD BLOCKING @ MID SPAN FOR FLOOR/CEILING JOISTS, TYP.
 -USE PRESSURE TREATED FRAMING BELOW 7'-0". ALL COLD FORM STEEL SPECIFIED AS CLARKWESTERN BUILDING SYSTEMS PRODUCTS, AND BY G90 GALVANIZED
 -PROVIDE BLOCKING IN WALLS FOR ALL PLUMBING FIXTURES, BATHROOM ACCESSORIES, AND LIFE SAFETY DEVICES
 -ALL SCREW FASTENERS SHALL BE GALVANIZED #10 SCREWS
 -COLD-FORMED STEEL INSTALLER TO COORDINATE MATERIAL SUBMITTALS W/ENGINEER
 -METAL STUDS SHALL BE 16 g.a. 5 1/2" DEEP

