

TASTING ROOM - RISING TIDE RENOVATION
 103 FOX STREET | PORTLAND, MAINE
 HEATHER & NATHAN SANBORN



DEXTRIOUS CREATIVE
 PORTLAND, ME 04102
 TRACIE REED, ARCHITECT
 NCARB, AIA, LEED AP BD+C
 traciereed@dextrouscreative.com
 207.409.0459 (cell)

STRUCTURAL ENGINEER
 AL HODSON
 RESURGENCE ENGINEERING
 61 INDIA STREET, SUITE 7
 PORTLAND, ME 04101
 AL@RESURGENCEENGINEERING.COM
 207.615.9985 (CELL)

No.	Description	Date

FIRST FLOOR PLAN & SCHEDULES
 Project number 15-24
 Date 08.27.15
 Drawn by TJR
 Checked by TJR
A-1.1
 Scale As indicated

9/25/2015 2:13:52 PM

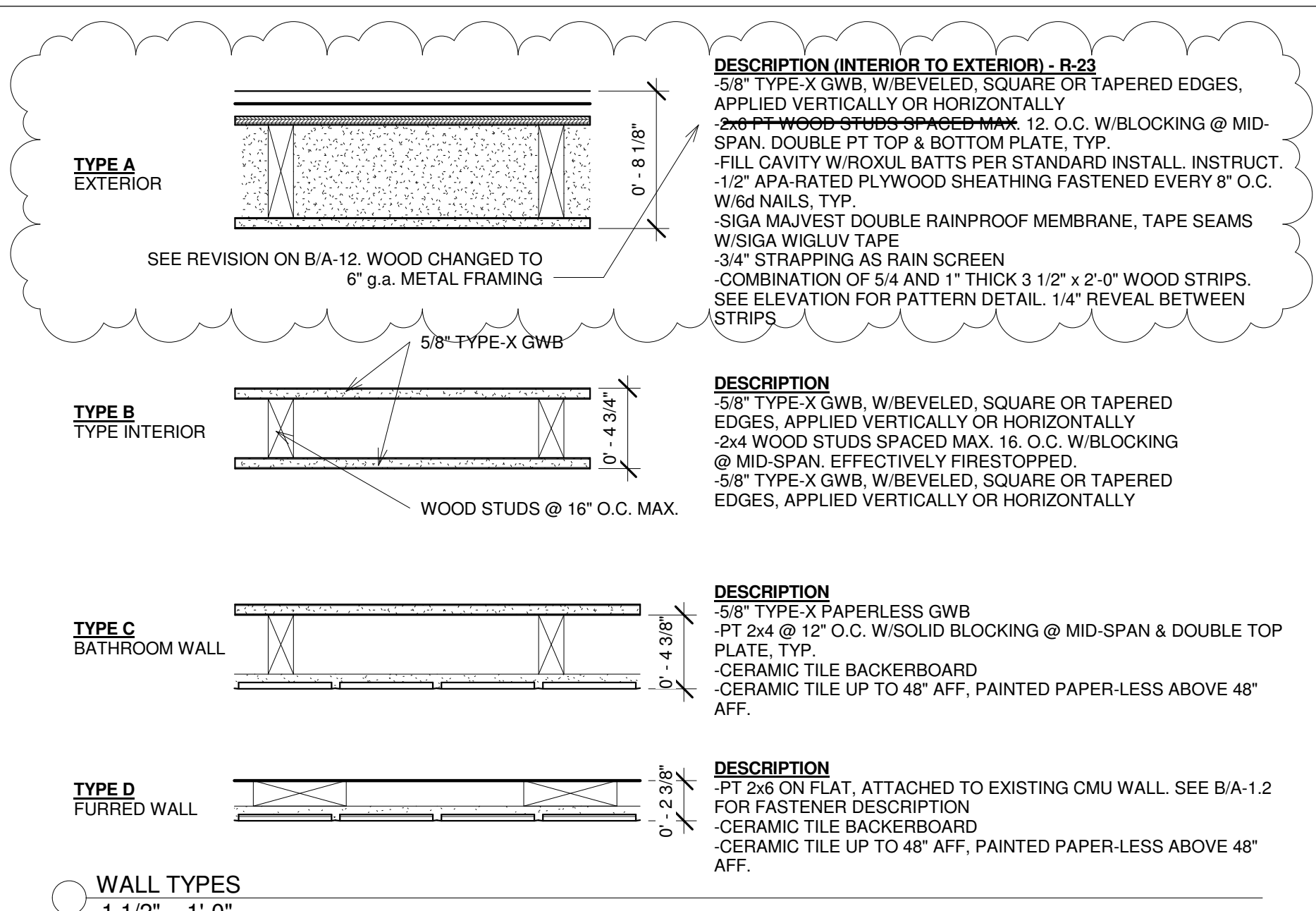
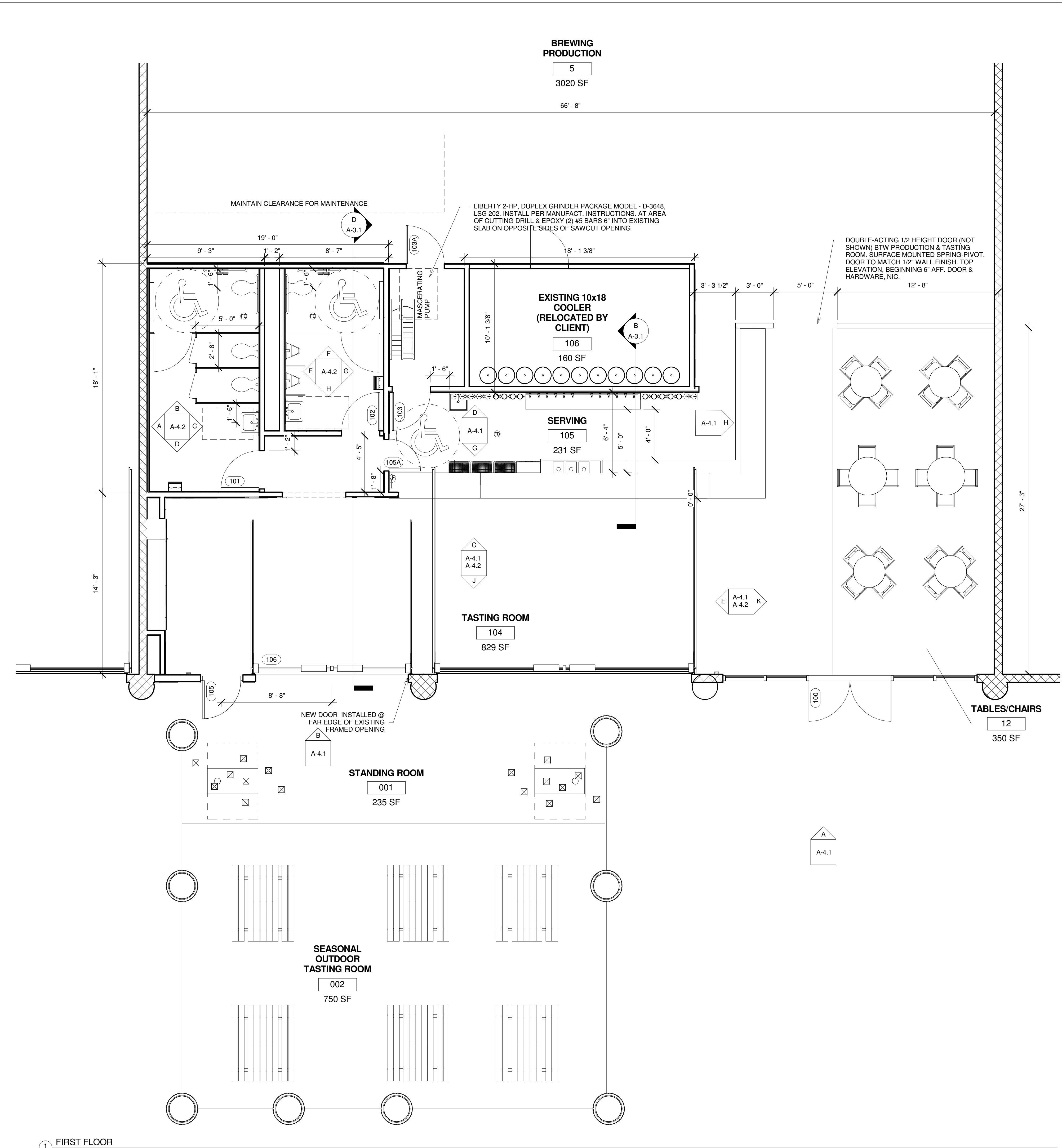

ROOM FINISH SCHEDULE

#	NAME	FLOOR	BASE	WALL	CEILING	Comments
104	TASTING ROOM	CONC.	AZEK	P	N/A	SEE ELEVATIONS/SECTIONS
101	WOMENS	TILE	TILE	P	GWB	TILE PATTERN PLAN TBD
102	MENS	TILE	TILE	P	GWB	TILE PATTERN PLAN TBD
103	STOR.	CONC.	AZEK	P	GWB	

DOOR SCHEDULE

#	TYPE	WIDTH	HEIGHT	FRAME	PANEL	HARDWARE	COMMENTS
100	C	6'-5 1/2"	6'-8 1/4"	Alum	Alum	1	NEW HARDWARE ONLY
101	A	3'-0"	6'-8"	Steel	WD	2	
102	A	3'-0"	6'-8"	Steel	WD	2	
103	A	3'-0"	6'-8"	Steel	WD	4	
103A	A	3'-0"	6'-8"	Steel	WD	4	
105	B	3'-0"	7'-0"	Alum	Alum	5	
105A	38	2'-6"	6'-8"	Steel	WD	4	
105B	A	3'-0"	6'-8"	Steel	Steel	3	

FINISH NOTES
 PAINT: PROVIDE LOW/NO-VOC WASHABLE, LATEX PAINT, (UNO. COLOR) PER CLIENT. NOTE ALL SURFACES SPECIFIED TO BE PAINTED SHALL BE DRY, CLEANED AND FREE OF ALL DIRT, GRIT, GREASE, MOLD, MILDEW, FOREIGN SUBSTANCES, AND ALL LOOSE, PEELING, BLISTERING, CHALKING OR SCALING PAINT. NO EXTERIOR PAINTING SHALL BE DONE OF THE TEMPERATURE IS BELOW 50 DEGREES F, OR IMMEDIATELY FOLLOWING RAIN, FROST. ALL CONDENSATION MUST BE DRIED. CONTRACTOR TO PROTECT FLOORS, AND FINISH SURFACES DURING PAINTING.
 BASE TRIM: PROVIDE 5 1/2" AZEK TRIM
 CONCRETE FLOOR: NO FINISHING
 TILE: FLOOR AND WALL TILE TBD

LOADING SETS
 NOTE: ALL HARDWARE SETS SHALL BE COMMERCIAL-GRADE II, ADA-COMPLIANT, SATIN CHROME FINISH. EXTERIOR DOORS SHALL BE INSTALLED WITH FIRE EXIT HARDWARE, CONFORMING TO UL10C AND UL 305. MAXIMUM LATCHFORCE SHALL NOT EXCEED 15 POUNDS. PROVIDE WEATHER STRIPPING ON NEW EXTERIOR DOORS.
 1 | ADA-PUSH PLATES (INTERIOR & EXTERIOR) WITH LOW-ENERGY DOOR OPERATOR, SURFACE-MOUNT VERTICAL ROD FIRE EXIT DEVICE (EXISTING DOOR RETROFIT), FIRE EXIT HARDWARE, TOP LATCH BOLT, CLOSER, MECHANICAL DOGGING
 2 | PULL/PUSH PLATE, KICKPLATE, DOOR STOP, SILENCER
 3 | UL 325 COMPLIANT COMMERCIAL DOOR OPERATOR, GALVANIZED STEEL HIGH-LIFT TRACKS, INTERIOR SPRING LOCK
 4 | DUMMY LEVER, KICKPLATE (BOTH SIDES), DOOR STOP, SILENCER
 5 | NARROW RIM DEVICE, CLOSER, LATCH BOLT, MECHANICAL DOGGING, ALUMINUM SADDLE THRESHOLD, WEATHER STRIPPING

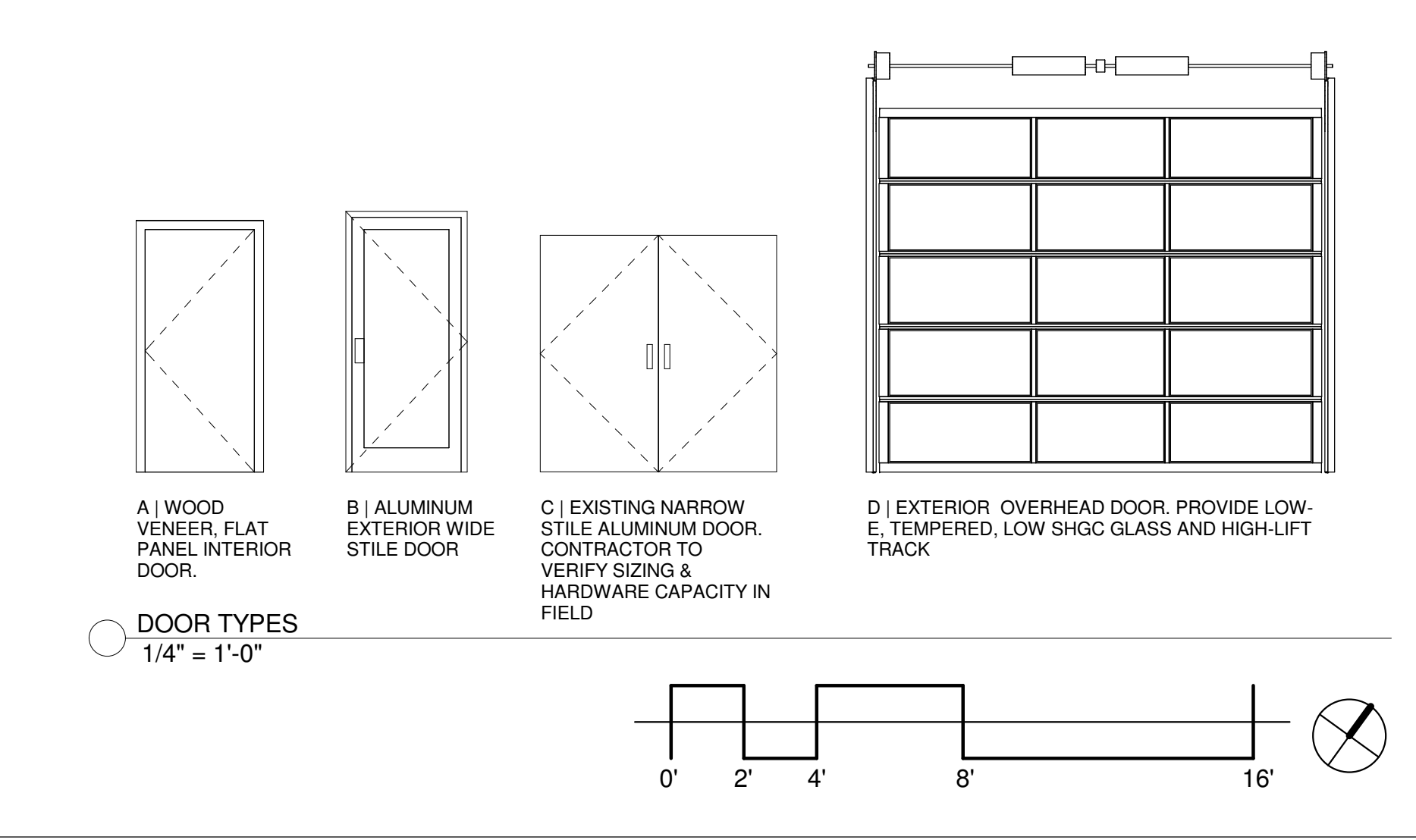

1 FIRST FLOOR
 1/4" = 1'-0"