

DISPLAY THIS CARD ON PRINCIPAL FRONTAGE OF WORK CITY OF PORTLAND

Please Read Application And Notes, If Any, Attached

BUILDING INSPECTION

PERMIT

Permit Number: 060849

This is to certify that FOX STREET REALTY LLC/Todd Sawyer

has permission to build a temporary shelter, no foundation

AT 115 FOX ST

023 A008001

*Application Expired
and abandoned
1/15/08*

provided that the person or persons, firm or corporation accepting this permit shall comply with all of the provisions of the Statutes of this State and of the Ordinances of the City of Portland regulating the construction, maintenance and use of buildings and structures, and of the application on file in this department.

Apply to Public Works for street line and grade if nature of work requires such information.

Notification of inspection must be given and when permission procured before this building or part thereof is locked or closed-in. 24 HOUR NOTICE IS REQUIRED.

A certificate of occupancy must be procured by owner before this building or part thereof is occupied.

OTHER REQUIRED APPROVALS

Fire Dept. _____

Health Dept. _____

Appeal Board _____

Other _____

Department Name

Director - Building & Inspection Services

PENALTY FOR REMOVING THIS CARD

City of Portland, Maine - Building or Use Permit Application

389 Congress Street, 04101 Tel: (207) 874-8703, Fax: (207) 874-8716

Permit No: 06-0849	Issue Date:	CBL: 023 A008001
-----------------------	-------------	---------------------

Location of Construction: 115 FOX ST	Owner Name: FOX STREET REALTY LLC	Owner Address: 299 FOREST AVE	Phone:
Business Name:	Contractor Name: Todd Sawyer	Contractor Address: 131 Orchard Hill Rd. Dresden	Phone 2077740111
Lessee/Buyer's Name	Phone:	Permit Type: Additions - Commercial	Zone: <i>FLB</i>

Past Use: Commercial	Proposed Use: Commercial/ build a temporary shelter, no foundation	Permit Fee: \$66.00	Cost of Work: \$4,500.00	CEO District: 1
		FIRE DEPT: <i>11.9.1.6</i> <input checked="" type="checkbox"/> Approved <input type="checkbox"/> Denied <i>Flame resistance certification</i>	INSPECTION: Use Group: Type:	

Proposed Project Description:
build a temporary shelter, no foundation
Application required and abandoned 1/15/08

Signature: <i>Carey Cross</i>	Signature:
PEDESTRIAN ACTIVITIES DISTRICT (P.A.D.)	
Action: <input type="checkbox"/> Approved <input type="checkbox"/> Approved w/Conditions <input type="checkbox"/> Denied	
Signature:	Date:

Permit Taken By: Idobson	Date Applied For: 06/09/2006	Zoning Approval	
-----------------------------	---------------------------------	------------------------	--

<ol style="list-style-type: none"> This permit application does not preclude the Applicant(s) from meeting applicable State and Federal Rules. Building permits do not include plumbing, septic or electrical work. Building permits are void if work is not started within six (6) months of the date of issuance. False information may invalidate a building permit and stop all work.. 	Special Zone or Reviews <input type="checkbox"/> Shoreland <input type="checkbox"/> Wetland <input type="checkbox"/> Flood Zone <input type="checkbox"/> Subdivision <input type="checkbox"/> Site Plan Maj <input type="checkbox"/> Minor <input type="checkbox"/> MM <input type="checkbox"/> Date: <i>12/29/06</i>	Zoning Appeal <input type="checkbox"/> Variance <input type="checkbox"/> Miscellaneous <input type="checkbox"/> Conditional Use <input type="checkbox"/> Interpretation <input type="checkbox"/> Approved <input type="checkbox"/> Denied Date:	Historic Preservation <input checked="" type="checkbox"/> Not in District or Landmark <input type="checkbox"/> Does Not Require Review <input type="checkbox"/> Requires Review <input type="checkbox"/> Approved <input type="checkbox"/> Approved w/Conditions <input type="checkbox"/> Denied Date:
	Date: <i>12/29/06</i>		

CERTIFICATION

I hereby certify that I am the owner of record of the named property, or that the proposed work is authorized by the owner of record and that I have been authorized by the owner to make this application as his authorized agent and I agree to conform to all applicable laws of this jurisdiction. In addition, if a permit for work described in the application is issued, I certify that the code official's authorized representative shall have the authority to enter all areas covered by such permit at any reasonable hour to enforce the provision of the code(s) applicable to such permit.

SIGNATURE OF APPLICANT	ADDRESS	DATE	PHONE
RESPONSIBLE PERSON IN CHARGE OF WORK, TITLE		DATE	PHONE

City of Portland, Maine - Building or Use Permit

389 Congress Street, 04101 Tel: (207) 874-8703, Fax: (207) 874-8716

Permit No: 06-0849	Date Applied For: 06/09/2006	CBL: 023 A008001
------------------------------	--	----------------------------

Location of Construction: 115 FOX ST	Owner Name: FOX STREET REALTY LLC	Owner Address: 299 FOREST AVE	Phone:
Business Name:	Contractor Name: Todd Sawyer	Contractor Address: 131 Orchard Hill Rd. Dresden	Phone (207) 774-0111
Lessee/Buyer's Name	Phone:	Permit Type: Additions - Commercial	

Proposed Use: Commercial/ build a temporary shelter, no foundation	Proposed Project Description: build a temporary shelter, no foundation
--	--

Dept: Zoning **Status:** Approved with Conditions **Reviewer:** Marge Schmuckal **Approval Date:** 06/28/2006

Note: 06282006 spoke with Todd Sawter - this shelter is for the storage of a motor home - it definately is not to be lived in **Ok to Issue:**

- 1) This permit is being approved on the basis of plans submitted. Any deviations shall require a separate approval before starting that work.
- 2) It is understood by this office that the motor home that is being stored is NOT for a residential use on site. It will not be lived in nor hooked up to utilities. This motor home is only being stored on site between uses when it is used for traveling off site.

Dept: Building **Status:** Pending **Reviewer:** Mike Nugent **Approval Date:**

Note: **Ok to Issue:**

Dept: Fire **Status:** Approved with Conditions **Reviewer:** Cptn Greg Cass **Approval Date:** 06/29/2006

Note: **Ok to Issue:**

- 1) Flame resistance certificate required for all membrane structures.

Comments:

6/30/2006-mjn: Left message with the applicant regarding duration of time, is it is greater than 180 days it is considered permanent and needs to meet snow loads etc.

This page contains a detailed description of the Parcel ID you selected. Press the **New Search** button at the bottom of the screen to submit a new query.

Current Owner Information

Card Number 1 of 1
Parcel ID 023 A008001
Location 115 FOX ST
Land Use TRANSPORTATION

Owner Address FOX STREET REALTY LLC
 299 FOREST AVE
 PORTLAND ME 04101

Book/Page 18533/243
Legal 23-A-8
 FOX ST 91-123 BOYD ST 105-121
 DIAMOND ST 2-18
 101124 SF

Current Assessed Valuation For Fiscal Year 2006

Land	Building	Total
\$264,610	\$767,670	\$1,032,280

Estimated Assessed Valuation For Fiscal Year 2007*

Land	Building	Total
\$291,700	\$942,500	\$1,234,200

* Value subject to change based upon review of property status as of 4/1/06.
 The tax rate will be determined by City Council in May 2006.

Building Information

Bldg #	Year Built	# Units	Bldg Sq. Ft.	Identical Units
1	1950	1	23736	1

Total Acres	Total Buildings	Sq. Ft.	Structure Type	Building Name
2.321	23736		AUTO SERVICE	FREIGHTLINER OF MAINE

Exterior/Interior Information

Section	Levels	Size	Use
1	01/01	23736	AUTO PARTS/SERVICE

Height	Walls	Heating	A/C
17	CONC. BLOCK	UNIT HEAT	NONE
		NONE	NONE
		NONE	NONE
		NONE	NONE
		NONE	NONE
		NONE	NONE
		NONE	NONE
		NONE	NONE

Building Other Features

Line	Structure Type	Identical Units
1	OVERHEAD DOOR - MOTOR OPR. WD/	9
1	OVERHEAD DOOR - WD/MT	4
1	OVERHEAD DOOR - WD/MT	1
1	OVERHEAD DOOR - MOTOR OPR. STE	1

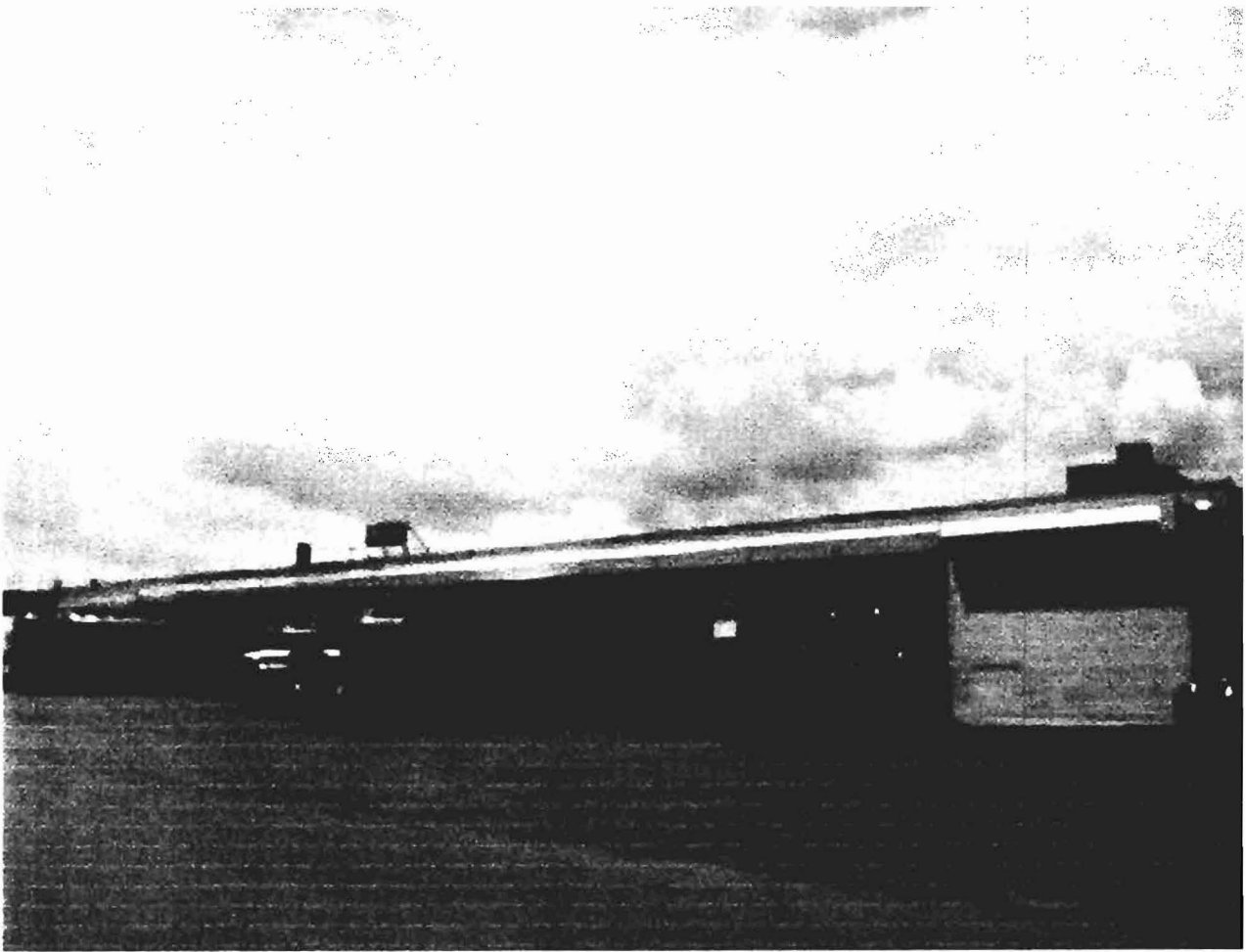



General Building Permit Application

If you or the property owner owes real estate or personal property taxes or user charges on any property within the City, payment arrangements must be made before permits of any kind are accepted.

Location/Address of Construction: <u>115 FOX STREET</u>		
Total Square Footage of Proposed Structure <u>936</u>		Square Footage of Lot <u>APPROX 3 ACRES</u>
Tax Assessor's Chart, Block & Lot Chart# <u>23</u> Block# <u>A</u> Lot# <u>8</u>	Owner: <u>FOX ST REALTY, DOUG CARDENTE</u>	Telephone: <u>233-7229 MIKE CARDENTE</u>
Lessee/Buyer's Name (If Applicable) <u>STEPHEN GRISWOLD</u>	Applicant name, address & telephone: <u>STEPHEN GRISWOLD 301 CITADOURS WALK PORT. ME. 774-6070</u>	Cost Of Work: \$ <u>4,500.-</u> Fee: \$ _____ C of O Fee: \$ <u>66⁰⁰</u>
Current Specific use: <u>PARKING AREA - PAVEMENT</u> If vacant, what was the previous use? _____ Proposed Specific use: _____		
Project description: <u>TEMPORANT SHELTER FOR STORAGE & WAREHOUSING</u> <u>METAL TUBE FRAME + WHITE POLY TARP</u> <u>(NO FOUNDATION)</u> <u>not to be lived in - just storage</u>		
Contractor's name, address & telephone: Who should we contact when the permit is ready: <u>TODD SAUTER</u> Mailing address: _____ Phone: <u>522-6968</u>		

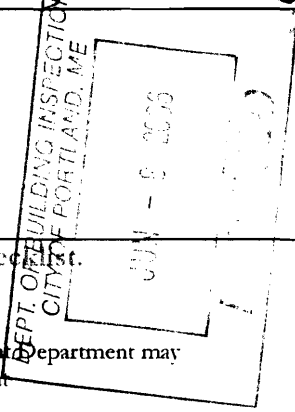

Please submit all of the information outlined in the Commercial Application Check sheet. Failure to do so will result in the automatic denial of your permit.

In order to be sure the City fully understands the full scope of the project, the Planning and Development Department may request additional information prior to the issuance of a permit. For further information visit us on-line at www.portlandmaine.gov, stop by the Building Inspections office, room 315 City Hall or call 874-8703.

I hereby certify that I am the Owner of record of the named property, or that the owner of record authorizes the proposed work and that I have been authorized by the owner to make this application as his/her authorized agent. I agree to conform to all applicable laws of this jurisdiction. In addition, if a permit for work described in this application is issued, I certify that the Code Official's authorized representative shall have the authority to enter all areas covered by this permit at any reasonable hour to enforce the provisions of the codes applicable to this permit.

Signature of applicant: <u>STEPHEN GRISWOLD</u>	Date: <u>JUNE 6, 2006</u>
---	---------------------------

This is not a permit; you may not commence ANY work until the permit is issued.

Diamond St

ILB

No min lot size

100% impervious surface

MAX bldg height: 45'

Side setback: none

Rear setback: none

Front setback: none

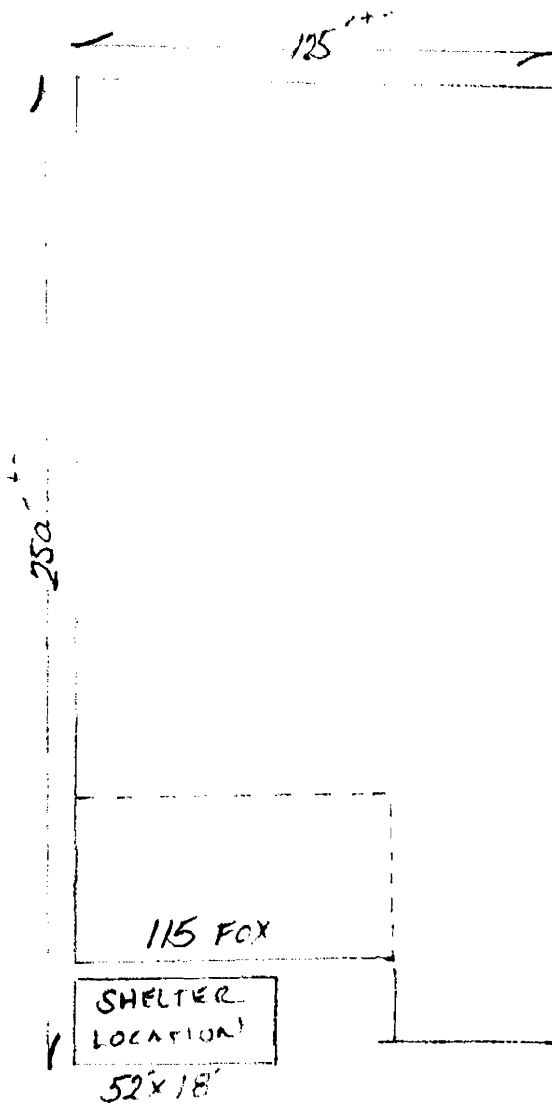

Fox St

Boyd St



1440 Field of Dream Way, Dyersville, IA 52040
 1-800-603-4445 or Contact Us
 www.clearspan.com

ClearSpan NorthStar RV Garage 18'W x 16'H x 52'L
 Item# PB01840R4N

Protect your recreational investment! Our motor home and boat storage solution keeps the elements from damaging and reducing the value of your prized possessions.

- Manufactured from 2.375" OD Allied Gatorshield® structural steel tubing.
- 14 gauge pipe.
- One double-zippered (12'6"H x 9'10"W) door with our "Twist of the Wrist" assembly.
- One solid end panel.
- 12.5 oz. premium forest green cover comes with a 15 year warranty.
- Can be built on any surface.
- Comes complete with heavy-duty mounting feet with predrilled fastening holes.
- Made in the USA.



Please Note: If this building will be used in a heavy snowfall region, we recommend upgrading to a 3 ft. rafter spacing. Please see accessories listed below.

MAIN IMAGE

Our Price: \$3,495.00 / EA

Weight	2463.000
Availability	Manufactured Product - Available in 8 days
width	18'
height	16'
length	52'
cover material weight	12.5 ounce
end frame	Included
end material	Same as cover
frame material	Allied Gatorshield Steel
pipe gauge	14
pipe diameter	2.375"
rafter spacing	4'
number of doors	1
door size	9'10"W x 12'6"H
door type	Poly roll-up
cover material warranty	15 year
Instructions	Instructions (PDF Format)
Warranty	Warranty Document

Recommended Accessories



Ground Anchor

105587 Anchor Kit

B

EARTH ANCHOR ASSEMBLY (SKU: 105587) WITHOUT CONCRETE

If the optional anchor kit was purchased, use the diagrams below to properly install the auger-style earth anchor and to attach the brackets to the rafter pipes. For rafter pipe diameters greater than what is shown, consult the instructions that shipped with the kits to properly attach the anchor mounting brackets.

IMPORTANT: The length of the auger-style anchor shown in this example is 30".

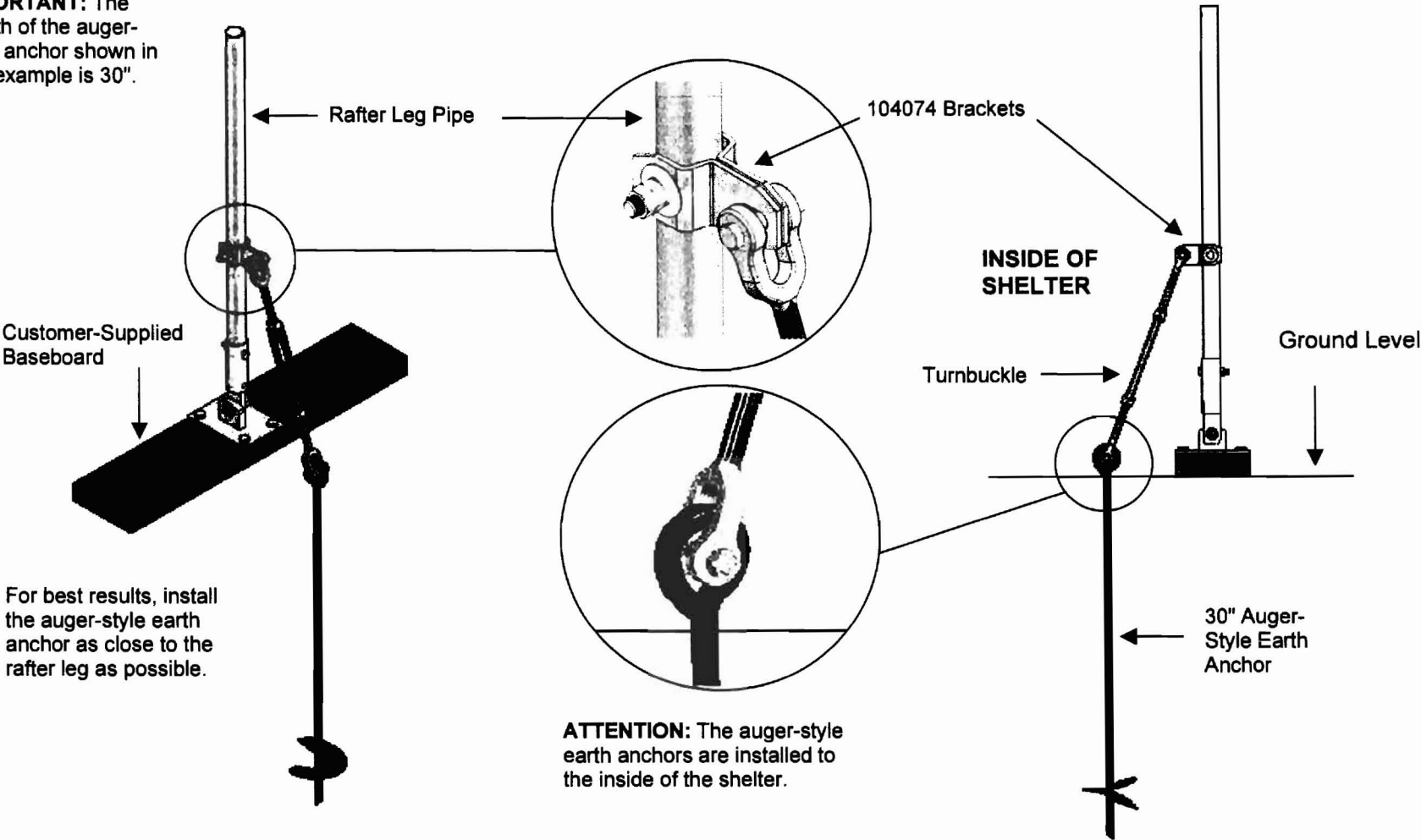

For best results, install the auger-style earth anchor as close to the rafter leg as possible.

ATTENTION: The auger-style earth anchors are installed to the inside of the shelter.