

**BAYSIDE EAST**  
 PROPOSED ELDERLY HOUSING  
 47 SMITH STREET, PORTLAND  
 FOR BAYSIDE EAST LP

TFH ARCHITECTS  
 100 COMMERCIAL STREET  
 PORTLAND MAINE 04101  
 TELEPHONE 207 775 6141  
 ARCHITECTURE PLANNING

CONSULTANTS:  
**BENNETT ENGINEERING**  
 CONSULTING ENGINEERS  
Portland, ME 04101

REVISIONS:

DATE: MAY 18, 2007  
 PROJECT No. 0514  
 DRAWN BY: SPD  
 CHECKED BY: CWA  
 SCALE: AS NOTED

SHEET TITLE:  
 EXTERIOR  
 ELECTRICAL  
 PLAN

E1.1

| LIGHTING FIXTURE SCHEDULE |                                      |                       |  |
|---------------------------|--------------------------------------|-----------------------|--|
| TYPE                      | DESCRIPTION                          | LAMPS QUANTITY & TYPE | REMARKS  |
| AA                        | LITHONIA KSF1-R4SC-TB-WB04-LPI(240V) | (1) 175W MH           | BUILDING MOUNTED - MOUNTING HEIGHT BY ARCHITECT                                      |
| BB                        | LITHONIA KSF1-R4SC-TB-SP04-LPI(240V) | (1) 175W MH           | POLE MOUNTED   |
| CC                        | PROGRESS *P6805-31 (120V)            | (1) 13W CF            | STEP LIGHT   |
| DD                        | PROGRESS *P5229-31 (12V)             | (1) 75W PAR 36        | LANDSCAPE UP LIGHT - PROVIDE (1) PROGRESS *P8591-30 12V TRANSFORMER FOR (3) FIXTURES |

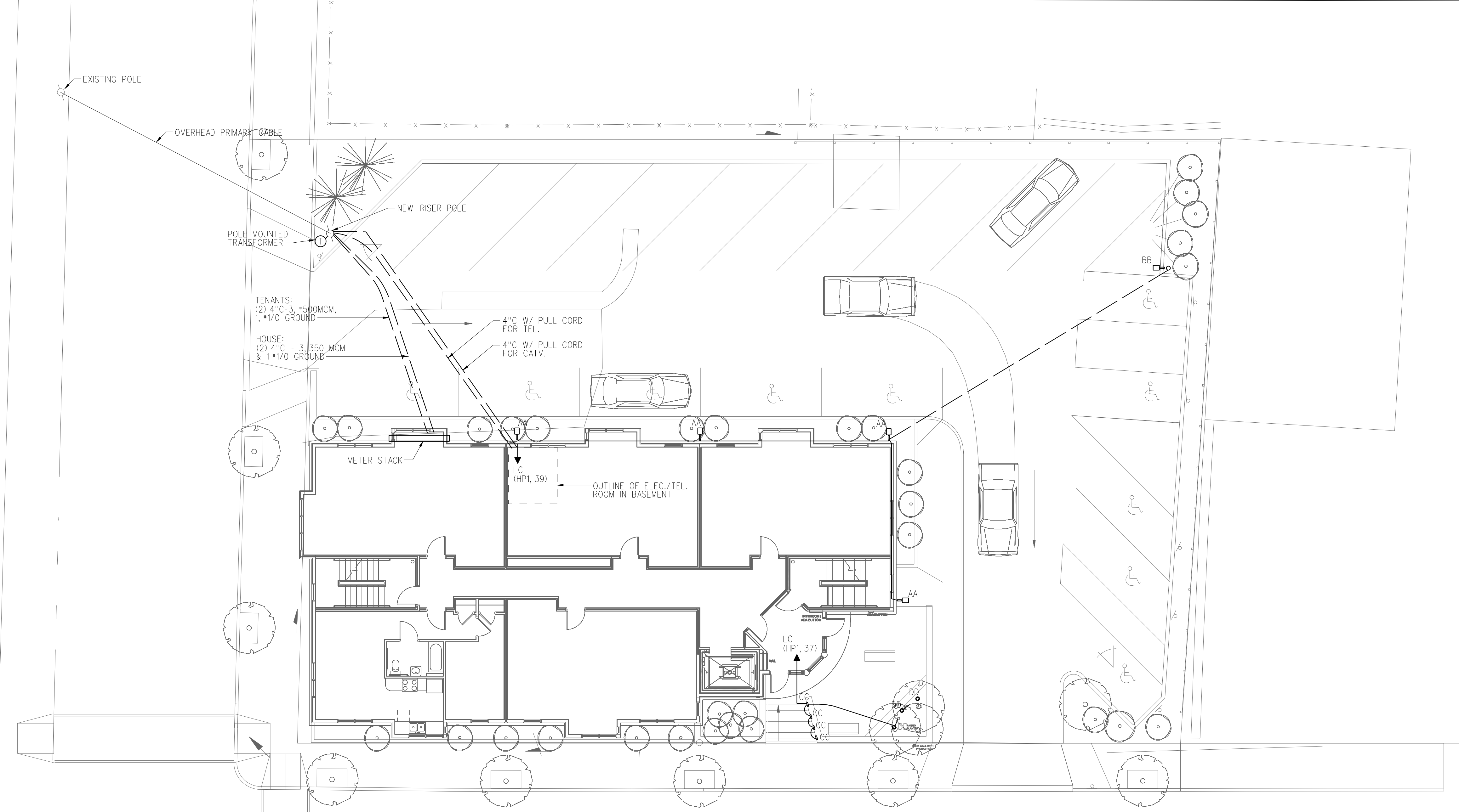

EXTERIOR ELECTRICAL PLAN  
 SCALE: 1"=10'-0"

