

© 2007 TFH ARCHITECTS

BAYSIDE EAST

PROPOSED ELDERLY HOUSING
47 SMITH STREET, PORTLAND
FOR BAYSIDE EAST LP

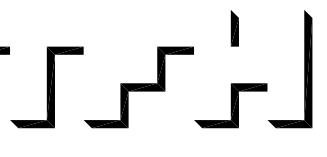

TFH ARCHITECTS
100 COMMERCIAL STREET
PORTLAND MAINE 04101
TELEPHONE 207 775 6141
ARCHITECTURE PLANNING

CONSULTANTS:

CM/LL
Pishman and Greer Consulting Engineers
350 US. Route 1
Falmouth, ME 04105
207-781-5242
STRUCTURAL:
Structural Design Consulting
22 Oakmont Drive
206 Orchard Beach, ME 04094
207-934-8038
MECHANICAL AND ELECTRICAL:
Bennett Engineering
7 Bennett Road
Fresno, ME 04032
207-855-9475

REVISIONS:

DATE: 05/18/07
PROJECT No. 0514
DRAWN BY: RJS
CHECKED BY: TST
SCALE: AS NOTED

SHEET TITLE:
STAIR PLANS
SECTIONS AND
DETAILS

A6.0

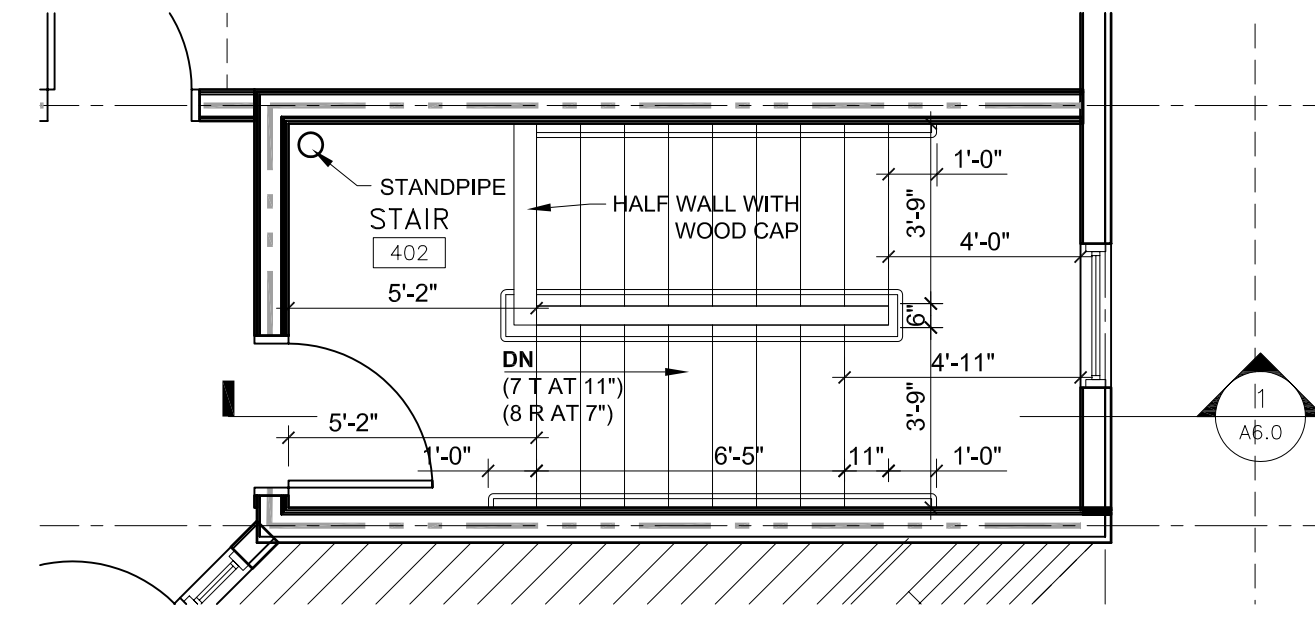

7 STAIR 402 - FOURTH FLOOR PLAN
A6.0 1/4" = 1'-0"

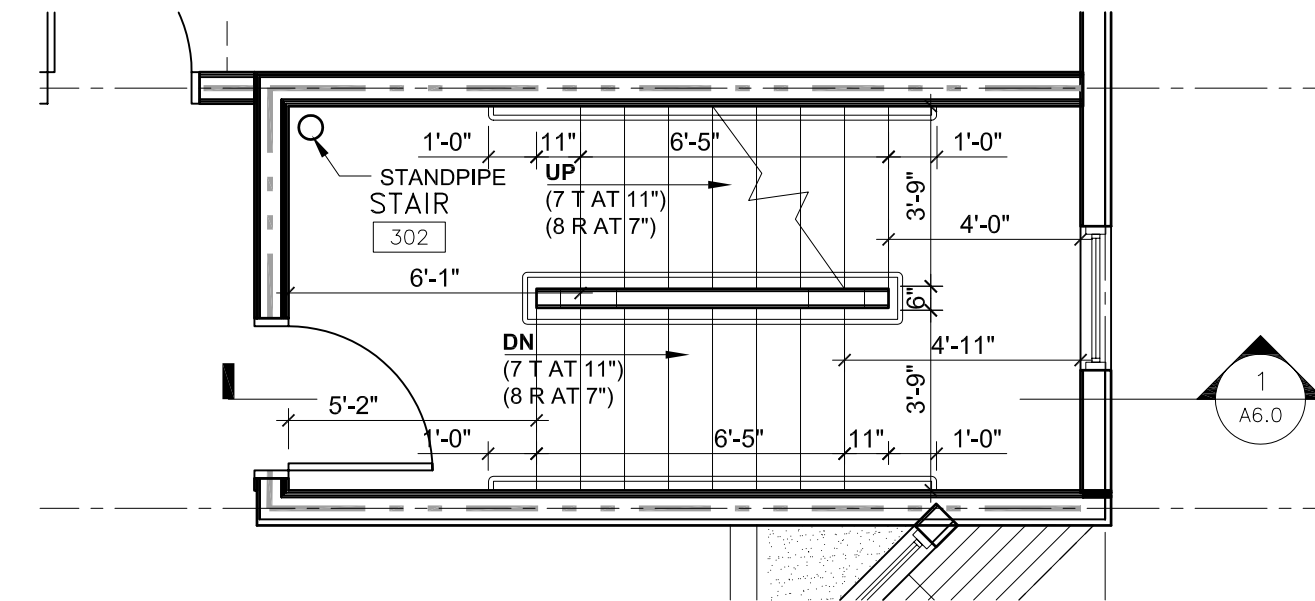

6 STAIR 302 - THIRD FLOOR PLAN
A6.0 1/4" = 1'-0"

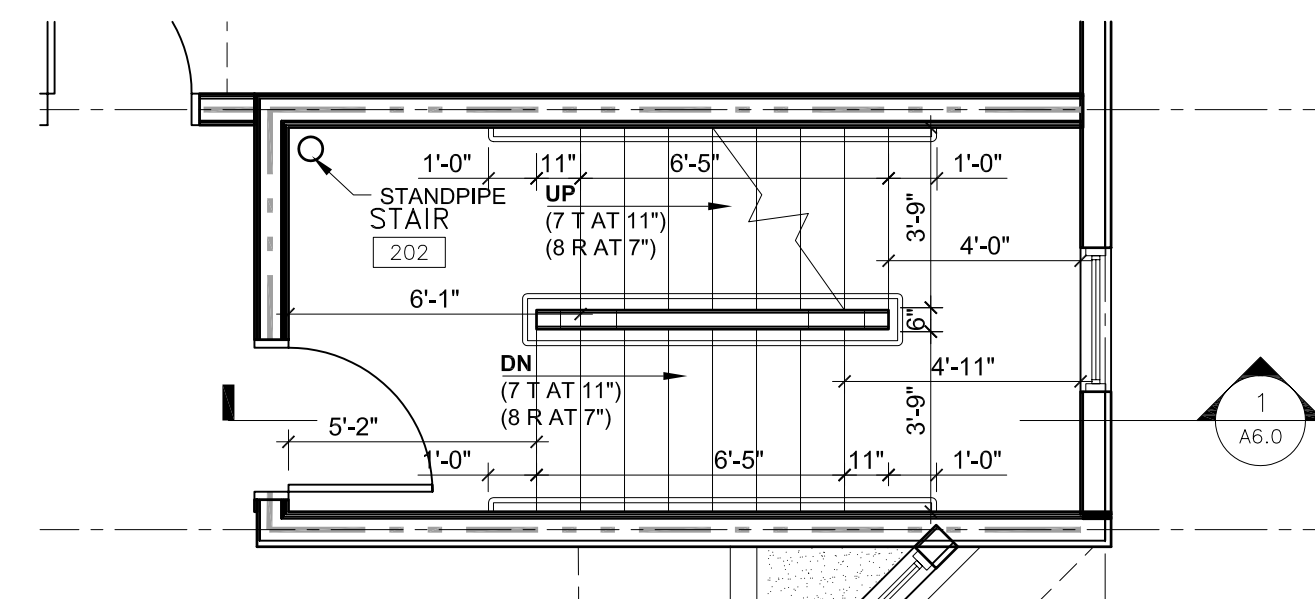

5 STAIR 202 - SECOND FLOOR PLAN
A6.0 1/4" = 1'-0"

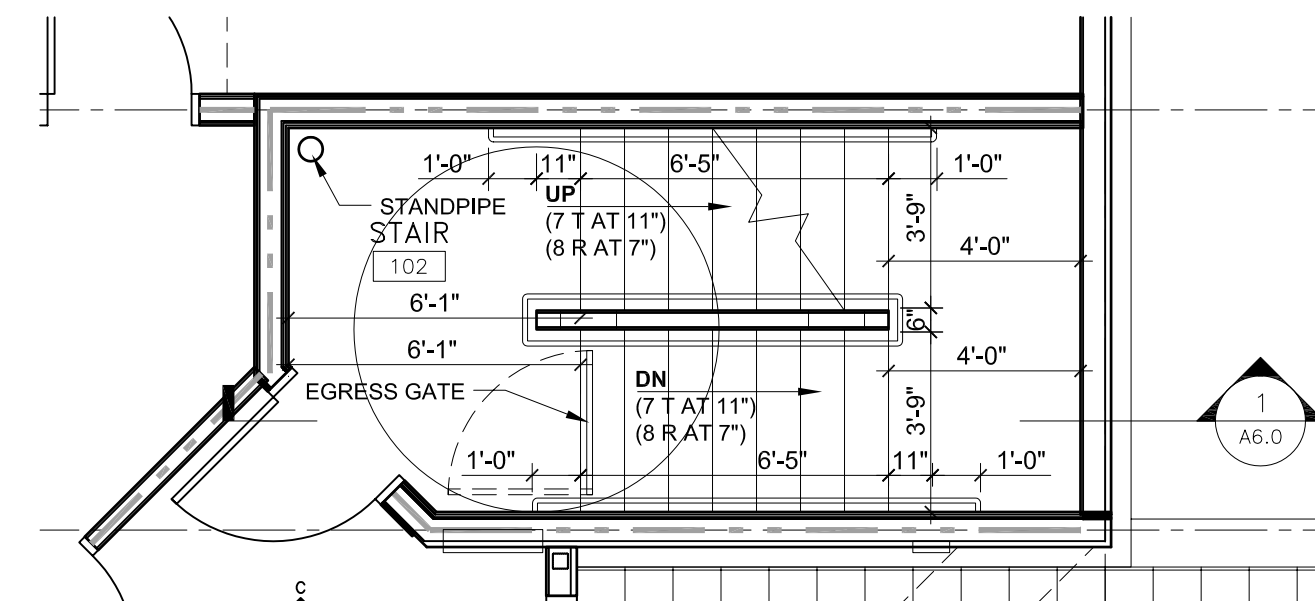

4 STAIR 102 - FIRST FLOOR PLAN
A6.0 1/4" = 1'-0"

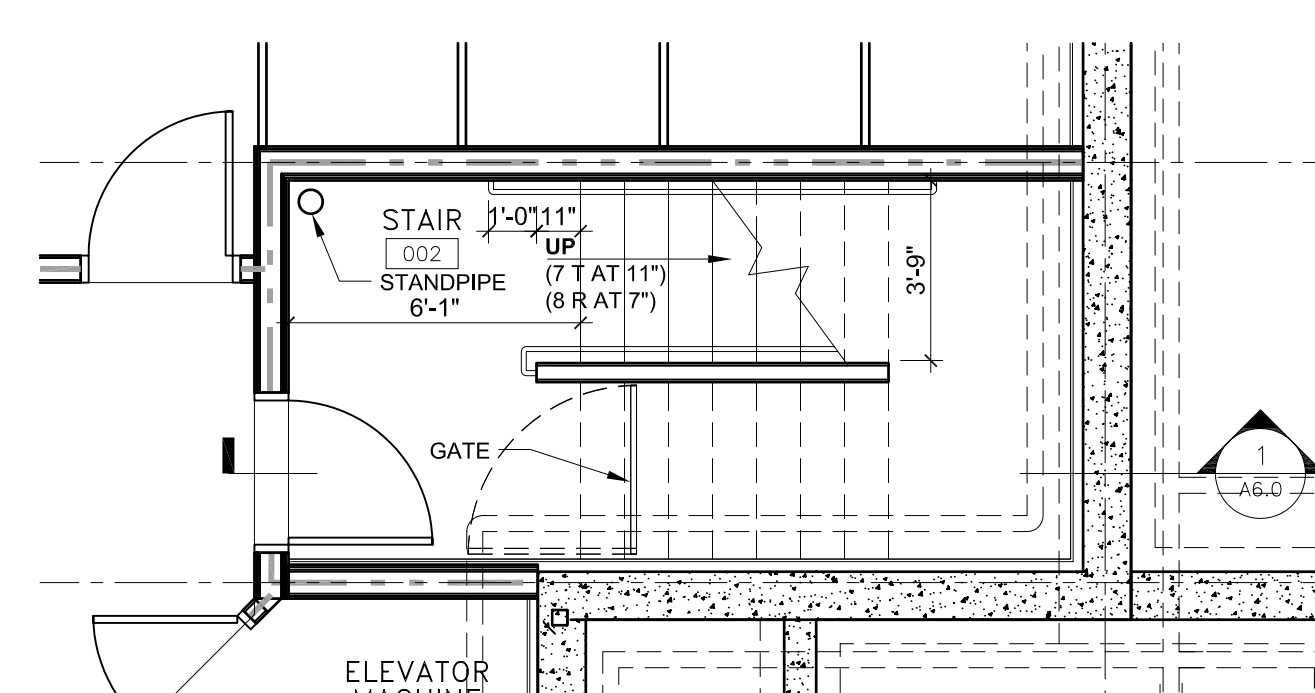

3 STAIR 002 - BASEMENT FLOOR PLAN
A6.0 1/4" = 1'-0"

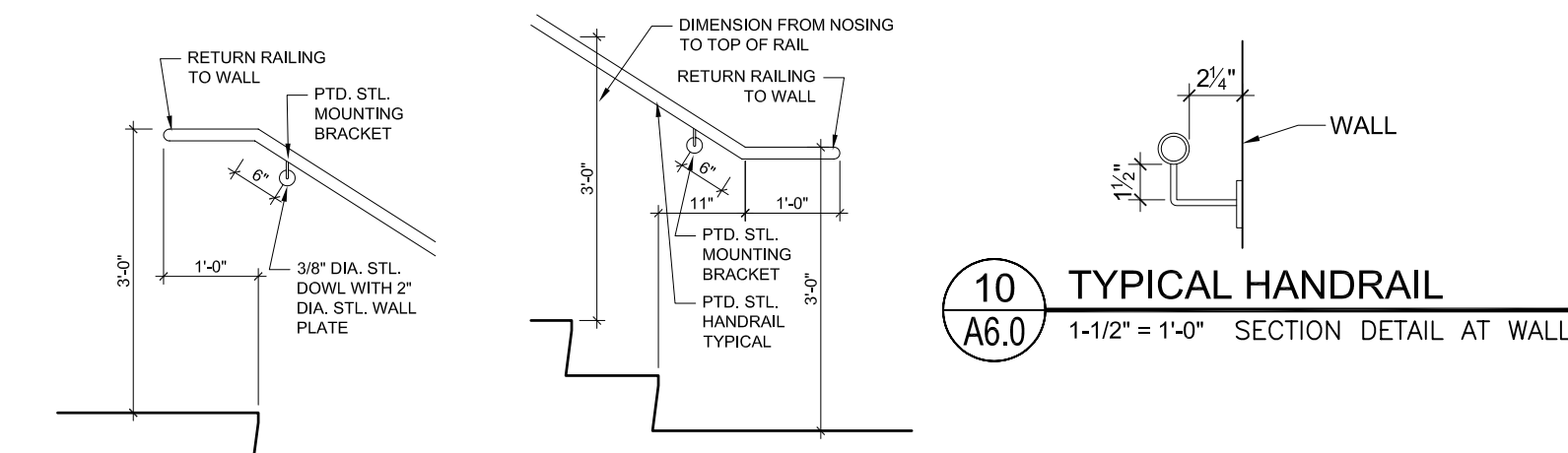

10 TYPICAL HANDRAIL
A6.0 1-1/2" = 1'-0"

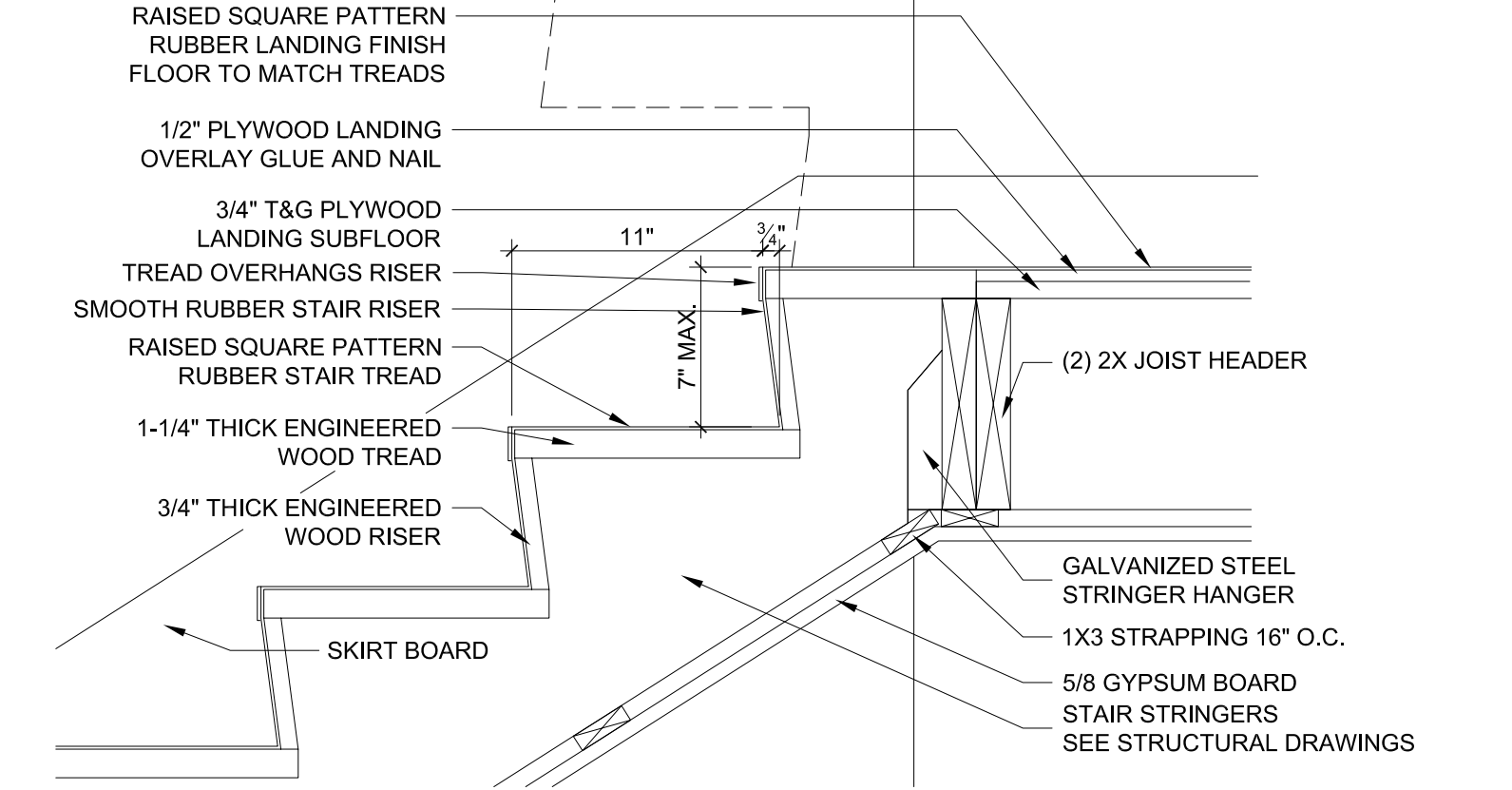

11 TYPICAL HANDRAIL DETAIL TOP AND BOTTOM
A6.0 1/2" = 1'-0"

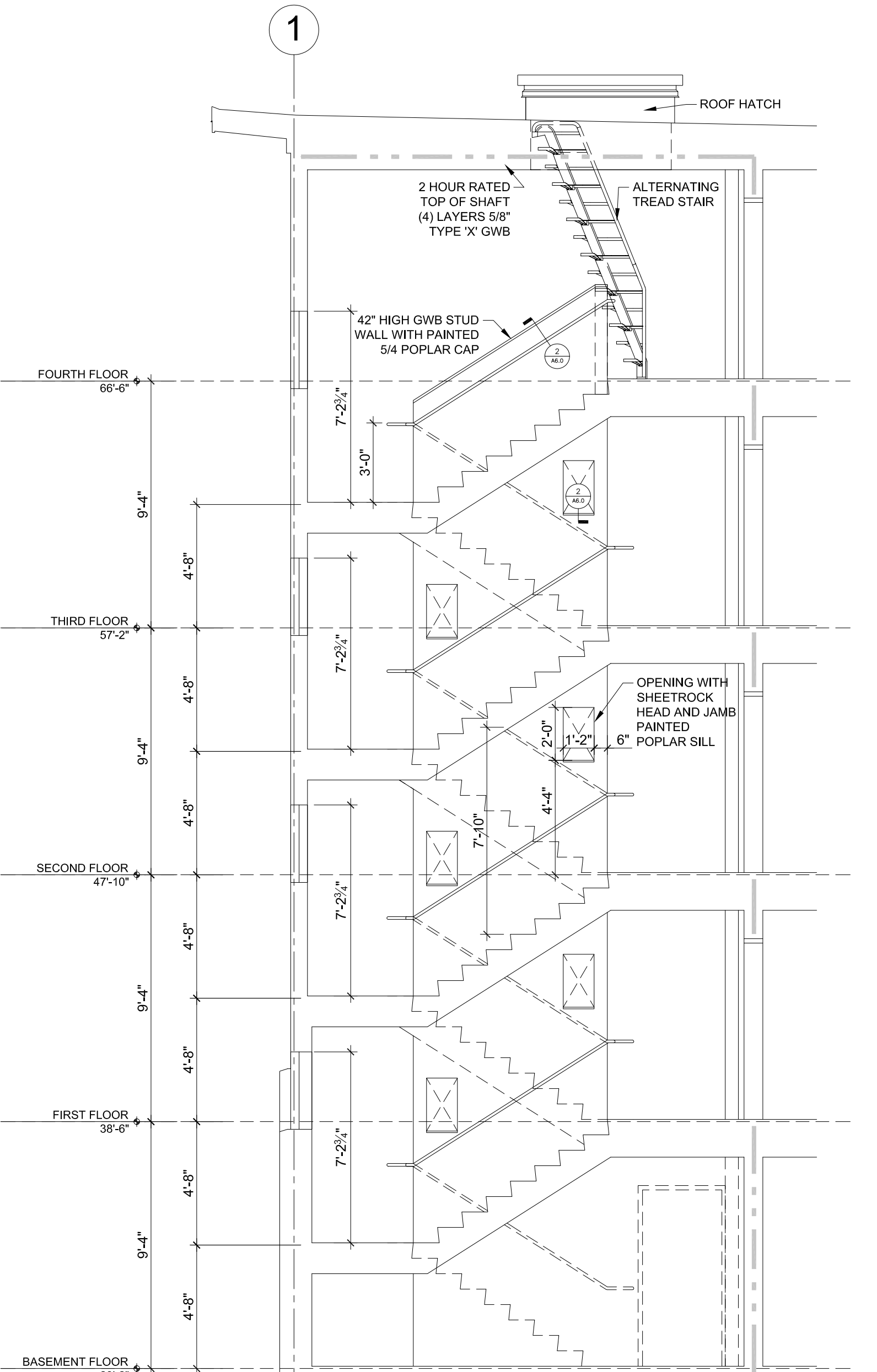

9 STAIR SECTION DETAIL AT TOP OF STRINGER
A6.0 1-1/2" = 1'-0"

8 STAIR 003-403 - SECTION
A6.0 1/4" = 1'-0"

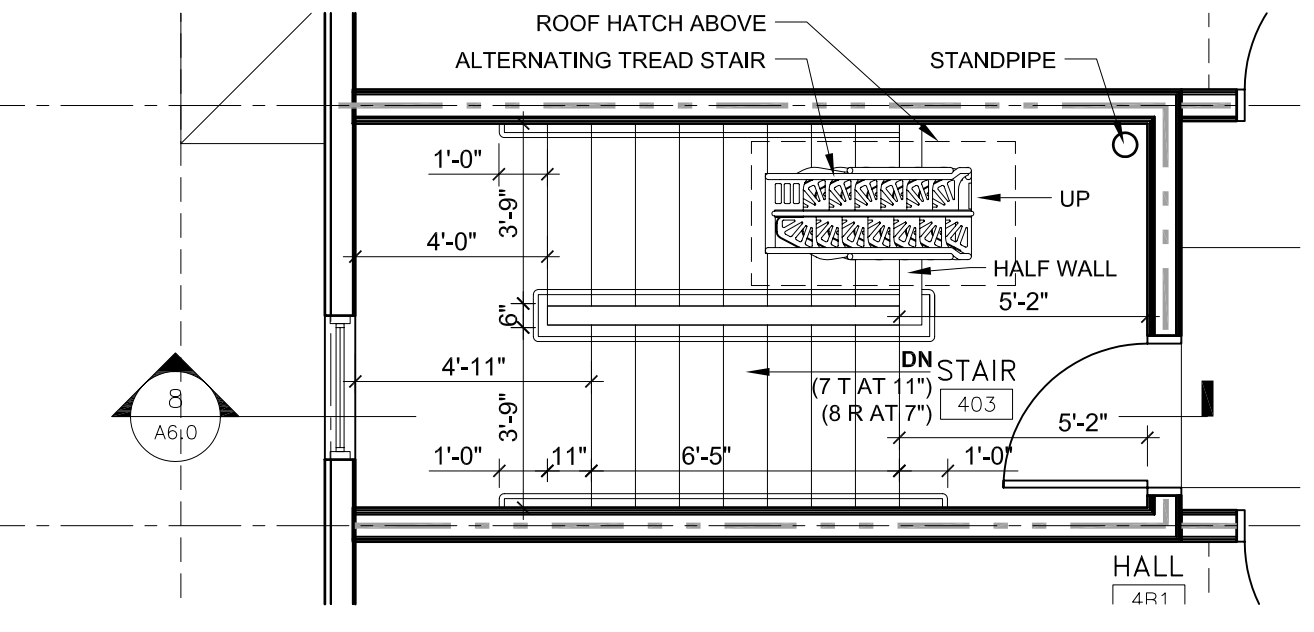

16 STAIR 403 - FOURTH FLOOR PLAN
A6.0 1/4" = 1'-0"

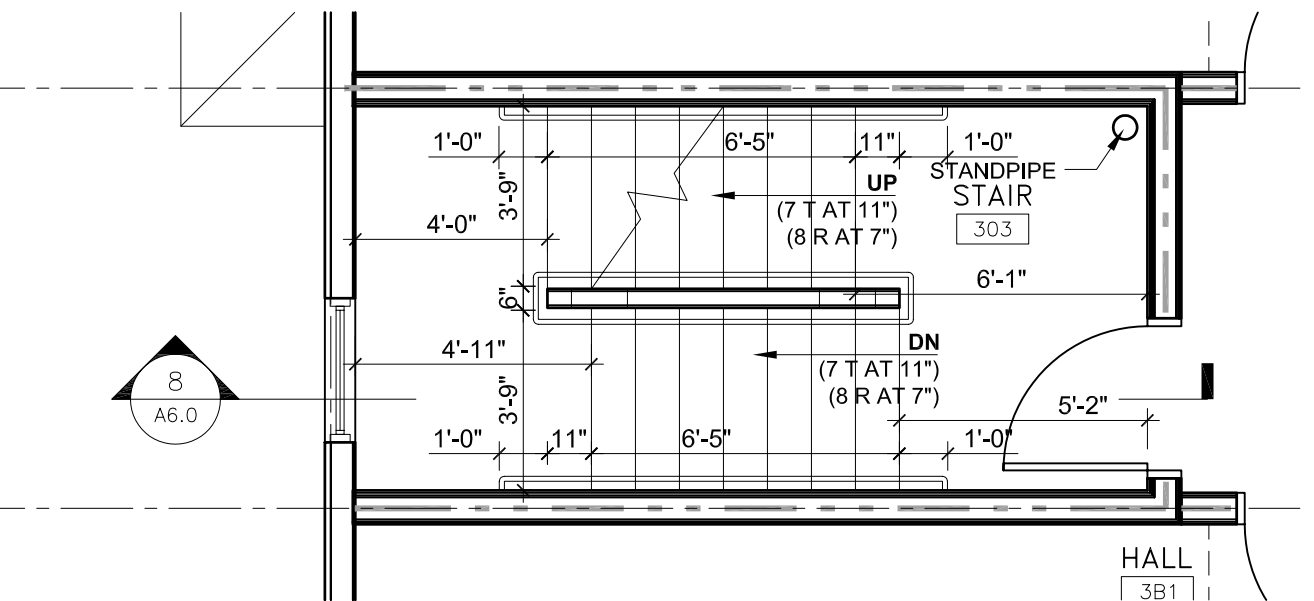

15 STAIR 303 - THIRD FLOOR PLAN
A6.0 1/4" = 1'-0"

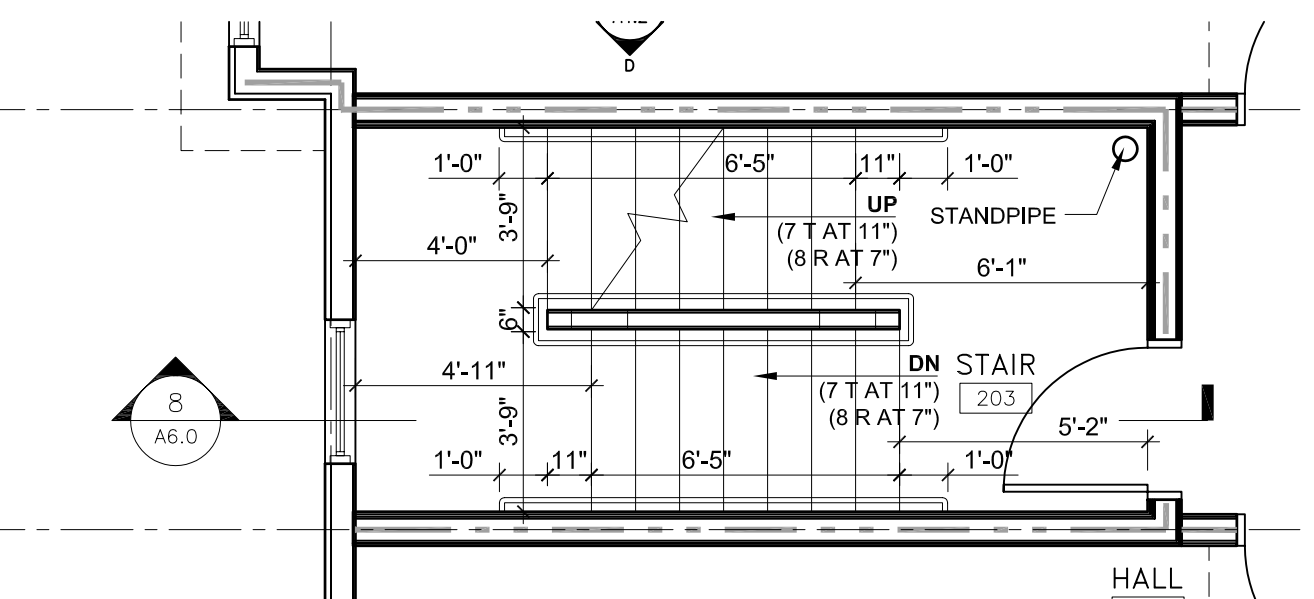

14 STAIR 203 - SECOND FLOOR PLAN
A6.0 1/4" = 1'-0"

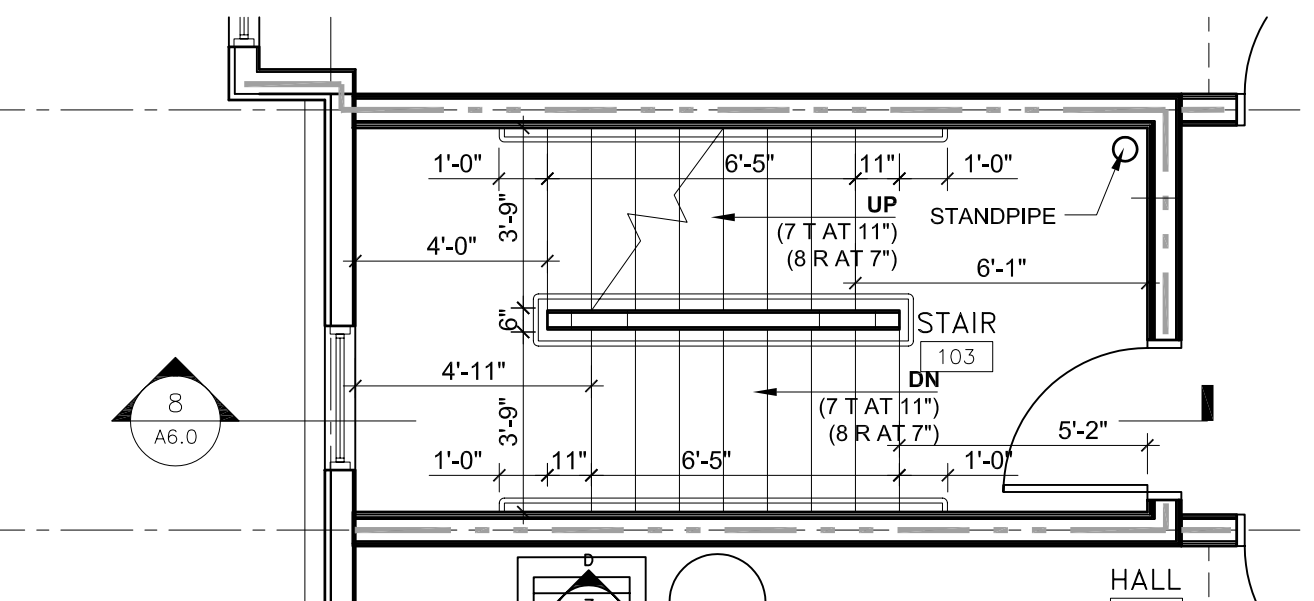

13 STAIR 103 - FIRST FLOOR PLAN
A6.0 1/4" = 1'-0"

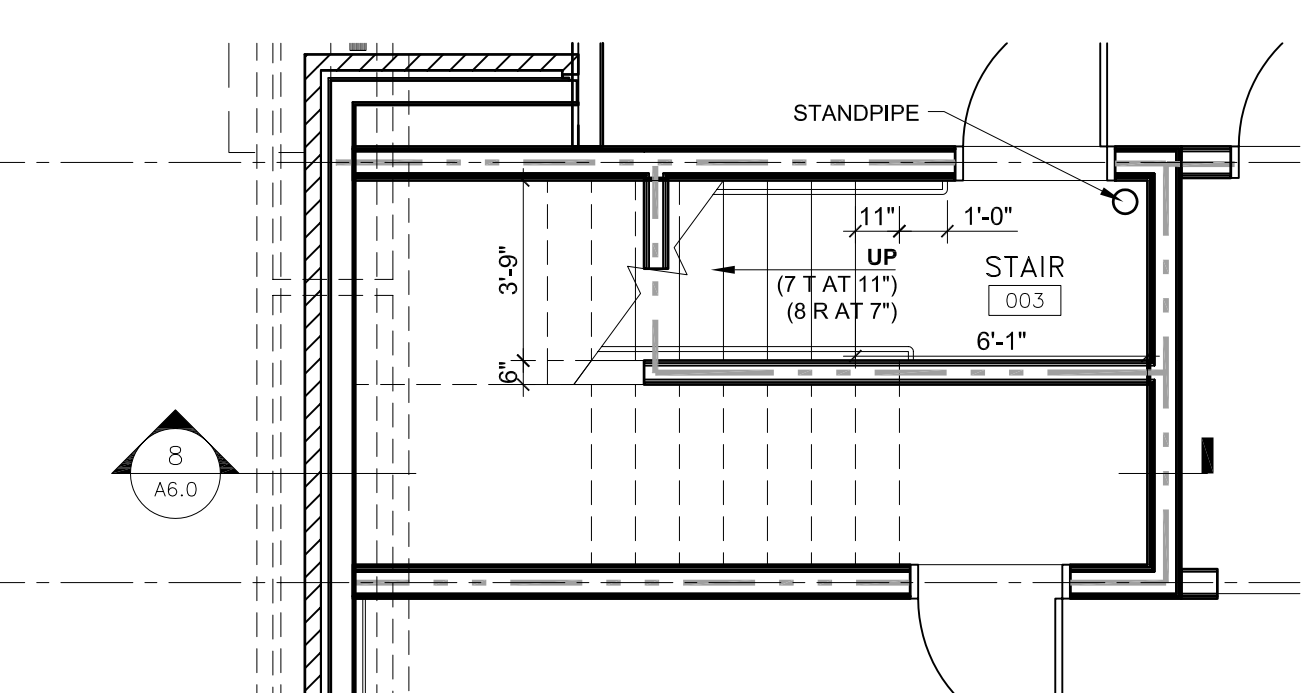

12 STAIR 003 - BASEMENT FLOOR PLAN
A6.0 1/4" = 1'-0"

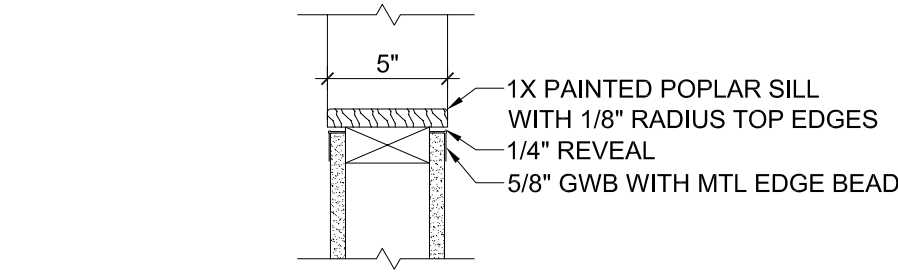

2 STAIR OPENING SILL DETAIL AND HALF WALL CAP DETAIL
A6.0 1-1/2" = 1'-0"

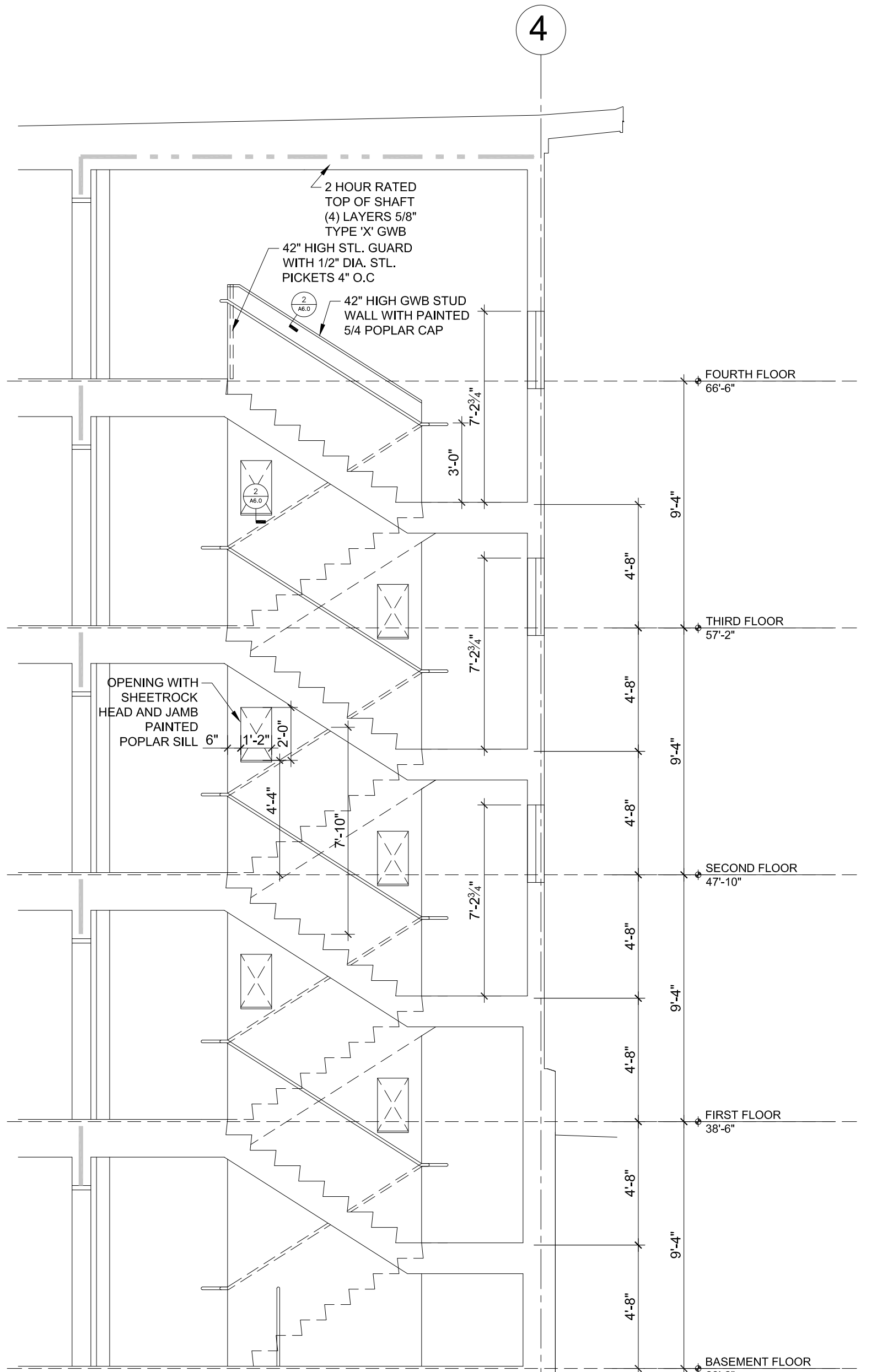

1 STAIR 002-402 - SECTION
A6.0 1/4" = 1'-0"