

BAYSIDE EAST
FOR
PORTLAND, MAINE



TFH ARCHITECTS
100 COMMERCIAL STREET
PORTLAND MAINE 04101
TELEPHONE 207 775 6141
ARCHITECTURE PLANNING

CONSULTANTS:

DATE: 07/23/07

PROJECT No. 0514

DRAWN BY: RJS

CHECKED BY: TST

SCALE: As Shown

SHEET TITLE:
EGRESS STAIR
RCP

ASK
2

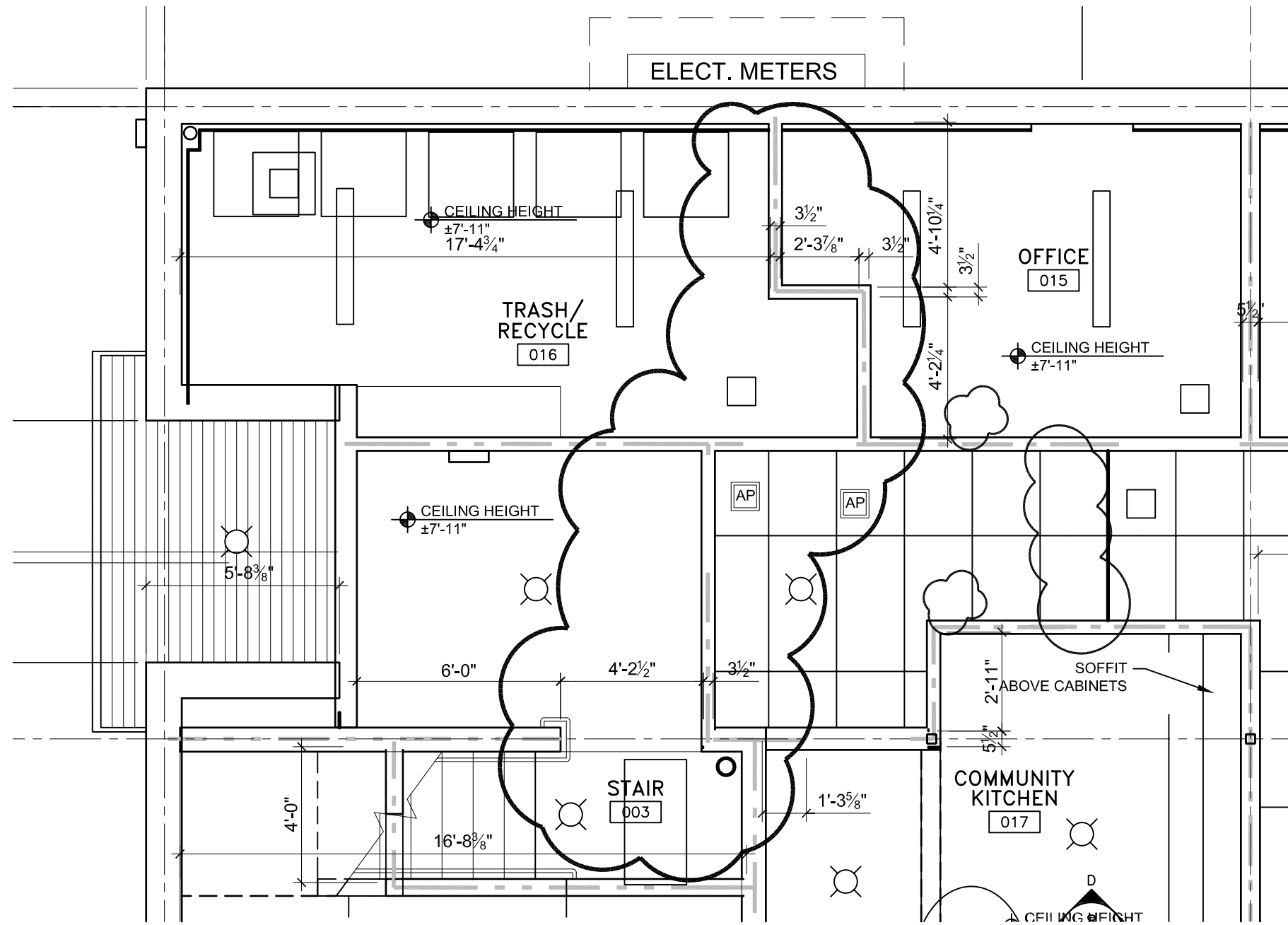

1 BASEMENT FLOOR REVISED STAIR CEILING PLAN
1/4" = 1'-0"