

Notes:

Insulation:

- All walls and ceilings to have closed cell spray foam.
- Ceilings to be cathedral with R38
- Walls to have R21

Collar ties:

- Collar ties to be exposed 2x8 pine spaced 48" O.C.

Drywall:

- All walls and ceilings to be finished with 1/2" drywall
- Three coat smooth finish

Flooring:

- All floors to be prefinished maple to match existing first floor finish.

Doors:

- Doors to be two-panel solid core.
- Hardware to be ORB lever to match first floor details.

Windows:

- New egress windows as specified
- New tempered window at shower location
- Add new Skylight at stairs for natural light.

Electrical:

- All electric updated to code
- Master and stairway ot have ceiling fan/lights

Heat:

- Existing baseboard heat to remain at all rooms.

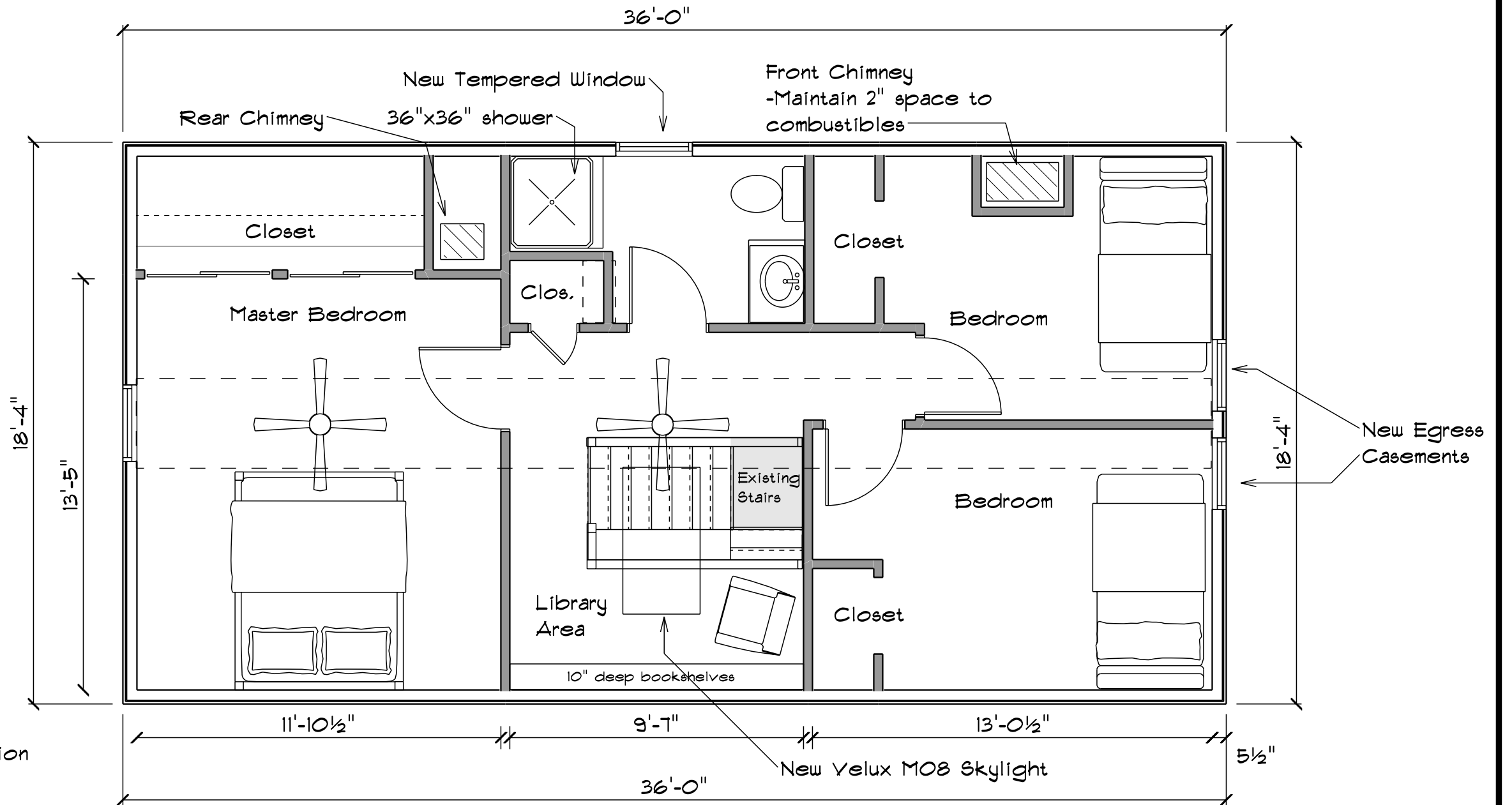

Existing Second Floor Plan

Joe Lucey Carpentry Inc.			Ward Willis & Belinda Ray	
482 Walnut Hill Rd North Yarmouth ME 04097			65 East Oxford St. Portland ME 04101	
PHONE: 207-671-4249 Joe@joeluceycarpentry.com		PHONE: FAX:		DRAWN BY: Joe Lucey
		DATE: Monday, October 10, 2016		PAGE: 2 / 6