

General Notes:

1. See A2.4 for wall types and partition types and window schedule
2. Place additional sprinkler heads at windows located in the 1 hour rated wall assembly

**@d-de-Tech**  
 235 Riverside Industrial Parkway  
 Portland, ME 04102

Downeast Structural Consultants, LLC  
  
 5 Oak Street  
 Cumberland, Maine 04021  
 phone: 207.829.8015  
 email: croy@downeaststructural.com

STATE OF MAINE  
 CHRISTOPHER RAY  
 No. 10847  
 LICENSED PROFESSIONAL ENGINEER  
 Mechanical Engineering  

**35 Mayo Street Re-Model**  
 Portland, Maine  
 Fowler-Greeves Construction

BY	REMARKS
JJO	ISSUED FOR PERMITTING
JJO	REVISED AS PER CITY COMMENT
JJO	REVISED AS PER CITY COMMENT
JJO	REVISED AS PER CITY COMMENT

DATE	NO	REMARKS
08-03-09	A	ISSUED FOR PERMITTING
09-24-09	B	REVISED AS PER CITY COMMENT
10-08-09	C	REVISED AS PER CITY COMMENT
10-26-09	D	REVISED AS PER CITY COMMENT

CODE: IBC 2003  
 TOWN: Portland  
 DATE: 06-16-09  
 SCALE: AS NOTED  
 DRAWN: JJO  
 TITLE: New Second Floor Plan  
 FILE: 015-017-09  
 SHEET: A1.3

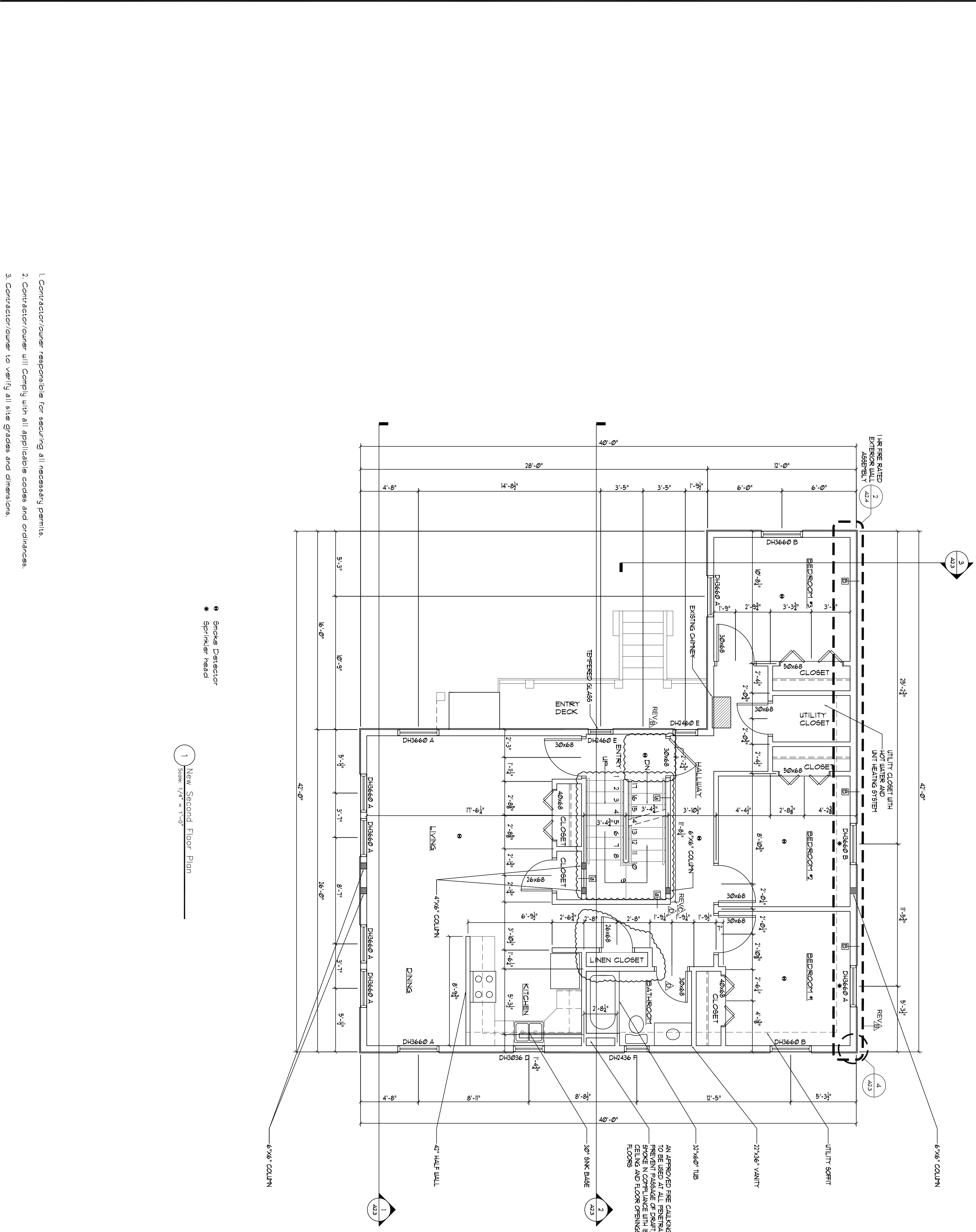

1. Contractor/owner responsible for securing all necessary permits.
2. Contractor/owner will Comply with all applicable codes and ordinances.
3. Contractor/owner to verify all site grades and dimensions.