

LOCUS N.T.S.

LEGEND

(EXISTING)

- IRON PIPE OR ROD FOUND
- MONUMENT FOUND
- WATER VALVE
- HYDRANT
- UTILITY POLE
- MANHOLE
- MANHOLE
- SIGN
- DECIDUOUS TREE
- FENCE
- CURB
- OVERHEAD WIRES
- EXISTING CONTOURS

(PROPOSED)

- 
- 
- 
- 
- 
- 
- 
- 
- 
- 
- 
- 
- 
- 
- 
- 
- 
- 
- 
- 

PLANT LIST - TREES, SHRUBS & GRASSES					
QUANTITY	SYB.	BOTANICAL NAME	COMMON NAME	SIZE	REMARKS
8	AC	<i>Amelanchier x grandiflora 'Autumn Brilliance'</i>	Serviceberry	6'-7' HT.	MULTI STEMMED CLUMP
1	CC	<i>Cercis canadensis 'Appalachian Red'</i>	Eastern Redbud	2"-2 1/2" CAL.	B&B
2	CJ	<i>Cercidiphyllum japonicum</i>	Katsuratree	3"-3 1/2" CAL.	B&B
8	GB	<i>Ginkgo biloba</i>	Ginkgo	3"-3 1/2" CAL.	B&B
5	HA	<i>Hydrangea anomala subsp. petiolaris</i>	Climbing Hydrangea	#7	CONT
8	IC	<i>Ilex crenata 'Steads'</i>	Japanese Holly	4'-5' HT.	B&B
6	RB	<i>Rhododendron 'Boule de Neige'</i>	Rhododendron	3.5'-3'	B&B
49	PK	<i>Pennisetum alopecuroides 'Karley rose'</i>	Pink Fountain Grass	# 2	CONT
36	PH	<i>Pennisetum alopecuroides 'Hale'</i>	Dwarf Fountain Grass	# 2	CONT
29	PV	<i>Panicum virgatum 'Northwind'</i>	Northwind Switch Grass	# 2	CONT
1	MJ	<i>Magnolia liliiflora 'Jane'</i>	Jane Magnolia	7'-8'	B&B
9	HQ	<i>Hydrangea quercifolia 'ruby slippers'</i>	Oakleaf Hydrangea	#5	CONT
50	LS	<i>Liriope spicata</i>	Creeping Lilyturf	#1	CONT

PLANT LIST - RAIN GARDEN SHRUBS

QUANTITY	SYB.	BOTANICAL NAME	COMMON NAME	Wet	Moist	Dry	Native	Size	Remarks
5	CS	<i>Cornus sericea 'Arctic Fire'</i>	Arctic Fire Dogwood				Y	# 5	CONT.
1	HI	<i>Hamamelis intermedia 'Arnolds Promise'</i>	Witch Hazel	X	X		N	5'-6'	B&B
10	IVF	<i>Ilex verticillata 'Red Sprite'</i>	Winterberry (Female)				Y	# 3	CONT.
2	IVM	<i>Ilex verticillata 'Jim Dandy'</i>	Winterberry (Male pollinator)				Y	# 3	CONT.

PLANT LIST - RAIN GARDEN PERENNIAL MIX

QUANTITY	SYB.	BOTANICAL NAME	COMMON NAME	Wet	Moist	Dry	Native	Size	Remarks
38		<i>Iris versicolor</i>	Blue Flag Iris	X	X		Y	# 1	CONT.
38		<i>Aster novae-angliae</i>	New England Aster	X	X		Y	# 1	CONT.
38		<i>Cimicifuga racemosa</i>	Black Snakeroot	X	X		Y	# 1	CONT.
38		<i>Rudbeckia fulgida</i>	Black-eyed Susan	X	X		Y	# 1	CONT.
38		<i>Echinacea purpurea</i>	Purple Coneflower	X	X		Y	# 1	CONT.

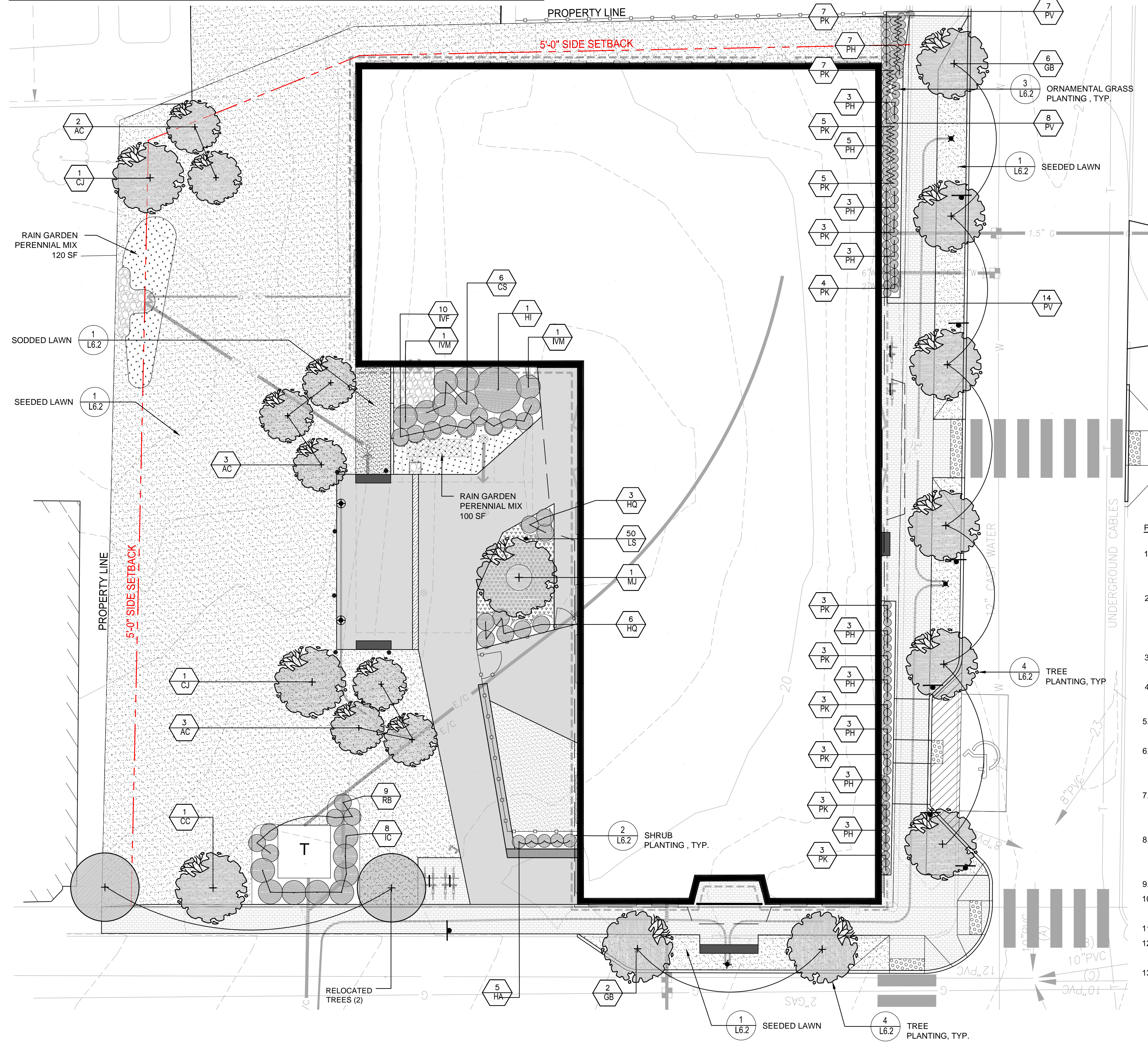

12' O.C.

PLANTING NOTES:

1. CONTRACTOR SHALL BEGIN MAINTENANCE IMMEDIATELY AFTER PLANTING AND SHALL CONTINUE UNTIL FINAL ACCEPTANCE. CONTRACTOR SHALL BE RESPONSIBLE FOR ALL MEANS AND METHODS OF WATERING AND MAINTENANCE.
2. CONTRACTOR SHALL SUPPLY PLANTS IN QUANTITIES SUFFICIENT TO COMPLETE WORK SHOWN ON THE PLAN. ANY DISCREPANCY BETWEEN THE QUANTITIES SHOWN IN THE PLANT SCHEDULE AND THOSE REQUIRED ON THE PLAN SHALL NOT ENTITLE THE CONTRACTOR TO ADDITIONAL REMUNERATION. ANY DISCREPANCIES SHALL BE CLARIFIED WITH THE LANDSCAPE ARCHITECT PRIOR TO ORDERING PLANT MATERIAL.
3. ALL MATERIALS SHALL CONFORM TO SPECIFICATIONS OF THE AMERICAN STANDARDS FOR NURSERY STOCK (LATEST EDITION) AS SET FORTH BY THE AMERICAN ASSOCIATION OF NURSERYMEN.
4. ALL PLANTS SHALL BEAR THE SAME RELATIONSHIP TO FINISH GRADE AS THE ORIGINAL GRADES BEFORE DIGGING.
5. ALL PLANTS BEDS AND TREE WELLS SHALL HAVE A MINIMUM OF 3" OF UNIFORMLY DISTRIBUTED, DARK, SHREDDED BARK MULCH.
6. CONTRACTOR SHALL SUBMIT SOIL SAMPLE AND TEST OF TOPSOIL TO LANDSCAPE ARCHITECT PRIOR TO INSTALLATION. SOIL ADMIXTURE SHALL BE ADDED TO EXISTING SOIL (BY CONTRACTOR) IF DEEMED NECESSARY BY SOIL TEST RESULTS.
7. ROUGH GRADING AND BED PREPARATION SHALL BE APPROVED BY LANDSCAPE ARCHITECT PRIOR TO PLANT INSTALLATION. CONTRACTOR SHALL NOTIFY LANDSCAPE ARCHITECT 48 HOURS PRIOR TO REQUIRED SITE VISIT.
8. ALL PLANTS SHALL BE BALLED AND WRAPPED OR CONTAINER GROWN AS SPECIFIED. ALL ROOT WRAPPING AND CONTAINER MATERIAL MADE OF SYNTHETICS OR PLASTICS SHALL BE REMOVED AT THE TIME OF PLANTING.
9. ALL BROAD LEAF EVERGREEN PLANTS SHALL BE SPRAYED WITH AN ANTIDESSICANT AT THE BEGINNING OF
10. ALL PLANTS SHALL BE INSTALLED AS PER DETAILS AND THE CONTRACT SPECIFICATIONS. THE LANDSCAPE CONTRACTOR SHALL REFER TO THE CONTRACT SPECIFICATIONS FOR ADDITIONAL REQUIREMENTS.
11. CONTRACTOR SHALL ONLY STAKE TREES IF DEEMED NECESSARY BY THE LANDSCAPE ARCHITECT.
12. THE LANDSCAPE CONTRACTOR SHALL PROVIDE PREPARED SOIL PLANTING MIX AS PER THE CONTRACT SPECIFICATIONS.
13. THE LANDSCAPE CONTRACTOR SHALL REFER TO THE PLANT LIST AND PLANTING SPECIFICATIONS FOR SEASONAL REQUIREMENTS AND OTHER RESTRICTIONS RELATED TO THE TIME AND SEASON OF PLANTING.

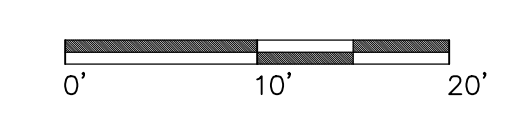

**KAPLAN THOMPSON ARCHITECTS**  
 424 FORE ST., PORTLAND, ME 04101  
 P: 207-842-2888 F: 842-2828  
 JESSE@KAPLANTHOMPSON.COM

**CARROLL ASSOCIATES LANDSCAPE ARCHITECTS**  
 217 COMMERCIAL ST  
 PORTLAND, ME 04101  
 P: 207.772.1552 F: 207.772.0172

**BECKER STRUCTURAL ENGINEERS**  
 75 YORK ST.  
 PORTLAND, ME 04101  
 P: 207.879.1838 F: 207.879.1822

**RANSOM Consulting Engineers and Scientists**  
 400 COMMERCIAL ST., SUITE 404  
 PORTLAND, ME 04101  
 P: 207.772.2891 F: 207.772.3248

**PORTLAND HOUSING MAINE DEVELOPMENT CORPORATION**  
 14 BAXTER BLVD  
 PORTLAND, ME 04101  
 P: 207.773.4753 F: 207.774.6471

**APEX ENGINEERING**  
 190 US Route One, PMB 346 Falmouth, Maine 04105  
 Phone: (207) 847-3445 Fax: (207) 847-3446

PRICING DOCUMENTS

Project:  
 BAYSIDE ANCHOR  
 Portland Housing Development  
 Corporation  
 81 East Oxford Street  
 Portland, ME

Drawing: **SITE LANDSCAPE PLAN**  
 Scale: 1"=10'  
 Date: July 2, 2014  
 Drawn by: EPK  
 Revised: 8.31.2015

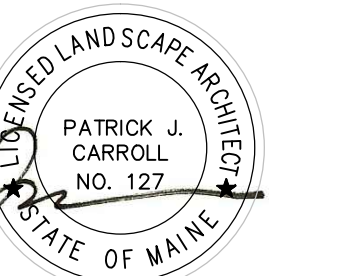

**L5.0**