

Fan View

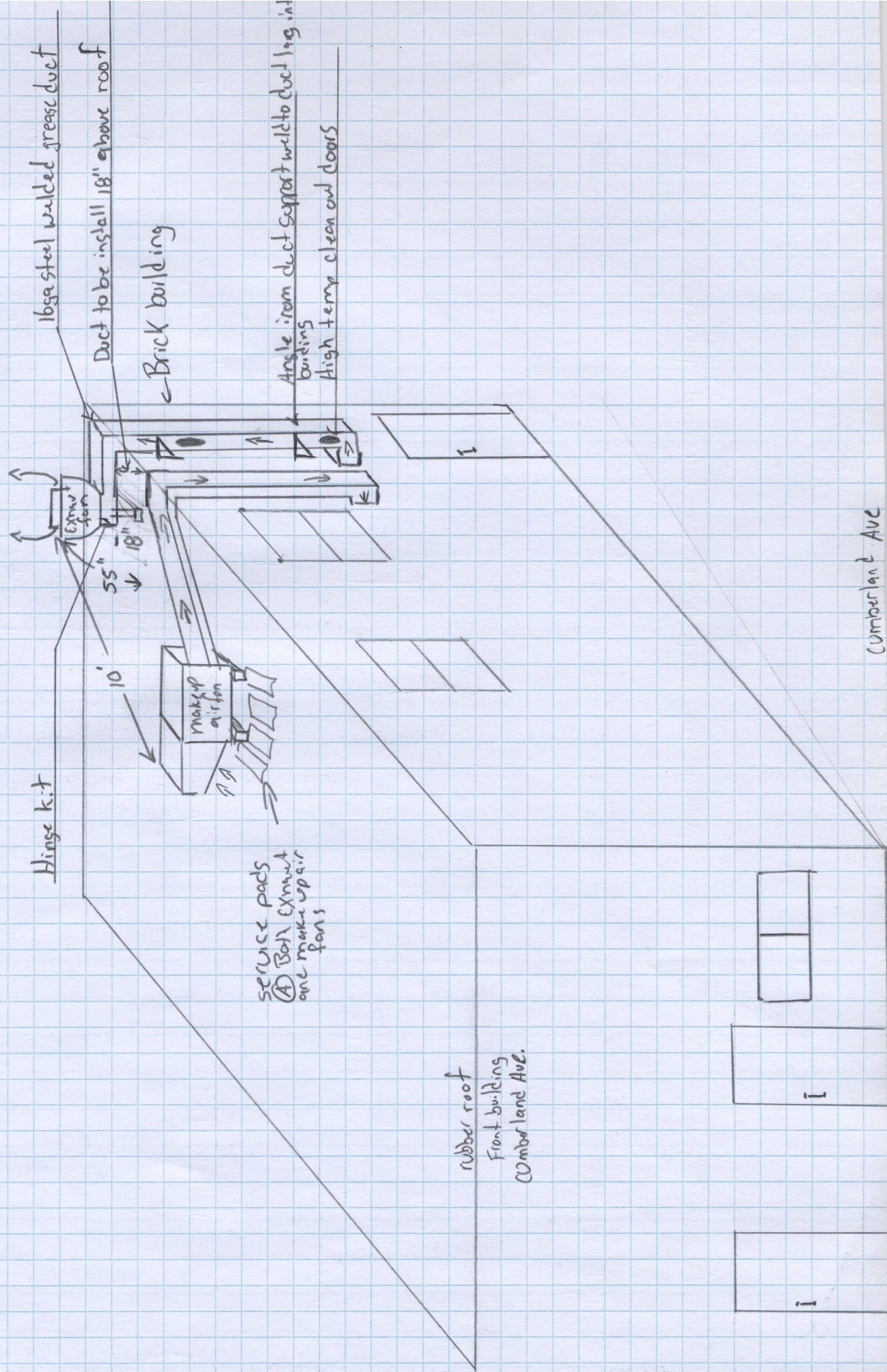

Hinge kit

16ga steel welded grease duct

Duct to be install 18" above roof

Brick building

service pads  
A Both Exhaust  
and make up air  
fans

Angle iron duct support welded to duct legs in  
brick building  
High temp clean out doors

rubber roof  
Front building  
Cumberland Ave.

Cumberland Ave