

R:\SP-M150 India & Middle Sts\Cadd\Permit Set\dwg\SP-M150-GRADING & DRAINAGE.dwg, C-4.0 GRADING-FOR, 4/15/2015 11:19:17 AM, dube_c_1.1

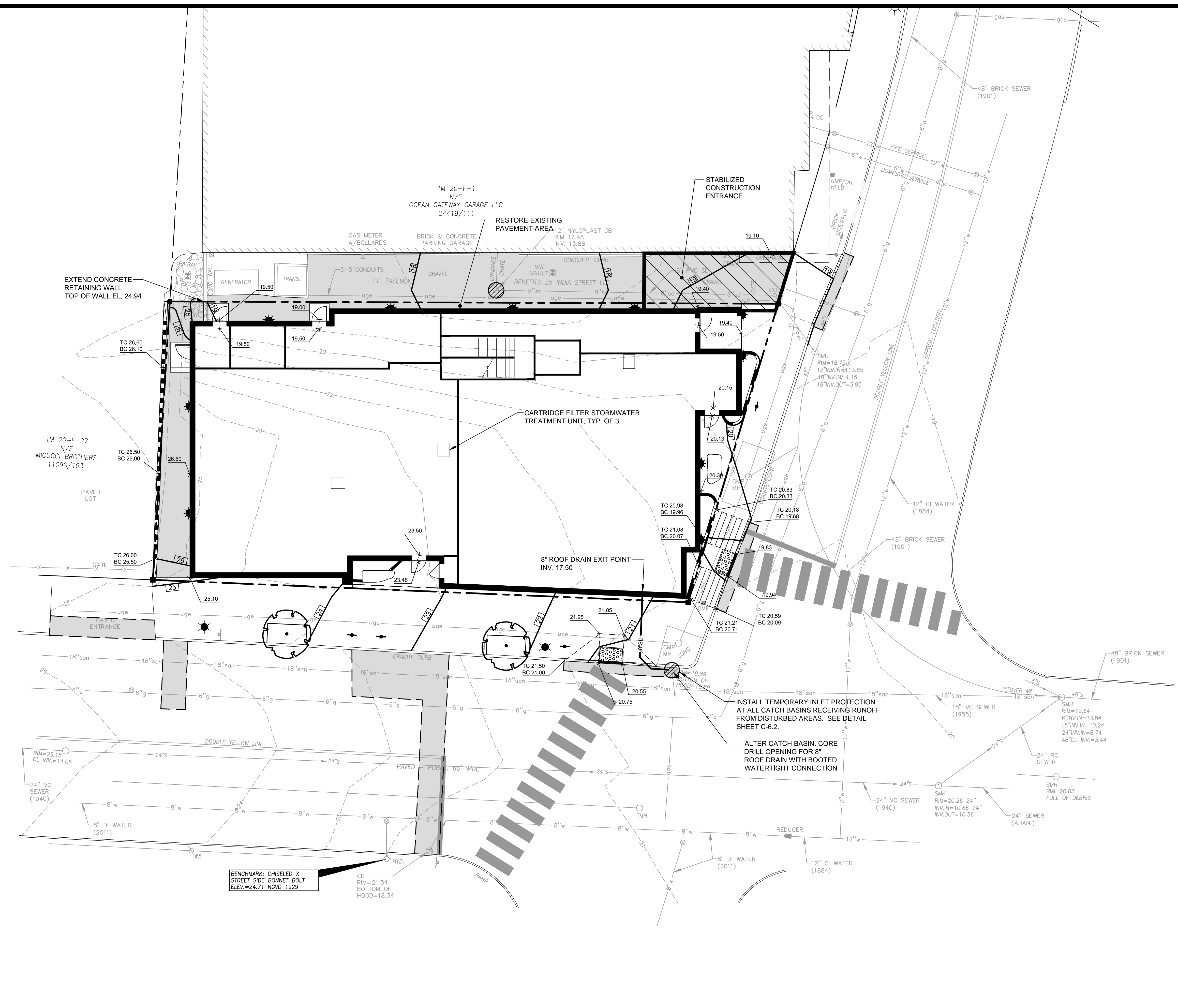

PRELIMINARY - NOT FOR CONSTRUCTION

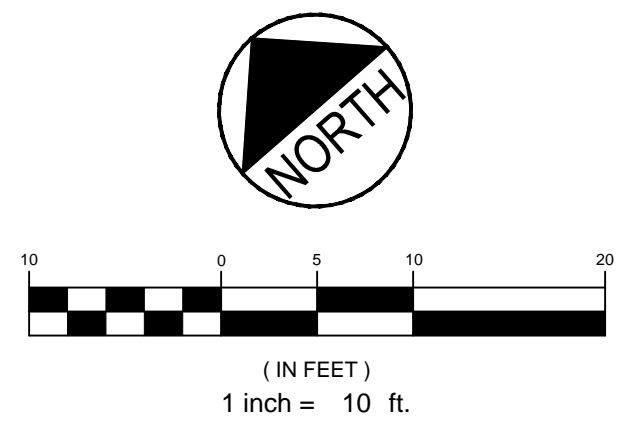

REV	DATE	DESCRIPTION
6	04.15.15	REVISED PER STAFF COMMENTS & RESUBMITTED TO CITY
5	02.06.15	SUBMITTED FINAL SITE PLAN APPLICATION TO CITY
4	07.22.14	REVISED GRADING TO REFLECT UPDATED LANDSCAPE PLANTERS
3	07.08.14	REVISED PER ENGINEERING PEER REVIEW COMMENTS AND RESUBMITTED TO CITY
2	06.12.14	REVISED PER PLANNING REVIEW STAFF COMMENTS AND RESUBMITTED TO CITY
1	05.05.14	SUBMITTED TO CITY

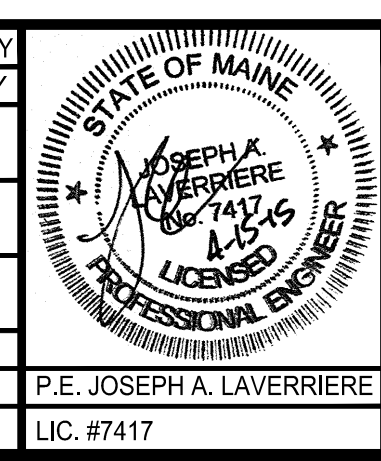

PROJECT	185 FORE STREET PORTLAND, MAINE
SHEET TITLE	GRADING, DRAINAGE & EROSION CONTROL PLAN
CLIENT	BATEMAN PARTNERS LLC

FST 100 YEARS FAY, SPOFFORD & THORNDIKE ENGINEERS · PLANNERS · SCIENTISTS 778 MAIN ST., SUITE B, SOUTH PORTLAND, ME 04106	
DRAWN: CDD	DATE: MAY 2014
DESIGNED: JAL	SCALE: 1" = 10'
CHECKED: JAL	JOB NO. SP-M150
FILE NAME: SP-M150-GRADING & DRAINAGE	
SHEET C-4.0	

R:\SP-M150 India & Middle Sts\Cadd\Permit Set\dwg\SP-M150-GRADING & DRAINAGE.dwg, c 4/15/2015 11:19 AM