

R:\SP-M150-India & Middle Sts\Cadd\Permit Set\dwg\SP-M150-UTILITY PLAN.dwg, C-5.0 FORE ST. 4/15/2015 11:31:19 AM. abbe_c. 1:1

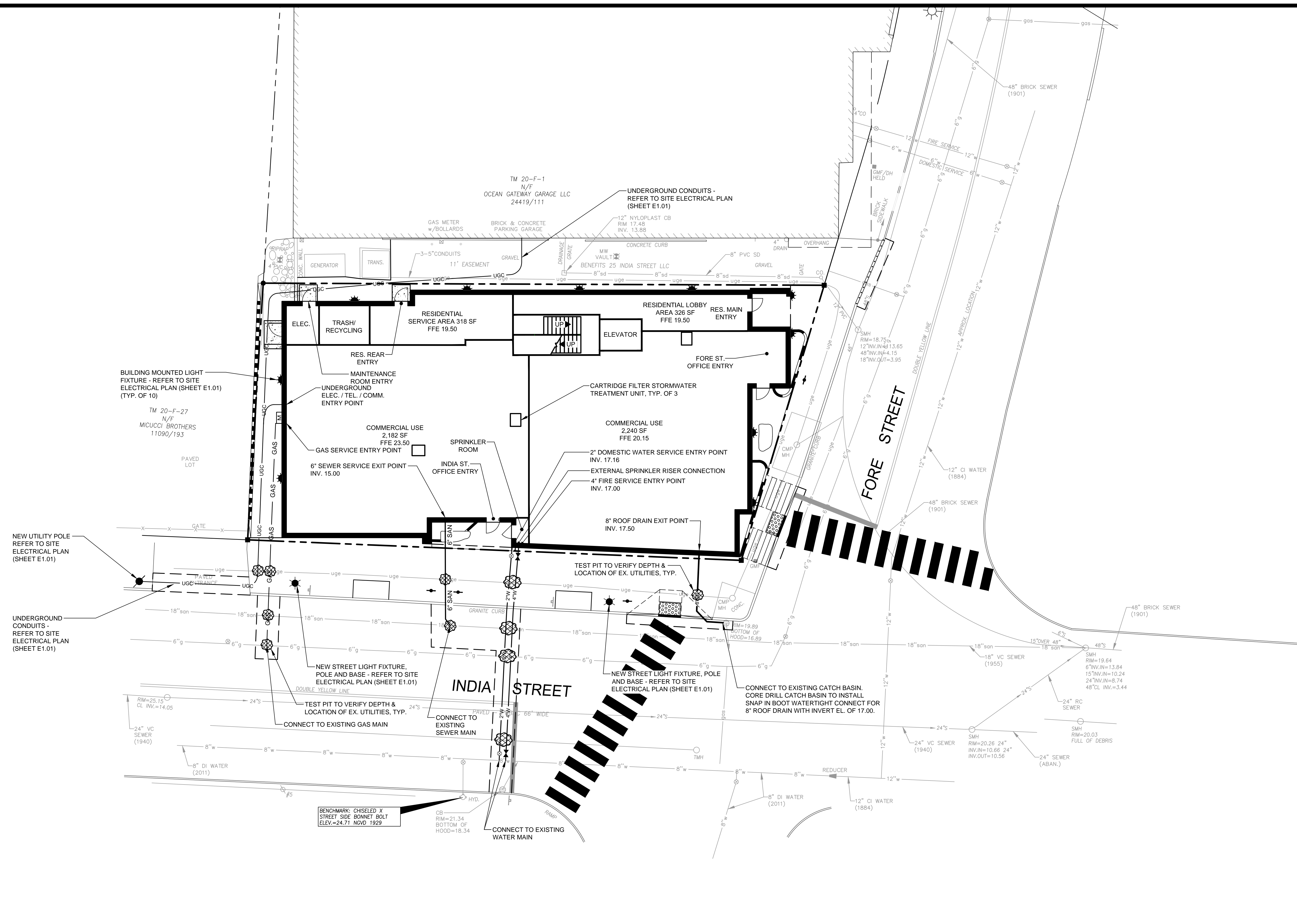

PRELIMINARY - NOT FOR CONSTRUCTION

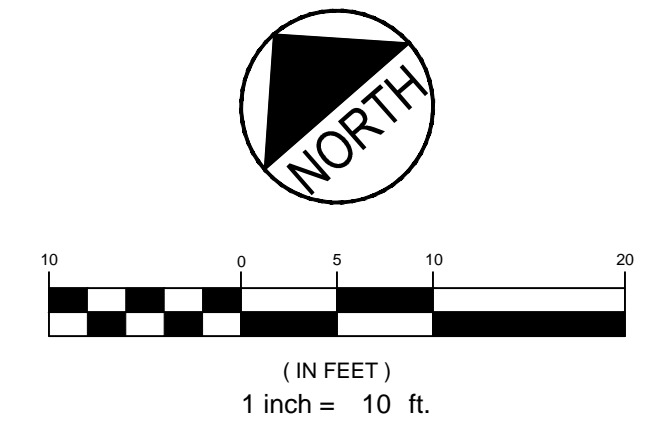

REV	DATE	DESCRIPTION
4	02.06.15	SUBMITTED FINAL SITE PLAN APPLICATION TO CITY
3	07.08.14	REVISED PER ENGINEERING PEER REVIEW COMMENTS AND RESUBMITTED TO CITY
2	06.12.14	REVISED PER PLANNING REVIEW STAFF COMMENTS AND RESUBMITTED TO CITY
1	05.05.14	SUBMITTED TO CITY

REVISIONS

P.E. JOSEPH A. LAVERRIERE
LIC. #7417

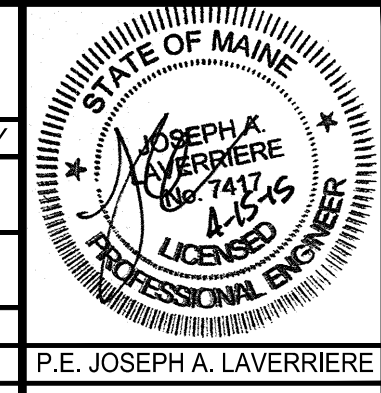

PROJECT	185 FORE STREET PORTLAND, MAINE
SHEET TITLE	UTILITY PLAN
CLIENT	BATEMAN PARTNERS LLC

FST 100 YEARS
FAY, SPOFFORD & THORNDIKE
ENGINEERS · PLANNERS · SCIENTISTS
778 MAIN ST, SUITE 8, SOUTH PORTLAND, ME 04106

DRAWN: CDD	DATE: MAY 2014
DESIGNED: JAL	SCALE: 1" = 10'
CHECKED: JAL	JOB NO. SP-M150
FILE NAME: SP-M150-UTILITY PLAN	
SHEET C-5.0	