

R:\SP-M150 India & Middle Sts\Cadd\Permit Set\dwg\SP-M150-GRADING & DRAINAGE.dwg, C-4.0 GRADING-FOR, 6/4/2015 9:21:16 AM, dube_c_1:1

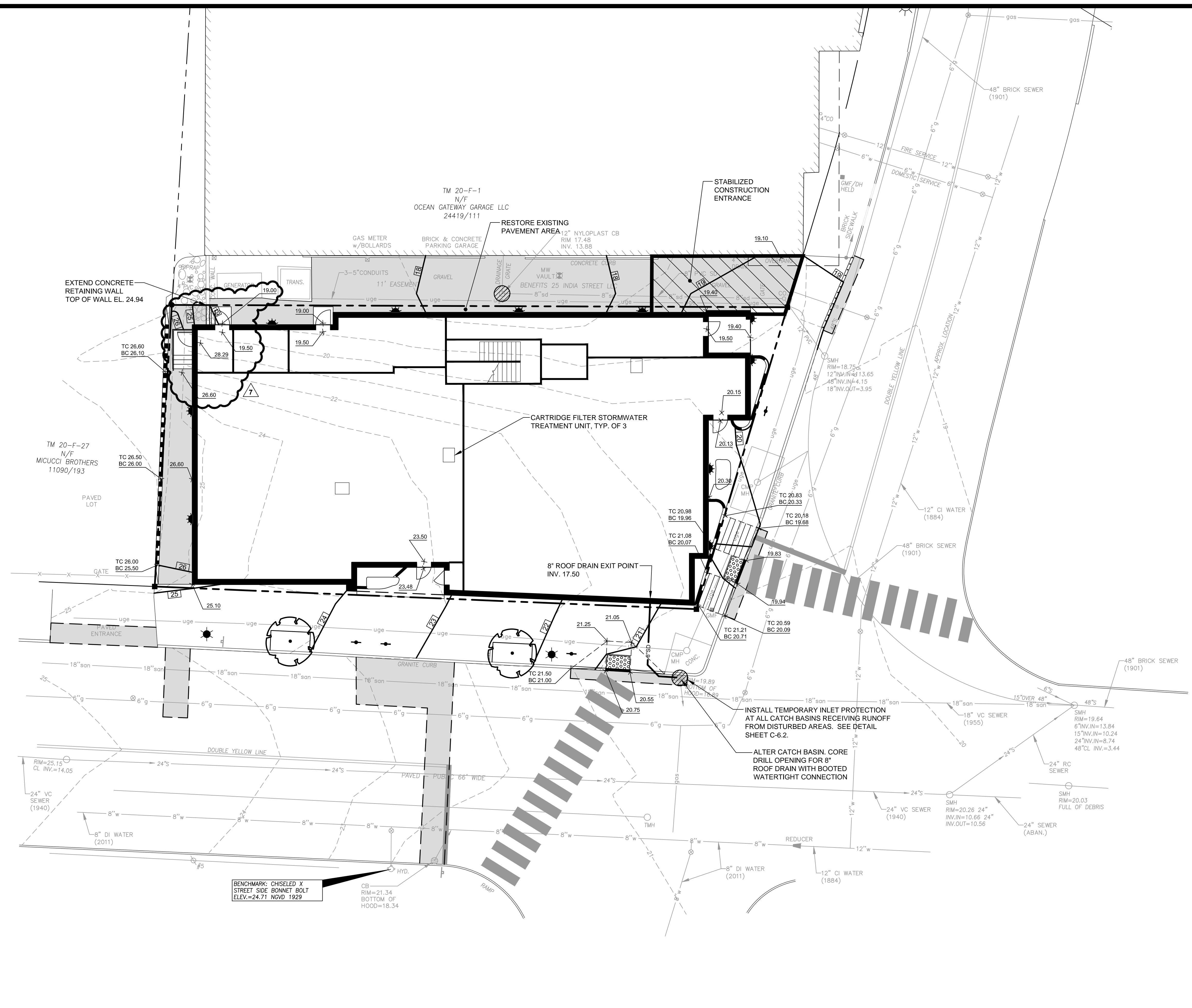

BENCHMARK: CHISELED X
STREET SIDE BONNET BOLT
ELEV.=24.71 NGVD 1929

CB
RIM=21.34
BOTTOM OF
HOOD=18.34

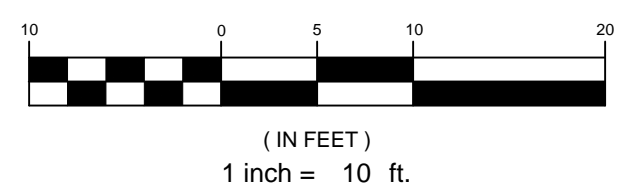

REV	DATE	DESCRIPTION
7	06.04.15	REVISED AS PART OF ADDENDUM #1
6	04.15.15	REVISED PER STAFF COMMENTS & RESUBMITTED TO CITY
5	02.06.15	SUBMITTED FINAL SITE PLAN APPLICATION TO CITY
4	07.22.14	REVISED GRADING TO REFLECT UPDATED LANDSCAPE PLANTERS
3	07.08.14	REVISED PER ENGINEERING PEER REVIEW COMMENTS AND RESUBMITTED TO CITY
2	06.12.14	REVISED PER PLANNING REVIEW STAFF COMMENTS AND RESUBMITTED TO CITY
1	05.05.14	SUBMITTED TO CITY

STATE OF MAINE

 JOSEPH A. LAVERRIERE
 LICENSED PROFESSIONAL ENGINEER
 P.E. JOSEPH A. LAVERRIERE
 LIC. #7417

PROJECT
**185 FORE STREET
 PORTLAND, MAINE**

SHEET TITLE
**GRADING, DRAINAGE &
 EROSION CONTROL PLAN**

CLIENT
BATEMAN PARTNERS LLC

FST FAY, SPOFFORD & THORNDIKE
 ENGINEERS · PLANNERS · SCIENTISTS
 778 MAIN ST, SUITE 8, SOUTH PORTLAND, ME 04106

DRAWN: CDD DATE: MAY 2014
 DESIGNED: JAL SCALE: 1" = 10'
 CHECKED: JAL JOB NO. SP-M150
 FILE NAME: SP-M150-GRADING & DRAINAGE
 SHEET **C-4.0**

PRELIMINARY - NOT FOR CONSTRUCTION

R:\SP-M150 India & Middle Sts\Cadd\Permit Set\dwg\SP-M150-GRADING & DRAINAGE.dwg, c.6/4/2015 9:21 AM