

-10° FREEZER
With Floor
Smooth Aluminum Floor

35° COOLER
With Floor
Smooth Aluminum Floor

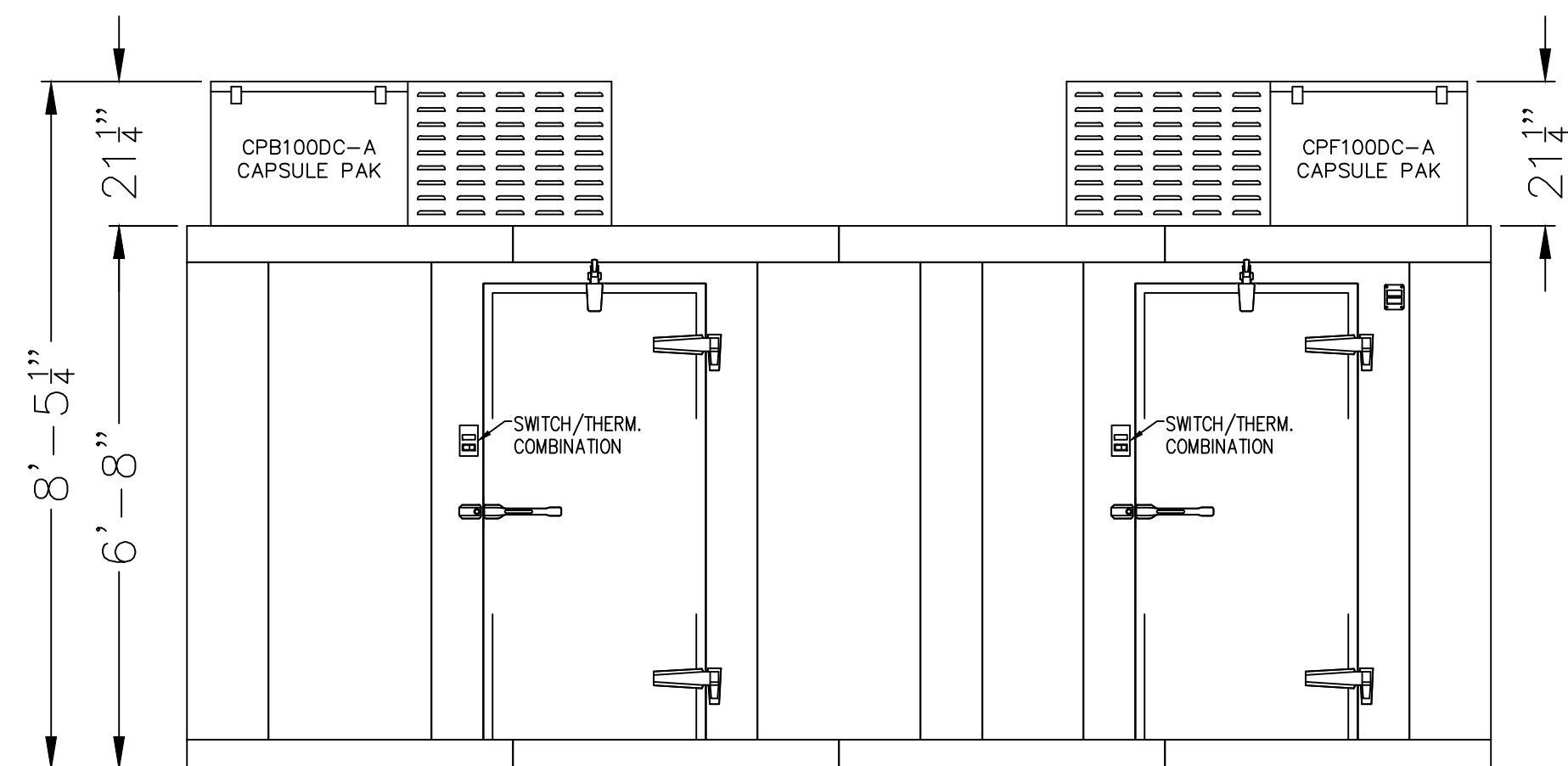

VIEW - A -

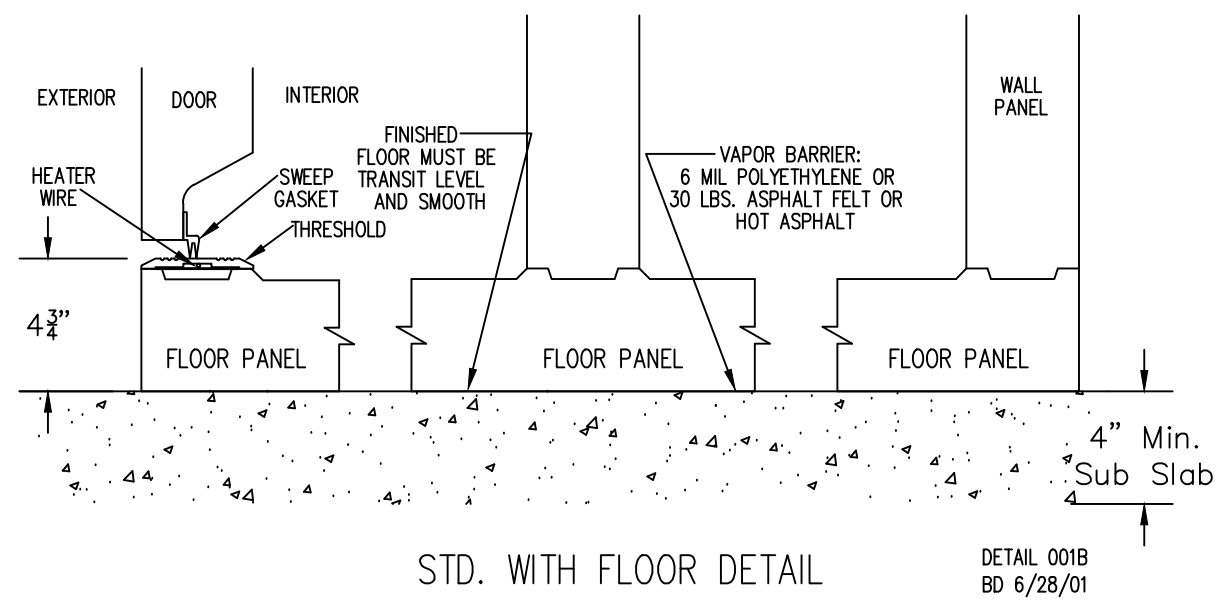

SPECIFICATIONS (D28559 Quote Number NL1750500JC-B)
Nor-Lake is registered by UL to ISO 9001-2008. California State Contractor License #940932.

(1) Nor-Lake FINELINE Walk-In Cooler/Freezer Combination (2 compartments)

Size: 16'0" long, 10'0" wide, 6'8" high

Ceiling panels to be 5" thick

Finishes:

26 Gauge Corrosion Resistant Stucco Embossed Coated Steel - Interior wall, Exterior wall, Interior ceiling

26 Gauge Smooth Galvanized - Ceiling topside, Floor bottomsides

.100 Smooth Aluminum - Interior floor

Freezer (-10.0° F) Details:

(1) 30" X 66" Walk-In Door right-hand swing

Includes door closer, cam lift hinges (one spring loaded), NL9800 deadbolt key/padlock handle with inside release, magnetic gasket, heater wire, double sweep gasket, LED vapor proof light, Heated Air Vent (standard on all freezer compartments) and NL508 combination digital thermometer and switch w/pilot light.

(1) CPF100DC-A -10° F Operation, Capsule-Pak Refrigeration System, Indoor Ceiling Mount Low Temperature, Defrost Timer, R-404A Refrigerant, 208/230-1-60 Electrical Which Meets CEC Requirements. System Overall Size Is 34.5 Inches Wide, 59 Inches Long and 21.25 Inches High. 7.5 Total System AMPS, 10 Foot Corded Plug, NEMA 6-15P, 3.32 EER Rating (system capacity 3515 BTU's/hour at 90.0° F ambient temperature).

Calculated load for Freezer (-10.0° F) is 2839 BTU's/hour calculated from 90° F ambient temperature, 0' elevation, 70° F floor temperature, 8.42 minutes open door time per 24 hrs for (1) 30" X 66" walk-in door opening into 90° F ambient, 1.5 Watts per square foot lighting operating 10 hours per day, 0.03 occupants working 10 hours per day. All calculations are based on data supplied by ASHRAE publications.

(1) 100 To 125 Series - Optional Five Year Extended Compressor Warranty

(1) 18 Month Labor/Service Warranty

Cooler (35.0° F) Details:

(1) 30" X 66" Walk-In Door right-hand swing

Includes door closer, cam lift hinges (one spring loaded), NL9800 deadbolt key/padlock handle with inside release, magnetic gasket, heater wire, double sweep gasket, LED vapor proof light and NL508 combination digital thermometer and switch w/pilot light.

(1) CPB100DC-A 35° F Operation, Capsule-Pak Refrigeration System, Indoor Ceiling Mount High Temperature, "Off Cycle" Timer, R-404A Refrigerant, 208/230-1-60 Electrical Which Meets CEC Requirements. System Overall Size Is 34.5 Inches Wide, 59 Inches Long and 21.25 Inches High. 7.7 Total System AMPS, 10 Foot Corded Plug, NEMA 6-15P, 5.07 EER Rating (system capacity 7382 BTU's/hour at 90.0° F ambient temperature).

Calculated load for Cooler (35.0° F) is 4867 BTU's/hour calculated from 90° F ambient temperature, 0' elevation, 70° F floor temperature, 38.01 minutes open door time per 24 hrs for (1) 30" X 66" walk-in door opening into 90° F ambient, 1.5 Watts per square foot lighting operating 8 hours per day, 0.05 occupants working 8 hours per day. All calculations are based on data supplied by ASHRAE publications.

(1) 100 To 125 Series - Optional Five Year Extended Compressor Warranty

(1) 18 Month Labor/Service Warranty

Refrigeration is "sized" for holding product only; that is, our calculation is based on product entering at the same temperature as the desired temperature of this walk-in. If you feel that this is insufficient, please advise.

Construction Approvals: NSF Approved, cULus and CSA Electrical, UL Flame Spread-25 and ULC Flame Spread-50 in accordance with ASTM-E-84. To comply with the US Energy Independence & Security Act of 2007, all walk-in doors opening into the ambient (indoors or outdoors) are required to have a method for minimizing infiltration when the doors are open. All Nor-Lake walk-in doors will include a spring hinge to comply with this standard by 1-1-09; however, to further minimize infiltration, Nor-Lake recommends the use of a strip curtain or strip door for all exterior doors. NOTE: Indoor walk-in must be in an environmentally controlled space. Relative Humidity should be kept between 30%-60%, maintaining a Dew Point of 50° F or less.

Quotation is subject to change upon receipt of detailed specifications and/or refrigeration load information.

Refrigeration sizing is based on maximum line runs of 100 feet per system.

NOTE: Walk-ins sold into the state of California may require structural engineered drawings for seismic review. If required, Nor-Lake can provide the required drawings and structural support. Please contact Nor-Lake for lead time and pricing to meet this requirement.

Local Codes: Walk-ins may need engineered drawings or special construction to meet local code approvals for rain, wind, seismic, and snow load approvals. If required, please contact Nor-Lake for lead time and pricing to meet these requirements.

*** Verify all dimensions ***

PANEL CONSTRUCTION SCHEDULE

THIS COMBINATION WALK-IN SHALL BE CONSTRUCTED AS FOLLOWS:

- COOLER WALLS TO BE 4" THICK
- FREEZER WALLS TO BE 5" THICK
- ALL CEILING PANELS TO BE 5" THICK
- ALL FLOOR PANELS (IF APPLICABLE) TO BE 4" THICK

<p>ATM A. F. McDONALD & ASSOCIATES FOOD FACILITIES CONSULTANT - DESIGNER 735 Main Street Shrewsbury, MA 01545 Tel: 508.845.9891 Cell: 508.479.3511</p>	
SCALE: 1/2"=1'-0"	DATE: 02/02/17
PROJECT: BENKAY REST 16 MIDDLE STREET PORTLAND, ME	
CLIENT: -	SHEET#: K-5
DRAWING: WALK-IN COOLER / FREEZER DETAIL	