

NOTES:
1. FOR ADDITIONAL NOTES AND INFORMATION SEE DRAWING S1.02.

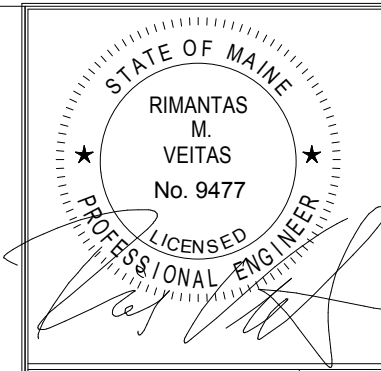

Prepared For:
BATEMAN PARTNERS, LLC
P.O. BOX 7486
Portland, ME 04112

Consulting Engineer:
VEITAS VEITAS engineers
68 Granite Street, Suite 101
Business, Scarborough, ME 04101
Tel: (207) 886-7486 Fax: (207) 886-2006

Architect:
ARCHETYPE architects
48 Union Wharf Portland, Maine 04101
(207) 772-6022 Fax (207) 772-4056

Project:
16 MIDDLE STREET
MIDDLE STREET
PORTLAND, MAINE

Revisions:

01/15/16	ISSUED FOR FDN. PERMIT
06/03/16	ISSUED FOR BUILDING PERMIT
06/14/16	ISSUED FOR CONSTRUCTION
07/17/16	ISSUED FOR ADDENDUM #1

Date: 01/15/16
Scale:
4th FLOOR FRAMING PLAN

S1.04

1 4th FLOOR FRAMING PLAN
1/8" = 1'-0"

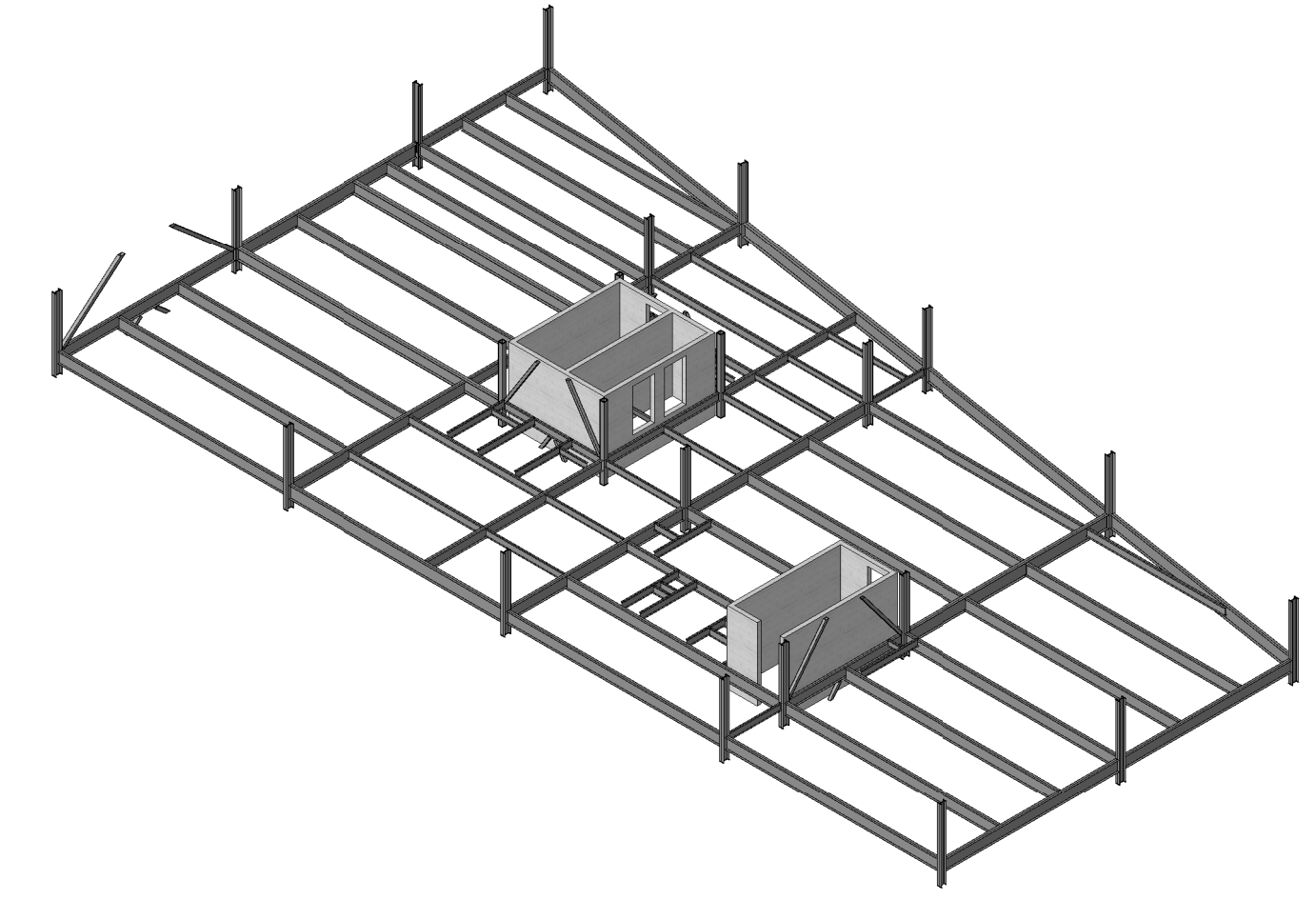

FLOOR CONSTRUCTION:
3 1/4" LIGHT WEIGHT CONCRETE OVER 2" - 18 GA.
(F_y = 40 KSI) GALV. COMPOSITE METAL DECK.
REINFORCE W/ 6x6-W2.9xW2.9 W.X.F. (TOTAL T = 5 1/4")
TOP OF CONCRETE EL. 65'-1 3/16"
TOP OF STEEL EL. -5 1/4" BELOW T.O.C. EL. (U.N.O.)