

APPROX. LOCATION EXISTING UTILITY POLE (CONTACT CMP AND "POINT XXX")

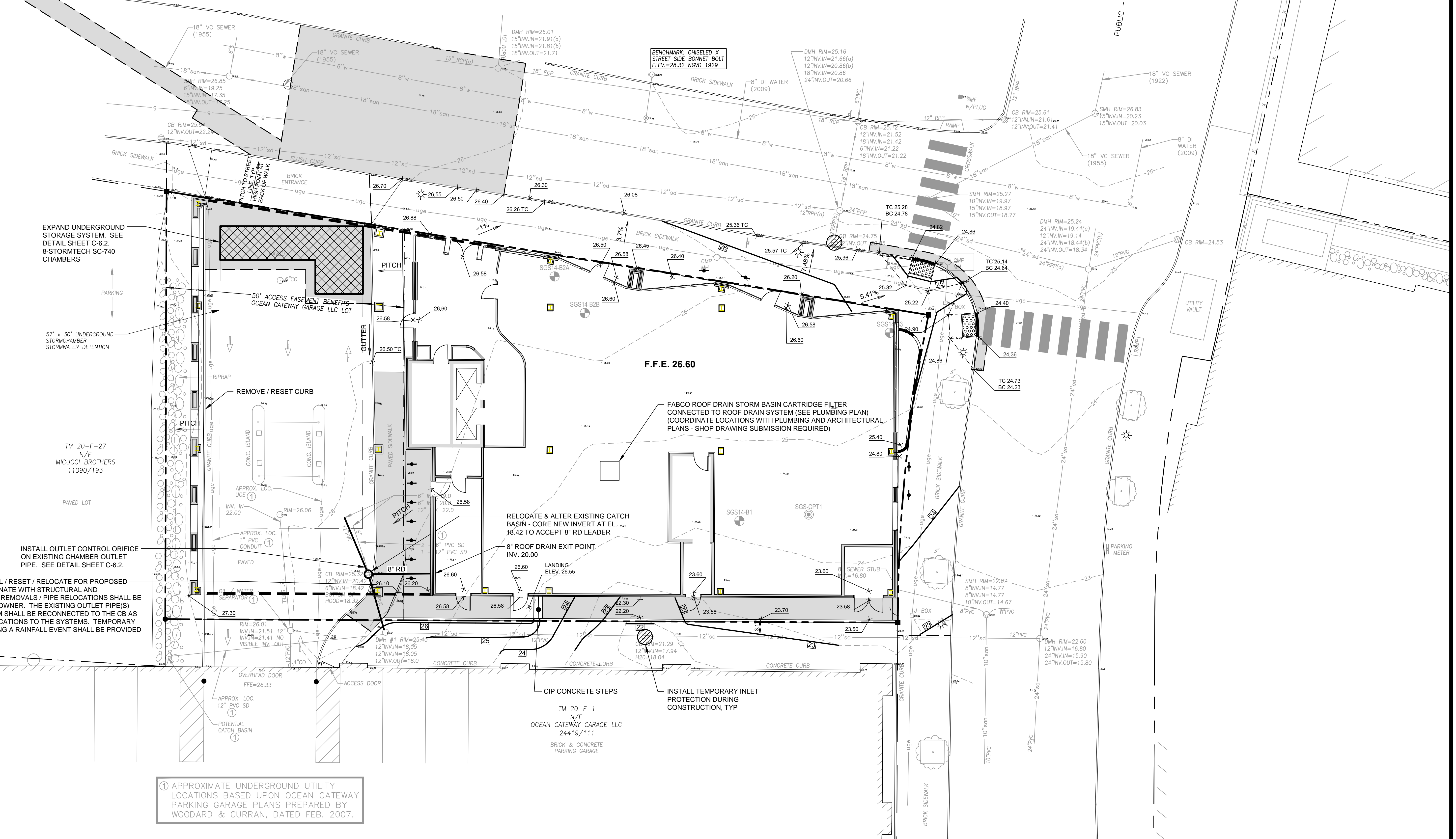

EXPAND UNDERGROUND STORAGE SYSTEM, SEE DETAIL SHEET C-6.2. 8-STORMTECH SC-740 CHAMBERS

57' x 30' UNDERGROUND STORMCHAMBER STORMWATER DETENTION

TM 20-F-27
N/F
MICUCCI BROTHERS
11090/193

INSTALL OUTLET CONTROL ORIFICE ON EXISTING CHAMBER OUTLET PIPE. SEE DETAIL SHEET C-6.2.

EXISTING CB & 12\"/>

① APPROXIMATE UNDERGROUND UTILITY LOCATIONS BASED UPON OCEAN GATEWAY GARAGE PLANS PREPARED BY WOODARD & CURRAN, DATED FEB. 2007.

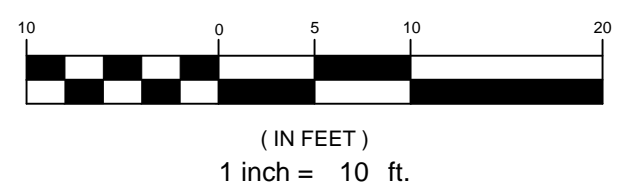

REV	DATE	DESCRIPTION
9	06.03.16	ISSUED FOR CONSTRUCTION
8	05.20.16	90% CD PACKAGE
7	02.15.16	50% CD PACKAGE
6	04.15.15	REVISED PER STAFF COMMENTS & RESUBMITTED TO CITY
5	02.06.15	SUBMITTED FINAL SITE PLAN APPLICATION TO CITY
4	07.22.14	REVISED GRADING TO REFLECT UPDATED LANDSCAPE PLANTERS
3	07.08.14	REVISED PER ENGINEERING PEER REVIEW COMMENTS AND RESUBMITTED TO CITY
2	06.12.14	REVISED PER PLANNING REVIEW STAFF COMMENTS AND RESUBMITTED TO CITY
1	05.05.14	SUBMITTED TO CITY
REV	DATE	DESCRIPTION
REVISIONS		

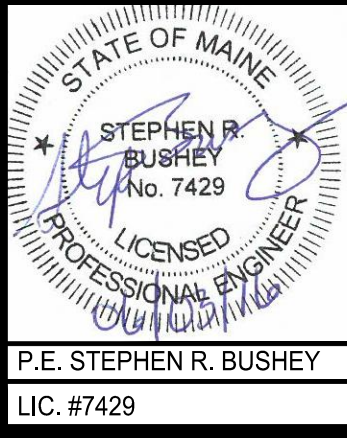

PROJECT
**16 MIDDLE STREET
PORTLAND, MAINE**

SHEET TITLE
**GRADING, DRAINAGE &
SEWER CONTROL PLAN**

CLIENT
**16 MIDDLE STREET
ASSOCIATES LLC**

FST 100 YEARS
FAY, SPOFFORD & THORNDIKE
ENGINEERS • PLANNERS • SCIENTISTS
778 MAIN ST., SUITE 8, SOUTH PORTLAND, ME 04106

DRAWN: CDD DATE: MAY 2014
DESIGNED: SRB SCALE: 1" = 10'
CHECKED: SRB JOB NO. 195350140
FILE NAME: SP-M150-GRADING & DRAINAGE
SHEET **C-4.0**