

APPROX. LOCATION EXISTING UTILITY POLE (CONTACT CMP AND FAIRPOINT XXX)

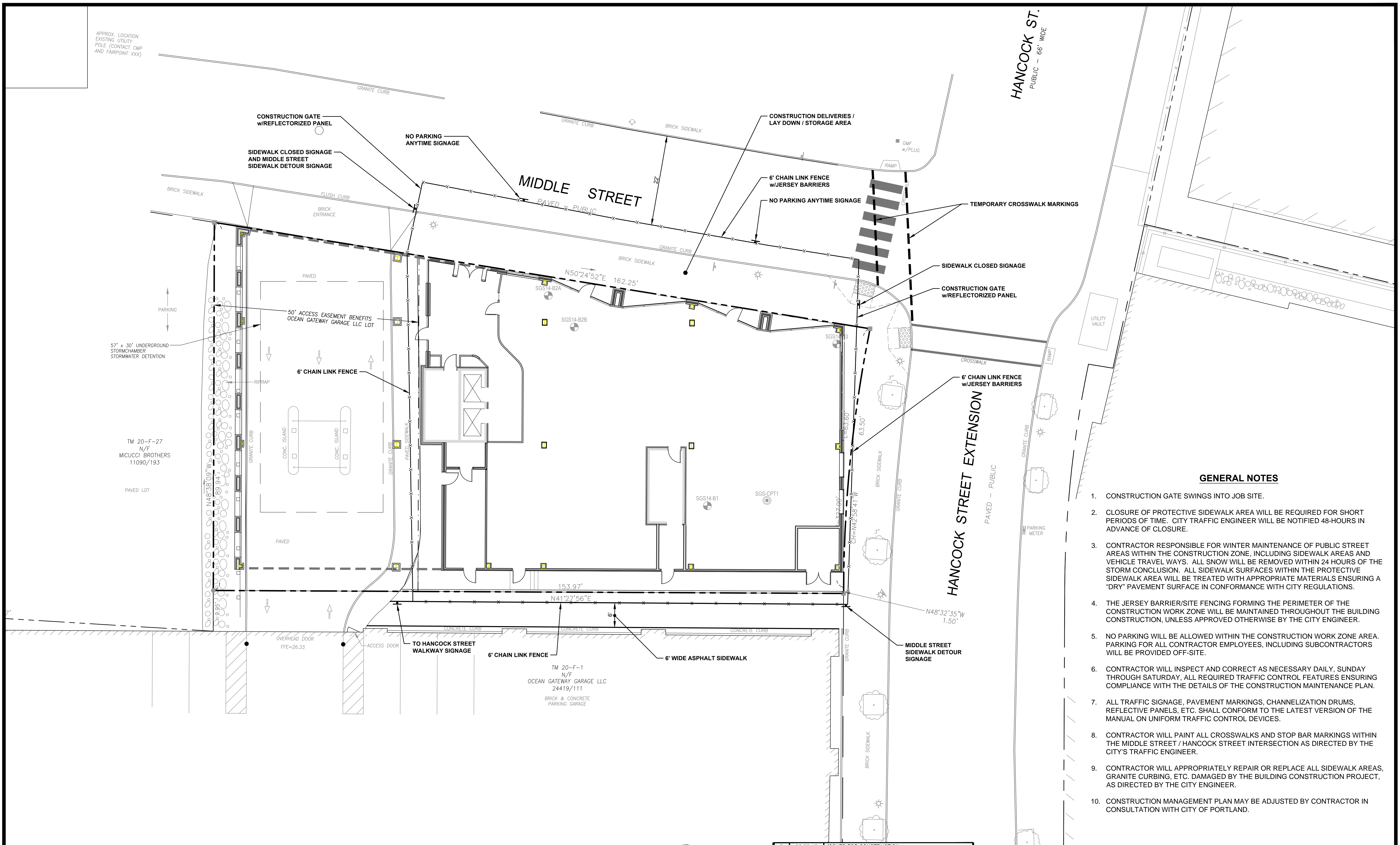

**GENERAL NOTES**

1. CONSTRUCTION GATE SWINGS INTO JOB SITE.
2. CLOSURE OF PROTECTIVE SIDEWALK AREA WILL BE REQUIRED FOR SHORT PERIODS OF TIME. CITY TRAFFIC ENGINEER WILL BE NOTIFIED 48-HOURS IN ADVANCE OF CLOSURE.
3. CONTRACTOR RESPONSIBLE FOR WINTER MAINTENANCE OF PUBLIC STREET AREAS WITHIN THE CONSTRUCTION ZONE, INCLUDING SIDEWALK AREAS AND VEHICLE TRAVEL WAYS. ALL SNOW WILL BE REMOVED WITHIN 24 HOURS OF THE STORM CONCLUSION. ALL SIDEWALK SURFACES WITHIN THE PROTECTIVE SIDEWALK AREA WILL BE TREATED WITH APPROPRIATE MATERIALS ENSURING A "DRY" PAVEMENT SURFACE IN CONFORMANCE WITH CITY REGULATIONS.
4. THE JERSEY BARRIER/SITE FENCING FORMING THE PERIMETER OF THE CONSTRUCTION WORK ZONE WILL BE MAINTAINED THROUGHOUT THE BUILDING CONSTRUCTION, UNLESS APPROVED OTHERWISE BY THE CITY ENGINEER.
5. NO PARKING WILL BE ALLOWED WITHIN THE CONSTRUCTION WORK ZONE AREA. PARKING FOR ALL CONTRACTOR EMPLOYEES, INCLUDING SUBCONTRACTORS WILL BE PROVIDED OFF-SITE.
6. CONTRACTOR WILL INSPECT AND CORRECT AS NECESSARY DAILY, SUNDAY THROUGH SATURDAY, ALL REQUIRED TRAFFIC CONTROL FEATURES ENSURING COMPLIANCE WITH THE DETAILS OF THE CONSTRUCTION MAINTENANCE PLAN.
7. ALL TRAFFIC SIGNAGE, PAVEMENT MARKINGS, CHANNELIZATION DRUMS, REFLECTIVE PANELS, ETC. SHALL CONFORM TO THE LATEST VERSION OF THE MANUAL ON UNIFORM TRAFFIC CONTROL DEVICES.
8. CONTRACTOR WILL PAINT ALL CROSSWALKS AND STOP BAR MARKINGS WITHIN THE MIDDLE STREET / HANCOCK STREET INTERSECTION AS DIRECTED BY THE CITY'S TRAFFIC ENGINEER.
9. CONTRACTOR WILL APPROPRIATELY REPAIR OR REPLACE ALL SIDEWALK AREAS, GRANITE CURBING, ETC. DAMAGED BY THE BUILDING CONSTRUCTION PROJECT, AS DIRECTED BY THE CITY ENGINEER.
10. CONSTRUCTION MANAGEMENT PLAN MAY BE ADJUSTED BY CONTRACTOR IN CONSULTATION WITH CITY OF PORTLAND.

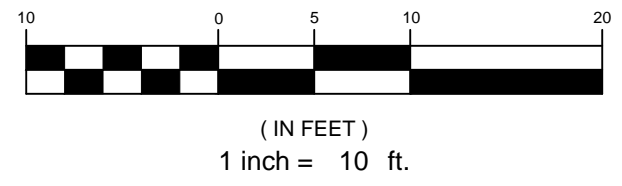
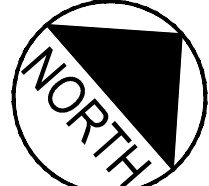

REV	DATE	DESCRIPTION
8	06.03.16	ISSUED FOR CONSTRUCTION
7	05.24.16	90% CD PACKAGE
6	10.20.15	RELEASED FOR CONSTRUCTION
5	04.15.15	REVISED PER STAFF COMMENTS & RESUBMITTED TO CITY
4	02.06.15	SUBMITTED FINAL SITE PLAN APPLICATION TO CITY
3	07.08.14	REVISED PER ENGINEERING PEER REVIEW COMMENTS AND RESUBMITTED TO CITY
2	06.12.14	REVISED PER PLANNING REVIEW STAFF COMMENTS AND RESUBMITTED TO CITY
1	05.05.14	SUBMITTED TO CITY
		REVISIONS

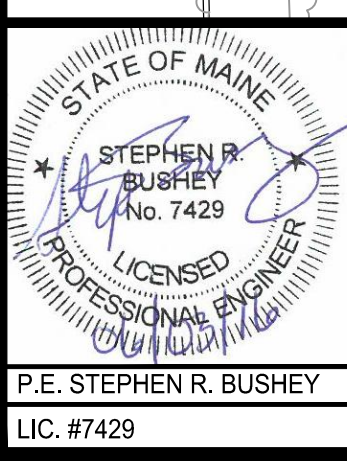

PROJECT  
**16 MIDDLE STREET  
 PORTLAND, MAINE**

SHEET TITLE  
**CONSTRUCTION  
 MANAGEMENT PLAN**

CLIENT  
**16 MIDDLE STREET  
 ASSOCIATES LLC**

**FST** **FAY, SPOFFORD & THORNDIKE**  
 ENGINEERS • PLANNERS • SCIENTISTS  
 778 MAIN ST., SUITE 8, SOUTH PORTLAND, ME 04106

DRAWN: CDD	DATE: MAY 2014
DESIGNED: SRB	SCALE: 1" = 10'
CHECKED: SRB	JOB NO. 195350140
FILE NAME: SP-M150-Construction Management Plan	
SHEET	<b>C-2.3</b>