

**ROOF/CEILING ASSEMBLY - 2 - HR RATING**

SPRAY FIREPROOFING FOR DECK - 2-HR RATED  
 SPRAY FIREPROOFING FOR STEEL - 2-HR RATED

1. **ROOFTOP PAVER/INSULATION SYSTEM** -- SEE DETAILS ON SHEET A5.00
2. **METAL DECK** -- 1/2"-18 GAGE GALVANIZED ROOF DECK (SEE STRUCTURAL)
3. **STEEL BEAM** -- SEE STRUCTURAL.
4. **SPRAY APPLIED FIRE RESISTIVE MATERIALS** -- 2-HR RATING PER MANUFACTURERS INSTRUCTION
5. **ACOUSTIC CEILING SYSTEM** -- INSTALLED BY FUTURE TENANT

**2 | FC2 - ROOF/CEILING ASSEMBLY - 2HR RATED**

1 1/2" = 1'-0"

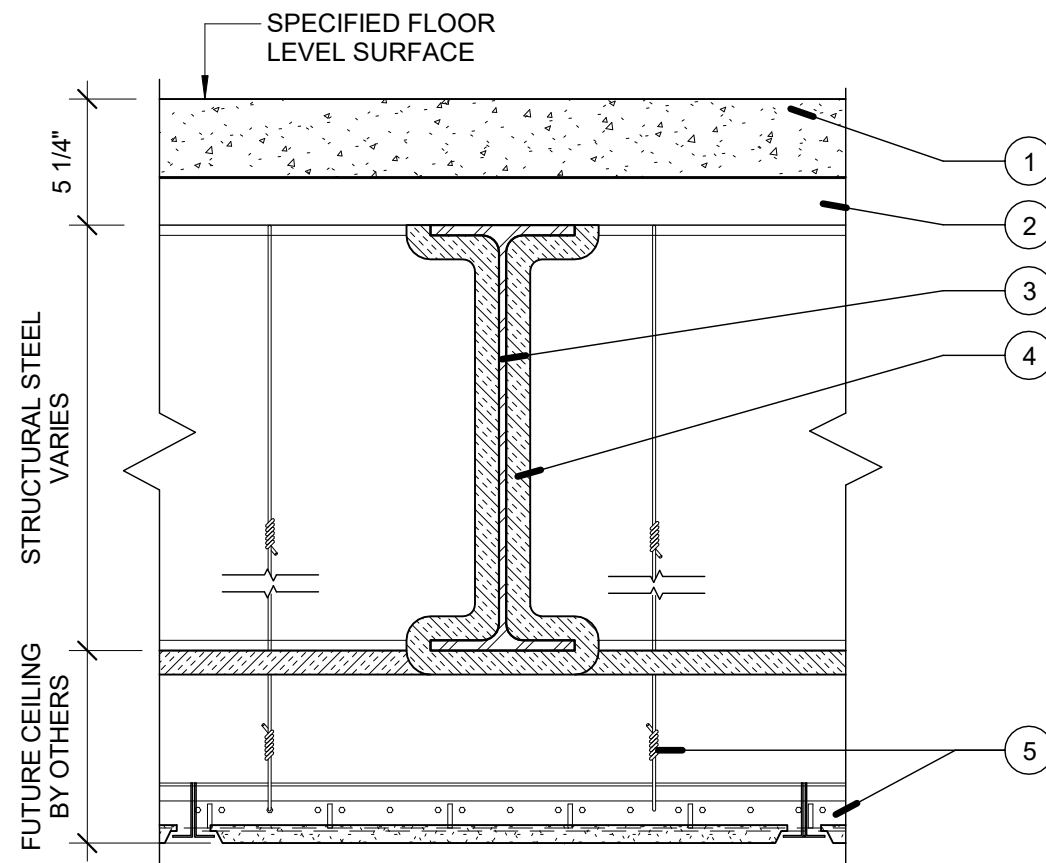

**FLOOR/CEILING ASSEMBLY - 2 - HR RATING**

U.L. RATING = D902 (FOR CONCRETE FLOOR)  
 SPRAY FIREPROOFING FOR STEEL - 2-HR RATED

1. **CONCRETE FLOOR** -- 3-1/4" LIGHT WEIGHT CONCRETE REINFORCED WITH 6X6 - W2.9 x W2.9 . (SEE STRUCTURAL)
2. **METAL DECK** -- 2"-20 GAGE GALVANIZED COMPOSITE FLOOR DECK (SEE STRUCTURAL)
3. **STEEL BEAM** -- SEE STRUCTURAL.
4. **SPRAY APPLIED FIRE RESISTIVE MATERIALS** -- 2-HR RATING PER MANUFACTURERS INSTRUCTION
5. **ACOUSTIC CEILING SYSTEM** -- INSTALLED BY FUTURE TENANT

**1 | FC1 - FLOOR/CEILING ASSEMBLY - 2HR RATED**

1 1/2" = 1'-0"

Architect:  
**ARCHETYPE**  
 architects  
 48 Union Wharf Portland, Maine 04101  
 (207) 772-6022 Fax (207) 772-4056

Date: 07/27/17  
 Scale: 1 1/2" = 1'-0"  
**RATED**  
**FLOOR/CEILING**  
**ASSEMBLY**

Project:  
**Ocean Gateway Addition**  
 167 Fore Street  
 Portland, Maine

