

# FOR MORTGAGE LENDER USE ONLY

GENERAL NOTES: (1) DISTANCES SHOWN ARE TAKEN FROM PROVIDED TITLE REFERENCES SHOWN BELOW (2) THE PURPOSE OF THIS INSPECTION IS TO REVIEW IN OPINION AS FOLLOWS: (A) DWELLING AND ANY OTHER STRUCTURE'S COMPLIANCE WITH RESPECT TO MAJOR ROAD SETBACKS AND (B) FLOOD ZONE DETERMINATION BY HORIZONTAL SCALING ON BELOW REFERENCED FEMA MAP (3) THIS INSPECTION APPLIES ONLY TO ALL TECHNICAL STANDARDS CURRENTLY SET FORTH BY STATE OF MAINE BOARD OF LAND SURVEYORS COMMUNITY MAP STATUTE (4) THIS INSPECTION IS TO BE USED ONLY BY THE BELOW LISTED LENDER AND IS NOT TO BE USED BY ANY OTHER PARTY FOR BOUNDARY LINE LOCATIONS OR LAND TITLE OPINIONS (5) TITLE OR OWNER, IF NOT DETERMINED (6) A PROPERTY SURVEY SHOULD BE PERFORMED TO OBTAIN A PROFESSIONAL OPINION PERTAINING TO BOUNDARY LINE LOCATIONS, EASEMENTS, RIGHTS OF WAY, ENCROACHMENTS, ENCROACHMENTS, AND OR CONFLICTS WITH ADJUTER'S DEEDS (7) LOCATION/EXISTENCE OF WATERWAYS NOT DETERMINED UNLESS SHOWN ON A RECORDED SUBDIVISION PLAN

THIS SKETCH IS NOT TO BE USED FOR CONSTRUCTION PURPOSES, IMPROVEMENTS SHOWN ARE APPROXIMATE

ADDRESS: 125 NEWBURY ST INSP. DATE: 5-15-13  
PORTLAND, ME SCALE: 1" = 15'

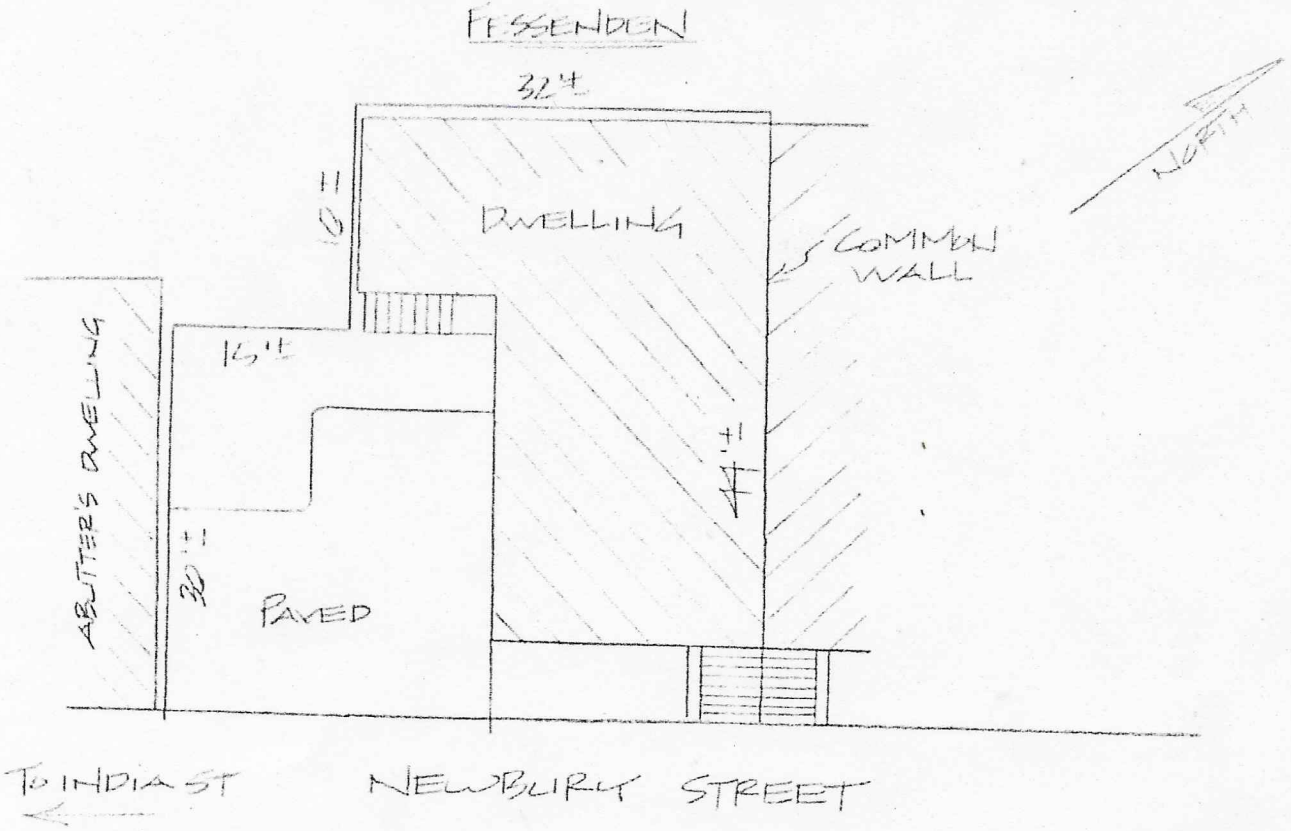

JDN

SEE PROVIDED TITLE REFERENCES FOR APPURTENANCES, IF ANY.

APPLICANT: CLARKE FILE#: 21325714  
 OWNER: BROWN CLIENT#: \_\_\_\_\_  
 LENDER: Savo & BIDDEFORD SAVINGS INST.  
 REQ. PARTY: Savo & BIDDEFORD SAVINGS INST.

TITLE REFERENCES: \_\_\_\_\_ COUNTY: CUMB  
 DEED BOOK: 1576S PAGE: 132  
 PLAN BOOK: \_\_\_\_\_ PAGE: \_\_\_\_\_ LOT: \_\_\_\_\_

MUNICIPAL REFERENCE:  
 MAP: 20 BLOCK: D LOT: 23

THE DWELLING DOES NOT FALL WITHIN A SPECIAL FLOOD HAZARD AREA PER FEMA COMMUNITY MAP No. 230251 PANEL: 0013B  
 ZONE: C DATE: 12-9-93

THE DWELLING WAS ██████ IN COMPLIANCE WITH MUNICIPAL ZONING SETBACK REQUIREMENTS AT THE TIME OF CONSTRUCTION.

Nadeau Land Surveys

Professional Land Surveyors  
 Certified Floodplain Managers

STATE OF MAINE

JAMES D. NADEAU  
 2124

PROFESSIONAL LAND SURVEYOR

5-16-13

918 BRIGHTON AVE. PH. (207) 878-7870  
 PORTLAND, ME. 04102 F. (207) 878-7871

THIS INSPECTION IS VALID ONLY WITH A SURVEYOR'S SEAL AND IS NULL & VOID 90 DAYS AFTER INSPECTION DATE