

**PROFILE: HANCOCK STREET**  
 STA. 3+11.17 TO STA. 6+15  
 SCALE: 1"=30' HORIZ.  
 1"=3' VERT.

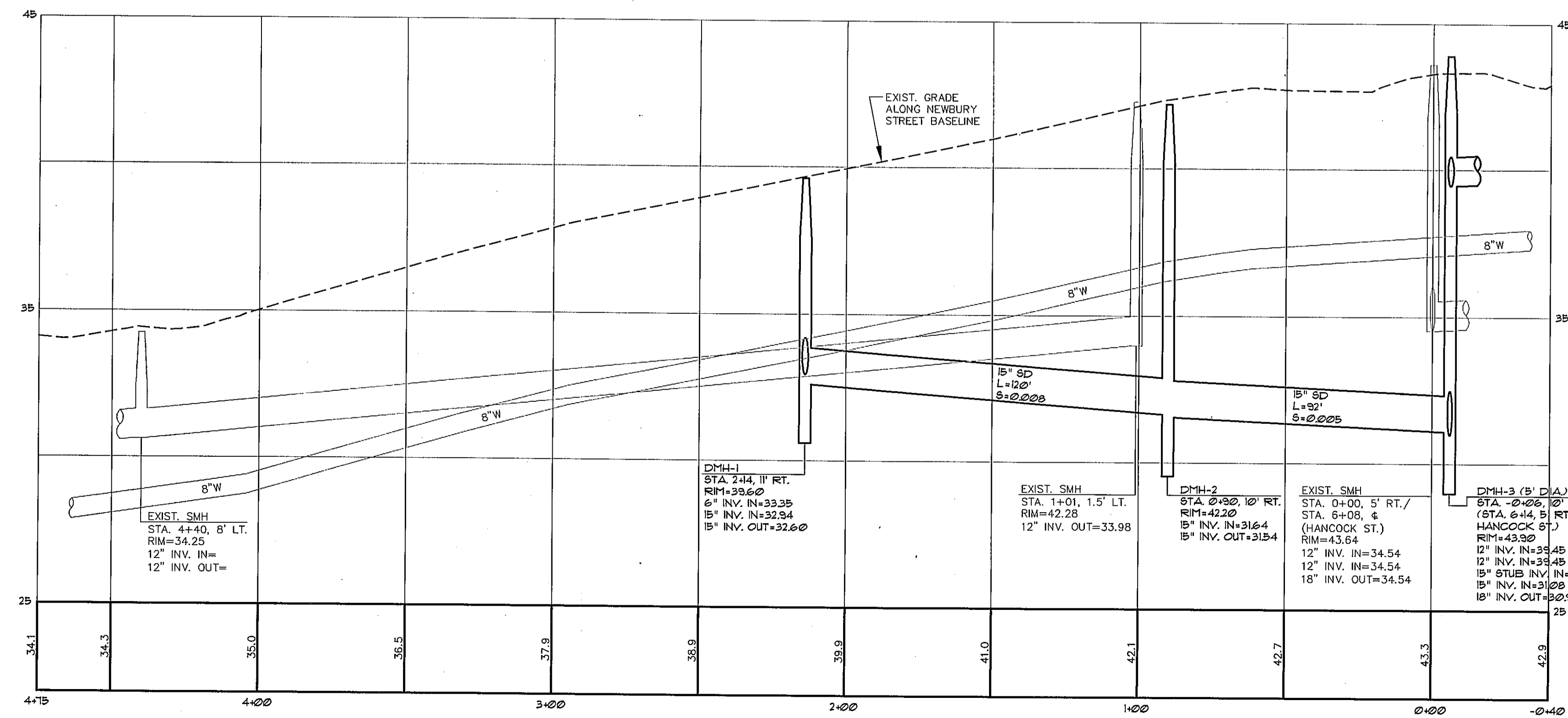

**PROFILE: NEWBURY STREET**  
 STA. -0+40 TO STA. 4+15  
 SCALE: 1"=30' HORIZ.  
 1"=3' VERT.

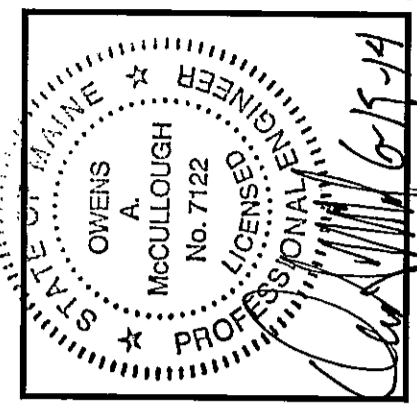

REV.	BY	DATE	STATUS
H	WTC	05-20-14	CITY SUBMITTAL B
G	WTC	06-12-14	FOUNDATION PERMIT SET
F	WTC	01-07-13	CITY SUBMITTAL 7
E	WTC	10-15-13	CITY SUBMITTAL 6
D	WTC	10-03-13	CITY SUBMITTAL 5
C	WTC	09-17-13	CITY SUBMITTAL 4
B	WTC	09-03-13	CITY SUBMITTAL 3

**SEBAGO TECHNICALS**  
 WWW.SEAGOTECHNICALS.COM  
 75 John Robb Rd., Suite 1A  
 South Portland, ME 04106  
 Tel: 207-262-2100 Fax: 207-262-5866

PROJECT NO.	13251
FIELD BOOK	DESIGN
CHKD	WTC
DRAWN	WTC
MAL	MAL

**PROFILE: HANCOCK ST. AND NEWBURY ST.**  
 OF:  
**SEAPORT LOFTS**  
 NEWBURY/HANCOCK STREET  
 FORT LAND, MAINE  
 FOR:  
**113 NEWBURY STREET, LLC**  
 35 FAY STREET, SUITE 107B  
 BOSTON, MA 02118-4320

DATE	SCALE
07-26-13	AS SHOWN