

PROFILE: HANCOCK STREET
STA. 3+11.7 TO STA. 6+75
SCALE: 1"=30' HORIZ.
1"=3' VERT.

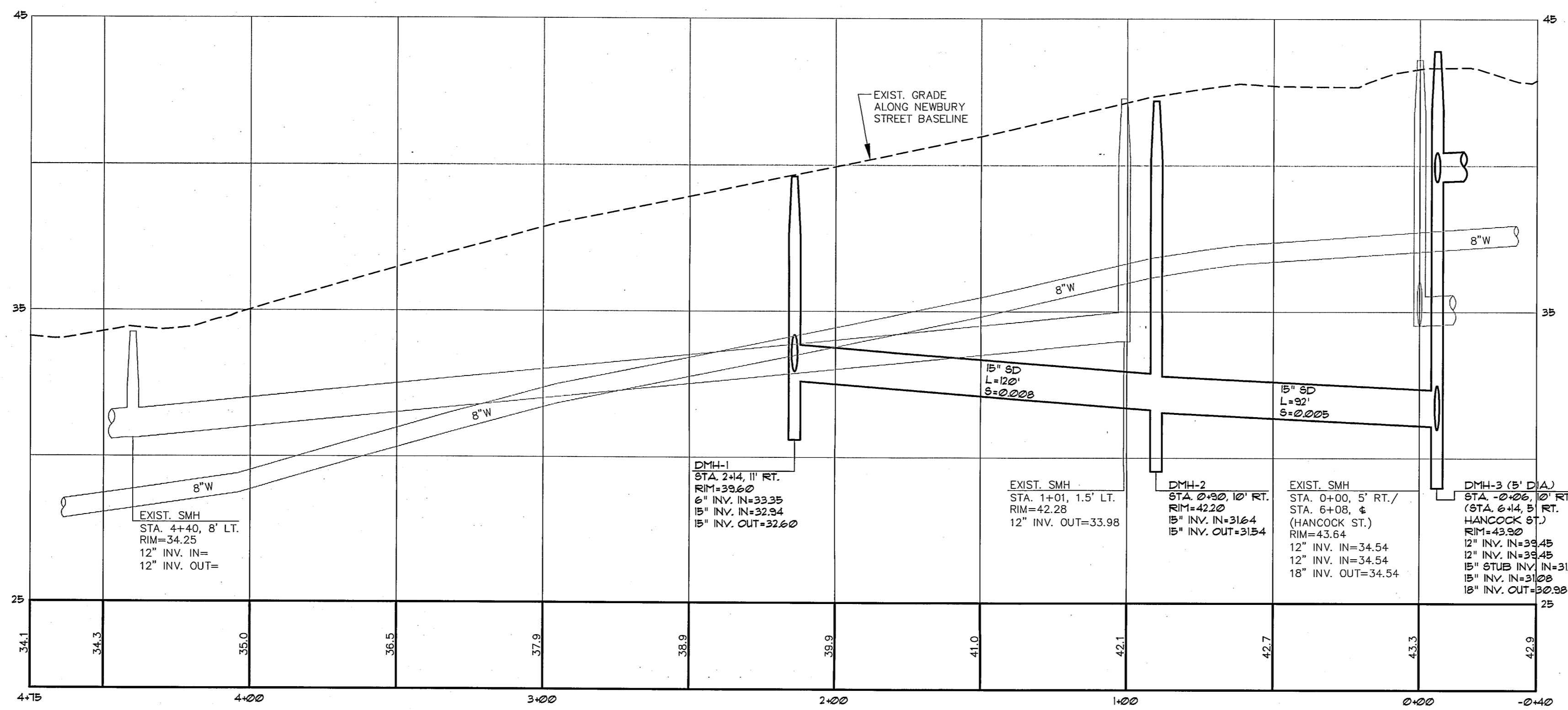

PROFILE: NEWBURY STREET
STA. -0+40 TO STA. 4+75
SCALE: 1"=30' HORIZ.
1"=3' VERT.

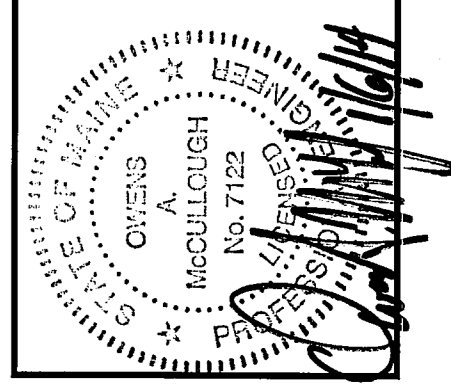

F	WTC	01-07-13	CITY SUBMITTAL 7
E	WTC	10-15-13	CITY SUBMITTAL 6
D	WTC	10-03-13	CITY SUBMITTAL 5
C	WTC	09-17-13	CITY SUBMITTAL 4
B	WTC	09-03-13	CITY SUBMITTAL 3
A	BY:	07-29-13	SUBMIT SITE PLAN APPLICATION TO CITY

REV. BY: DATE: STATUS:

THIS PLAN SHALL NOT BE REPRODUCED, COPIED, REPRODUCED, OR OTHERWISE TRANSMITTED IN ANY FORM OR BY ANY MEANS, WITHOUT THE WRITTEN PERMISSION FROM SEBAGO TECHNICAL SERVICES, INC. ANY ALTERATIONS, ADDITIONS, OR DELETIONS SHALL BE AT THE USER'S SOLE RISK AND WITHOUT LIABILITY TO SEBAGO TECHNICAL SERVICES, INC.

SEBAGO TECHNICAL SERVICES
WWW.SEBAGOTECHNICALSERVICES.COM
75 John Roberts Rd. - Suite 1A
South Portland, ME 04106
Tel: 207-286-2100

PROJECT NO. 13251 | FIELD BOOK DESIGN | CHKD | DRAWN | WTC | WTC | MAL

PROFILE: HANCOCK ST. AND NEWBURY ST.
OF:
SEAPORT LOFTS
NEWBURY / HANCOCK STREET
PORTLAND, MAINE
FOR:
113 NEWBURY STREET, LLC
35 FAY STREET, SUITE 107B
BOSTON, MA 02118-4320

DATE: 07-26-13 | SCALE: AS SHOWN

SHEET 8 OF 14

13251P-dwg. TAB:P