

**NOTES:**  
 1. STORM DRAIN SHALL BE SMOOTH BORE ADS-N-12 DUAL-WALLED, HIGH DENSITY POLYETHYLENE PIPE OR EQUAL WITHIN SITE LIMITS.  
 2. STORM DRAIN SHALL BE SDR-35 FVC PIPE WITHIN CITY RIGHT-OF-WAYS.

**LEGEND**

EXISTING	DESCRIPTION	PROPOSED	EXISTING	DESCRIPTION	PROPOSED
---	BOUNDARY LINE/ROW	---	⊗	WATER GATE VALVE	⊗
---	ABUTTER LINE/ROW	---	⊕	WATER SHUT OFF	⊕
---	SETBACK	---	⊖	HYDRANT	⊖
▨	BUILDING	▨	⊙	SEWER	⊙
---	SIGN	---	⊙	SEWER MH	⊙
---	EDGE PAVEMENT	---	⊙	STORM DRAIN	⊙
---	EDGE CONCRETE	---	⊙	ROOF DRAIN	⊙
---	CURBLINE	---	⊙	CATCH BASIN	⊙
---	CONTOURS	---	⊙	DRAINAGE MH	⊙
---	SPOT GRADE	---	⊙	OVERHEAD UTILITY	⊙
---	SIDEWALK SLOPE	---	⊙	UNDERGROUND UTILITY	⊙
---	SCREEN FENCING	---	⊙	TRANSFORMER PAD	⊙
---	RETAINING WALL	---	⊙	ELECTRICAL MANHOLE	⊙
⊙	DECIDUOUS TREE	⊙	⊙	LIGHT POLE/WALL	⊙
⊙	CONIFEROUS TREE	⊙	⊙	UTILITY POLE	⊙
⊙	GAS	⊙	⊙	GUY	⊙
⊙	WATER	⊙			

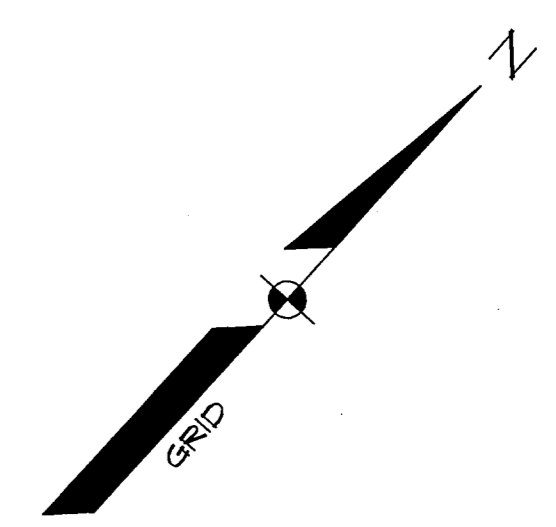

MATCHLINE RIGHT

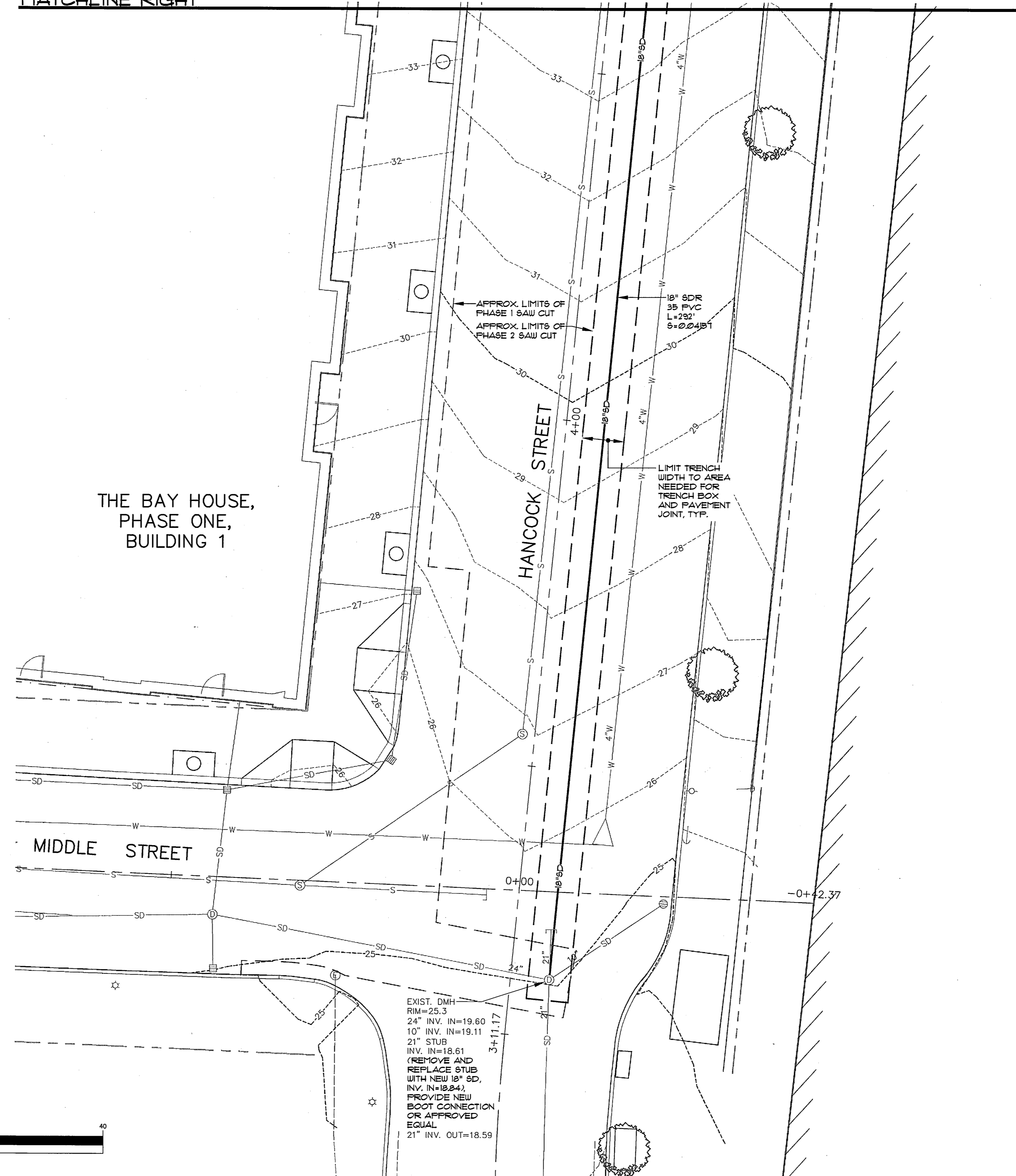

MATCHLINE LEFT

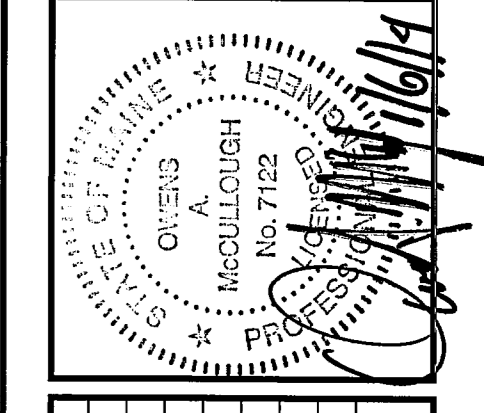
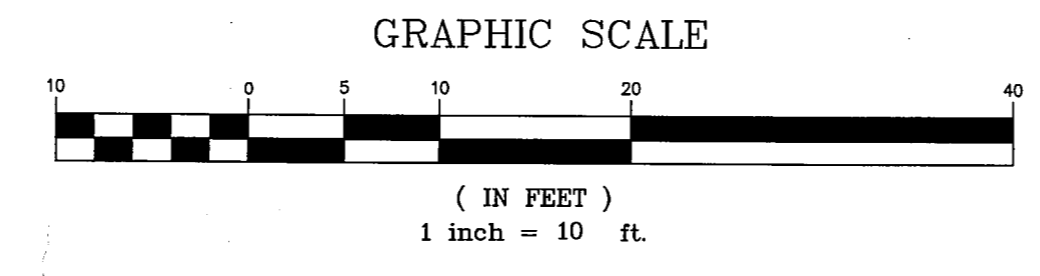

REV.	BY:	DATE:	STATUS:
F	WTC	01-07-13	CITY SUBMITTAL 7
E	WTC	10-15-13	CITY SUBMITTAL 6
D	WTC	10-03-13	CITY SUBMITTAL 5
C	WTC	09-17-13	CITY SUBMITTAL 4
B	WTC	08-03-13	CITY SUBMITTAL 3
A	WTC	07-29-13	SUBMIT SITE PLAN APPLICATION TO CITY

THIS PLAN SHALL NOT BE USED WITHOUT WRITTEN PERMISSION FROM SEBAGO TECHNICAL SERVICES, INC. ANY ALTERATIONS, AUTHORIZED OR OTHERWISE, SHALL BE AT THE USER'S SOLE RISK AND WITHOUT LIABILITY TO SEBAGO TECHNICAL SERVICES, INC.

**SEBAGO TECHNICAL SERVICES**  
 WWW.SEBAGOTECHNICALSERVICES.COM  
 75 John Roberts Rd., Suite 1A  
 South Portland, ME 04106  
 Tel: 207-888-8558

PROJECT NO. 13251  
 FIELD BOOK DESIGN CHKD DRAWN  
 13251 WTC WTC MAL

**OFF-SITE DRAINAGE PLAN**  
 OF:  
**SEAPORT LOFTS**  
 NEWBURY / HANCOCK STREET  
 PORTLAND, MAINE  
 FOR:  
**113 NEWBURY STREET, LLC**  
 35 FAY STREET, SUITE 107B  
 BOSTON, MA 02118-4320

DATE: 07-26-13  
 SCALE: 1" = 10'

**SHEET 7 OF 14**