

PROFILE: HANCOCK STREET
 STA. 3+11.17 TO STA. 6+15
 SCALE: 1"=3' HORIZ.
 1"=3' VERT.

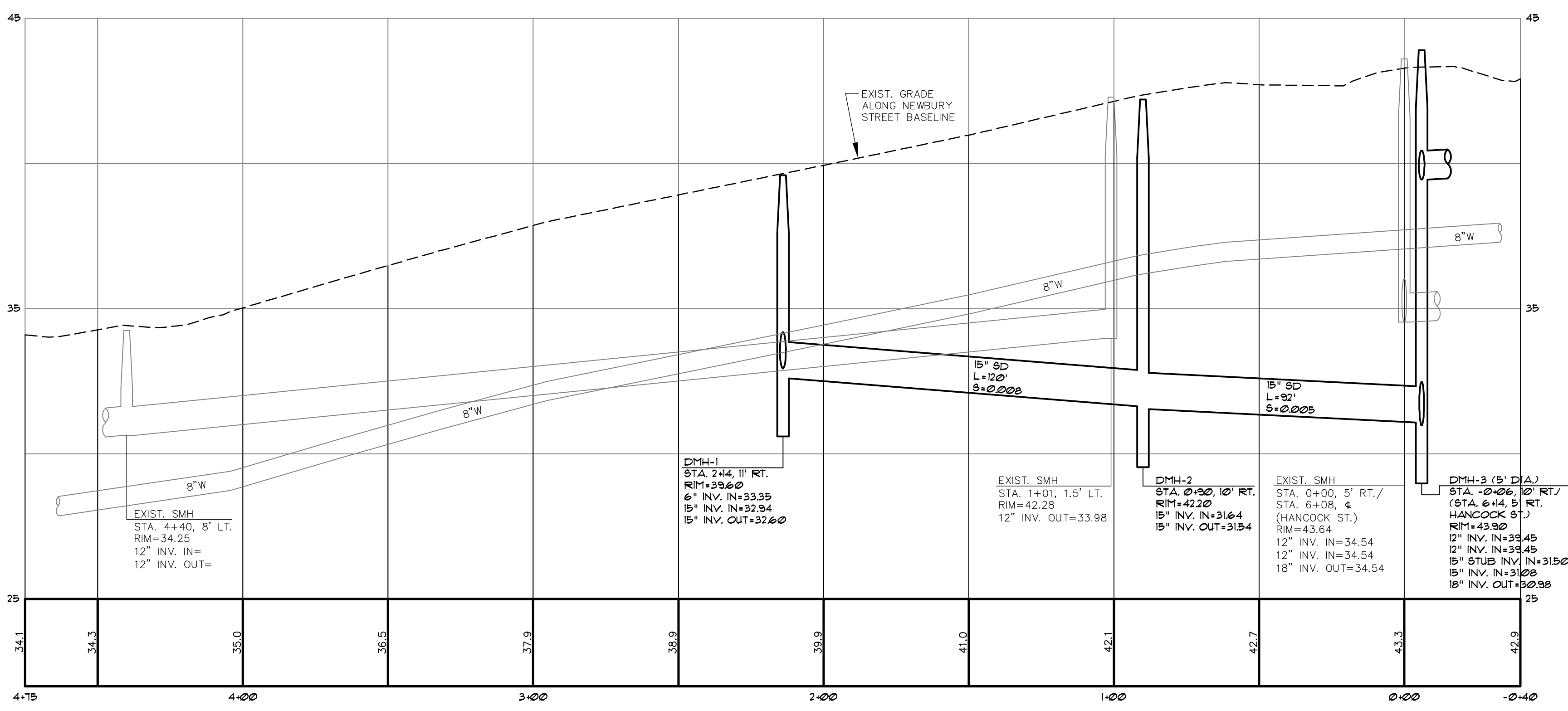

PROFILE: NEWBURY STREET
 STA. 0+40 TO STA. 4+15
 SCALE: 1"=3' HORIZ.
 1"=3' VERT.

08-06-14	PRICING SET 1 AUGUST 6, 2014
07-22-14	ADDRESS COMMENTS PER WILLIAM CLARKE E-MAIL DATED 07-10-14
06-20-14	CITY SUBMITTAL 8
06-12-14	FOUNDATION PERMIT SET
01-07-13	CITY SUBMITTAL 7
10-15-13	CITY SUBMITTAL 6
10-03-13	CITY SUBMITTAL 5
DATE:	STATUS:
REV: BY:	DATE:
J	WTC
I	WTC
H	WTC
G	WTC
F	WTC
E	WTC
D	WTC

SEBAGO
 TECHNICALS
 WWW.SEAGOTECHNICALS.COM
 75 John Roberts Rd., Suite 1A
 South Portland, ME 04106
 Tel: 207-262-2100
 Fax: 207-783-5888

DESIGN	CHKD	DRAWN
WTC	WTC	MAL

PROJECT NO. 13251

PROFILE: HANCOCK ST. AND NEWBURY ST.
 OF:
 SEAPORT LOFTS
 NEWBURY/HANCOCK STREET
 PORTLAND, MAINE
 FOR:
 113 NEWBURY STREET, LLC
 35 FAY STREET, SUITE 107B
 BOSTON, MA 02118-4320

DATE	SCALE
07-26-13	AS SHOWN

SHEET 6 OF 12

13251P.dwg, TAB.P