

NOTES:
 1. STORM DRAIN SHALL BE SMOOTH BORE ADS N-12 DUAL-WALLED, HIGH DENSITY POLYETHYLENE PIPE OR EQUAL WITHIN SITE LIMITS.
 2. STORM DRAIN SHALL BE SDR-35 PVC PIPE WITHIN CITY RIGHT-OF-WAYS.

LEGEND

EXISTING	DESCRIPTION	PROPOSED	EXISTING	DESCRIPTION	PROPOSED
---	BOUNDARY LINE/ROW	---	W	WATER GATE VALVE	W
---	ABUTTER LINE/ROW	---	W	WATER SHUT OFF	W
---	BUILDING	---	W	HYDRANT	W
---	EDGE PAVEMENT	---	W	SEWER MH	W
---	EDGE CONCRETE	---	W	STORM DRAIN	W
---	CURBLINE	---	W	ROOF DRAIN	W
---	CONTOURS	---	W	CATCH BASIN	W
---	SPOT GRADE	---	W	DRAINAGE MH	W
---	SIDEWALK SLOPE	---	W	OVERHEAD UTILITY	W
---	SCREEN FENCING	---	W	UNDERGROUND UTILITY	W
---	RETAINING WALL	---	W	TRANSFORMER PAD	W
---	DECIDUOUS TREE	---	W	ELECTRICAL MANHOLE	W
---	CONIFEROUS TREE	---	W	LIGHT POLE/WALL	W
---	GAS	---	W	UTILITY POLE	W
---	WATER	---	W	GUT	W

MATCHLINE RIGHT

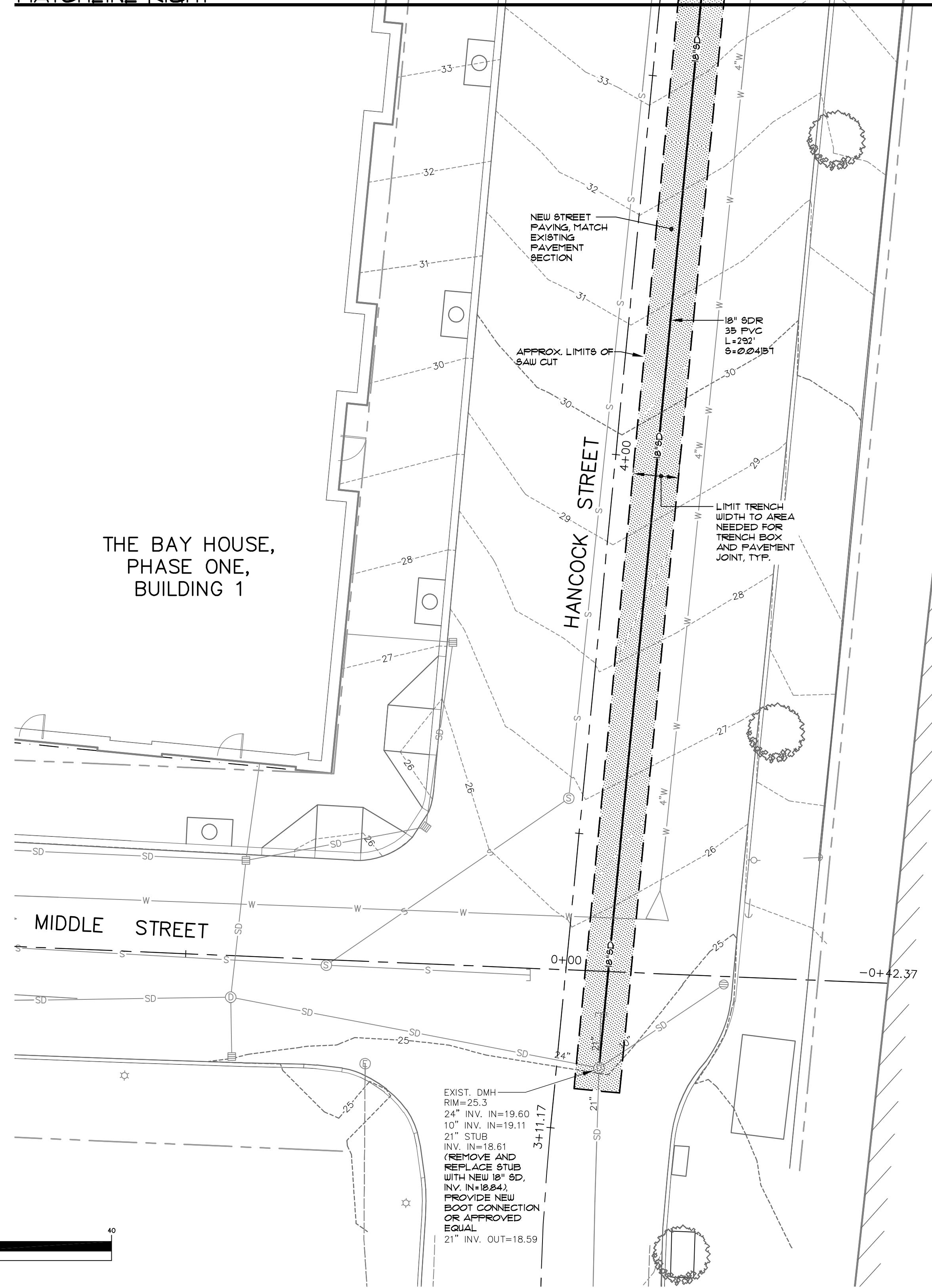

GRAPHIC SCALE

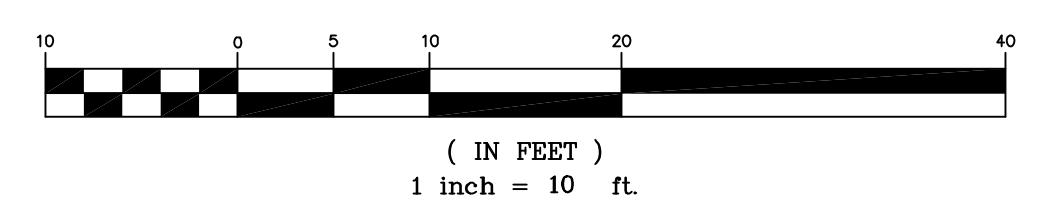

MATCHLINE LEFT

THE BAY HOUSE,
PHASE ONE,
BUILDING 1

THE BAY HOUSE,
PHASE ONE,
BUILDING 1

13251.GLU.dwg, TAB:GLU2

SEBAGO TECHNICALS
 WWW.SEBAGOTECHNICALS.COM
 75 John Roberts Rd., Suite 1A, South Portland, ME 04240
 Tel: 207-262-2100 Fax: 207-782-8868

PROJECT NO. 13251 FIELD BOOK DESIGN CHKD DRAWN
 WTC WTC WTC WTC WTC MAL

OFF-SITE DRAINAGE PLAN
 OF: SEAPORT LOFTS
 NEWBURY/HANCOCK STREET
 PORTLAND, MAINE
 FOR: 113 NEWBURY STREET, LLC
 35 FAY STREET, SUITE 107B
 BOSTON, MA 02118-4320

DATE: 07-26-13 SCALE: 1" = 10'

PRICING SET 1 AUGUST 6, 2014
 ADDRESS COMMENTS PER WILLIAM CLARKE E-MAIL DATED 07-10-14
 CITY SUBMITTAL 8
 FOUNDATION PERMIT SET
 CITY SUBMITTAL 7
 CITY SUBMITTAL 6
 CITY SUBMITTAL 5
 DATE: 10-03-13
 BY: WTC
 THIS PLAN SHALL NOT BE MODIFIED WITHOUT WRITTEN PERMISSION FROM SEBAGO TECHNICALS, INC. ANY ALTERATIONS AUTHORIZED OR OTHERWISE, SHALL BE AT THE USER'S SOLE RISK AND WITHOUT LIABILITY TO SEBAGO TECHNICALS, INC.

SHEET 5 OF 12