

**PROFILE: HANCOCK STREET**  
 STA. 3+11.17 TO STA. 6+15  
 SCALE: 1"=30' HORIZ.  
 1"=3' VERT.

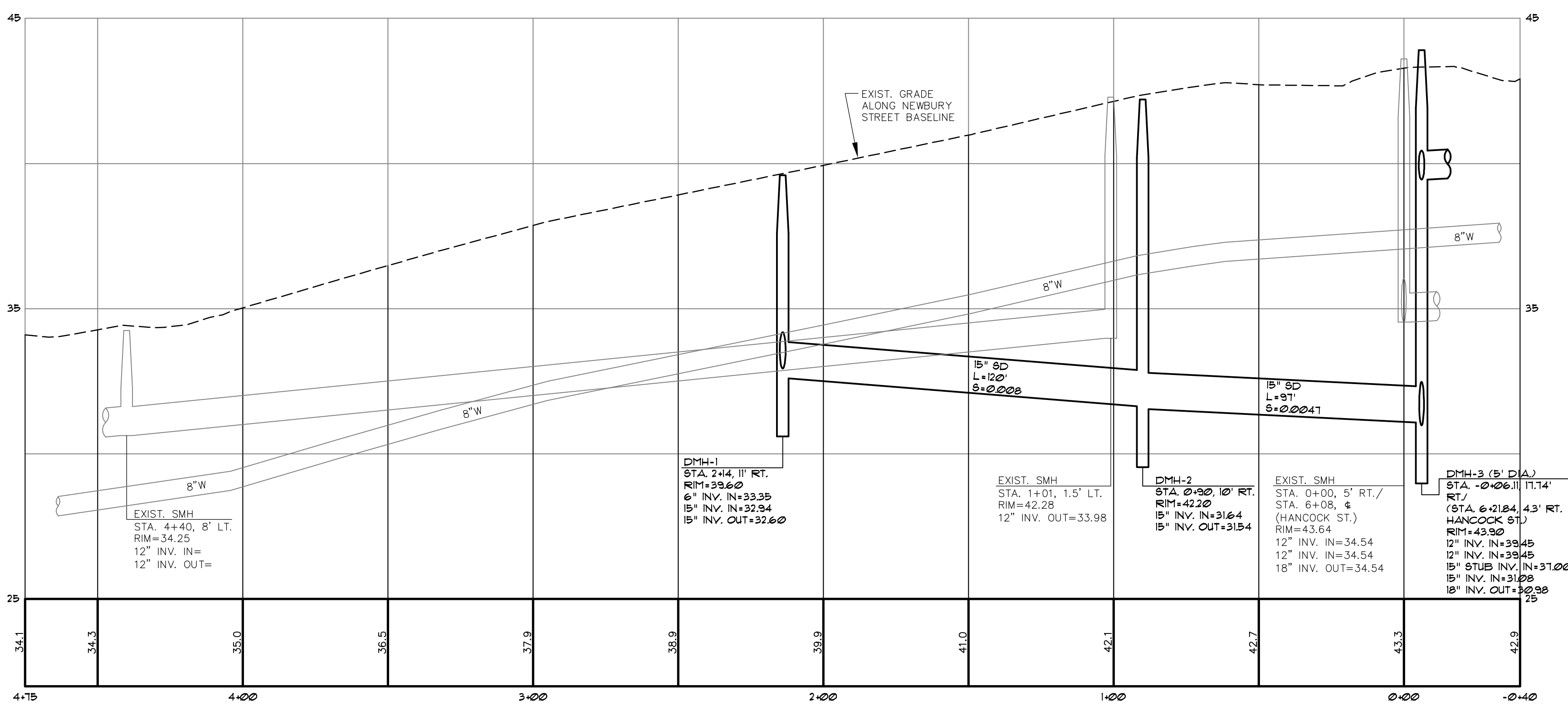

**PROFILE: NEWBURY STREET**  
 STA. 0+40 TO STA. 4+75  
 SCALE: 1"=30' HORIZ.  
 1"=3' VERT.

WTC	12-31-14	MISCELLANEOUS REVISIONS
L	12-08-14	MISCELLANEOUS REVISIONS
K	11-18-14	REVISED SITE LIGHTING / ISSUE CK-02
J	09-10-14	ISSUE CK-01
I	08-06-14	PRICING SET 1 AUGUST 6, 2014
H	07-22-14	ADDRESS COMMENTS PER WILLIAM CLARKE E-MAIL DATED 07-10-14
G	06-20-14	CITY SUBMITTAL 8
REV:	BY:	DATE:

**SEBAGO TECHNICALS**  
 WWW.SEAGOTECHNICALS.COM  
 75 John Roberts Rd., Suite 1A  
 South Portland, ME 04240  
 Tel: 207-783-5868

PROJECT NO.	13251
FIELD BOOK	
DESIGN	WTC
CHKD	WTC
DRAWN	MAL

**PROFILE: HANCOCK ST. AND NEWBURY ST.**  
 OF:  
**SEAPORT LOFTS**  
 NEWBURY / HANCOCK STREET  
 PORTLAND, MAINE  
 FOR:  
**113 NEWBURY STREET, LLC**  
 35 FAY STREET, SUITE 107B  
 BOSTON, MA 02118-4320

DATE	SCALE
07-26-13	AS SHOWN

**SHEET 6 OF 12**

THIS PLAN SHALL NOT BE MODIFIED WITHOUT WRITTEN PERMISSION FROM SEBAGO TECHNICALS, INC. ANY ALTERATIONS, AUTHORIZED OR OTHERWISE, SHALL BE AT THE USER'S SOLE RISK AND WITHOUT LIABILITY TO SEBAGO TECHNICALS, INC.

13251P.dwg, TAB:P