

NOTES:
 1. STORM DRAIN SHALL BE SMOOTH BORE ADS-N-12 DUAL-WALLED, HIGH DENSITY POLYETHYLENE PIPE OR EQUAL WITHIN SITE LIMITS.
 2. STORM DRAIN SHALL BE SDR-35 PVC PIPE WITHIN CITY RIGHT-OF-WAYS.

LEGEND

EXISTING	DESCRIPTION	PROPOSED	EXISTING	DESCRIPTION	PROPOSED
---	BOUNDARY LINE/ROW	---	⊗	WATER GATE VALVE	⊗
---	ABUTTER LINE/ROW	---	⊕	WATER SHUT OFF	⊕
---	SETBACK	---	⊖	HYDRANT	⊖
---	BUILDING	---	⊙	SEWER MH	⊙
---	SIGN	---	⊚	STORM DRAIN	⊚
---	EDGE PAVEMENT	---	⊛	ROOF DRAIN	⊛
---	EDGE CONCRETE	---	⊜	CATCH BASIN	⊜
---	CURBLINE	---	⊝	DRAINAGE MH	⊝
---	CONTOURS	---	⊞	OVERHEAD UTILITY	⊞
---	SPOT GRADE	---	⊟	UNDERGROUND UTILITY	⊟
---	SIDEWALK SLOPE	---	⊠	TRANSFORMER PAD	⊠
---	SCREEN FENCING	---	⊡	ELECTRICAL MANHOLE	⊡
---	RETAINING WALL	---	⊢	LIGHT POLE/WALL	⊢
---	DECIDUOUS TREE	---	⊣	UTILITY POLE	⊣
---	CONIFEROUS TREE	---	⊤	GUT	⊤
---	GAS	---			
---	WATER	---			

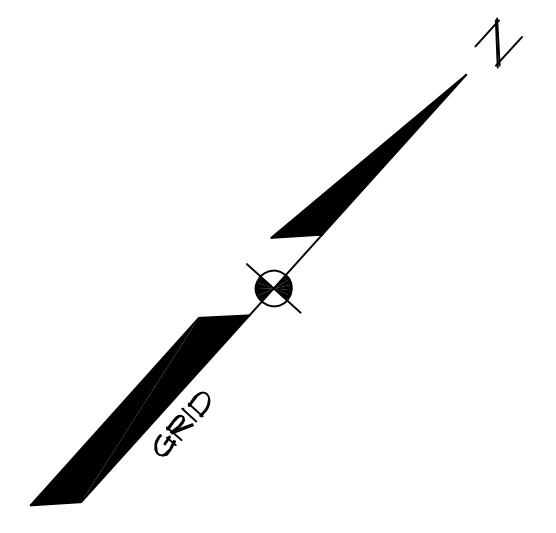

MATCHLINE RIGHT

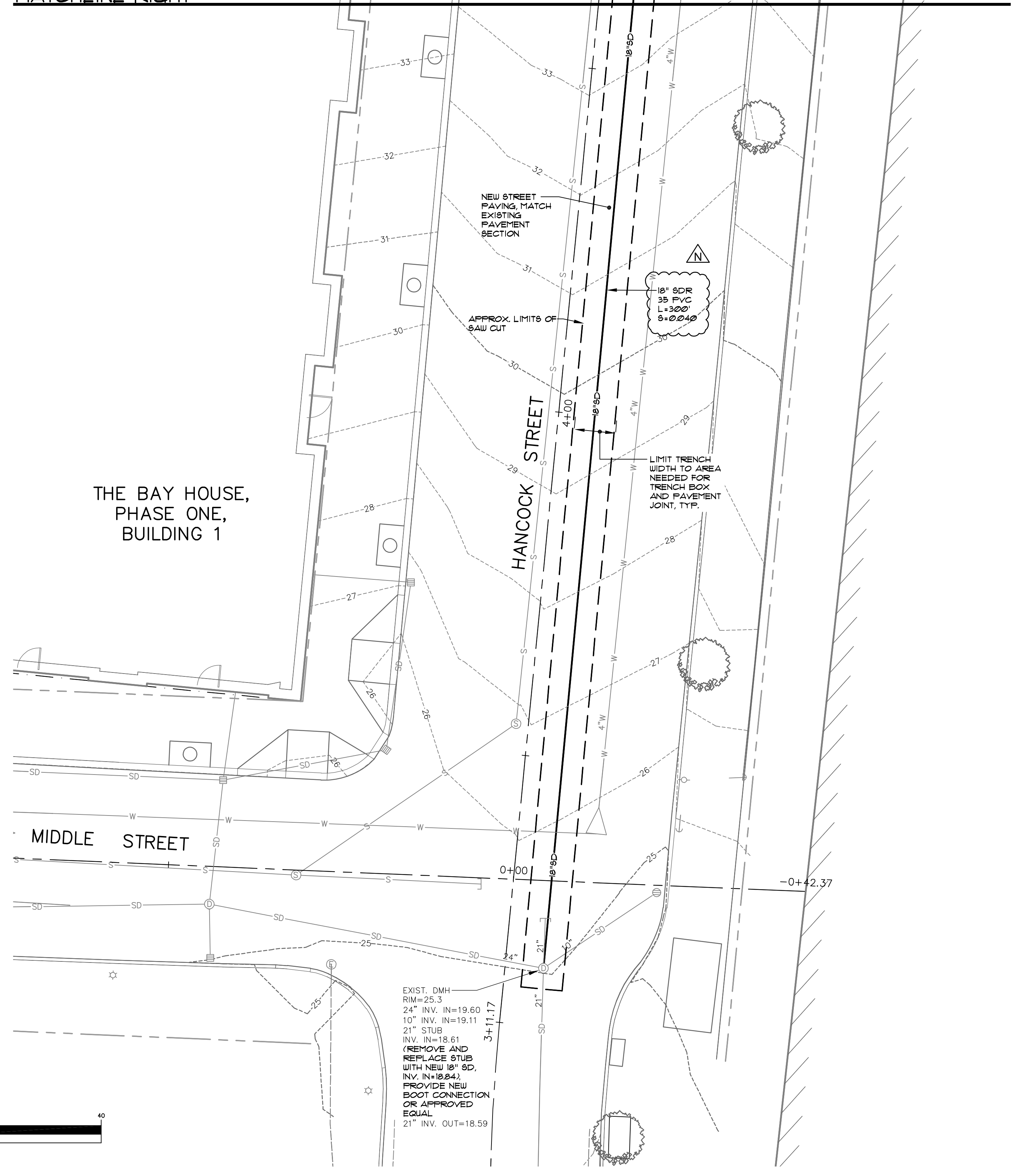
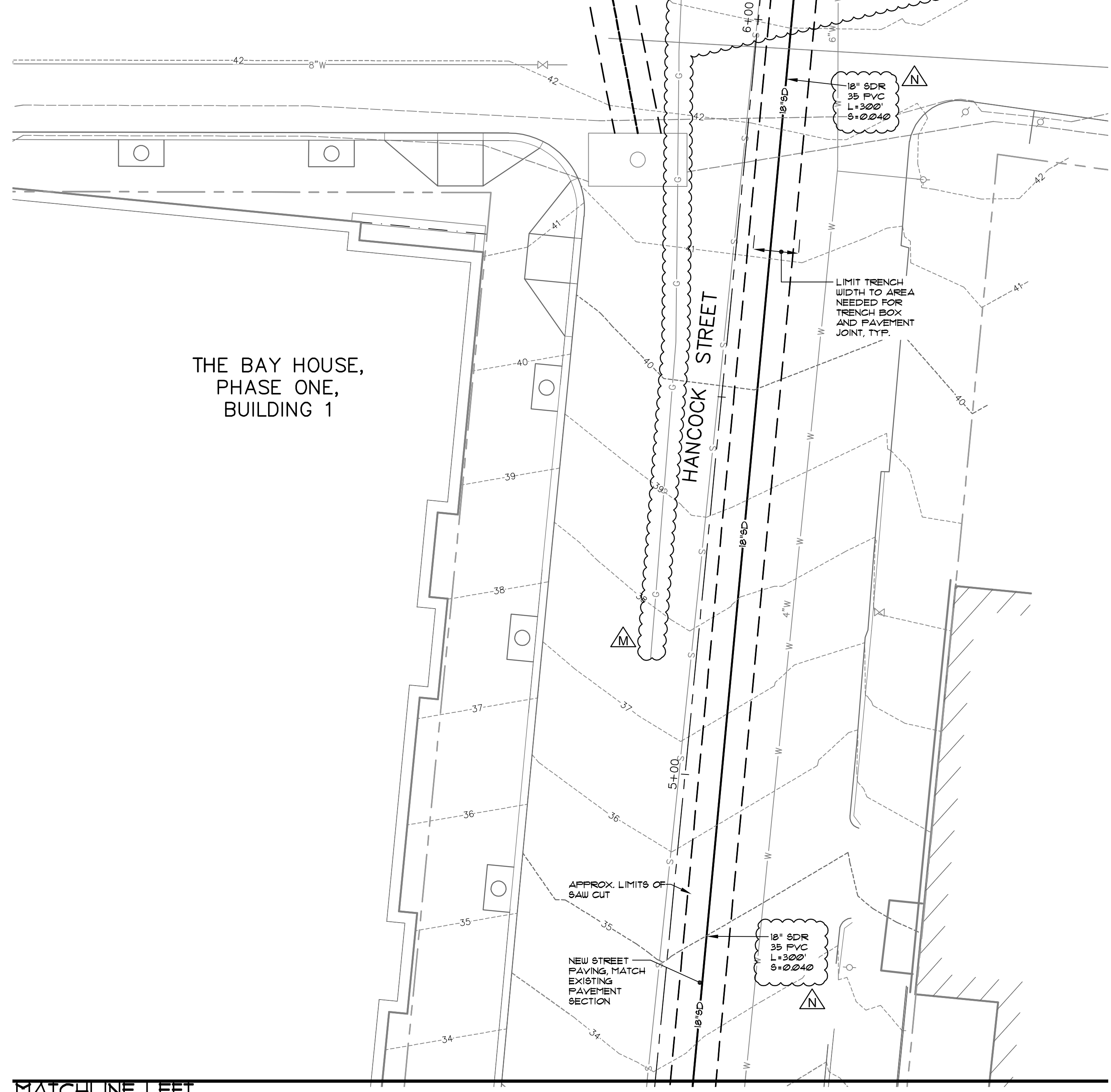

MATCHLINE LEFT

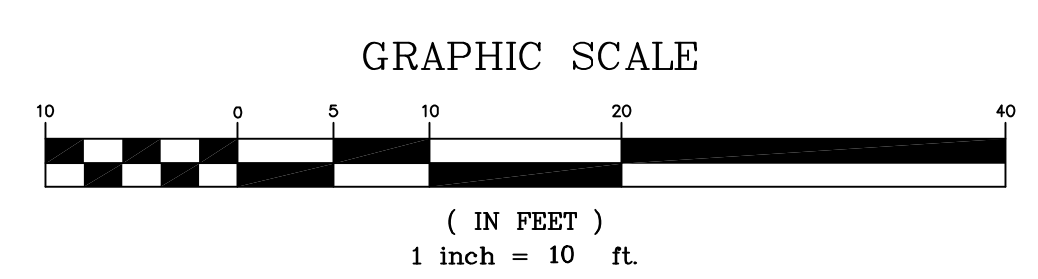

WTC	DATE	DESCRIPTION
WTC	12-31-14	MISCELLANEOUS REVISIONS
WTC	12-08-14	MISCELLANEOUS REVISIONS
WTC	11-18-14	REVISED SITE LIGHTING / ISSUE CK-02
WTC	09-10-14	ISSUE CK-01
WTC	08-06-14	PRICING SET 1 AUGUST 6, 2014
WTC	07-22-14	ADDRESS COMMENTS PER WILLIAM CLARKE E-MAIL DATED 07-10-14
WTC	06-20-14	CITY SUBMITTAL 8
REV:	DATE:	STATUS:

THIS PLAN SHALL NOT BE MODIFIED WITHOUT WRITTEN PERMISSION FROM SEBAGO TECHNIQS, INC. ANY ALTERATIONS AUTHORIZED OR OTHERWISE, SHALL BE AT THE USER'S SOLE RISK AND WITHOUT LIABILITY TO SEBAGO TECHNIQS, INC.

SEBAGO
 TECHNICALS
 WWW.SEAGOTECHNIQS.COM
 75 John Roberts Rd., Suite 1A, Lewiston, ME 04240
 South Portland, ME 04106
 Tel: 207-262-2100
 Fax: 207-783-5868

PROJECT NO.	FIELD BOOK	DESIGN	CHKD	DRAWN
13251		WTC	WTC	MAL

OFF-SITE DRAINAGE PLAN
 OF:
 SEAPORT LOFTS
 NEWBURY / HANCOCK STREET
 PORTLAND, MAINE
 FOR:
 113 NEWBURY STREET, LLC
 35 FAY STREET, SUITE 107B
 BOSTON, MA 02118-4320

DATE	SCALE
07-26-13	1" = 10'

SHEET 5 OF 12

13251.GLU.dwg, TAB:GLU2