

**LEGEND**

EXISTING	DESCRIPTION	PROPOSED	EXISTING	DESCRIPTION	PROPOSED
---	BOUNDARY LINE/ROW	---	---	WATER GATE VALVE	---
---	ABUTTER LINE/ROW	---	---	WATER SHUT OFF	---
---	SETBACK	---	---	HYDRANT	---
---	BUILDING	---	---	SEWER	---
---	SIGN	---	---	SEWER MH	---
---	EDGE PAVEMENT	---	---	STORM DRAIN	---
---	EDGE CONCRETE	---	---	ROOF DRAIN	---
---	CURLINE	---	---	CATCH BASIN	---
---	CONTOUR	---	---	DRAINAGE MH	---
---	SPOT GRADE	---	---	OVERHEAD UTILITY	---
---	SIDEWALK SLOPE	---	---	UNDERGROUND UTILITY	---
---	SCREEN FENCING	---	---	TRANSFORMER PAD	---
---	RETAINING WALL	---	---	ELECTRICAL MANHOLE	---
---	DECIDUOUS TREE	---	---	LIGHT POLE/WALL	---
---	CONIFEROUS TREE	---	---	UTILITY POLE	---
---	GAS	---	---	GUT	---
---	WATER	---	---		

**NOTES:**

- STORM DRAIN SHALL BE SMOOTH BORE ADS N-12 DUAL-WALLED, HIGH DENSITY POLYETHYLENE PIPE OR EQUAL WITHIN SITE LIMITS.
- STORM DRAIN SHALL BE SDR-35 PVC PIPE WITHIN CITY RIGHT-OF-WAYS.
- ROOF DRAINS (RD) SHALL BE SCH. 40 PVC.
- WHERE FOOTING DRAINS EXIT BUILDING, PROVIDE 6" SCH. 40 PVC OUTLET AND BACKFLOW PREVENTER IN NEWBURY STREET. COORDINATE LOCATION WITH CITY INSPECTOR.

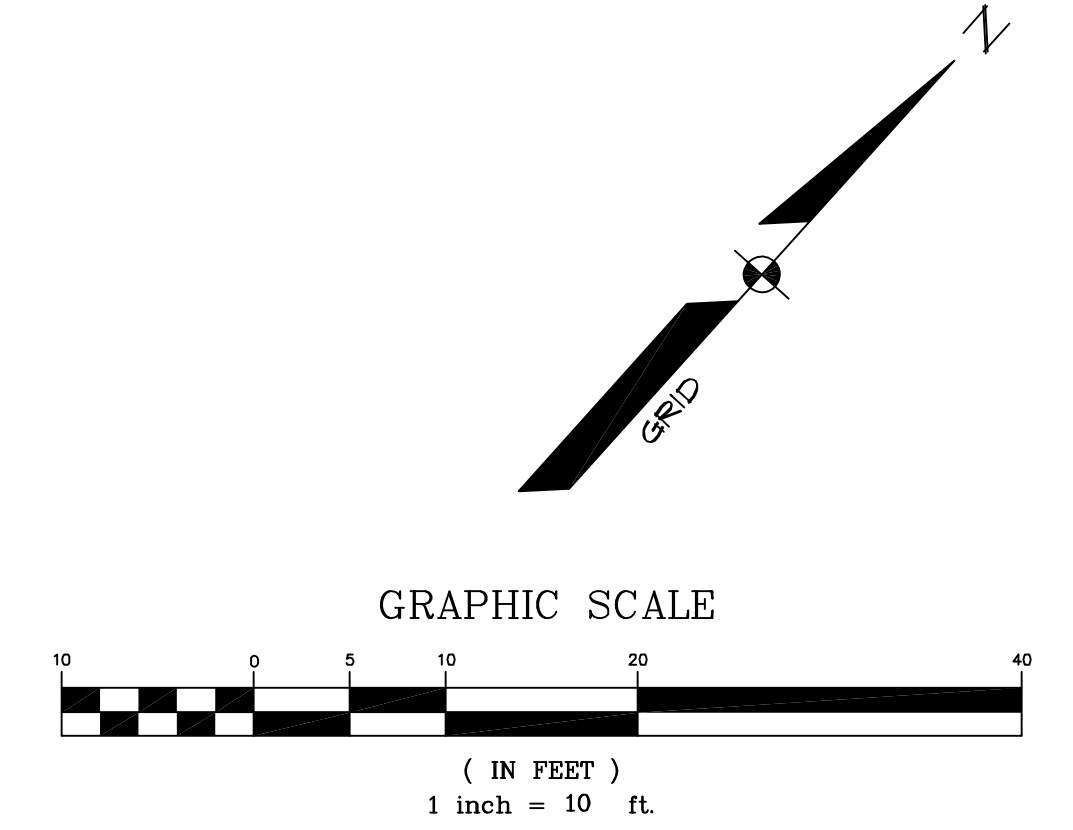

**SEBAGO TECHNICALS**  
 WWW.SEBAGOTECHNICALS.COM  
 75 John Roberts Rd., Suite 1A, South Portland, ME 04240  
 Tel: 207-782-2100

**GRADING AND UTILITY PLAN**  
 OF:  
**SEAPORT LOFTS**  
 NEWBURY/HANCOCK STREET  
 PORTLAND, MAINE  
 FOR:  
**113 NEWBURY STREET, LLC**  
 35 FAY STREET, SUITE 107B  
 BOSTON, MA 02118-4320

PROJECT NO. 13251 FIELD BOOK DESIGN CHK'D DRAWN  
 WTC WTC WTC WTC WTC MAL

MISCELLANEOUS REVISIONS  
 WTC 12-31-14  
 WTC 12-08-14  
 WTC 11-18-14  
 WTC 09-10-14  
 WTC 08-05-14  
 WTC 07-22-14  
 WTC 06-20-14  
 REV: BY: DATE: STATUS:

MISCELLANEOUS REVISIONS  
 WTC 12-31-14  
 WTC 12-08-14  
 WTC 11-18-14  
 WTC 09-10-14  
 WTC 08-05-14  
 WTC 07-22-14  
 WTC 06-20-14  
 REV: BY: DATE: STATUS:

13251.GLU.dwg, TAB:GUT

DATE 07-26-13 SCALE 1" = 10'

SHEET 4 OF 12