

PROFILE: HANCOCK STREET
STA. 3+11.7 TO STA. 6+75
SCALE: 1"=30' HORIZ.
1"=3' VERT.

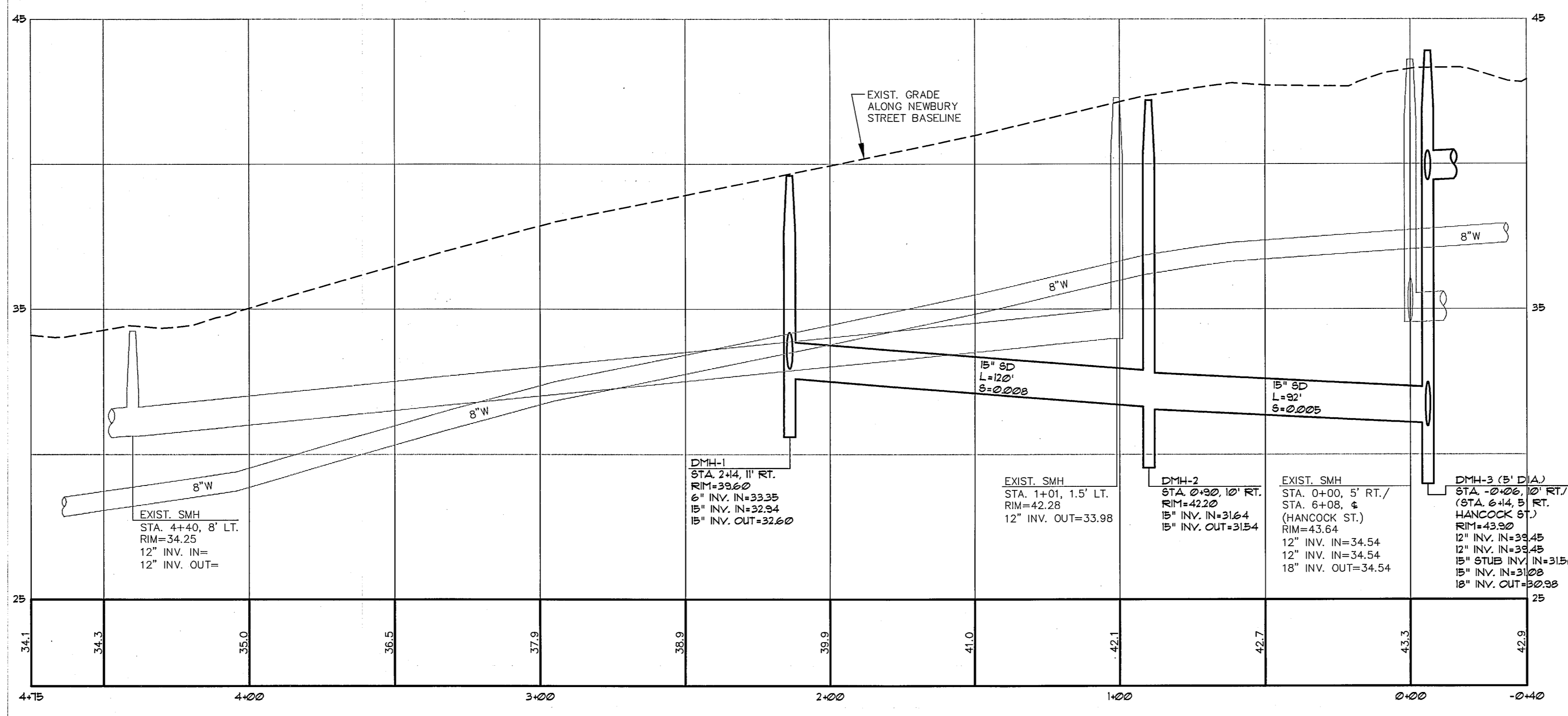

PROFILE: NEWBURY STREET
STA. 0+40 TO STA. 4+75
SCALE: 1"=30' HORIZ.
1"=3' VERT.

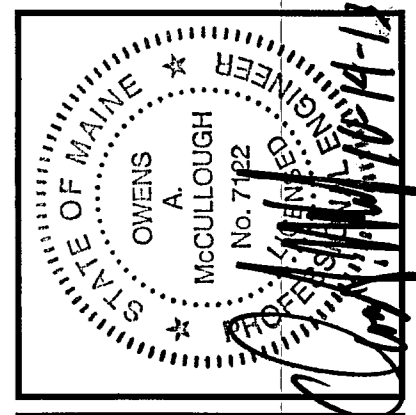

WTC	10-15-13	CITY SUBMITTAL 6
WTC	10-03-13	CITY SUBMITTAL 5
WTC	09-17-13	CITY SUBMITTAL 4
WTC	09-03-13	CITY SUBMITTAL 3
WTC	07-29-13	SUBMIT SITE PLAN APPLICATION TO CITY
REV:	BY:	DATE:
A		
B		
C		
D		
E		

STATUS: **11-14-13**

THIS PLAN SHALL NOT BE MODIFIED WITHOUT WRITTEN PERMISSION FROM SEBAGO TECHNICS, INC. ANY ALTERATIONS AUTHORIZED OR OTHERWISE, SHALL BE AT THE USER'S SOLE RISK AND WITHOUT LIABILITY TO SEBAGO TECHNICS, INC.

SEBAGO TECHNICS
WWW.SEBAGOTECHNICS.COM
75 Ash Street, Suite B
Portland, ME 04108
Tel: 207-783-6666

PROJECT NO. | FIELD BOOK | DESIGN | CHKD | DRAWN | MAL

13251 | | | | |

PROFILE: HANCOCK ST. AND NEWBURY ST.
OF:
SEAPORT LOFTS
NEWBURY / HANCOCK STREET
PORTLAND, MAINE
FOR:
113 NEWBURY STREET, LLC
38 FAY STREET, SUITE 107B
BOSTON, MA 02116-4520

DATE	SCALE
07-26-13	AS SHOWN