

NOTES:
 1. STORM DRAIN SHALL BE SMOOTH BORE ADS N-15 DUAL-WALLED, HIGH DENSITY POLYETHYLENE PIPE OR EQUAL WITHIN SITE LIMITS.
 2. STORM DRAIN SHALL BE SDR-35 PVC PIPE WITHIN CITY RIGHT-OF-WAYS.

LEGEND

EXISTING	DESCRIPTION	PROPOSED	EXISTING	DESCRIPTION	PROPOSED
---	BOUNDARY LINE/ROW	---	W	WATER GATE VALVE	W
---	SEWER LINE/ROW	---	W	WATER SHUT OFF	W
---	SETBACK	---	W	HYDRANT	W
---	BUILDING	---	W	SEWER	W
---	SIGN	---	W	SEWER MH	W
---	EDGE PAVEMENT	---	W	STORM DRAIN	W
---	EDGE CONCRETE	---	W	ROOF DRAIN	W
---	CURBLINE	---	W	CATCH BASIN	W
---	CONTOURS	---	W	DRAINAGE MH	W
---	SPOT GRADE	---	W	OVERHEAD UTILITY	W
---	SIDEWALK SLOPE	---	W	UNDERGROUND UTILITY	W
---	SCREEN FENCING	---	W	TRANSFORMER PAD	W
---	RETAINING WALL	---	W	ELECTRICAL MANHOLE	W
---	DECIDUOUS TREE	---	W	LIGHT POLE/WALL	W
---	CONIFEROUS TREE	---	W	UTILITY POLE	W
---	GAS	---	W	GUY	W
---	WATER	---	W		W

MATCHLINE RIGHT

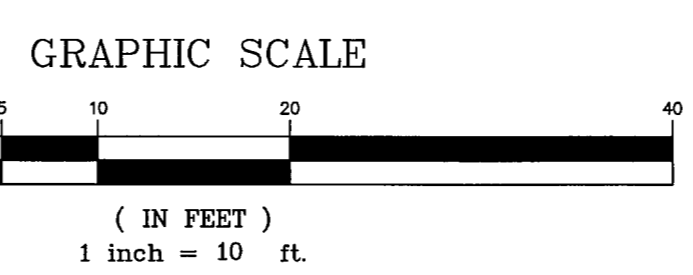
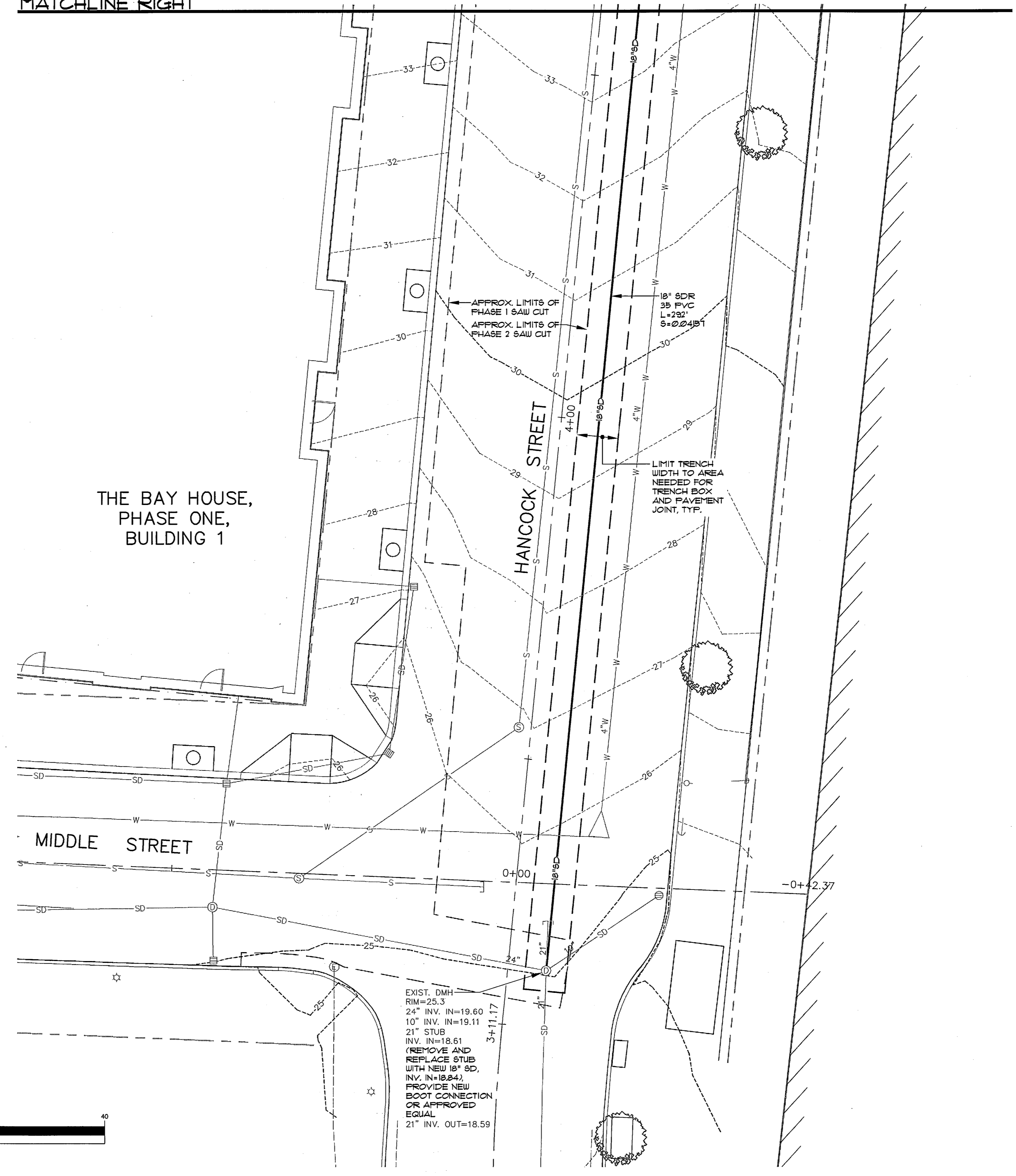

MATCHLINE LEFT

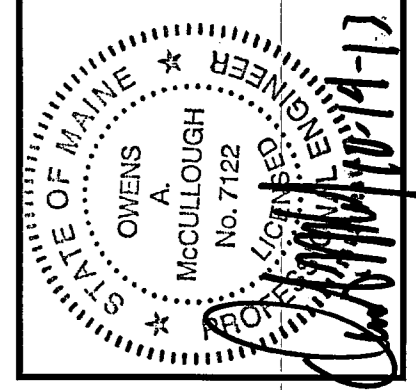

REV:	BY:	DATE:	STATUS:
A	WTC	07-28-13	SUBMIT SITE PLAN APPLICATION TO CITY
B	WTC	09-03-13	CITY SUBMITTAL 3
C	WTC	09-17-13	CITY SUBMITTAL 4
D	WTC	10-08-13	CITY SUBMITTAL 5
E	WTC	10-15-13	CITY SUBMITTAL 6

SEBAGO TECHNICALS
 WWW.SEBAGOTECHNICALS.COM
 74 Park Road, Portland, ME 04106
 Tel: 207-200-2100 Fax: 207-783-6666

PROJECT NO. 13251
 FIELD BOOK DESIGN CHKD DRAWN
 WTC WTC MAL

OFF-SITE DRAINAGE PLAN
 OF: SEAPORT LOFTS
 NEWBURY/HANCOCK STREET
 PORTLAND, MAINE
 FOR: 113 NEWBURY STREET, LLC
 55 NEWBURY STREET, SUITE 107/5
 BOSTON, MA 02118-4920

DATE: 07-28-13 SCALE: 1" = 10'

SHEET 7 OF 14