

- NOTES:**
1. PROVIDE SIMPSON JOIST HANGERS AT ALL JOIST ENDS, TYP.
 2. WINDOW HEADERS SHALL BE (2)-2x8's, U.N.O. SEE TYP. HEADER DETAIL X/SX.X
 3. PROVIDE (3)-2x6's AT ALL COLUMNS AND CORNERS, U.N.O.
 4. SEE S3.1 & S3.2 FOR FRAMING ELEVATIONS

ROOF FRAMING PLAN

SCALE: 1/4"=1'-0" 1

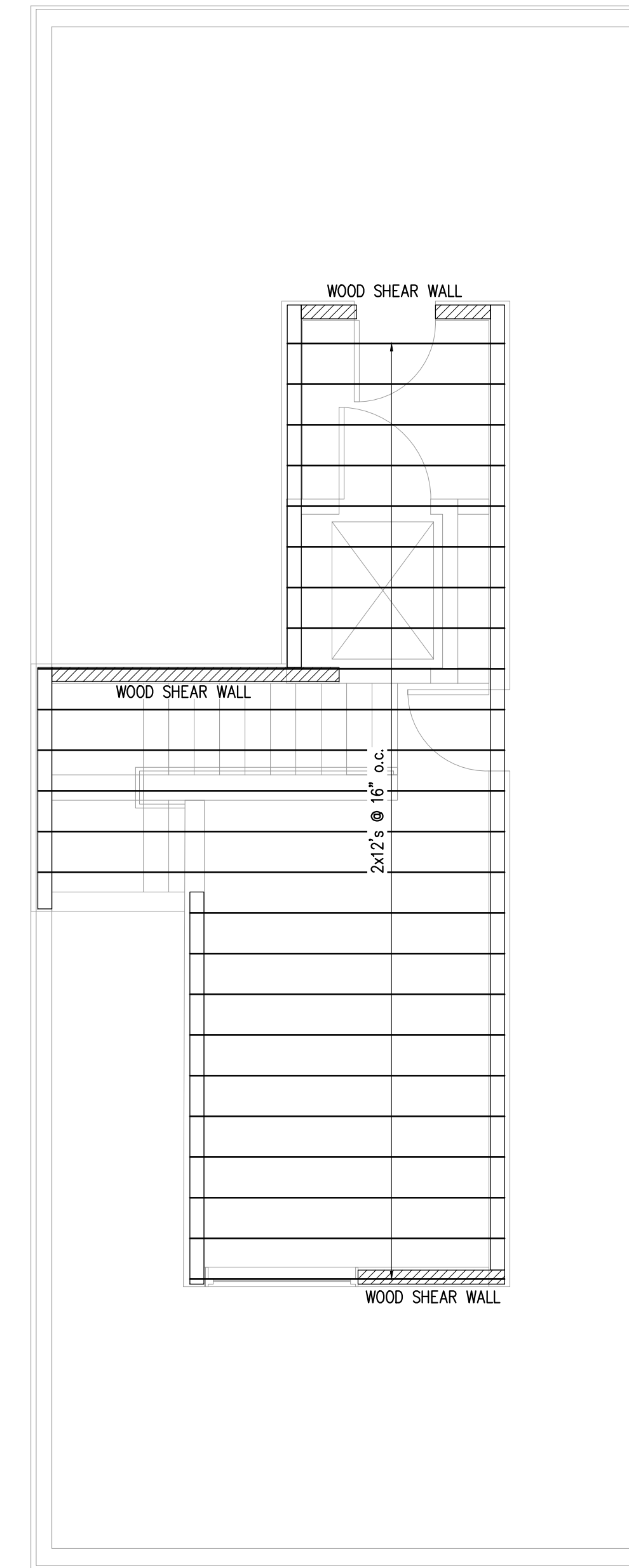

- NOTES:**
1. PROVIDE SIMPSON JOIST HANGERS AT ALL JOIST ENDS, TYP.
 2. WINDOW HEADERS SHALL BE (2)-2x8's, U.N.O. SEE TYP. HEADER DETAIL X/SX.X
 3. PROVIDE (3)-2x6's AT ALL COLUMNS AND CORNERS, U.N.O.
 - 4.

TOWER ROOF FRAMING PLAN

SCALE: 1/4"=1'-0" 2

PLAN LEGEND

- BEARING WALL
- SHEAR WALL
- BEAM
- HSS COLUMN
- COLUMN FROM ABOVE
- COLUMN BELOW
- COLUMN ABOVE AND BELOW
- HOLD-DOWN

CASCO BAY ENGINEERING
 424 Fore Street
 Portland, ME 04101
 Phone 207.842.2800
 Fax 207.842.2828
 www.cascobayengineering.com

CLIENT:
SUNNY TIME SOLAR LLC
 PO BOX 15372
 PORTLAND, ME 04101

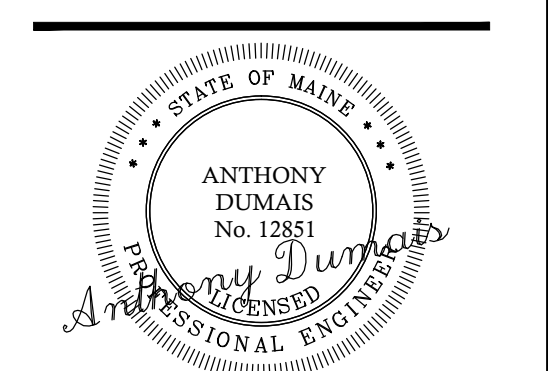

THE HAWK
 48 HANCOCK STREET
 PORTLAND, MAINE
 NEW BUILDING

PRELIMINARY
NOT FOR CONSTRUCTION

No.	DESCRIPTION	ISSUED		DATE	
		DR.	CHK.	BY	TD
A	ISSUE FOR PERMIT - NOT FOR CONSTRUCTION	TD	TD	TD	12-29-14

SHEET TITLE:
ROOF FRAMING PLANS

DESIGNED: TD
 DRAWN: TD
 DATE: 11-13-14
 PROJECT NUMBER: 14-135

S1.3