

- NOTES:**
1. PROVIDE SIMPSON JOIST HANGERS AT ALL JOIST ENDS, TYP.
 2. WINDOW HEADERS SHALL BE (2)-2x8's, U.N.O. SEE TYP. HEADER DETAIL X/SX.X
 3. PROVIDE (3)-2x6's AT ALL COLUMNS AND CORNERS, U.N.O.
 4. SEE S3.1 & S3.2 FOR FRAMING ELEVATIONS

THIRD FLOOR FRAMING PLAN

SCALE: 1/4"=1'-0"

1

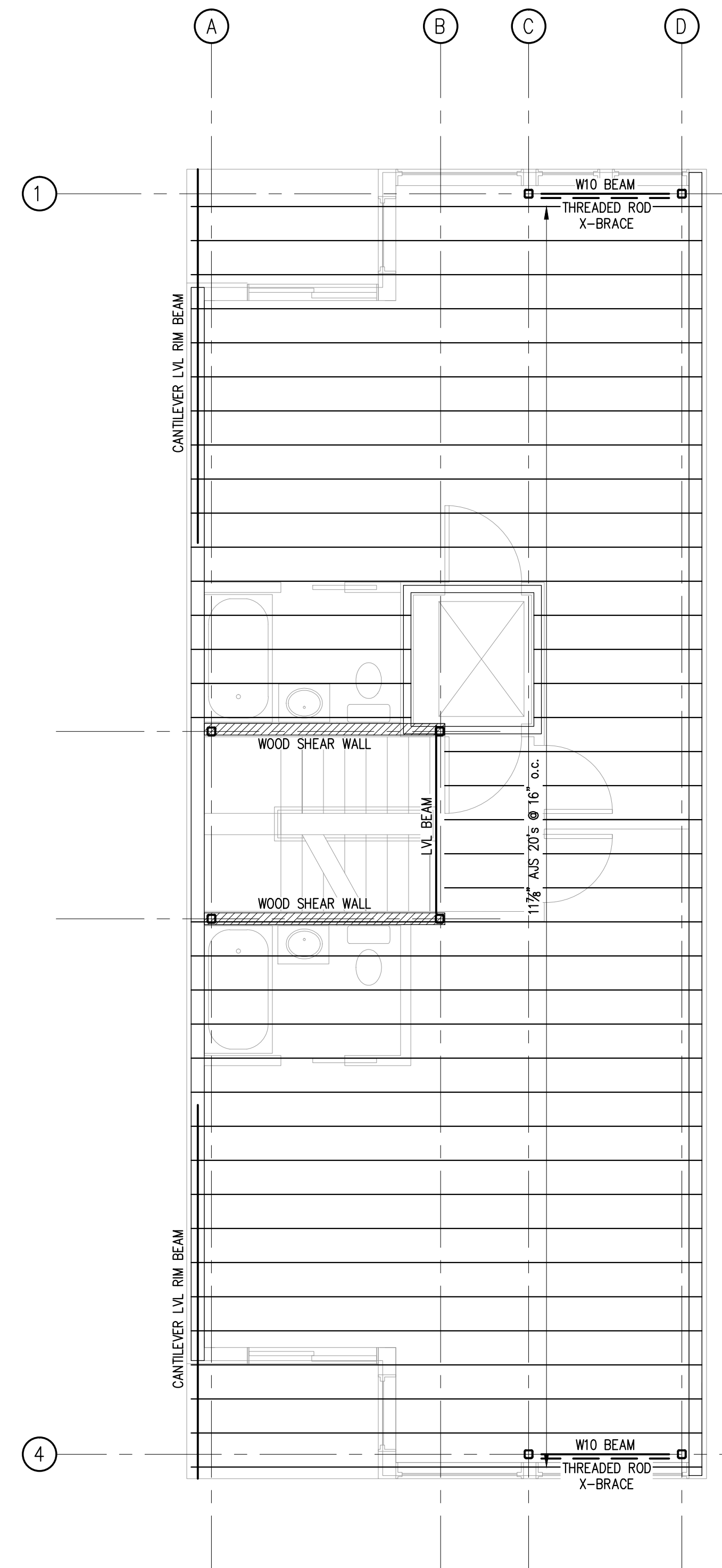

- NOTES:**
1. PROVIDE SIMPSON JOIST HANGERS AT ALL JOIST ENDS, TYP.
 2. WINDOW HEADERS SHALL BE (2)-2x8's, U.N.O. SEE TYP. HEADER DETAIL X/SX.X
 3. PROVIDE (3)-2x6's AT ALL COLUMNS AND CORNERS, U.N.O.
 4. SEE S3.1 & S3.2 FOR FRAMING ELEVATIONS

FOURTH FLOOR FRAMING PLAN

SCALE: 1/4"=1'-0"

2

PLAN LEGEND

- BEARING WALL
- SHEAR WALL
- BEAM
- HSS COLUMN
- COLUMN FROM ABOVE
- COLUMN BELOW
- COLUMN ABOVE AND BELOW
- HOLD-DOWN

CASCO BAY ENGINEERING
 424 Fore Street
 Portland, ME 04101
 Phone 207.842.2800
 Fax 207.842.2828
 www.cascobayengineering.com

CLIENT:
SUNNY TIME SOLAR LLC
 PO BOX 15372
 PORTLAND, ME 04101

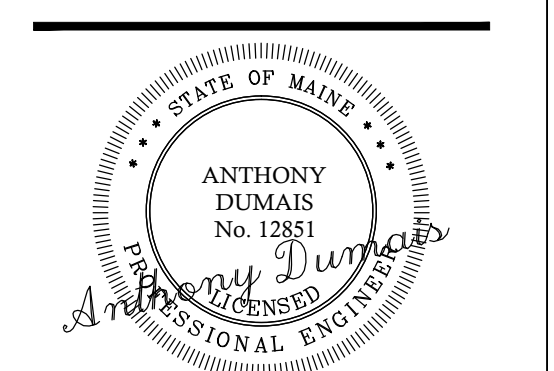

THE HAWK
 48 HANCOCK STREET
 PORTLAND, MAINE
 NEW BUILDING

**PRELIMINARY
 NOT FOR CONSTRUCTION**

No.	ISSUED DESCRIPTION	DR.		DATE	
		BY	TD	TD	TD
A	ISSUE FOR PERMIT - NOT FOR CONSTRUCTION				

SHEET TITLE:
THIRD AND FOURTH FLOOR FRAMING PLANS

DESIGNED: TD
 DRAWN: TD
 DATE: 11-13-14
 PROJECT NUMBER: 14-135

S1.2

PRINTED: Dec 31, 2014