

A STUDIO 6 - ENLARGED FLOOR PLAN
1/4" = 1'-0"

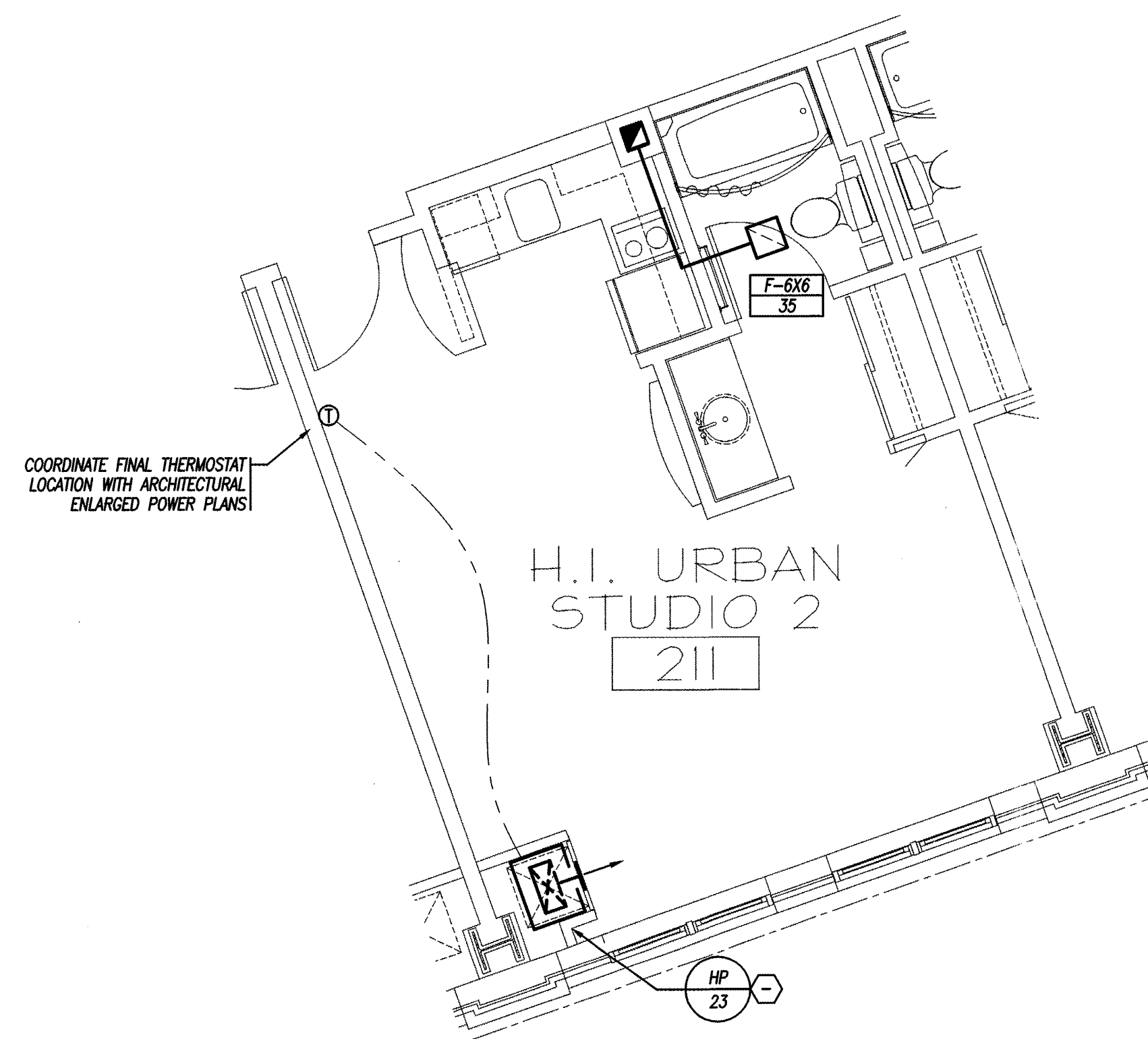

B H.I. URBAN STUDIO 2 - ENLARGED FLOOR PLAN
1/4" = 1'-0"

NOTES:
 1. ALL INTERIOR BEDROOM AND BATHROOM DOORS SHALL BE UNDERCUT 1" BY GENERAL CONTRACTOR.
 2. EACH GUEST ROOM SHALL BE PROVIDED WITH A RECIRCULATION RANGE HOOD PROVIDED BY OTHERS.

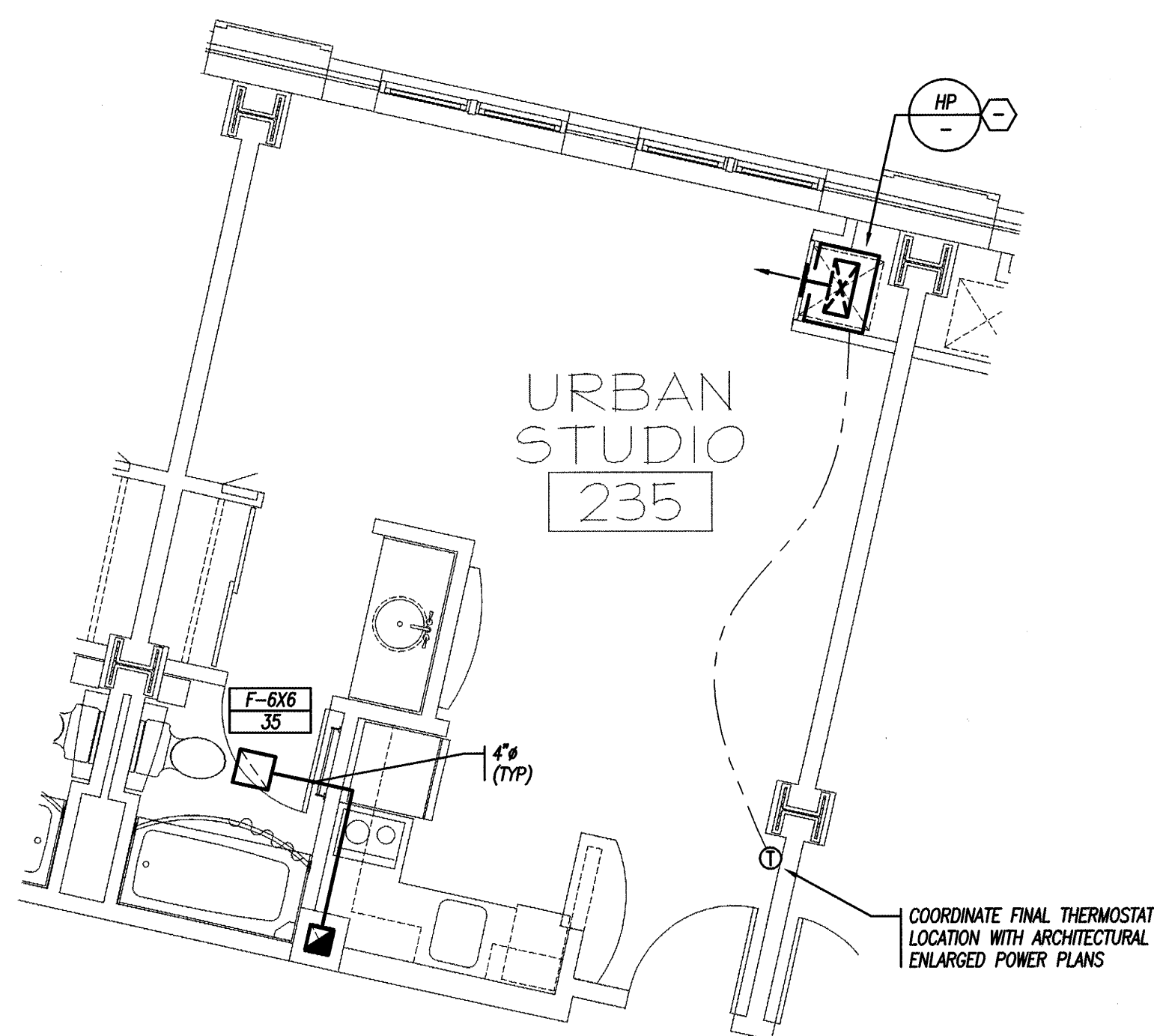

C URBAN STUDIO 1 - ENLARGED FLOOR PLAN
1/4" = 1'-0"

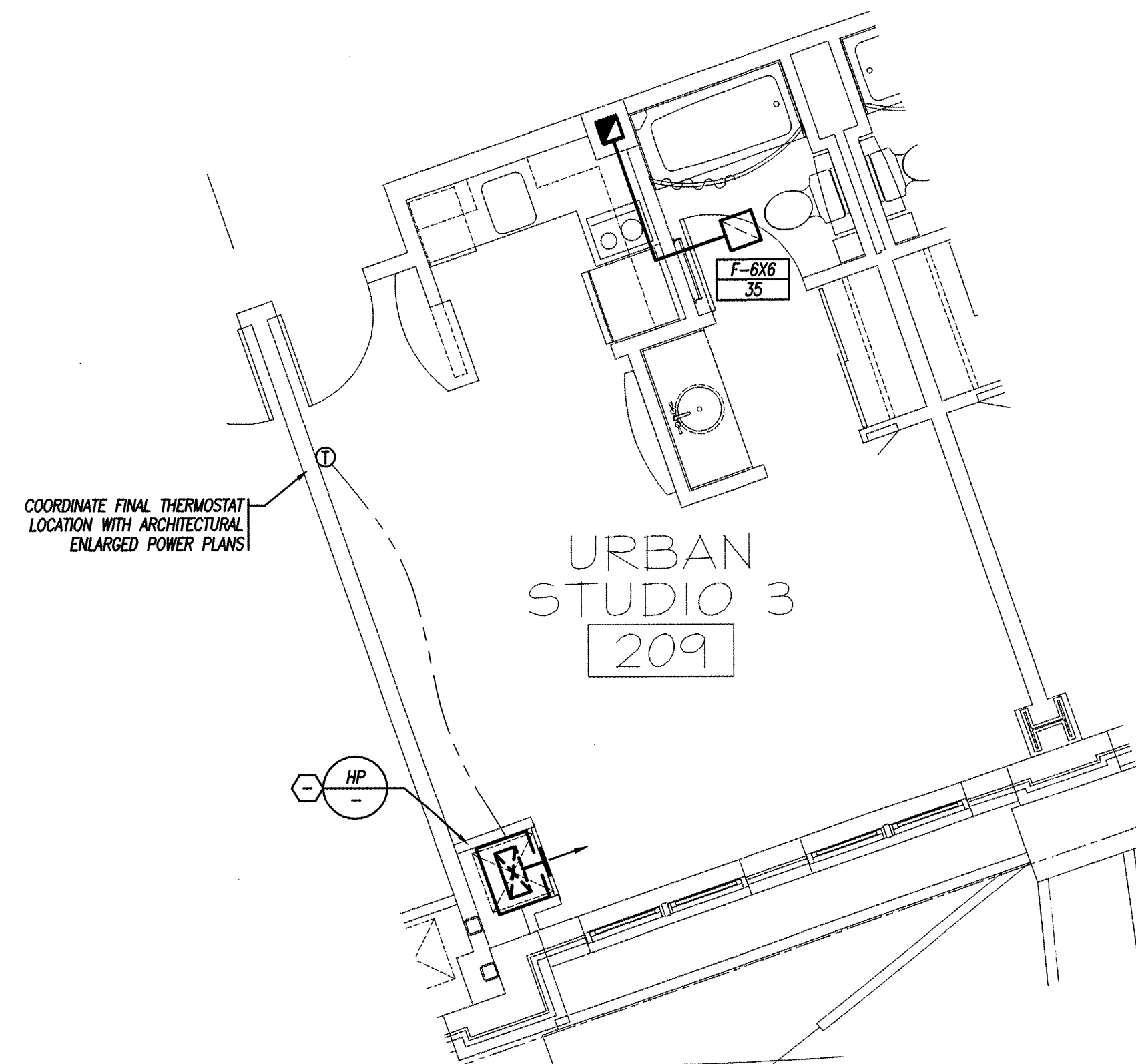

D URBAN STUDIO 3 - ENLARGED FLOOR PLAN
1/4" = 1'-0"

PERMIT ISSUE - 09/27/07

NO.	REVISION	DATE
SCALE: AS NOTED	DRAWN BY: SRO	
DATE: 09/27/07	CHECKED BY: JCL	

	<p>R. W. Sullivan Engineering HVAC, Electrical, Plumbing, Fire Protection, Code The Schroll Center 829 Main Street, Suite 200 Boston, Massachusetts 02129-1107 Phone: (617) 523-8227 Fax: (617) 523-8016 www.rwsusa.com RWS Job No. 2273.00</p>
--	---

PROJECT
RESIDENCE INN BY MARRIOTT
 PORTLAND, ME
 JOB# 802

TITLE
HVAC ENLARGED GUEST ROOM PLANS

GROUP ONE
 21 W. THIRD STREET, BOSTON, MA 02127
 TEL: (617) 268-7000 FAX: (617) 268-0209

DRAWING NO.
H1.23