

Residence Inn by Marriott

City of Portland Cumberland County, Maine

CODE REVIEW

A. Summary of the Work:

This project consists of a new five story hotel facility of steel and plank construction containing 179 guestrooms and assembly space (Meeting, and Breakfast Rooms, Swimming Pool) for the sole use of the hotel guests. The first floor also contains retail space. The entire building is sprinkled in accordance with NFPA-13.

- Construction Type: 2A
- Use Group: R-1: Hotel (Second thru Fourth Floors)
A-3: Assembly (First Floor Lobby, Pool and Meeting Rooms)
M: Mercantile
Separated use groups shall be separated from adjoining use groups with a 1 hour fire separation wall (table 302.3.3 exception 1 sprinklers)
- Applicable Codes:
 - International Building Code - 2003
 - International Energy Conservation Code - 2003
 - Maine State Plumbing Code - Based on International Energy Plumbing Code
 - International Energy Mechanical Code - 2003
 - NFPA 2003
 - The National Electrical Code - 2005
 - American with Disabilities Act - 524 CMR 1998 / IBC 2003
 - NFPA 101 Life Safety Code

B. Allowable Area Calculations Data:

Use Group: R-1 (IBC 2003)		Use Group: A-3 (IBC 2003)	
Construction Type: 2A		Construction Type: 2A	
Allowable Area: (Table 503)	10,200 sf	Allowable Area: (Table 503)	15,500 sf
Area Modification: (Sec. 506, 506.2, 506.3)		Area Modification: (Sec. 506, 506.2, 506.3)	
$A_a = 24,000 + \frac{24,000 \times 34.5}{100} + \frac{24,000 \times 200}{100}$		$A_a = 15,500 + \frac{15,500 \times 34.5}{100} + \frac{15,500 \times 200}{100}$	
$A_a = 24,000 + 8,280 + 48,000$		$A_a = 15,500 + 5,347 + 31,000$	
$A_a = 36,720$		$A_a = 51,847$	
Allowed Area: 36,720 sf		Allowed Area: 51,847 sf	
Max. per Floor		Max. per Floor	
Allowable Height: (Table 503)	4 st 65'-0"	Allowable Height: (Table 503)	3 st 65'-0"
Sprinkler Increase: (Sec. 504.2)	1 st 20'-0"	Sprinkler Increase: (Sec. 504.2)	1 st 20'-0"
4 st, 60'-0" limit (504.2)		4 st, 60'-0" limit (504.2)	
Adjusted Height:	4 st 60'-0"	Adjusted Height:	4 st 85'-0"

Use Group: M (IBC 2003)	
Construction Type: 2A	
Allowable Area: (Table 503)	21,500 sf
Area Modification: (Sec. 506, 506.2, 506.3)	
$A_a = 21,500 + \frac{21,500 \times 34.5}{100} + \frac{21,500 \times 200}{100}$	
$A_a = 21,500 + 7,447 + 43,000$	
$A_a = 71,947$	
Allowed Area: 71,947 sf	
Max. per Floor	
Allowable Height: (Table 503)	4 st 65'-0"
Sprinkler Increase: (Sec. 504.2)	1 st 20'-0"
4 st, 60'-0" limit (504.2)	
Adjusted Height:	5 st 85'-0"

C. Building Areas Per Floor:

Floor	Actual Gross Area per Floor	Allowable Gross Area per Floor (Table 503)
R-1		
First	6,817 sq. ft.	36,720 sq. ft.
Second	26,001 sq. ft.	Maximum allowable floors of 4 stories (Section 504.2)
Third	26,001 sq. ft.	
Fourth	26,001 sq. ft.	
Fifth	26,001 sq. ft.	
Total	110,821 sq. ft.	146,880 sq. ft.

First Floor
 Allowable Area Ratio (Section 302.3.2 must be less or equal to 1.0)
 $R-1(6,817/36,720) + A-3(19,063/51,847) + M(1,987/71,947) = (.19) + (.38) + (.03) = .60$

Second Floor
 Allowable Area Ratio (Section 302.3.2 must be less or equal to 1.0)
 $R-1(26,001/36,720) + A-3(4,253/51,847) + M(0) = (.71) + (.08) + (0) = .79$

Typical Floor
 Allowable Area Ratio (Section 302.3.2 must be less or equal to 1.0)
 $R-1(26,001/36,720) + A-3(0) + M(0) = (.71) + (0) + (0) = .71$

Floor	Actual Gross Area per Floor	Allowable Gross Area per Floor (Table 503)
A-3		
First	19,063 sq. ft.	51,847 sq. ft.
Second	Exterior Courtyard 4,253 sq. ft.	per floor - 4 allowed floors
Total	23,316 sq. ft.	207,388 sq. ft.

Floor	Actual Gross Area per Floor	Allowable Gross Area per Floor (Table 503)
M		
First (only)	1,987 sq. ft.	71,947 sq. ft.
Total	1,987 sq. ft.	359,735 sq. ft.

Actual Square Footage (Interior Spaces)	
First Floor	27,867 sq. ft.
Second Floor	26,001 sq. ft.
Third Floor	26,001 sq. ft.
Fourth Floor	26,001 sq. ft.
Fifth Floor	26,001 sq. ft.
Total	131,871 sq. ft.

D. Public Toilet Room Design:

MINIMUM FACILITIES FOR BUILDING OCCUPANCY (Table 4-1 Maine State Plumbing Code)			
Use Group (Hotel)	Plumbing Facilities (Table 4-1 Lounge & Restaurant)	Other Facilities	Use Group (Mercantile)
First Floor Assembly: 239 occupants Bar / lounge and Meeting area. 25 Employees Total 264	Men Required: 132 design occupant load 2 WC per 51-150 people 1 Urinal per 150 people 1 Lav. per 150 people Provided-First Floor: 2 WC and 1 urinal provided 3 WC and 2 urinals provided 1 Lav. Req. 3 provided	Women Required: 132 design occupant load 2 WC per 51-150 people 1 Lav. per 150 people Provided-First Floor: 2 WC provided 5 WC provided 1 Lav. Req. 3 provided	Required: Total Assembly: 264 occupants 1 Drinking Fountain / 150 (table 4-1 public building) 2 Drinking Fountain Required 1 Service Sink Required Provided: 1 HI 1 LO Drinking Fountain Provided 1 Service Sink Provided
Second through fifth floors	Men and Women Required: 15 design occupant load 1 WC per 1-15 people 0 Urinal per 1-9 people 1 Lav. per 40 people Provided-Men and Women: 1 WC required 1 WC provided 1 Lav. provided		First Floor Mercantile: 30 occupants Men and Women Required: 15 design occupant load 1 WC per 1-15 people 0 Urinal per 1-9 people 1 Lav. per 40 people Provided-Men and Women: 1 WC required 1 WC provided 1 Lav. provided
Assembly	N/A		

E. Construction Summary:

FIRE RESISTANCE RATINGS OF STRUCTURE ELEMENTS (TABLE 601)	
Structure Element	Rating
Structural Frame	1 hour
Bearing Walls - Exterior	1 hour
Bearing Walls - Interior	1 hour
Nonbearing Walls - Exterior (Table 602) (greater or = to 30 feet) (< 30 feet)	1 hour
Floor Construction	1 hour
Roof Construction (With beams and Joist)	1 hour

INCIDENTAL USE AREAS (table 302.1.1)	
Area	Rating
Fumace Rooms with Equipment over 400,000 BTU input	1 hour or automatic sprinkler
Boilers over 15 PSI and 10 HP	1 hour or automatic sprinkler
Laundry Rooms over 100 S.F.	1 hour or automatic sprinkler
Storage Rooms over 100 S.F.	1 hour or automatic sprinkler
Waste and linen collection rooms over 100 S.F.	1 hour
Boiler and fumace rooms	Automatic sprinkler
Storage rooms	Automatic sprinkler and smoke separation walls

ADDITIONAL FIRE RESISTANCE RATINGS	
Building Element	Rating
R-1 Sleeping Unit Separation	1 hour
Separated Uses (R-1, M to A-3 Table 302.3.3 Except, 1 Sprinkler)	1 hour
Stair exit enclosure shafts	2 hour
Elevator shafts	2 hour
All other shafts (connecting 4 stories 707.4)	2 hour
Exit access corridors (table 1016.1) (with sprinkler) Assembly and Mercantile Residential	1 hour 1/2 hour
All door ratings to comply with Table 715.3	
Interior finishes: (Table 803.5) (Sprinklered)	R-1 Class B A-3 Class B Class C Class C
Vertical Exits and passageways	
Exit Access corridors	
Rooms or enclosed areas	
Roof Covering: Roof Material Classification (sect. 1505.1)	Class B

Note:
 All penetrations through fire treated assemblies shall be fire stopped or otherwise protected to maintain the integrity of the assembly in the event of fire. See fire stopping details.
 All shafts and/or ducts penetrating a rated assembly for two or more floors continuous to have 2 hour gypsum board rated assembly wrap.

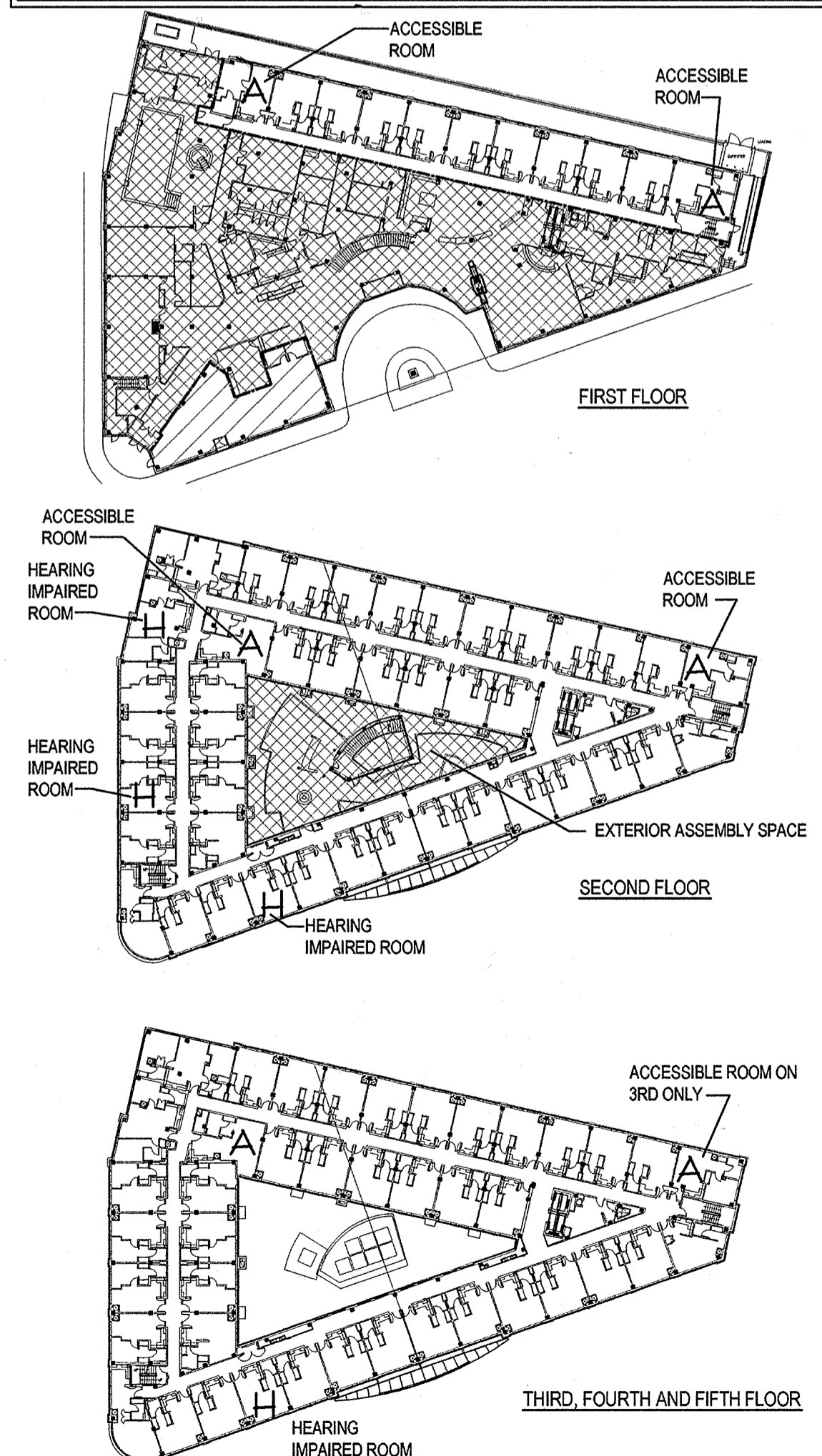

DRAWING INDEX

A0.00 Code Review & Drawing Index	A7.7 Guestroom Details	E0.01 Electrical Legend and General Notes
C001 Cover Sheet, General Notes and Legend	A7.8 Guestroom Details	E1.01 Lighting Plan First Floor
- Existing Conditions and Subdivision Plan	A7.9 Guestroom Details	E1.02 Lighting Plan Second Floor
C101 Site Layout and Utility Plan	A8.0 Door Hardware and Jamb Schedule	E1.03 Lighting Plan Third and Fourth Floors (Typical Floors)
C102 Grading, Drainage and Erosion Plan	A8.1 Door Hardware and Jamb Schedule	E1.04 Lighting Plan Fifth Floor
C401 Site Details	A8.2 Threshold and Floor Transition Details	E2.01 Power Plan First Floor
C402 Utility Details	A8.3 Window Schedule and Details	E2.02 Power Plan Second Floor
C403 Drainage Details	A8.4 Window Schedule and Details	E2.03 Power Plan Third and Fourth Floors (Typical Floors)
C404 Subsurface Detention Pond Plan and Details	A9.0 Finish Schedule	E2.04 Power Plan Fifth Floor
C405 Erosion and Sedimentation Control Notes and Details	A9.1 Finish Schedule	E2.05 Electrical Roof Plan
L-1.0 Paving and Landscape Plan	A9.2 Interior Finish Index	E3.01 Fire Alarm Plan First Floor
L-2.0 Courtyard Layout and Grading Plan	A9.3 Interior Finish Index	E3.02 Fire Alarm Plan Second Floor
L-3.0 Courtyard Landscape Plan	K1.0 Kitchen and Bar Plans and Details	E3.03 Fire Alarm Plan Third and Fourth Floors
L-4.0 Site Details		E3.04 Fire Alarm Plan Fifth Floor
L-4.1 Site Details		E4.01 Electrical Unit Plans
A0.2 Occupancy and Egress		E4.02 Electrical Unit Plans
A0.3 Fire Separation Plan		E4.03 Electrical Unit Plans
A0.4 Fire Separation Details		E4.04 Electrical Partial Plans
A0.4A Fire Separation Details		E5.01 Electrical Riser Diagram
A0.5 Grid Control Plan		E5.02 Fire Alarm Riser Diagram
A0.6 Wall Type Legend and UL Assemblies		E6.01 Electrical Schedules
A0.7 Wall Type Legend and UL Assemblies		E6.02 Electrical Schedules
AC1.1 Architectural Site Plan		E6.03 Electrical Details
AC1.2 Architectural Site Plan		
A1.0 First Floor Plan	FP0.01 Fire Protection Legend, General Notes, Details and Part Plans	
A1.1 Second Floor Plan	FP0.02 Fire Protection Details	
A1.2 Typical Floor Plan	FP1.1 Fire Protection First Floor Plan	
A1.3 Roof Plan	FP1.20 Fire Protection Unit Plans	
A1.3A Roof Details	FP1.21 Fire Protection Unit Plans	
A1.4 First Floor Public Space Enlarged Plan	FP1.22 Fire Protection Unit Plans	
A1.5 First Floor Public Space Enlarged Plan	FP1.2 Fire Protection Second Floor Plan	
A1.6 First Floor Public Space Enlarged Plan	FP1.3 Fire Protection Third Floor Plan	
A1.7 Second and Typical Floor Public Space Enlarged Plans	FP1.4 Fire Protection Fourth Floor Plan	
A1.20 Guestrooms- Enlarged Plans and Elevations	FP1.5 Fire Protection Fifth Floor Plan	
A1.21 Guestrooms- Enlarged Plans and Elevations	FP1.6 Fire Protection Roof Plan	
A1.22 Guestrooms- Enlarged Plans and Elevations	P0.1 Plumbing Legend, General Notes and Details	
A1.23 Guestrooms- Enlarged Plans and Elevations	P0.2 Plumbing Details and Piping Diagram	
A1.24 Guestrooms- Enlarged Plans and Elevations	P0.3 Plumbing Part Plans and Equipment Schedules	
A1.25 Guestrooms- Enlarged Plans and Elevations	P0.4 Plumbing Part Plans	
A1.26 Guestrooms- Enlarged Plans and Elevations	P0.5 Plumbing Part Plans	
A1.27 Guestrooms- Enlarged Plans and Elevations	P0.6 Plumbing Fixture and Equipment Schedule	
A1.28 Guestrooms- Enlarged Plans and Elevations	P1.0 Plumbing First Floor Plan	
A1.29 Guestrooms- Enlarged Plans and Elevations	P1.0U Plumbing First Floor Underground Plan	
A1.30 Guestrooms- Enlarged Plans and Elevations	P1.1 Plumbing Second Floor Plan	
A1.31 Guestrooms- Enlarged Plans and Elevations	P1.20 Base Unit Plans	
A1.32 Guestrooms- Enlarged Plans and Elevations	P1.21 Plumbing Unit Plans	
A1.33 Guestrooms- Enlarged Plans and Elevations	P1.2 Plumbing Third Floor Plan	
A2.0 Exterior Elevations	P1.3 Plumbing Fourth Floor Plan	
A2.1 Exterior Elevations	P1.4 Plumbing Fifth Floor Plan	
A2.2 Courtyard Elevations	P1.5 Plumbing Roof Plan	
A2.3 Transverse Sections	P2.0 Plumbing Water Riser Diagrams	
A3.0 Egress Stair #1 Plans, Sections and Details	P2.1 Plumbing Sanitary, Waste and Riser Diagrams	
A3.1 Egress Stair #2 Plans, Sections and Details		
A3.2 Monumental Stair Plans, Sections and Details	H0.01 HVAC Legend and General Notes	
A4.0 First Floor Reflected Ceiling Plan	H0.02 HVAC Schedules	
A4.1 First Floor Reflected Ceiling Plan	H0.03 HVAC Details	
A4.2 First Floor Reflected Ceiling Plan	H0.04 HVAC Details	
A4.3 Typical Floor Reflected Ceiling Plan	H0.05 HVAC Details	
A4.4 Lighting Schedule and Lighting Details	H1.01 HVAC First Floor Plan	
A4.5 Ceiling Details	H1.02 HVAC Second Floor Plan	
A5.0 Enlarged Wall Sections and Details	H1.03 HVAC Third Floor Plan	
A5.1 Enlarged Wall Sections and Details	H1.04 HVAC Fourth Floor Plan	
A5.2 Enlarged Wall Sections and Details	H1.05 HVAC Fifth Floor Plan	
A5.3 Enlarged Wall Sections and Details	H1.06 HVAC Roof Plan	
A5.4 Enlarged Wall Sections and Details	H1.07 HVAC First Floor Piping Plan	
A5.5 Cross Section	H1.21 HVAC Enlarged Guestroom Plans	
A5.5A Enlarged Wall Sections and Details	H1.22 HVAC Enlarged Guestroom Plans	
A5.6 Longitudinal Section	H1.23 HVAC Enlarged Guestroom Plans	
A5.6A Enlarged Section Details	H2.01 HVAC RTU-1 and RTU-2 Riser Diagrams	
A5.7 Elevator Plans and Sections	H2.02 HVAC Exhaust Riser Diagrams	
A5.8 Elevator Details	H2.03 HVAC Heat Pump Riser Diagrams	
A6.0 Public Space Elevations		
A6.1 Public Space Elevations		
A6.2 Public Space Elevations		
A6.3 Public Space Elevations		
A7.0 Public Space Details		
A7.1 Public Space Details		
A7.2 Public Space Details		
A7.3 Public Space Details		
A7.4 Public Space Details		
A7.5 Public Space Details		
A7.6 Public Space Details		

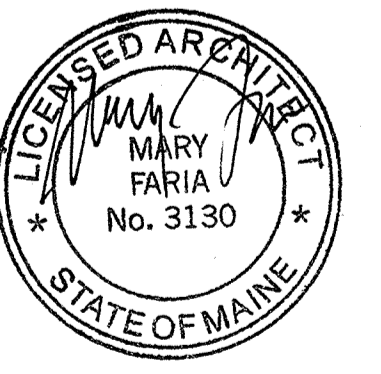

PERMIT ISSUED
9-27-2007

ARCHITECT GROUP ONE 21 W. THIRD STREET, BOSTON, MA 02127 TEL: (617) 268-7000 FAX: (617) 268-0209	STRUCTURAL ENGINEER Goldstein-Milano The Schwartz Center 529 Main St. Suite 203, Boston, MA 02129 TEL: (617) 670-9990 FAX: (617) 670-9939	MECHANICAL / ELECTRICAL / PLUMBING ENGINEERS R.W. Sullivan Engineering The Schwartz Center 529 Main St. Suite 203, Boston, MA 02129 TEL: (617) 523-8227 FAX: (617) 523-8016
---	---	---