

FRAMING PLAN SYMBOLS KEY	
□	WOOD OR STEEL POST/COLUMN
○	NUMBER OF WOOD STUDS IN POST BELOW
A / B / C	COLUMN (ABOVE, BELOW, CONTINUOUS) AT THIS LEVEL
(E) / (N)	EXISTING / NEW
←	(N) JOIST BEARING
→	(E) JOIST BEARING
↔	(N) CONTINUOUS JOIST WITH INTERMEDIATE BEARING
↔	(E) CONTINUOUS JOIST WITH INTERMEDIATE BEARING
↔	(N) FLUSH FRAMED JOIST BEARING WITH HANGER
↔	(E) JOIST W/ (N) FLUSH HANGER
↔	(N) WOOD STUD BEARING WALL BELOW
↔	(E) MULTI-WYTHE BRICK MASONRY WALL TO REMAIN/ BE REPAIRED AS NEEDED.
↔	INDICATES (N) FLOOR INFILL W/ 2x @ 16" O.C. FLOOR JOISTS. JOIST DEPTH TO (E) MATCH FLOOR FRAMING
#T	NUMBER OF TRIM STUDS UNDER HEADER
#K	NUMBER OF KING STUDS ADJACENT TO HEADER

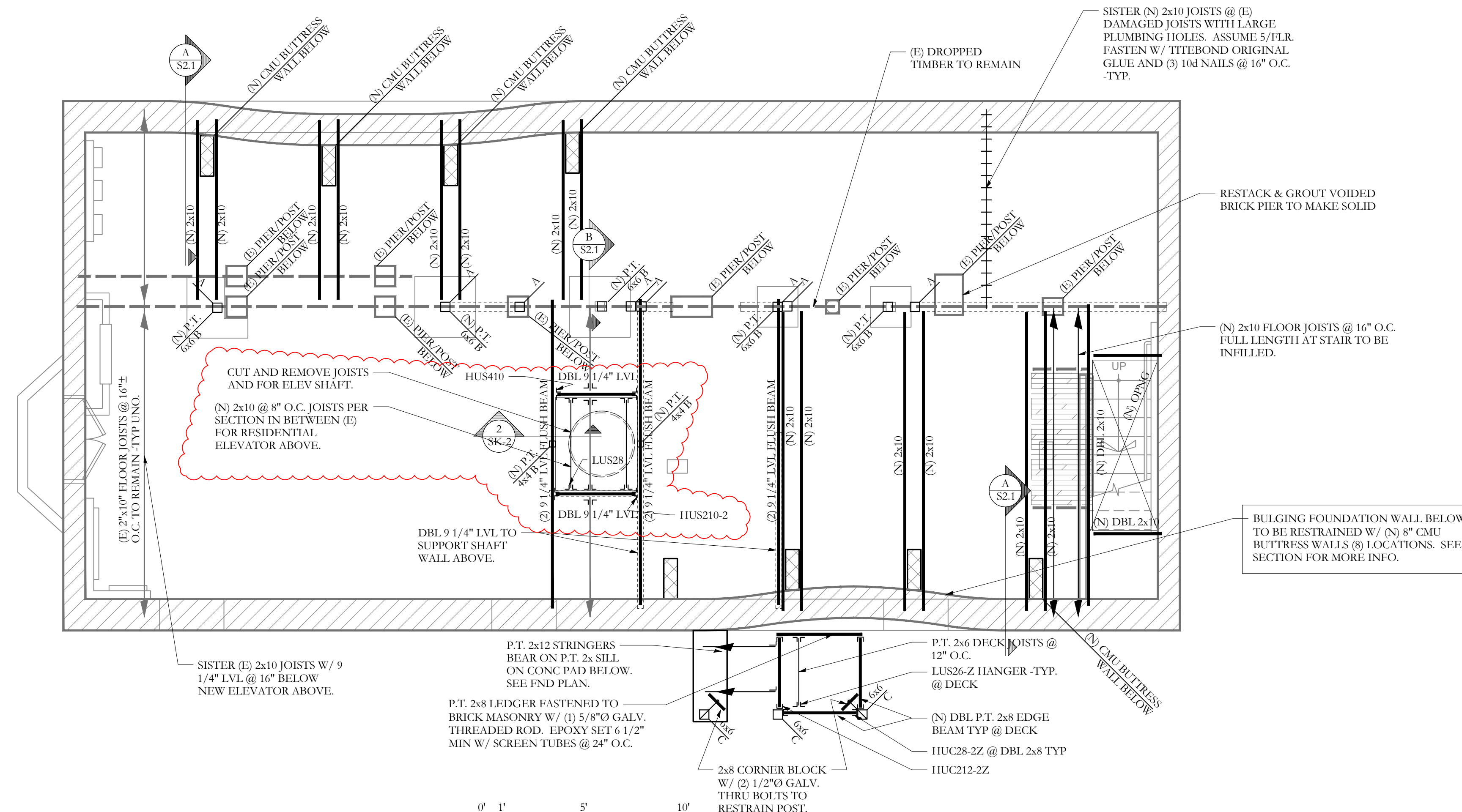

1ST FLOOR FRAMING PLAN
 SCALE 1/4"=1'-0"

- NOTES:
- SEE GENERAL NOTES FOR ADDITIONAL INFORMATION.
 - TEMPORARY SHORING OF ALL REPAIR WORK BY CONTRACTOR -TYP
 - (E) INDICATES EXISTING, (N) INDICATES NEW.
 - ALL WOOD COLUMNS IN 2x6 WALLS SHALL BE 3-2x6 AND IN 2x4 WALLS SHALL BE 3-2x4 UNLESS NOTED OTHERWISE ON PLANS.
 - ALL BEAMS ARE FLUSH, UNO.
 - ALL HEADERS IN 2x6 BEARING WALLS ARE (3) 2x6, UNO.
 - ALL HEADERS IN 2x4 BEARING WALLS ARE (2) 2x8, UNO.
 - ALL FLOOR SHEATHING TO BE 3/4", SEE GENERAL NOTES FOR ADDITIONAL INFORMATION -TYP.

© 2015 RYAN SENATORE ARCHITECTURE

RESIDENCES
 107 INDIA STREET
 PORTLAND, MAINE



RYAN SENATORE ARCHITECTURE
 565 CONGRESS ST. SUITE 304
 PORTLAND, MAINE 04101
 207-650-6414
 senatorearchitecture.com

CONSULTANTS:
STRUCTURAL: Structural Integrity
 77 Oak Street
 Portland, ME 04101
 207-774-4614

REVISIONS:
 7 March, 2016
 elevator rev: 15 April, 2016

PERMIT SET

DATE: 5 February, 2016

PROJECT No.

DRAWN BY: MKL

CHECKED BY:

SCALE: AS NOTED

SHEET TITLE:

1ST FLOOR FRAMING PLAN

S1.2

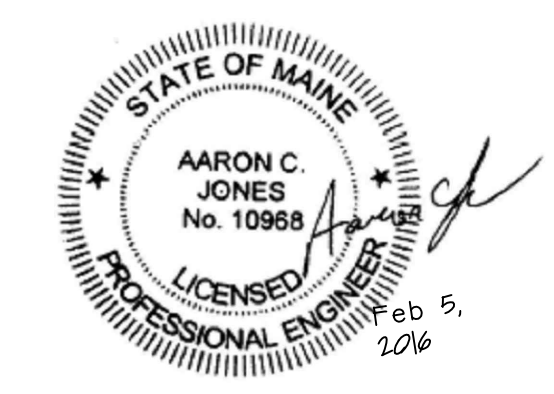

Structural Integrity
 Consulting Engineers, Inc.
 77 Oak Street
 Portland, ME, 04101
 p. 207-774-4614
 f. 866-793-7835
 www.structuralintegrity.com

BUILD WITH CONFIDENCE
 © 2012 Structural Integrity Consulting Engineers, Inc.
 S1 # 15-0242