

NOTES:
 1.) DO NOT LOCATE PLUMBING OR ELECTRICAL ELEMENTS IN WALLS TO CONFLICT WITH POCKET DOORS

WALL LEGEND	
WALL TO BE REMOVED	
EXISTING WALL	
NEW WALL	

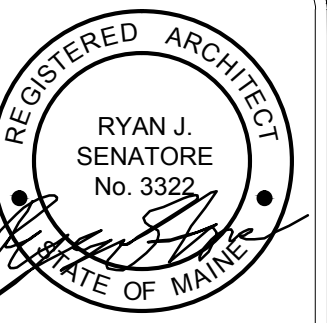

© 2016 RYAN SENATORE ARCHITECTURE

RESIDENCES
 107 INDIA STREET
 PORTLAND, MAINE



RYAN SENATORE
 ARCHITECTURE
 565 CONGRESS STREET
 PORTLAND, MAINE 04101
 207-747-5159
 senatorearchitecture.com

CONSULTANTS:
 STRUCTURAL:
 Structural Integrity
 77 Oak Street
 Portland, ME 04101
 207-774-4614

REVISIONS:

DATE: FEBRUARY 12, 2016

PROJECT No.

DRAWN BY: RRT

CHECKED BY: RJS

SCALE: AS NOTED

SHEET TITLE:

FIRST FLOOR PLAN

A1-2

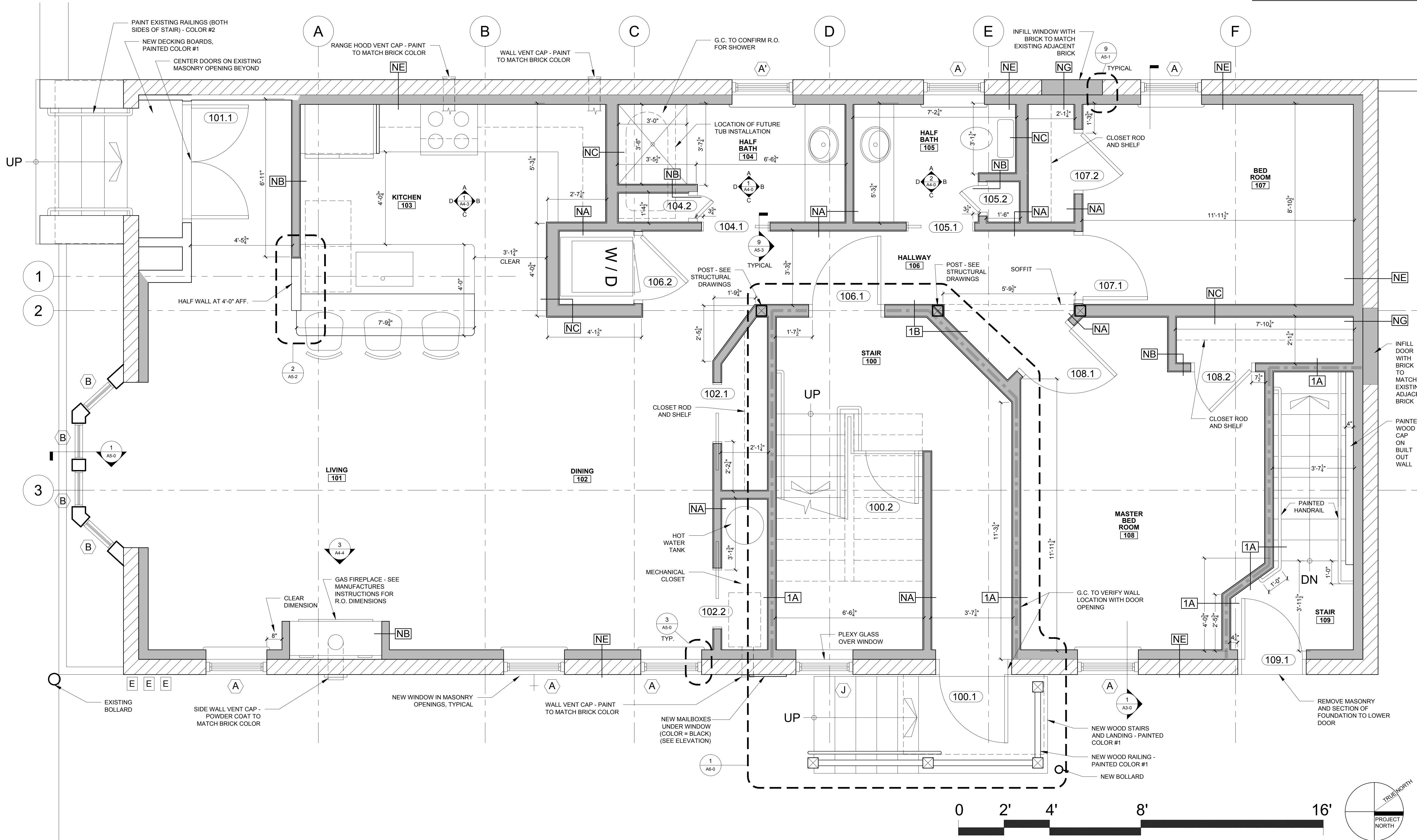

1 FIRST FLOOR PLAN
 1/2" = 1'-0"