

LEGEND	
	EXIT
	FIRE EXTINGUISHER

1 CODE REVIEW PLAN
1/8" = 1'-0"

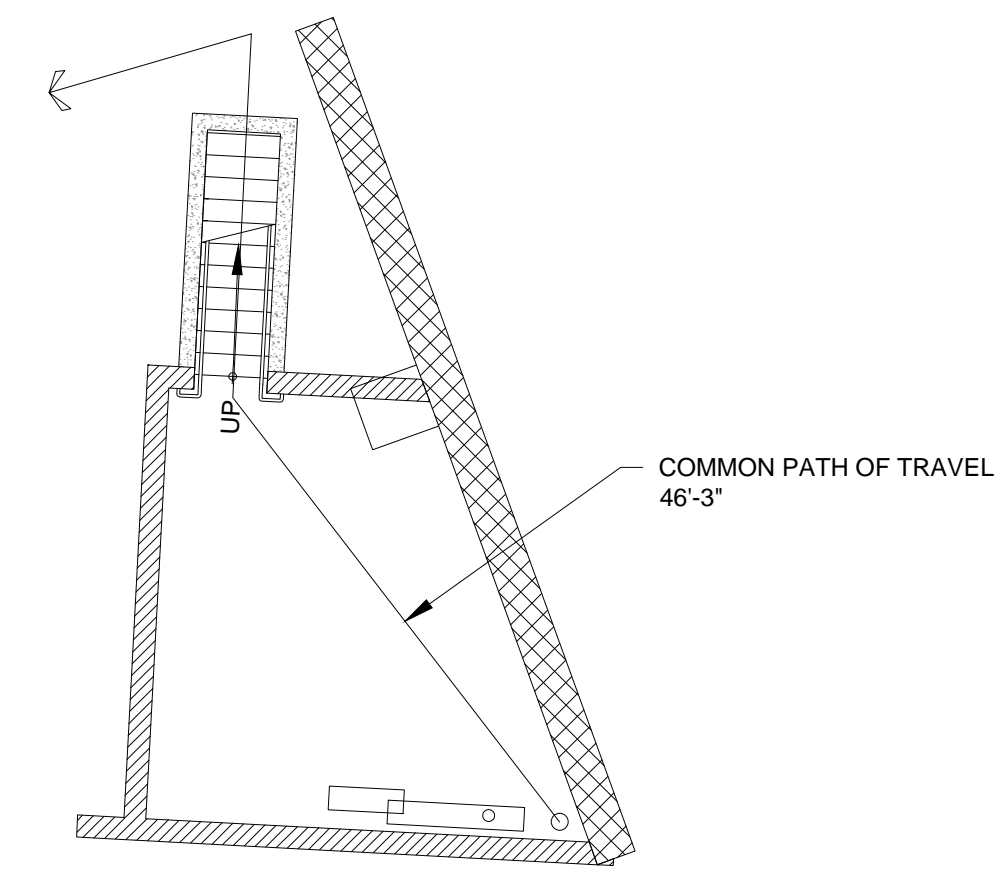

2 CODE REVIEW - BASEMENT PLAN
1/8" = 1'-0"

© 2016 RYAN SENATORE ARCHITECTURE

CLOUDPORT OFFICES
63 FEDERAL STREET
PORTLAND, MAINE

RSA
RYAN SENATORE ARCHITECTURE
565 CONGRESS STREET
PORTLAND, MAINE 04101
207-650-6414
senatorearchitecture.com

CONSULTANTS:

REVISIONS:

DATE: 29 MARCH 2016

PROJECT No. 1617

DRAWN BY: RRT

CHECKED BY: RJS

SCALE: AS NOTED

SHEET TITLE:
CODE REVIEW PLAN

G1-2